

GROUND(GREEN)/  
MISE A LA TERRE (VERT)

WHITE/BLANC

BLACK/NOIR



DETAIL A

UNSCREW THE SET-SCREW  
TO ADJUST THE POSITION  
OR THE LENGTH FOR THE  
AIRCRAFT CABLE & WIRE/  
DEVISSER LA VIS POUR  
AJUSTER LA POSITION OU  
LA LONGUEUR DU CABLE  
D'ACIER ET DU FIL.

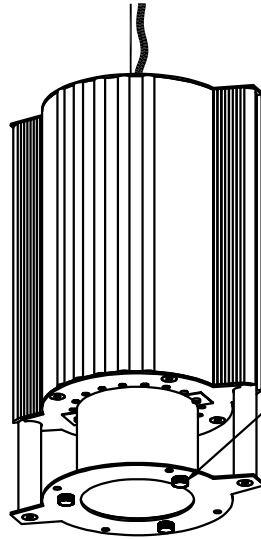
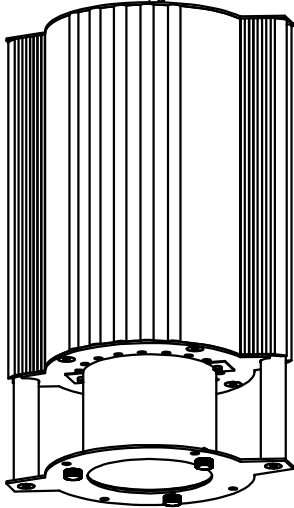

1-LOOSE THE 3 DECORATIVE SCREW/  
DÉSERRER LES 3 VIS DÉCORATIVES

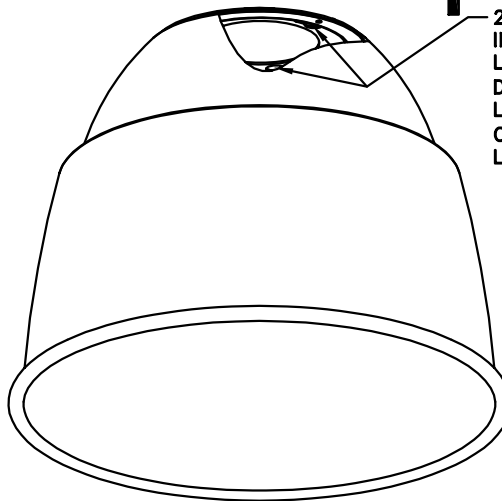

2-FIT THE DECORATIVE SCREW  
IN THE HOLE AND TWIST TO  
LOCK THE SHADE.SCREW THE  
DECORATIVE SCREW/  
INSÉRER LES VIS DANS LES CHEMINS DE  
CLÉ ET TOURNER POUR BARRER  
LE DIFFUSEUR. RESERRER LES VIS.

### 3-INSTALL THE LAMP / INSTALLER L'AMPOULE

COMP FL G24Q5 TRIPLE TWIN 57W  
E 120-277V  
COMP FL G24Q6 TRIPLE TWIN 70W  
E 120-277V

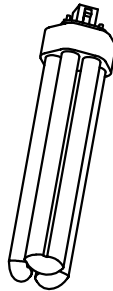

MH OPEN MED BD17, E17, ED17  
70W/100W/150W/175W  
M 120/277/347V  
MH OPEN MED E17, ED17  
70W/100W E 120-277V

\* MH MED BD17, E17, ED17  
70W/100W/150W/175W  
M 120/277/347V



INC MED A21, HAL T10 200W 120V

DATE: 2006/08/08

#### NOTES:

- \* USE PROTECTION GLASS WITH "MH MED..." LAMPS
- \* UTILISER VERRE DE PROTECTION AVEC AMPOULES "MH MED..."

### INSTALLATION SHEET FICHE D'INSTALLATION

PROD.: 4270

TYPE: PENDANT FIXTURE/ SUSPENSION

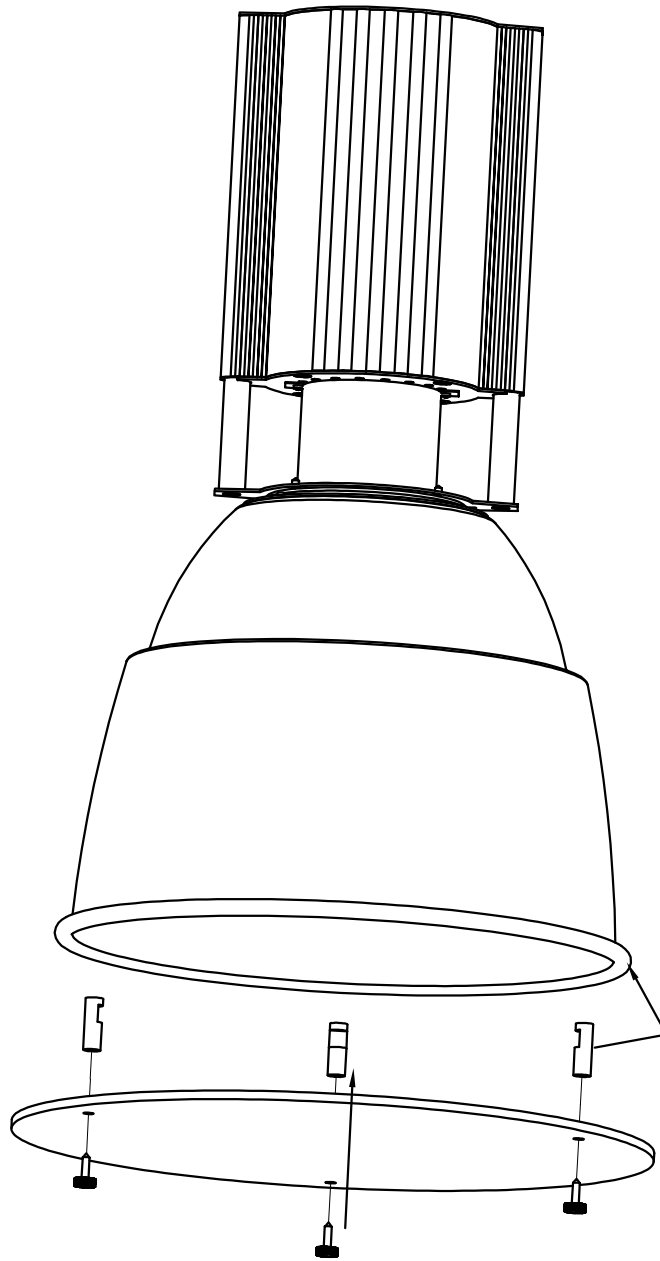

FIT THE CLIPS AROUND THE SHADE  
 THEN PASS THE 3 DECORATIVE SCREWS THROUGH  
 THE GLASS AND TIGHTEN THEM. /  
 INSÉRER LES CLIPS AUTOUR DU DIFFUSEUR  
 PUIS PASSER LES VIS DANS LE VERRE  
 ET LES VISSER.



DATE: 2006/08/08

NOTES:

- \* USE PROTECTION GLASS WITH  
 "MH MED..." LAMPS
- \* UTILISER VERRE DE PROTECTION  
 AVEC AMPOULES "MH MED..."

INSTALLATION SHEET  
 FICHE D'INSTALLATION

PROD.: 4270

TYPE: PENDANT FIXTURE/ SUSPENSION

PAGE : 2/2