

INSTALLATION INSTRUCTIONS

IMPORTANT: READ BEFORE INSTALLING FIXTURE.
RETAIN FOR FUTURE REFERENCE.



SAFETY: This fixture must be wired in accordance with the National Electrical Code and applicable local codes and ordinances. Proper grounding is required to insure personal safety. Carefully observe grounding procedure under installation section.

WARNING: Make certain power is OFF before starting installation or attempting any maintenance. Risk of fire/electric shock. If not qualified, consult an electrician.

- **RISK OF ELECTRIC SHOCK**—Disconnect power at fuse or circuit breaker before installing or servicing.
- **RISK OF BURN**—Disconnect power and allow fixture to cool before servicing.
- **RISK OF PERSONAL INJURY**— Fixture may become damaged and/or unstable if not installed properly. Tighten all fixture components to their recommended torque values. Do not lift pole into place by securing lifting device to lighting fixture.

WARNING: Make certain power is OFF before starting installation or attempting any maintenance.

STANDARD OPEN FIXTURE INSTALLATION

1. Unscrew two screws from cover plate or cone located at fixture base. **(FIG. 2)** Remove plate or cone cover to gain access to the wiring compartment.
2. Pull electrical service leads through the pole with sufficient length to reach through and into the wiring compartment of the fixture. The service leads should pass through the large, circular openings in the mounting plate to avoid cutting or pinching the leads.
3. Connect service leads to the appropriate position with the terminal block. **(FIG. 3)**
 - a. Three-terminal block (2-wire service): Connect line service lead to terminal that is connected to black factory-installed wire. Connect neutral service wire to terminal that is connected to white factory-installed wire.
 - b. Three-terminal block (3-wire service, 2 lines, 1 ground): Connect 1 line service lead to terminal that is connected to black factory-installed wire. Connect other line service lead to terminal that is connected to white factory-installed wire. Connect ground service lead to terminal that is connected to green factory-installed wire.
 - c. Three-terminal block (3-wire service, 1 line, 1 neutral, 1 ground): Connect line service lead to terminal that is connected to black factory-installed wire. Connect neutral service wire to terminal that is connected to white factory-installed wire. Connect ground service wire to terminal that is connected to green factory-installed wire.
 - d. No terminal block (3-wire service, 2 lines, 1 ground): Connect 1 line service lead to black factory-installed wire. Connect other line service lead to white factory-installed wire. Connect ground service lead to green factory-installed wire.
 - e. No terminal block (3-wire service, 1 line, 1 neutral, 1 ground): Connect line service lead to black factory-installed wire. Connect neutral service wire to white factory-installed wire. Connect ground service wire green factory-installed wire.
4. For fixtures with asymmetric light patterns, locate the word "streetside" on the overhang plate and rotate the fixture on the pole such that the word "streetside" is facing the street.
5. Secure the fixture to the pole top by tightening the three square head bolt in the fixture base. Recommended tightening torque: 120-140 in-lbs.
6. Reattach plate or cone cover to fixture base and secure with two cover retaining screws.
7. The fixture is now ready to energize.

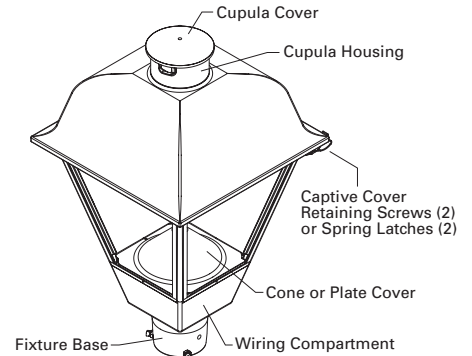

FIG. 1

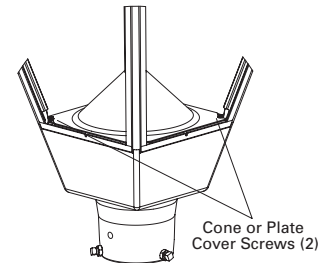

FIG. 2

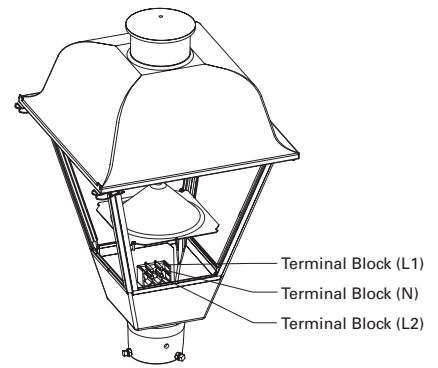

FIG. 3

STANDARD FIXTURE WITH LENS INSTALLATION

1. Loosen the captive cover retaining screws or spring latches and open the hinged top cover of the fixture. **(FIG. 1)**
2. Remove two nuts and screw on LED assembly **(FIG. 4)** and lift LED assembly to side.
3. Remove two acrylic refractor panels by lifting them up and out of the slotted corner posts.
4. Unscrew two screws from cover plate at fixture base. **(FIG. 2)** Remove plate cover to gain access to the wiring compartment.
5. Pull electrical service leads through the pole with sufficient length to reach through and into the wiring compartment of the fixture. The service leads should pass through the large, circular openings in the mounting plate to avoid cutting or pinching the leads.

— continued

These instructions do not claim to cover all details or variations in the equipment, procedure, or process described, nor to provide directions for meeting every possible contingency during installation, operation or maintenance. When additional information is desired to satisfy a problem not covered sufficiently for user's purpose, please contact your nearest representative. **NOTE:** Specifications and dimensions subject to change without notice.

INSTALLATION INSTRUCTIONS

IMPORTANT: READ BEFORE INSTALLING FIXTURE.
RETAIN FOR FUTURE REFERENCE.

WARNING: Make certain power is OFF before starting installation or attempting any maintenance.

6. Connect service leads to the appropriate position with the terminal block. (FIG. 3)
 - a. Three-terminal block (2-wire service): Connect line service lead to terminal that is connected to black factory-installed wire. Connect neutral service wire to terminal that is connected to white factory-installed wire.
 - b. Three-terminal block (3-wire service, 2 lines, 1 ground): Connect 1 line service lead to terminal that is connected to black factory-installed wire. Connect other line service lead to terminal that is connected to white factory-installed wire. Connect ground service lead to terminal that is connected to green factory-installed wire.
 - c. Three-terminal block (3-wire service, 1 line, 1 neutral, 1 ground): Connect line service lead to terminal that is connected to black factory-installed wire. Connect neutral service wire to terminal that is connected to white factory-installed wire. Connect ground service wire to terminal that is connected to green factory-installed wire.
 - d. No terminal block (3-wire service, 2 lines, 1 ground): Connect 1 line service lead to black factory-installed wire. Connect other line service lead to white factory-installed wire. Connect ground service lead to green factory-installed wire.
 - e. No terminal block (3-wire service, 1 line, 1 neutral, 1 ground): Connect line service lead to black factory-installed wire. Connect neutral service wire to white factory-installed wire. Connect ground service wire green factory-installed wire.
7. For fixtures with asymmetric light patterns, locate the word "streetside" on the overhang plate and rotate the fixture on the pole such that the word "streetside" is facing the street.
8. Secure the fixture to the pole top by tightening the three square head bolt in the fixture base. Recommended tightening torque: 120-140 in-lbs.
9. Reattach plate or cone cover to fixture base and secure with two cover retaining screws.
10. Replace the two previous acrylic refractors panels.
11. Reattach LED assembly to fixture with previous screws and nuts. Close the cover and secure with two cover retaining screws or secure spring latches.
12. Secure the fixture to the pole top by tightening the three square head bolt in the fixture base. Recommended tightening torque: 120-140 in-lbs.
13. The fixture is now ready to energize.

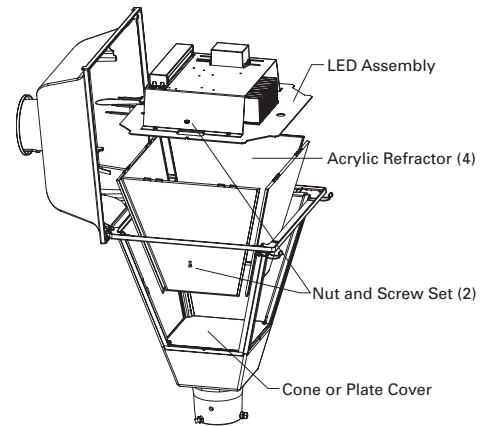

FIG. 4

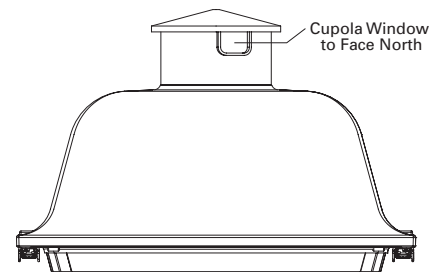

FIG. 5

STANDARD OPEN FIXTURE INSTALLATION

When specified, the Traditionaire fixture is furnished with a rotatable photocontrol receptacle that allows the photocontrol to be properly positioned with the use of a straight blade screwdriver.

1. Lift off cupola roof. (FIG. 1)
2. Remove the shorting cap (when furnished) and loosen the two flat head screws.
3. Rotate the cupola until the window in the cupola is facing in a northerly direction. Line up the north arrow of the photocontrol receptacle with the window in the cupola. Retighten the screws and install the photocontrol. (FIG. 5)
4. Replace the cupola roof.

CAUTION: THE RECEPTACLE HAS A BUILT-IN STOP WHICH ALLOWS 350° ROTATION. DO NOT ATTEMPT TO ROTATE BEYOND THIS STOP AS YOU WILL DAMAGE THE RECEPTACLE.

These instructions do not claim to cover all details or variations in the equipment, procedure, or process described, nor to provide directions for meeting every possible contingency during installation, operation or maintenance. When additional information is desired to satisfy a problem not covered sufficiently for user's purpose, please contact your nearest representative. **NOTE:** Specifications and dimensions subject to change without notice.