

DESCRIPTION

The OVF Flat Glass roadway luminaire is ideal for roadways where cutoff is preferred or light trespass is an issue. Suitable for 3G vibration conditions.

Catalog #		Type
Project		
Comments		Date
Prepared by		

SPECIFICATION FEATURES

Construction

HOUSING: Die-cast aluminum housing with stainless steel bail latch. 3G vibration rated. **DOOR:** Die-cast aluminum door frame with integral hinges for hands free installation, relamping and maintenance. ANSI wattage/source label.

Electrical

SOCKET: Adjustable mogul-base porcelain socket. 150W Metal Halide and below is medium-base. **BALLAST ASSEMBLY:** Hard mounted ballast with encapsulated starter for protection from environmental abuse. Standard two position tunnel

type compression terminal block. Optional swing-down ballast bridge also available (Not available for 3G applications). **PHOTOCONTROL:** Optional NEMA twistlock photocontrol receptacle also available.

Optical

LENS: Removable tempered flat glass lens. **REFLECTOR:** The optical system is a hydroformed anodized aluminum reflector with a Dacron polyester filter.

Mounting

Two-bolt/one bracket slipfitter with cast-in pipe stop and leveling steps. Fixed-in-place birdguard seals around 1-1/4" or 2" mounting arms. (Birdguard not needed for 2" arm.)

Finish

Standard grey polyester powder coat finish. Optional bronze, black and white finishes available.



OVF FLAT GLASS

150 - 400W

Pulse Start Metal Halide
High Pressure Sodium
Metal Halide

ROADWAY LUMINAIRE

DIMENSIONS

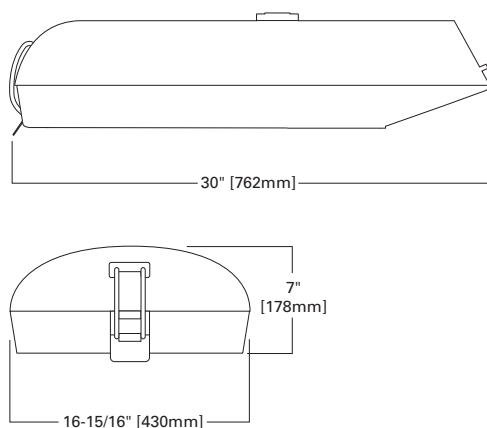

SWING-DOWN BALLAST MODULE

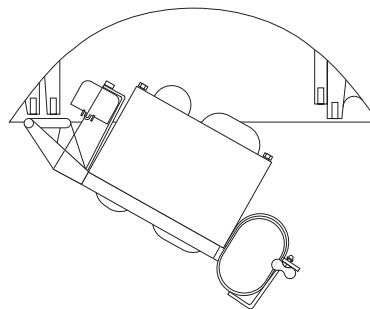

EPA

Effective Projected Area:
.51 Square Feet

SHIPPING DATA

Approximate Net Weight:
30 lbs. (18 kgs.)

ORDERING INFORMATION

Sample Number: OVF15SWW2D4

Product Family ¹	Lamp Wattage	Lamp Type	Ballast Type	Voltage	Distribution	Optical Package
OVF=Flat Glass	Pulse Start Metal Halide 15=150W 25=250W 32=320W 35=350W 40=400W High Pressure Sodium 15=150W ² 20=200W 25=250W 40=400W 24=250/400W wired 250W 42=400/250W wired 400W Metal Halide (Probe Start) ³ 25=250W 40=400W	P =Pulse Start Metal Halide S =High Pressure Sodium M =Metal Halide ⁴	C =CWI H =Reac. /HPF K =10kV CWA N =Hi. Reac./NPF P =Hi. Reac./HPF R =Hi. Reac./NPF W =CWA M =Mag. Reg.	2=120V 0=208V 4=240V 7=277V 8=480V 9=347V F=120/240 wired 120V W=Multi-Tap, wired 120V P=240 w/PCR wired 120V V=Multi-Tap, wired 240V N=Multi-Tap wired 277V	2=Type II 3=Type III	D=MCO
Options (Add as Suffix)			Accessories (Order Separately)			
CEC =California Title 20 Compliant Ballast (Applies to 250-320W and 400W Pulse Start Metal Halide Only) 1 =Single Fuse (120, 277 or 347V) 2 =Double Fuse (208, 240 or 480V) 4 =NEMA Twistlock Photocontrol Receptacle A =Raw Aluminum Unfinished E =150/100V HPS Ballast L =Lamp Included H =Plug-in Starter Receptacle K =Level Indicator M =MOV Lightning Surge Protector T =Swing-down Ballast Bridge U =UL/CSA Listed 3 =Three-Position Terminal Block WH =White BK =Black BZ =Bronze			OA/RA1016 =NEMA Photocontrol - Multi-Tap OA/RA1027 =NEMA Photocontrol - 480V OA/RA1014 =NEMA Photocontrol - 120V OA1214 =TufGuard Vandal Shield OA/RA1013 =Photocontrol Shorting Cap			

NOTES:

1. Customer is responsible for engineering analysis to confirm pole and fixture compatibility for all applications. Refer to our white paper WP513001EN for additional support information.

2. 150W units are for S55 lamps.

3. Probe Start Metal Halide available for non-US markets only (250-400W).

4. Metal Halide requires ED28 lamp.

5. MOV option not available for any system requiring a three-position terminal block (example - 240V with PCR wired 120V). In order for MOV option to function center terminal of three-position terminal block must be connected to "Earth" ground.