

DESCRIPTION

The RMA/RMC Security Light comes complete and ready for mounting in areas such as barnyards, service drives, storage facilities and roadways with light traffic.

| Catalog # | | Type |
|-------------|--|------|
| Project | | |
| Comments | | Date |
| Prepared by | | |

SPECIFICATION FEATURES

Construction

HOUSING: Die-cast aluminum head with slipfitter for 1-5/8" to 2-3/8" O.D. pipe.

Optical

OPTICS: Open bottom acrylic refractor standard on RMA. RMC has full cutoff Type V reflector.

Electrical

LAMP: Choice of High Pressure Sodium and Pulse Start Metal Halide lamp sources. SOCKET: HPS: Mogul-base, MH: Medium-base Standard (Mogul-base Optional). PHOTOCONTROL: Optional NEMA photocontrol available.

Mounting

Can be pole or wall mounted.

Finish

Standard natural aluminum finish.



RMA/RMC SECURITY LIGHT

Pulse Start Metal Halide
High Pressure Sodium

ROADWAY LUMINAIRE

DIMENSIONS

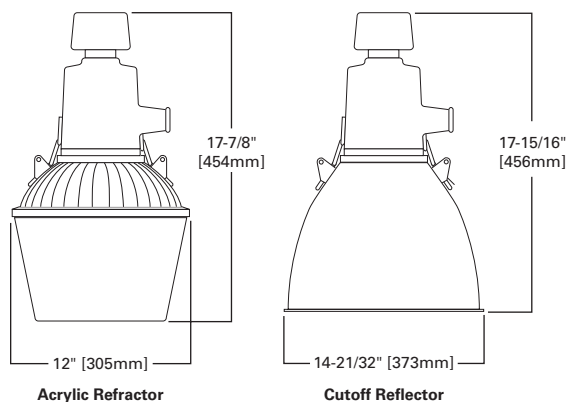

BRACKET

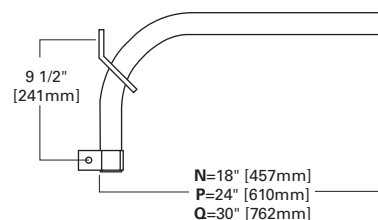

EPA

Effective Projected Area:
1.2 Square Feet

SHIPPING DATA

Approximate Net Weight:
31 lbs. (14 kgs.)

ORDERING INFORMATION

Sample Number: RMA50SR255LPV5

| Product Family | Lamp Wattage | Lamp Type | Ballast Type | Voltage | Distribution |
|--|---|---|--|---|---|
| RMA =Acrylic Refractor RMC =Cutoff Reflector ¹ | Pulse Start Metal Halide 70 =70W 10 =100W High Pressure Sodium 50 =50W 70 =70W 10 =100W 15 =150W ² 20 =200W | P =Pulse Start Metal Halide S =High Pressure Sodium ³ | N =Hi. React./NPF R =Hi. React./NPF | 2 =120V 4 =240V P =240V w/PCR wired 120V | 22 =Type II 33 =Type III 55 =Type V XX =None |
| Options (Add as Suffix) | | | Accessories (Order Separately) | | |
| L =Lamp Included H =Plug-in Starter Receptacle S =Shorting Cap N =18" Bracket P =24" Bracket Q =30" Bracket T =(2) 30" #14 Leads V =(2) 5" #14 Leads W =(2) 7" #14 Leads Y =Mogul-base for Metal Halide ⁴ U =UL/CSA Listed Z =ANSI Wattage/Source Label G =Birdguard Kit ⁵ F =Spring Type Clamping Band 5 =120V NEMA Photocontrol | | | RA1028 =House Side Shield RMCR5 =Type V Full Cutoff Reflector | | |

NOTES:

1. Available in Type V only.
2. 150W Units are for S55 Lamps.
3. Terminal block sockets standard on HPS. Not available on Metal Halide units. Requires the use of separate terminal block.
4. Available with 100W Metal Halide only.
5. Not available with plug-in starter option.