



Project name:

Classic Clad / Thermo Clad / ThermoPlus Clad
option selection for projects with Pine / Fir wood

1

cladding style.



quadrat
NFRC
compatible option



classic
NFRC compatible
option



classic sharp



heritage

2

cladding length. (shown with drip edge for illustration purposes)



full length
cladding

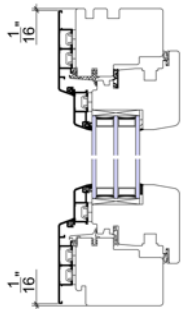

shortened
cladding
NFRC
compatible
option

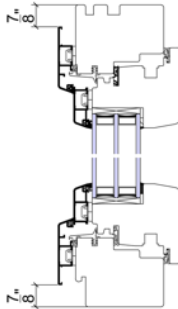

extra short
cladding
head and
jamb
(short
cladding at
sill)

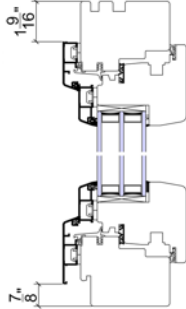

3

drip edge. drip edge is found at the sill of all windows, does not apply to
any doors with aluminum threshold
(ThermoClad with Classic cladding shown for illustration purposes)

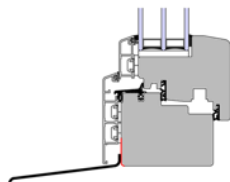
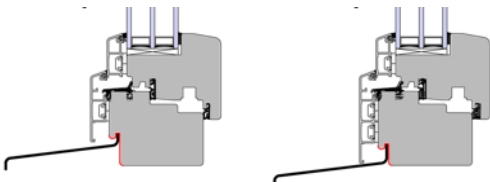

YES, I request a drip edge. Shown with regular
and short claddings for illustration purposes.
NFRC compatible option

NO, I decline a drip edge and understand the
additional challenges in waterproofing.

4

interior profile.



squared
off interior

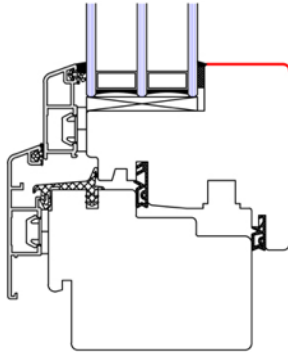

sloped
interior

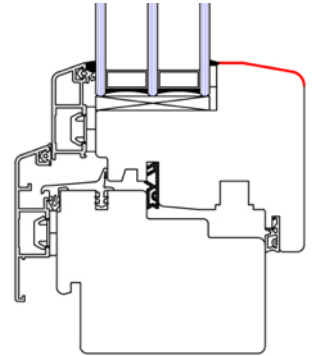

5

handle color and style.



F1 silver



F9
titanium



F4 light
bronze



R5.3 dark
bronze
Not available
for doors, or
windows
with locks. If
selected,
doors will
ship with F4
handle



white



Zola modern
stainless steel,
upgrade
charges apply.
Not for terrace
doors or
BreezePanels,
not for tiltfirst
locking window
handles



Verona
Chrome
handle,
upgrade
charges
apply. Not
for locking
or tilt first
window
handle





6

For the stain / paint on the wood parts of the window, choose EITHER a solid RAL color of your choice, or a stain color from the light color palette, or a stain color from the darker palette. For all color selection do not select from a screen or printed image, these are for reference only. Always choose from a physical Zola provided sample.



RAL solid color (please fill in color number) _____

light stain color palette, pine wood. if your wood is not pine, contact Zola



Zola Naked



matte
Clear



semimatte
Clear



matte
Birch



semimatte
Birch



matte
Maple



semimatte
Maple

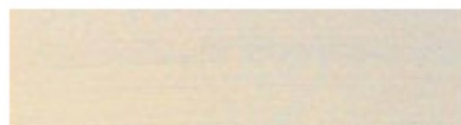

matte
Beech



semimatte
Beech



matte
Spruce



semimatte
Spruce



matte
Pine



semimatte
Pine



matte
Larch



semimatte
Larch



matte
Alder



semimatte
Alder



darker stain color palette, pine wood. if your wood is not pine, contact Zola

☐ Spruce
Color Stain
G 3236, E 7232



☐ Cherry
Color Stain
G 3234, E 7234



☐ Pine
Color Stain
G 3232, E 7229



☐ Teak
Color Stain
G 6093, E 7250



☐ Cypress
Color Stain
G 9703, E 9225



☐ Chestnut
Color Stain
G 2707, E 9707



☐ Old Pine
Color Stain
G 9247, E 7250



☐ Dark Oak
Color Stain
G 2707, E 3757



☐ Cherry
Color Stain
G 6051, E 7302



☐ Nut
Color Stain
G 6036, E 7250



☐ Oak
Color Stain
G 3080, E 9790

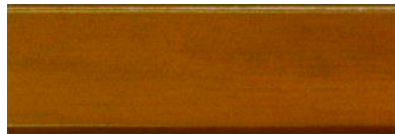

☐ Palisander
Color Stain
G 0711, E 7021





7

For your aluminum cladding color, please choose from standard and optional colors below. Prices for optional colors are found on your Zola quote if requested. For all color selection do not select from a screen or printed image, these are for reference only. Always choose from a physical Zola provided sample.

☐ RAL 9016
Traffic White



☐ RAL 9007
Grey Aluminum



☐ RAL 9006
White Aluminum



☐ RAL 9005
Jet Black

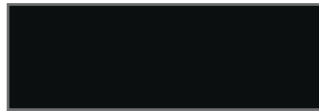

☐ RAL 8019
Grey Brown



☐ RAL 8017
Chocolate Brown

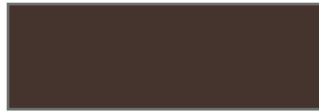

☐ RAL 8011
Nut Brown

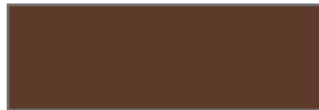

☐ RAL 8007
Fawn Brown



☐ RAL 8003
Clay Brown



☐ RAL 8001
Ocher Brown



☐ RAL 7042
Traffic Grey A



☐ RAL 7035
Light Grey

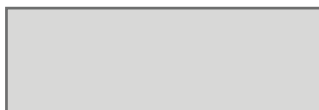

☐ RAL 7016
Anthracite Grey



☐ RAL 7001
Silver Grey



☐ RAL 6029
Mint Green



☐ RAL 6005
Moss Green



☐ RAL 5015
Sky Blue



☐ RAL 5013
Cobalt Blue



☐ RAL 5010
Gentian Blue



☐ RAL 3003
Ruby Red



☐ RAL 3002
Carmine Red



☐ RAL 1013
Oyster White



☐ RAL 1033
Dahlia Yellow



☐ custom color as defined and priced
in quote