

Assembly Instructions

HurryUp!® Nesting Table

Modesty Panel/Wire Manager

July 2009

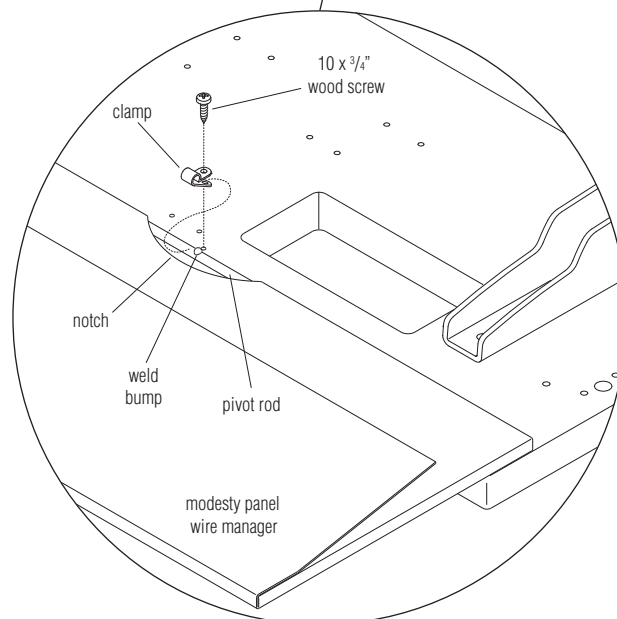
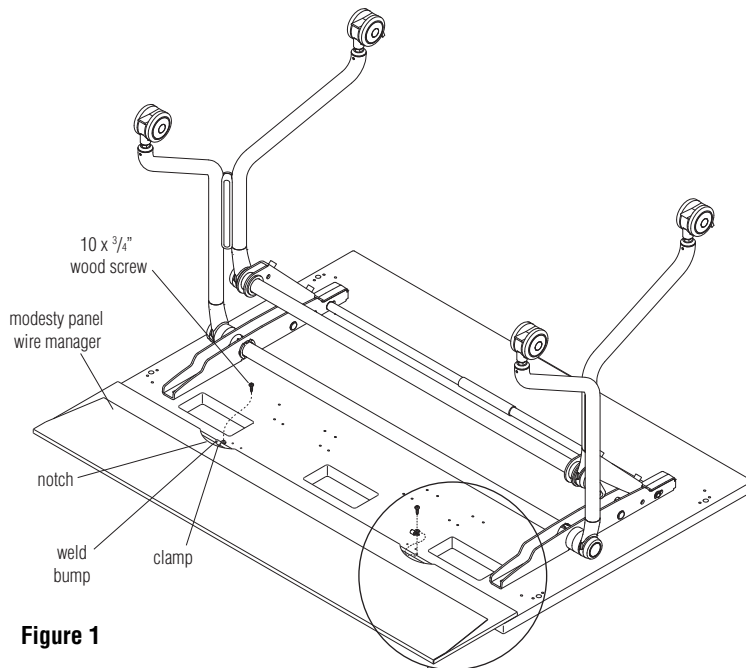

1. Carefully turn assembled table or worksurface upside down onto a soft, protective, flat surface. Two people may be required to handle worksurface (figure 1).
2. With table upside down, position the modesty panel onto the table with the wire manager face-up and the notches in the modesty panel facing toward the table frame as illustrated (Figure 1 & Detail A).
3. Use the location of the weld bumps and notches in the modesty panel to assist in locating the mounting holes for the modesty panel clips at the underside of the table. Position the clamps over the pivot rod of the modesty panel, to the inside of the weld bumps and align clamps with the mounting holes in the table top. Screw each clamp to the underside of the table with a #10 x 3/4" wood screw per clamp as illustrated. Each HurryUp modesty panel should be secured with two clamps. Tables 72" in length will have three clamps and screws to assemble per modesty panel wire manager (Figure 1 & Detail A).
4. Carefully turn the table to the upright position. Take care when rotating table as modesty panel/wire manager will rotate down into position as table is turned over.



Assemble units as described herein only. To do otherwise may result in instability. All screws, nuts and bolts must be tightened securely and must be checked periodically after assembly. Failure to assemble properly, or to secure parts may result in assembly failure and injury.