

Assembly Instructions

Hurry Up!™ Nesting Table PowerUp & Wire Management

October 2004

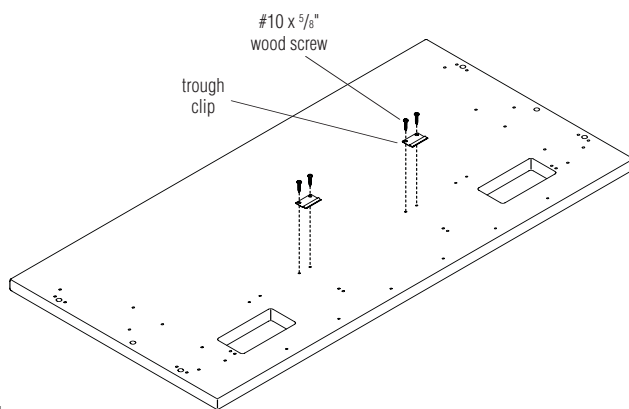

Figure 1

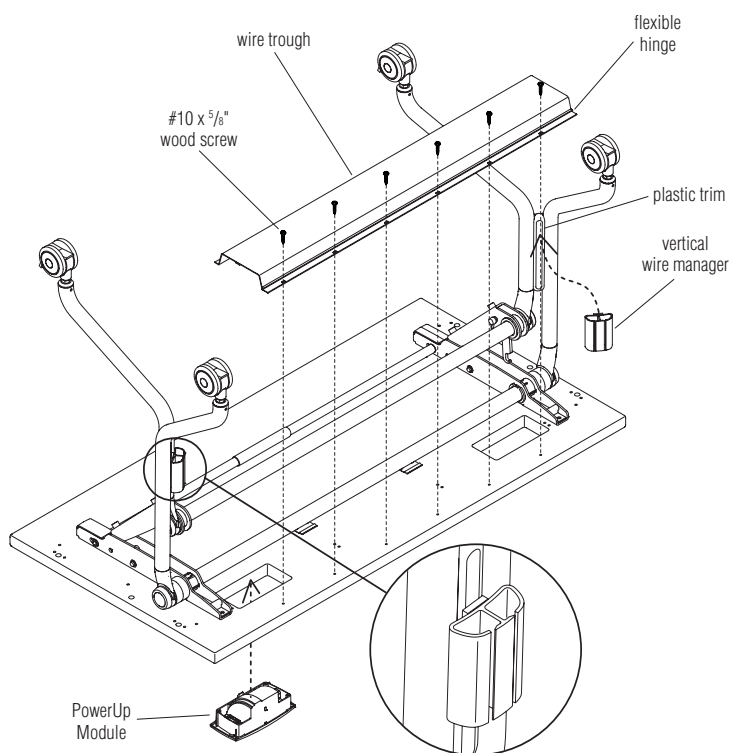
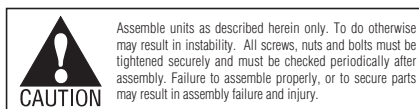

Figure 2



Note: On 24" wide tables step 2 (Figure 1) must be performed prior to assembling the table frame. On all other tables these steps may be performed after frame installation.

1. Carefully place table top face down on a soft protective surface. Two people may be required to handle the worksurface.
2. Attach trough clips to underside of worksurface using two #10 x 5/8" screws for each clip (Figure 1).
3. Lift worksurface and orient front of PowerUp module(s) toward the user side of the worksurface. Install module(s) into available grommet cutouts in worksurface (Figure 2).
4. Position the wire trough to underside of worksurface and slide the non-mounting edge under trough clips. A flat screwdriver may be required to adjust clip for proper fit. Align mounting holes of trough with pre-drilled holes in worksurface and secure wire trough using #10 x 5/8" wood screws along the back, "flexible hinge" edge of the trough as illustrated (Figure 2).
5. To install each vertical (leg) wire manager, first remove the protective paper backing to expose the adhesive surface.
6. Locate the plastic trim at the rear of the table leg. Position the wire manager in the center of the leg trim and apply firm pressure to allow adhesive to set. Repeat for other leg if desired (Figure 2).
7. Allow 24 hours for adhesive to cure before routing wires and cables through a wire manager.

