

Disassembly Instructions

Hurry Up! Tables

Material Type: A . Steel B. Wood / Particle Board C. Plastic D. Zinc

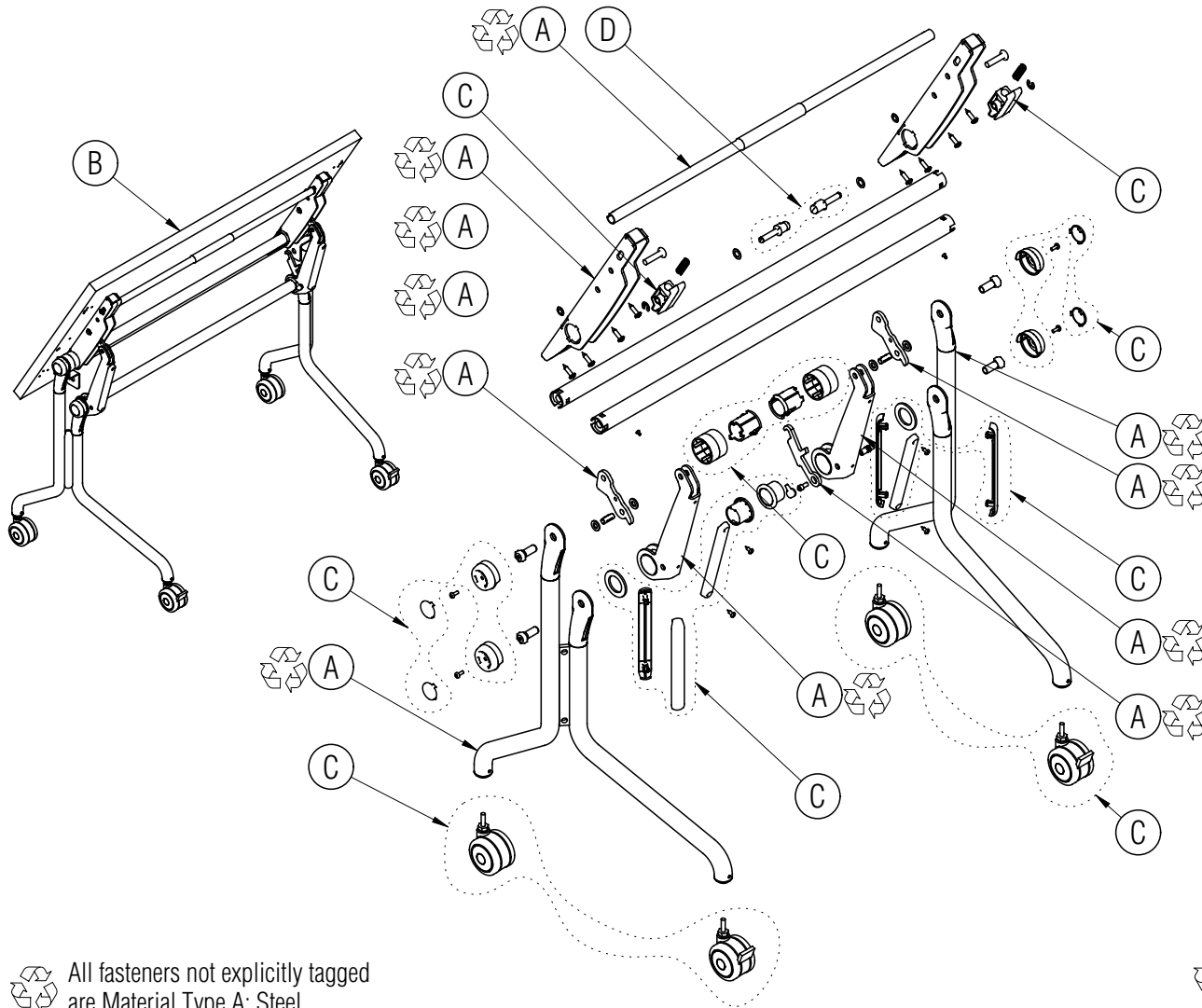

All fasteners not explicitly tagged are Material Type A: Steel

Procedure:

1. Remove the screws holding the legs to the table top and remove the top.
2. Remove the casters from each leg.
3. Remove the trim caps on the ends of the tie rods and remove the caps and bolts holding the rods to each leg.
4. Pry off the trim from each leg.
5. Remove snap rings to separate the locking mechanisms from the legs.
6. Drive out the pin holding the swing arm catch in each top support bracket.
7. Remove the screws holding the trim pieces to the top support brackets and remove the trim.

General Notes:

1. Disassembly time: 30-40 minutes
2. This procedure assumes basic familiarity with hand tools and furniture terminology: no specialized training is required
3. All materials removed and disassembled shall be sorted and segregated with like materials and disposed of or recycled according to recycling availability or waste acceptance
4. For items to be recycled, refer to KI's End of Life Recycling Matrix and KI's End of Life Recovery Options Matrix, available at www.ki.com

Required Tools



Gloves



Safety Glasses

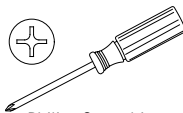

Philips Screwdriver



Hex Socket Wrench

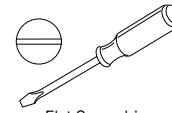

Flat Screwdriver



Drift Punch

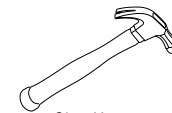

Claw Hammer

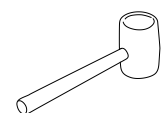

Rubber Mallet