



Detailing guide for senior living facilities

Creating an integrated system with Altro flooring and wall cladding is an ideal solution for areas in which hygiene and water resistance are a top concern. Within the senior living market these areas may include showers, nurse-assisted bathing areas, commercial kitchens, medical rooms and indoor swimming facilities. Proper installation techniques are critical in these areas, which is why Altro products must be installed as per the instructions in this guide and the Altro installation guide. Failure to comply may void the limited product warranty.

Overview

Senior living is institutional by nature, and health codes tend to reinforce this. That's why designers are looking at performance benefits and high quality commercial installation techniques when choosing floor and wall finishes.

In this segment, the potential for injury and illness is very high, which is why proper detailing and transitions are sensitive and require a quality installation.

2014 Facilities Guidelines Institute Guidelines for Design and Construction of Residential Health, Care and Support Facilities

The new standard for residential facilities provides minimum recommendations for new construction and renovation of nursing homes, hospice facilities, assisted living facilities, independent living settings, adult day care facilities, wellness centers and outpatient rehabilitation centers.

Key points relating to installation techniques:

- To reduce Hospital-Acquired Infections, surfaces must be non-absorbent, non-porous and smooth
- Flooring surfaces shall provide smooth transitions between different flooring materials
- Flooring surfaces must be cleanable and wear resistant
- Slip resistant flooring required in bathing areas and rooms, ramps and entries
- Slip resistant flooring required in kitchens with all joints sealed
- Areas subject to wet cleaning methods should have homogeneous, heat-welded flooring with the material flash-coved.

Altro flooring to Altro wall cladding

Overlap joint method (preferred)

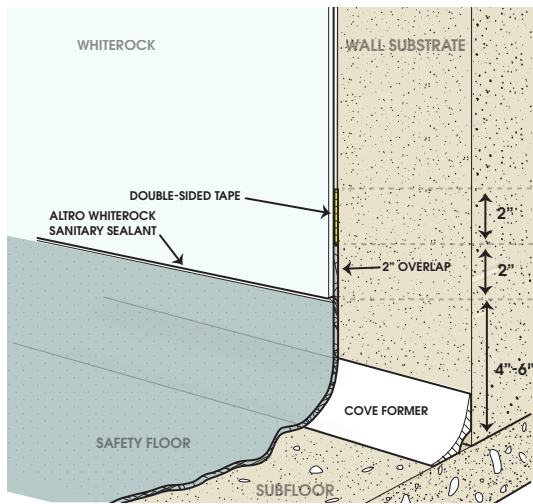

The preferred method of installing Altro flooring with Altro WhiteRock is the overlap joint method. This installation is made by using a cove former to run the safety flooring 6" - 8" up the wall. Altro WhiteRock is then overlapped 2" over the safety flooring. The overlap of the product ensures a complete seal from floor to wall transition and does not need to rely on heat welding to achieve that seal.

Heat welded joint method

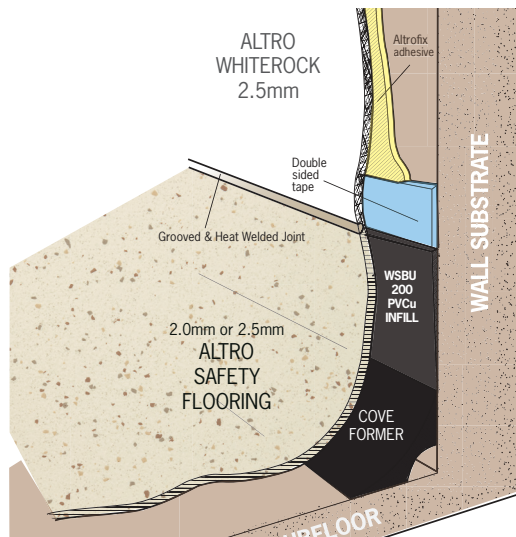

Occasionally a heat welded transition from floor to wall is necessary. In instances like these, use the heat welded joint method. This installation is done by installing Altro WhiteRock wall cladding first, with the bottom of the panel being 4" - 6" above the floor. Altro flooring is then installed using a cove former to run the material up the wall with a small amount of overage extending above the wall cladding. Using the wall cladding as a cutting guide, the extra flooring is trimmed away and then heat welded with the wall cladding. This installation method is more labor intensive and requires precision with the heat welding gun.

Cove methods

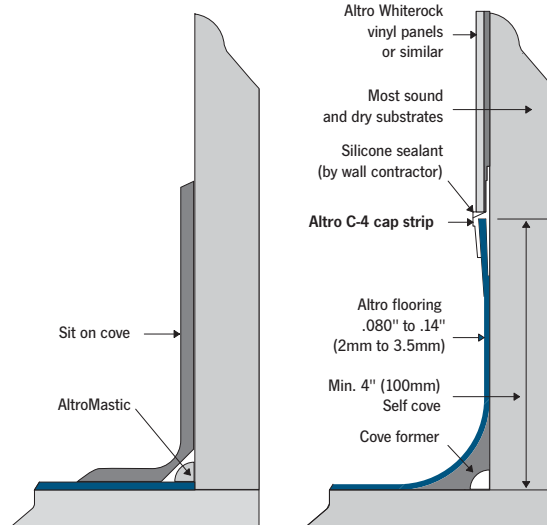

Sit on cove detail

C-4 detail

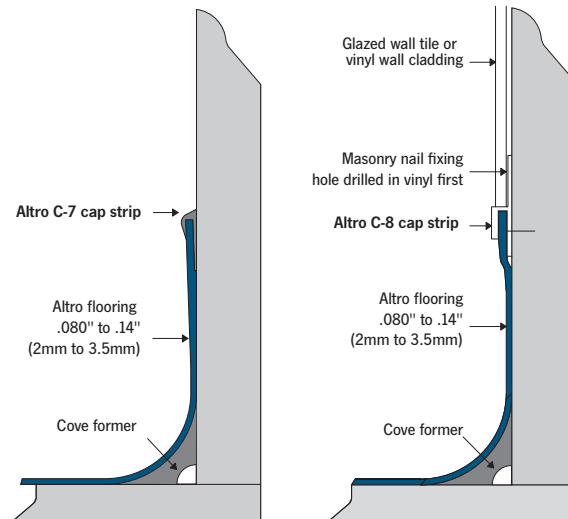

C-7 detail

C-8 detail

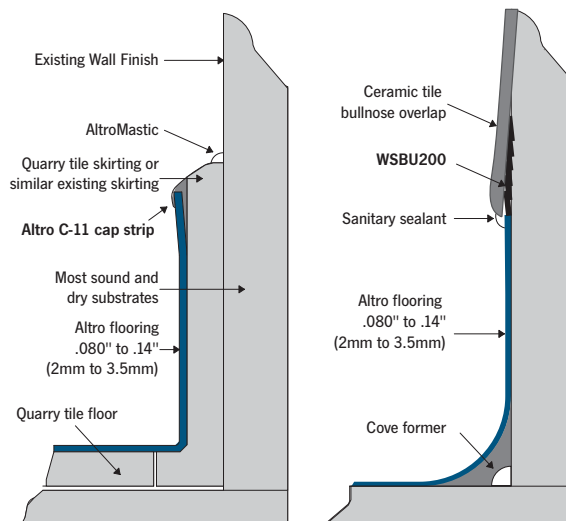

C-11 detail

Ceramic tile bullnose overlap detail

Capstrip and cove former details

Altro flooring installed with a C7 and C8 cap strips are pictured below. These strips are the most commonly used.

- C7 cap strips are used to finish your Altro flooring installation to dry wall (and no other wall finish is being installed).
- C8 cap strips are used when Altro flooring is being installed with a ceramic tile wall finish.
- C4 cap strips are available for installing Altro Whiterock in an alternative method. We still recommend the overlap method on the majority of installations.



Shower transition trim

Altro Aquarius to shower transition trim to sheet vinyl

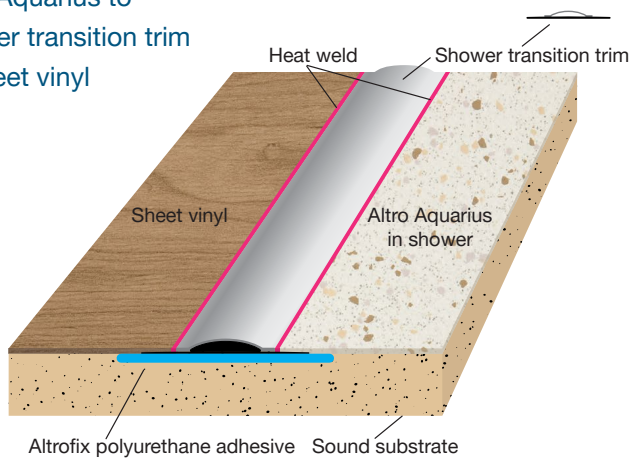

Flooring transitions

Sheet vinyl to other sheet vinyl transition

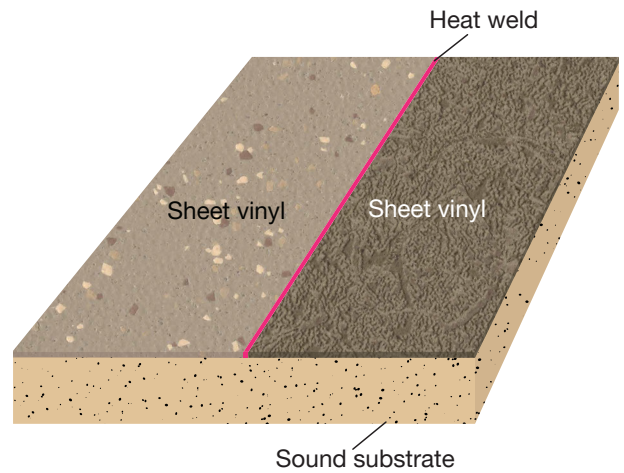

Sheet vinyl to LVT plank

C - PVC seam sealer (Lonseal Lonsealer, or equivalent)

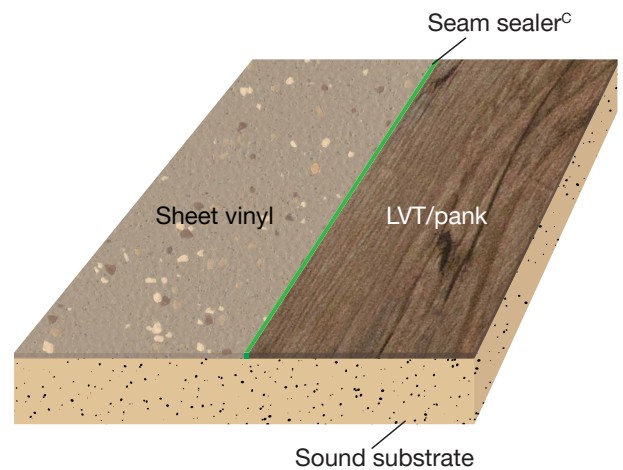

Carpet tile to sheet vinyl

A - Subfloor leveler system (Johnsonite® LS-40, or equivalent)

B - PVC cement (Oatey® heavy duty - clear, or equivalent)

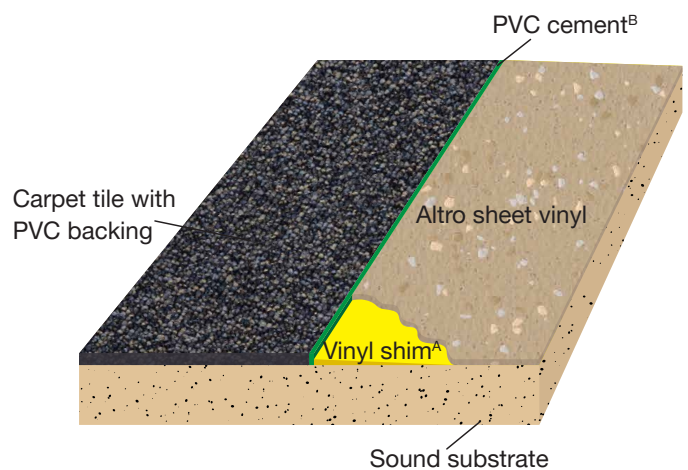

Drains

New round drains and cleanouts

Clamping drains are the best choice for proper installations, and the only choice for areas where water penetration concerns are a priority. These drains are readily available from plumbing supply distributors. They may be installed at time of concrete placement or retrofitted. They are screw on and height adjustable. They come in a variety of drainage pipe diameters and cover sizes. We prefer the larger cover sizes.

The following are acceptable drains:

Zurn Z 400 H – 6/9H, Wade 110 – FC6/9, Mifab F1100 – FC

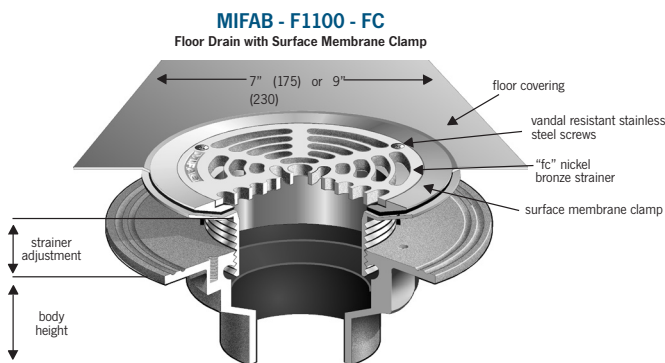

Sample of an approved clamping drain

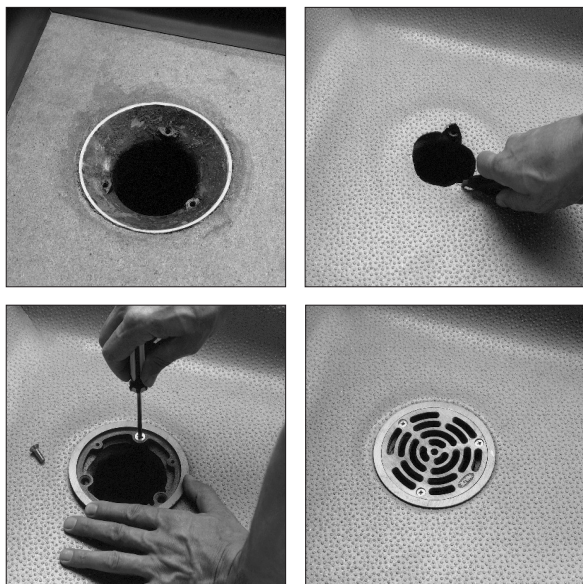

Note: In most cases, it will be necessary to weigh down the drain area to allow the Altrofix 30 two-part adhesive to setup.

Caution: Failure to weigh down the drain area during this process may cause a bubble or a pucker in the Altro floor covering, to which there is no remedy.

Full installation details available on altro.com

Modifying an Existing Drain

- Remove the drain cover plate.
- With a quality cementitious patching compound, finish the subfloor flush with the drain perimeter.

Note: If drain body is higher than the concrete surface, it must be either ground-off or chipped out and lowered. If the drain body is lower than the concrete surface, you must slightly grind the concrete surface to allow for a slight slope-to-drain profile.

- Using a small hand held electric grinder, remove the square shoulder on the inside edge of the drain body to create a 45-degree slope into the drain.

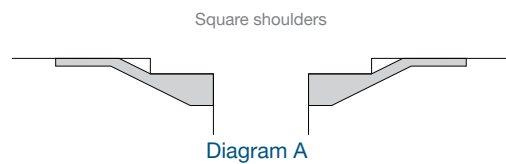

- Similarly, remove the square shoulder from the perimeter of the back side of the drain cover plate creating a 45-degree slope to match the drain body.



- Replace the cover plate screws for the purpose of land marking the screw holes and preventing the adhesive from filling the holes during the gluing process.

Gluing and Cutting Process

- Apply adhesive (Altrofix 30 two-part polyurethane or approved polyurethane adhesive) on the floor, around, and onto the sloped perimeter of the drain.
- Place the Altro floor covering over the drain, and fit cut only to the inside diameter of the drain plate screws. Note: Cutting to the outside of the screws will cause the material to be short of the drain plate once it is re-installed.
- Cut small windows in the Altro floor covering at the drain plate screws only.
- After all final fitting is completed, warm material with a hot air blower and secure the drain plate cover in place. This process pinches the Altro floor covering between the drain body and the drain plate cover.

