

# Veil



inscape

# Create spaces that make life at work better.

## Smart Workspaces

### Delight Users

Thoughtful details keep users happy and productive.

### Empower Technology

Convenient, flexible access to technology and power makes it easy to share information.

### Foster Agility

Smart products let people easily customize and change their space.

### Design for Sustainability

Good choices matter – from beginning to end, and over again.





# Restore balance to the open plan.

Open plan offices may foster idea sharing but can make focus work difficult. The Veil collection can help soften the volume of sound and give open plan workers the option to control their space, allowing them to adjust their level of acoustic and visual privacy to suit their work style and as their needs for concentration and collaboration shift.



# Cloak helps find the balance between personal space vs. shared space.

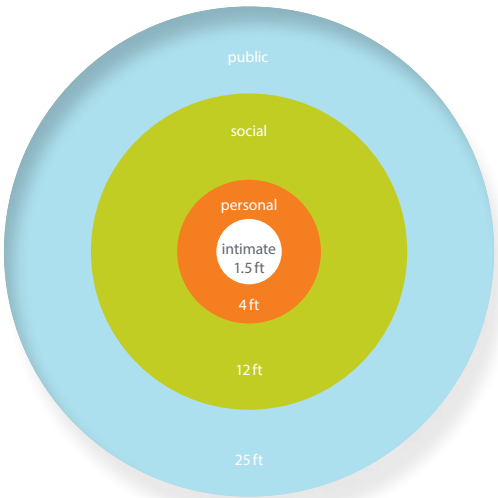

Cloak

Cloak wraps around the back of a chair to create a cocoon of visual and acoustic privacy, defining intimate space. A simple adjustment of the wings empowers users to control their privacy. Cloak's soft surface reduces sound, defines space and adds visual interest.



Wave

Simple space division with Wave to reflect noise in the office environment with its convex and concave design.





seam detail

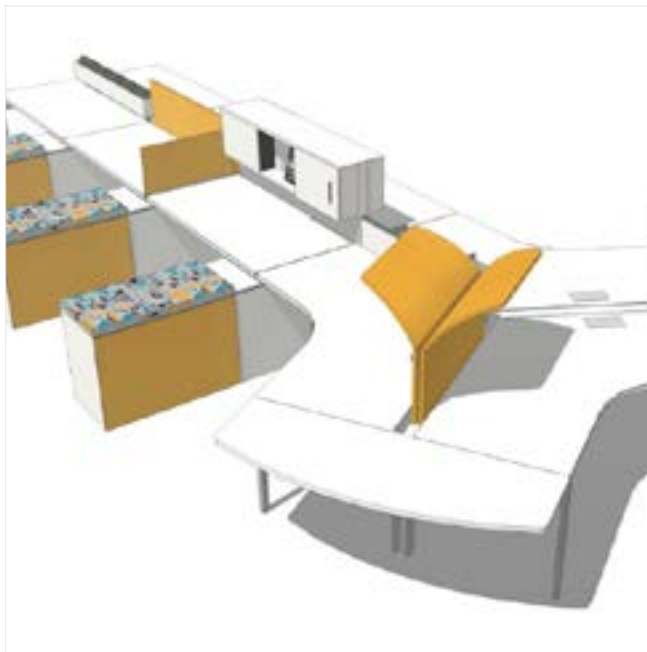

Cove

Cove is a privacy screen that helps people to focus in open environments. Ideal for benching applications, Cove mounts to the worksurface, and slides for easy movement and placement. Not only does it provide visual privacy from distraction and a tackable surface, acoustics are addressed in the smartly engineered curvilinear design. Acoustical material used in construction diffuses the amount of sound energy being absorbed and attenuates airborne sound.

Mask

Mask transforms storage into soft surfaces to help absorb sound in the open plan. This fabric panel is magnetized to mount to any storage unit, masking metal surfaces and acting as a design element in the space.



Pivot

Pivot is a privacy solution for Interval, Inscape's post & beam solution. Mounted from the underside of the Interval beam and secured to the floor, Pivot's 360° rotating fabric partitions not only define the space, but help to absorb sound and limit visual distractions.



Ease

Ease is lounge seating that integrates with the Cloak screen or can be situated as stand alone pieces to create various meeting hubs. Ease can be easily moved and rearranged to meet immediate needs.





# A responsible choice



The Veil Collection is made from sustainable materials.

- FSC-certified wood
- 90% post-recycled content core
- Renewable wool or 100% recycled polyester fabrics
- Manufactured and assembled locally
- 90% of material recyclable
- Designed for easy disassembly at the end of life

# Product Map

Cloak (freestanding screen)

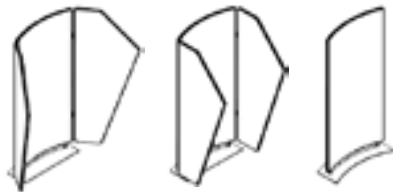

Cove (benching screen)



Mask (fabric storage panel)



Pivot (Interval+ accessory)

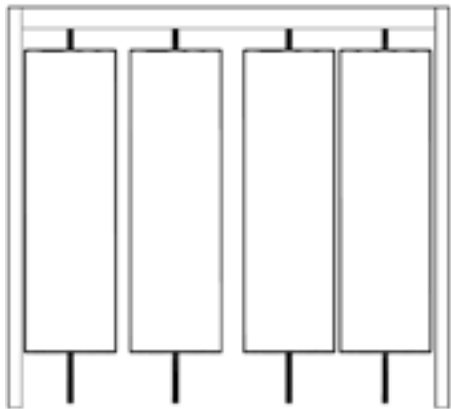

Ease (seat and ottoman)



# Veil

## designed by

David Parshad, Inscape Studio

### Delight Users

Allows open plan workers to adjust their level of acoustic and visual privacy to suit their work style and needs.

### Empower Technology

Stay focused and block out distraction to make the most of the technology we rely on.

### Foster Agility

User controlled, movable and adjustable.

### Design for Sustainability

Made with steel and eco-fabrics for high recycled content. Use across many applications today and tomorrow – reusable.

The logo for Inscape, featuring the word "inscape" in a bold, lowercase, sans-serif font. The letters are dark grey, and the "i" and "s" are slightly larger than the other letters.

[inscapesolutions.com](https://inscapesolutions.com)