

C4S

SERPENTINE LED LINEAR COVE LIGHTING, MID-POWER
REMOTE POWER SYSTEM



APPLICATION

C4S LED linear lighting produces uniform illumination designed to accent and highlight spaces featuring curves and corners, such as coves and soffits. The 6" articulating modules pivot smoothly up to 90 degrees for seamless illumination along curvilinear segments. Designed with modular CLiP[®] (Configurable Lighting Platform), C4S provides options to suit multiple application requirements.

CONSTRUCTION

- Thermally optimized die cast aluminum housing
- Unique sliding expansion link can expand luminaire up to 1" in length per foot maintaining even light and providing field adjustability
- Ability to articulate 90°+ while maintaining uniform distribution
- Modular design allows for simple field service of 6" units
- Sections quick connect together to form extended runs
- CSA damp location listed

OPTICS / LENS / DIFFUSER

- Convex, lightly frosted lens

POWER SYSTEM

- Utilizes remote, low voltage (12V) DC power supply
- Dimming control options include 0-10 Volt or Lutron Triac

PERFORMANCE

- Light output of 420 lm/ft (nominal)
- Operating temperature range of -20°C to 50°C
- Rated for a minimum of 86,000 hours (L85) at 25°C ambient operating temperature
- Power Supply Total Harmonic Distortion <20%, Power Factor >0.9

LIGHT CHARACTERISTICS

- Available in 2700K, 3000K, 3500K, 4000K.
- Typical CRI of 80+, 90+ CRI option available with 2700K, 3000K and 3500K selection
- LED's are selected and placed on the printed circuit boards via Tempo Industries' UniBin[™] process which ensures consistent hue and color within the entire run. Color variations are held to a minimum, within a 2-step MacAdam ellipse.

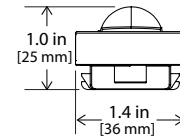

WARRANTY

Tempo provides a 5-year limited warranty.



PERFORMANCE SUMMARY All data nominal. 3500K test data shown.

| | |
|-------------|-----|
| Watts/ft | 4.8 |
| Lumens/ft | 420 |
| Lumens/Watt | 88 |

C4S

SERPENTINE LED LINEAR COVE LIGHTING, MID-POWER
REMOTE POWER SYSTEM

ORDERING INFORMATION

Example: 25ft C4S00-12-1006-48ST27S-NA

25 feet of C4R, 12" increments, convex lightly-frosted lens, 6" O.C., 4.8 W/ft DC, Std LED Spacing, 2700K, Std UniBin, Natural Anodized

| | C4 | S | 0 | 0 | 12 | 10 | 06 | 48 | ST | | | | | | |
|-----------------------------|----------|--------------|---------|-------------|-----------------------|----------------------------|----------------|-------------|-----------------------|--|--|---|--|--|--|
| Length in Feet ¹ | PLATFORM | | | | PERFORMANCE | | | | LIGHT CHARACTERISTICS | | | | | | |
| | Series | Platform | Profile | Type | Increment Length | Optic/Lens/Diffuser | Module Spacing | Watts/Foot | LED Spacing | Color Temp | Attribute | Finish | | | |
| | C4 | S Serpentine | 0 Rect. | 0 Symmetric | 12 12" base increment | 10 Convex, lightly frosted | 06 6" O.C. | 48 4.8 (DC) | ST Standard | 27 2700K 30 3000K 35 3500K 40 4000K | S Standard UniBin C High CRI (90+) 2700K, 3000K, 3500K only | NA Natural Anodized (Std.) SPL Special Color - Consult Factory | | | |

NOTES:

(1) Total ordered length may be specified in 0.5ft increments (EXAMPLE 27.5ft). Unless otherwise specified, Tempo will determine the section lengths of shipped product to comprise the total length, up to a maximum section length of 8ft (EXAMPLE: 30ft of ordered product may ship as (6) 5ft sections or (3) 8ft and (1) 6ft section, etc.)

C4S

SERPENTINE LED LINEAR COVE LIGHTING, MID-POWER
REMOTE POWER SYSTEM

SYSTEM INTEGRATION ACCESSORIES

| POWER SUPPLIES - 12V Output for Standard LED Spacing | | | Max Run Length |
|---|--|--|----------------|
| Require approved enclosure (by others) in close proximity to luminaire. Consult factory for guidance. | | | 4.8 W/ft |
| PWR-120-EL-040-T | 120V AC Input, 12V DC Output, 40W, Triac Dimming Lutron Hi-lume 1% 2-wire LED driver (120V forward phase) -LTEA2W | | 8 ft |
| PWR-UNV-EL-060 | 120-277V AC Input, 12V DC Output, 60W, Non-Dimming | | 12 ft |
| PWR-UNV-EL-060-Z | 120-277V AC Input, 12V DC Output, 60W, 0-10V Dimming | | 12 ft |

| SURGE SUPPRESSION DEVICE | | |
|--|---------------------|--|
| A Tempo furnished surge suppression device must be installed on each supplying branch circuit to comply with Tempo's 5-year warranty terms | | |
| SSD-120 | 120V Branch Circuit | |
| SSD-277 | 277V Branch Circuit | |

| POWER FEED CABLES Additional lengths available, contact factory | | |
|---|----------------------------------|--|
| PFC3-F-12-36 | Female Connector, 12V, 36 inches | |
| PFC3-M-12-36 | Male Connector, 12V 36 inches | |

| JUMPER FEED CABLES Additional lengths available, contact factory | | |
|--|---|--|
| JFC3-FF-12-18 | Female/Female Connector, 12V, 18 inches | |
| JFC3-MF-12-18 | Male/Female, 12V, 18 inches | |
| JFC3-MM-12-18 | Male/Male, 12V, 18 inches | |

| MOUNTING HARDWARE | | |
|-------------------------|---------------------------------------|--|
| C4A-MTGBRKT | Surface Mount Bracket | |
| C4A-MTGBRKT-SURF | Surface Mount Bracket with Screw Ears | |
| C4A-MTGBRKT-COVE | Front Cove Mount | |

C4S

SERPENTINE LED LINEAR COVE LIGHTING, MID-POWER
REMOTE POWER SYSTEM

DIMENSIONAL INFORMATION

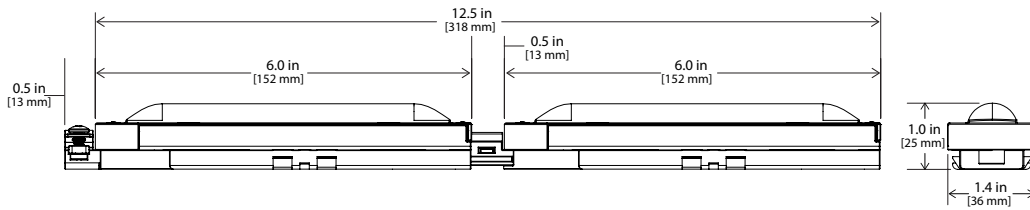

TEMPO EXCLUSIVE EXPANSION LINK

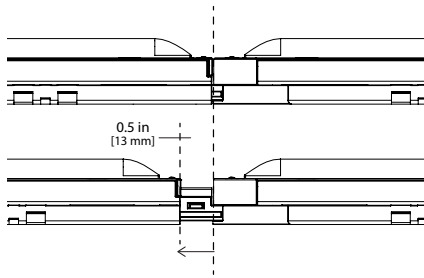

Tempo's exclusive adjustable length allows for 1/2" per module extension to fit perfectly into an application with no noticeable affect on light uniformity.

MOUNTING HARDWARE

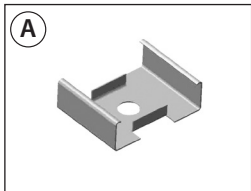

C4A-MTGBRKT
SURFACE MOUNT

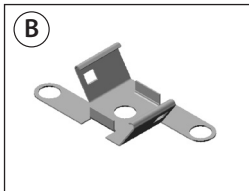

C4A-MTGBRKT-SURF
SURFACE MOUNT W/ SCREW
MOUNTING EARS

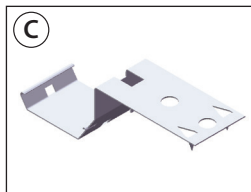

C4A-MTGBRKT-COVE
COVE MOUNT

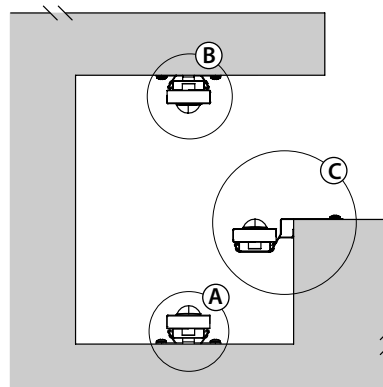

Tempo Industries reserves the right to change materials or modify the design of its product without notification as part of the company's continuing product improvement program. Please consult www.tempolc.com for the most up-to-date specifications and technical data.