

206H/208H 2" CEILING ADJUSTMENTS INSTALLATION INSTRUCTIONS

WARNING: Before proceeding, read all instructions carefully to insure proper and safe installation.

WARNING: Risk of fire or electrical shock. Disconnect power before installing or servicing.

WARNING: Risk of electrical shock. High temperatures inside luminaire. Make certain line voltage corresponds with ballast's primary voltage. (See ballast label).

WARNING: All wiring to be performed per National Electrical Code and local code by a qualified electrician.

IMPORTANT - When lamping, always wear eye protection. Make sure area below fixture is clear.

Note: If lamp is installed dirty, operating hours and performance will significantly decrease.

IMPORTANT: Not every unit is identical! Placement of proper luminaire section (by length, emergency option, etc.) within each row is important. Refer to layout drawing to verify row identification, product location, and feed points!

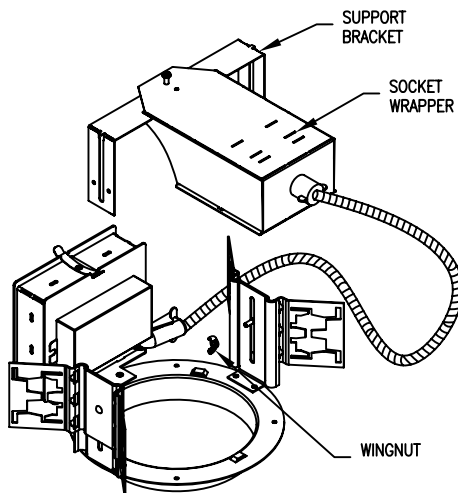

1.) REMOVE SUPPORT BRACKET AND SOCKET WRAPPER BY REMOVING WINGNUTS.

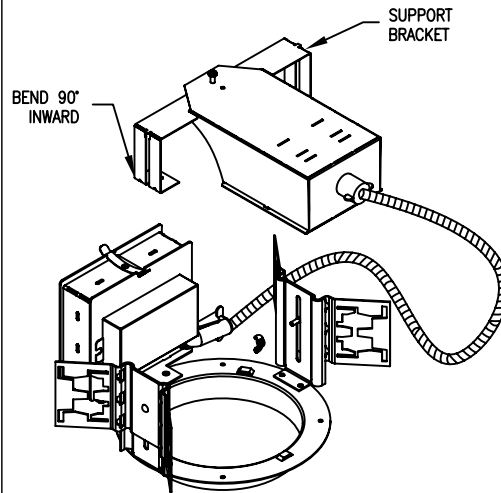

2.) BEND ENDS OF SUPPORT BRACKET 90° AT HOLES INWARD TO SHORTEN BRACKET HEIGHT.

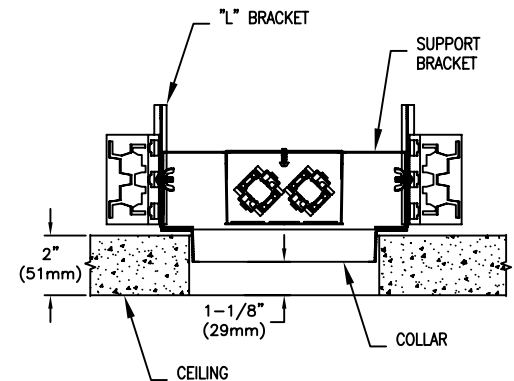

3.) REASSEMBLY SUPPORT BRACKET INSIDE "L" BRACKETS AND REPLACE WINGNUTS. ADJUST COLLAR HEIGHT TO 1-1/8" (29mm) TO EDGE OF OPENING. TIGHTEN WINGNUTS TO SECURE ASSEMBLY IN PLACE.



LSI INDUSTRIES INC.
10000 Alliance Road
Cincinnati, Ohio 45242
(513)793-3200 Fax (513)793-0147
www.lsi-industries.com

A Company with a *Smart Vision*

Installation Questions?
Call LSI Field Service Department at:
1-800-436-7800 Ext. 3300 Fax 877-861-1368