

ONE OR TWO LAMP STRIP (T8)

S

PRODUCT HIGHLIGHTS

- Flip up sockets make installation a snap and reduces installation costs
- Alignment couplers furnished for continuous row installation
- Channel cover equipped with quarter-turn, captive fasteners for easy access to ballast compartment
- Accepts iotuibak okyf-in wiring feature for continuous row installation

CONSTRUCTION - Fixture housing, lampholder brackets, end sections and channel cover constructed of code-gauge, die-formed steel.

ELECTRICAL - All devices UL/CUL listed. Suitable for damp locations. Damp location emergency pack must be specified separately. Ballasts are energy-saving solid-state electronic. Ballasts and lampholders replaceable without removing from ceiling. Discrete voltage must be specified for emergency pack options when wired with flex.

FINISH - All surfaces are finished with a high reflectance, lighting fixture white polyester powder.

LISTING - Listing to UL 1598 and other U.S. and Canadian safety standards.

PHOTOMETRICS - Please visit our web site at www.lsi-industries.com for detailed photometric data.



DIMENSIONS

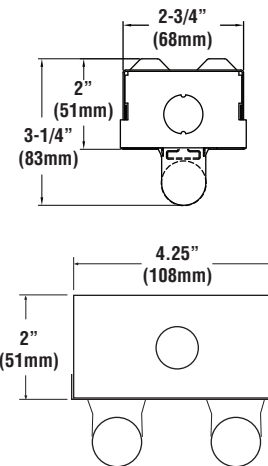

ARRA
Funding Compliant

ORDERING INFORMATION

TYPICAL ORDER EXAMPLE: **S 2 32 SS010 EM UE**

Prefix	Lamps	Lamp Type	Ballasts	Options	Voltage
S	1 2	17 - 17W 24" 25 - 25W 36" 32 - 32W 48" Note: For tandem configurations suffix number above with "-2"	SSOD - T8 Dimming (specify type) SSOL - T8 Low Watt SSOHL - T8 High Ballast Factor SSOHLR - T8 Program Start High Ballast Factor SSOR - T8 Programmed Start SSO10 - T8 <10% THD Instant Start	EM - Emergency Pack ² EM14 - Emergency Pack - 1400 lumens PM - Pr-wired Plug-in Assembly (specify circuitry. See Options/Accessories Section)	120 - 120V 277 - 277V 347 - 347V UE - Universal Electronic (120-277V)

ACCESSORY ORDERING INFORMATION (Accessories are field installed)

Description	Order Number	Description	Order Number
Wire Guard - 4 foot (1 Lamp)	WG 140 ¹	Symmetrical Reflector 1 Lamp (specify unit)	SR14
Wire Guard - 4 foot (2 Lamp)	WG 240 ¹	Asymmetrical Reflector 1 Lamp (specify unit)	AR14
Grid Hanger	GH	Symmetrical Reflector 2 Lamp (specify unit)	F20232
Chain Hanger Set (36" length)	CHS	Asymmetrical Reflector 2 Lamp (specify unit)	AR24

1- 8ft. fixture requires 2 wire guards

2- Emergency battery pack option not available with 2' fixture,



Project Name _____ Fixture Type _____
Catalog # _____

11/29/16
© 2016
LSI INDUSTRIES INC.