

ENTERPRISE / INTREPID / LEXINGTON HSS

INSTALLATION INSTRUCTIONS

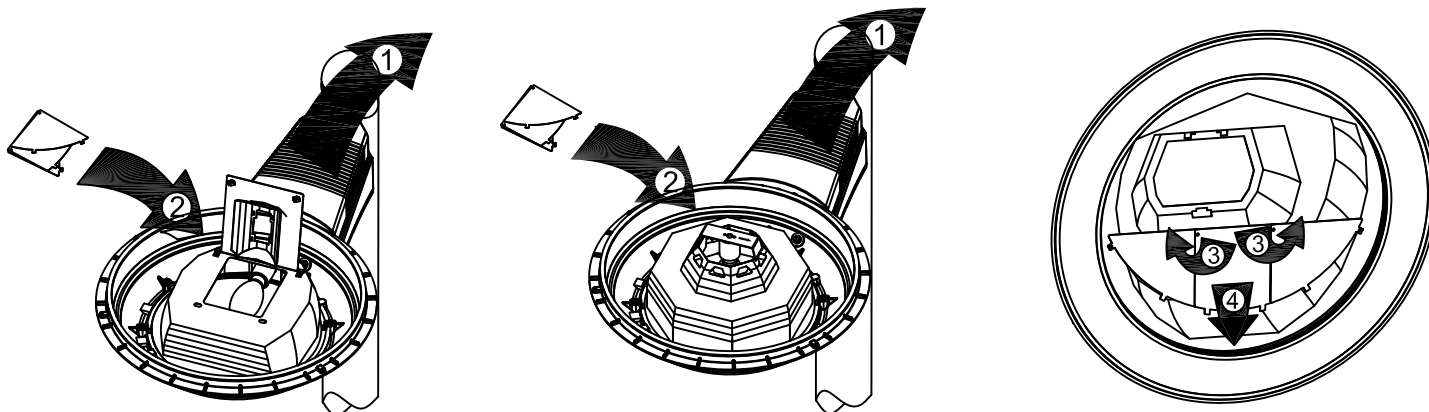

REFLECTOR MODULES SHOWING TYPICAL HSS INSTALLATION:

1. REMOVE FIXTURE TOP CAP SCREWS (3X). LIFT TOP CAP & SUSPEND FROM SAFETY CABLE. LIFT LAMP ACCESS COVER OR SOCKET BRACKET.
2. FOLD HSS AND INSERT INTO THE REFLECTOR THRU THE HOLE IN THE TOP OF REFLECTOR ASSEMBLY.
3. HOLD THE HSS CLOSE TO THE LENS AND UNFOLD THE SIDES UNTIL THE BACK EDGE IS STRAIGHT.
4. PUSH THE UNFOLDED HSS TOWARDS THE SIDE OF THE REFLECTOR WHERE LIGHT IS TO BE BLOCKED (HOUSE SIDE). INSERT THE TABS ON THE HSS BETWEEN THE LENS AND GASKET. CAREFULLY INSERT THE HSS UNTIL THE TABS ARE COMPLETELY UNDER THE LENS GASKET.
5. WIPE INSIDE OF LENS CLEAN. CLOSE RE-LAMP DOOR, OR RE-INSTALL SOCKET BRACKET. REPLACE TOP CAP, AND TIGHTEN TOP CAP SCREWS (3X) TO 15-20 IN-LBS TORQUE.

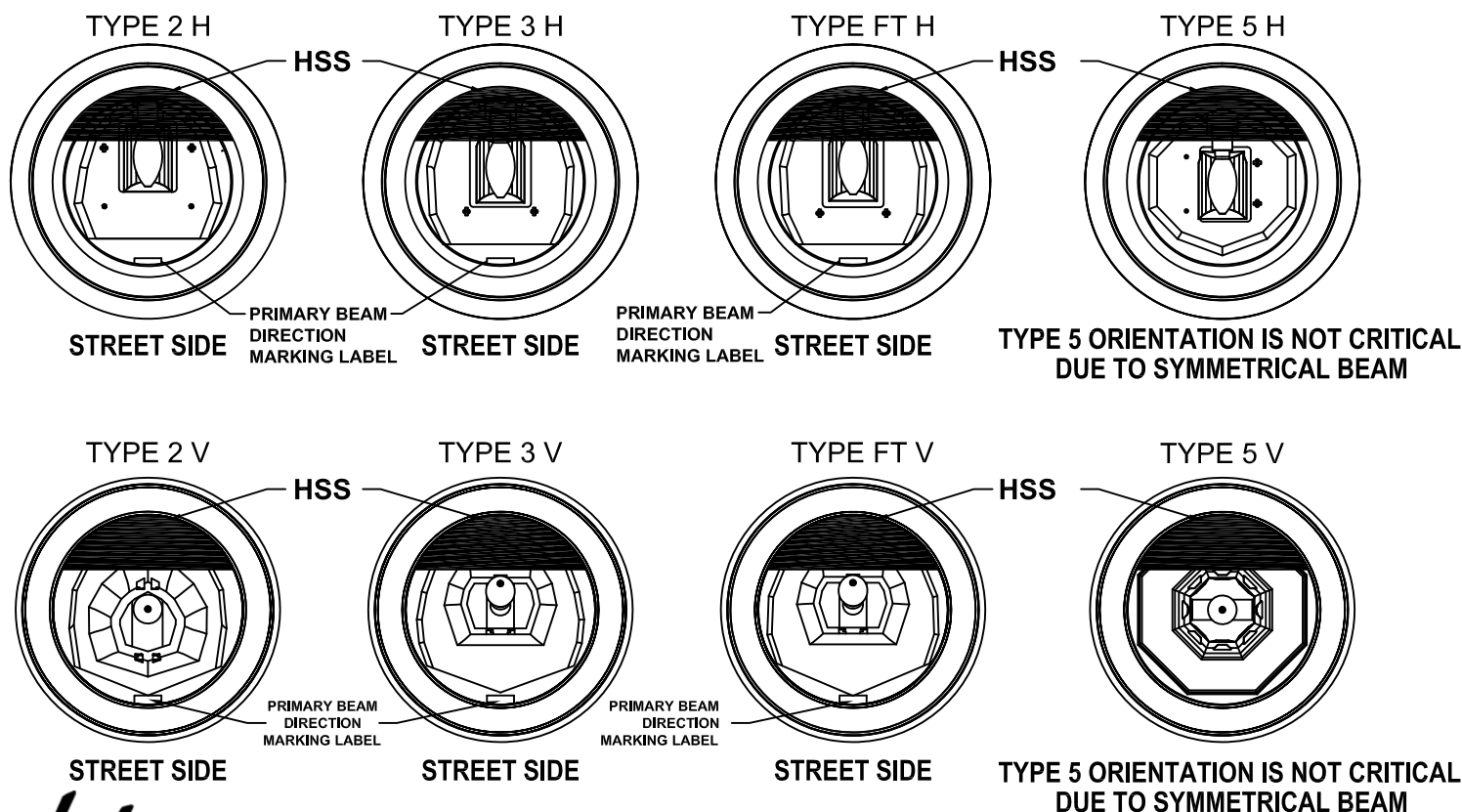

A Company with a *Smart Vision*

INSTALLATION QUESTIONS?
CALL LSI FIELD SERVICE
800-436-7800 EXT 3300
FAX 513-984-9723