

MIRADA WALL SCNCE (XWM)



DOE LIGHTING FACTS

Department of Energy has verified representative product test data and results in accordance with its Lighting Facts Program. Visit www.lightingfacts.com for specific catalog strings.

LIGHT OUTPUT - XWM - 3 5000K CCT

	Lumens	Wattage	LPW
03	3410	29	117
04	4417	40	111
06	6609	59	113
08	8610	82	105

LED Chips are frequently updated therefore values may increase.

COVERAGE DIAGRAM

SIDE VIEW

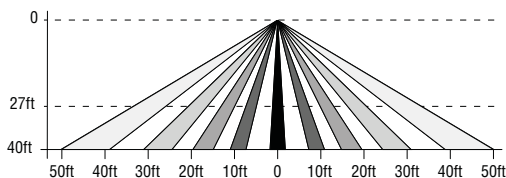

TOP VIEW

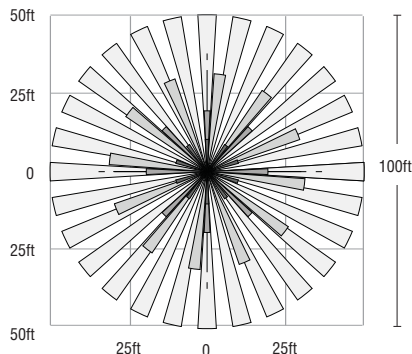

US & Int'l. patents pending

SMARTTEC™ -LSI drivers feature integral sensor which reduces drive current, when ambient temperatures exceed rated temperature

ENERGY SAVING CONTROL OPTIONS - DIM - 0-10 volt dimming enabled with LSI wireless controls.

OPTIONAL INTEGRAL MOTION SENSOR - Passive infrared motion sensor activates switching of luminaire light levels. High level light is activated when passersby enter target zone and increased to full bright in 1-2 seconds. Low light level (30% of maximum drive current) is activated when target zone is absent of motion activity for 5 minutes and is gradually ramped down (10 seconds) to low level. Sensor detection range 110° horizontal x 93° vertical x 10 meters maximum distance.

LEDS - Available with 5000K, 4000K or 3000K color temperature, 70 CRI min.

OPTICS/DISTRIBUTIONS - Ultra-high efficiency reflectors provide three distributions. Choose from Type 2, Type 3 or Type FT.

HOUSING - Three-piece die-cast aluminum housing is smoothly contoured low-profile shape. Mounting hardware is stainless steel or electro-zinc plated steel. Housing and optical unit are sealed with extruded silicone gasket; supply conductors with molded EPDM bushing.

OPTICAL UNIT - Proprietary silicone refractor optics provide exceptional coverage and uniformity. Pressure stabilizing breather allows super-tight protection while preventing cycling from building up internal pressures and vacuums that can stress optical unit seals

WALL MOUNTING - Galvanized-steel universal wall mounting plate easily mounts directly to 4" octagonal or square junction box. EPDM gasket is supplied to be installed between mounting plate and junction box, sealing junction box from entrance of water. Universal plate permits fixture to be mounted in uplighting (indoor only) or downlighting position.

ELECTRICAL - Two-stage surge protection (including separate surge protection built into electronic driver) meets IEEE C62.41.2-2002, Location Category C. Available with universal voltage power supply 120-277VAC (50/60Hz input) or 347-480VAC.

DRIVER - Drivers are dimming, standard. Components are fully encased in potting material for IP65 moisture resistance. Driver complies with IEC and FCC standards. Driver can be easily accessed.

EMERGENCY OPTIONS - Optional integral emergency battery-back-up options are available. BB option operates in 0°C to 60°C ambient temperature and CWBB operates in -20°C to 60°C ambient temperature. When primary AC power failure occurs, both options operate 10 LEDs for minimum of 90 minutes.

OPERATING TEMPERATURE - -40°C to +50°C (-40°F to +122°F)

FINISH - Fixtures are finished with LSI's DuraGrip® polyester powder coat finishing process. The DuraGrip finish withstands extreme weather changes without cracking or peeling.

WARRANTY - LSI LED fixtures carry a limited 5-year warranty.

PHOTOMETRICS - Please visit our web site at www.lsi-industries.com for detailed photometric data.

SHIPPING WEIGHT (in carton) - 30 lbs./13.6Kg

LISTING - UL listed to ANSI/UL1598, UL8750 and other U.S. and international safety standards. Suitable for wet locations in downlight position.

This product, or selected versions of this product, meet the standards listed below. Please consult factory for your specific requirements.



Project Name _____ Fixture Type _____
Catalog # _____

12/08/16

© 2016
LSI INDUSTRIES INC.

MIRADA WALL SCNCE (XWM)

LUMINAIRE ORDERING INFORMATION

TYPICAL ORDER EXAMPLE: **XWM FT LED 08 50 UE WHT IMS**

Prefix	Distribution	Light Source	Output ⁸	Color Temperature	Input Voltage	Finish	Optional Controls	Optional Sensor/Options
XWM - Mirada Wall Sconce	2 - Type 2 3 - Type 3 (Wide Throw) FT - Type 4 (Forward Throw)	LED	03 - 3,400 Lumens 04 - 4,400 Lumens 06 - 6,600 Lumens 08 - 8,600 Lumens	50 - 5000K 40 - 4000K 30 - 3000K	UE - Universal Voltage (120-277) HV - 347-480	BLK - Black BRZ - Bronze GPT - Graphite MSV - Metallic Silver PLP - Platinum Plus WHT - White	Wireless Control System^{1,2} (blank) - None PCM - Platinum Control System GCM - Gold Control System DIM - 0-10 volt dimming (required for satellite fixtures) Stand-Alone Control (blank) - None DIM - 0-10 volt dimming ³ (from external signal)	Sensor IMS - Integral Motion Sensor ^{4,7} Options BB - Battery Back-up ⁵ CWBB - Cold Weather Battery Back-up ⁵

ACCESSORY ORDERING INFORMATION ¹ (Accessories are field installed)			
Description	Order Number	Description	Order Number
XWM SW BLK - Surface Wiring Box (Available in black only)	356915BLK	DFK208 - Double Fusing	DFK208
FK120 - Single Fusing	FK120	DFK240 - Double Fusing	DFK240
FK277 - Single Fusing	FK277	DFK480 - Double Fusing	DFK480
FK347 - Single Fusing	FK347	IMS/PC Remote Configurator Tool ⁷	584929

FOOTNOTES:

- 1 - For wireless controls information and accessories, see Controls Section.
- 2 - Requires a SiteManager and override switch. Not compatible with battery back-up, IMS or HL Option.
- 3 - Not compatible with IMS Option
- 4 - Not compatible with DIM or Wireless Control System
- 5 - Not compatible with Wireless Control System
- 6 - Not available with BB, CWBB, IMS Option or Wireless Control System
- 7 - IMS is the WattStopper Dual Sensor (Daylight & Motion) which is field adjustable, via a handheld remote configurator tool*
- 8 - Output based on type 3 optics in cool white color temperature, see IES files for exact delivered lumens

DIMENSIONS

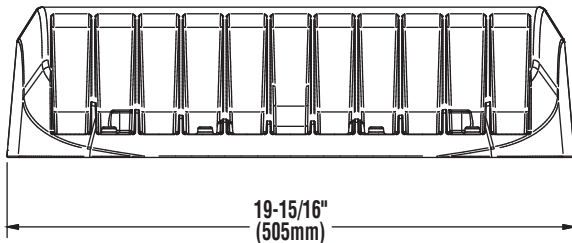
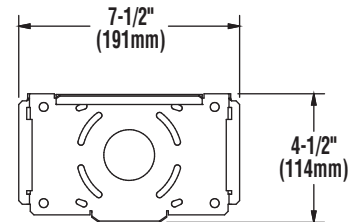
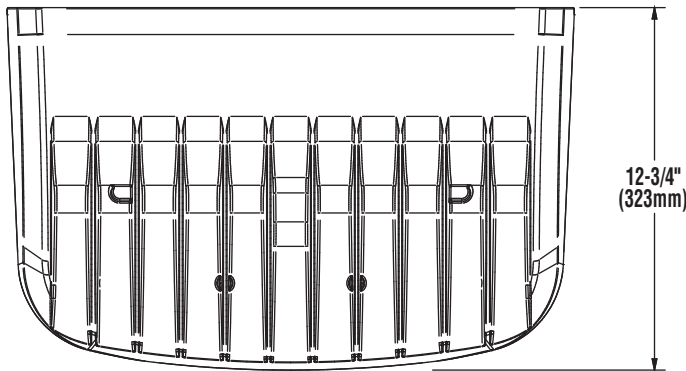

Project Name _____ Fixture Type _____
Catalog # _____

12/08/16
© 2016
LSI INDUSTRIES INC.