

XALV WC LINE VOLTAGE INSTALLATION INSTRUCTIONS

- WARNING:** BEFORE PROCEEDING, READ ALL INSTRUCTIONS CAREFULLY TO INSURE PROPER AND SAFE INSTALLATION.
- WARNING:** RISK OF FIRE OR ELECTRICAL SHOCK. DISCONNECT POWER BEFORE INSTALLING OR SERVICING.
- WARNING:** RISK OF ELECTRICAL SHOCK. HIGH TEMPERATURES INSIDE LUMINAIRE. MAKE CERTAIN LINE VOLTAGE CORRESPONDS WITH LED MODULE INPUT VOLTAGE MARKING LABEL. (SEE MODULE LABEL)
- WARNING:** ALL WIRING TO BE PERFORMED PER NATIONAL ELECTRICAL CODE AND LOCAL CODE BY A QUALIFIED ELECTRICIAN.
- IMPORTANT:** WHEN SERVICING, ALWAYS WEAR EYE PROTECTION. MAKE SURE AREA BELOW FIXTURE IS CLEAR.
- NOTE:** IF LED MODULE IS INSTALLED DIRTY, OPERATING HOURS AND PERFORMANCE WILL SIGNIFICANTLY DECREASE.
- NOTE:** WALL MOUNTING CONNECTIONS ARE TO BE MADE IN SUCH A MANNER SO AS TO EXCLUDE WATER FROM J-BOX.

WCU WALL MOUNTING

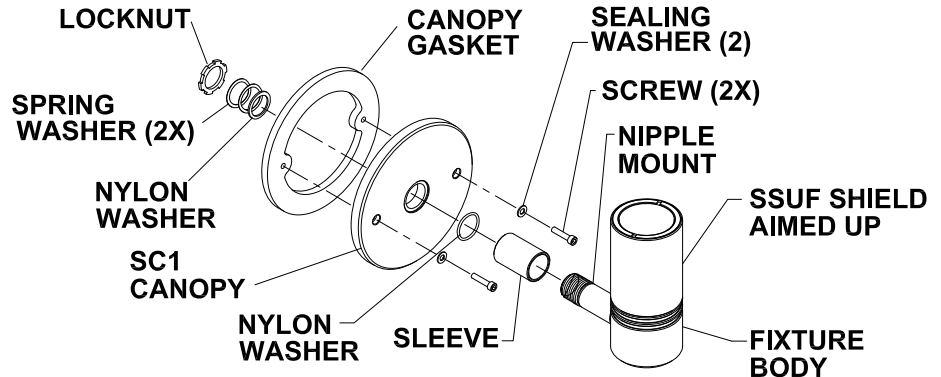

1. SLIDE SLEEVE & NYLON WASHER OVER LEADS & NIPPLE MOUNT AS SHOWN.
2. FEED FIXTURE LEADS & NIPPLE THRU CANOPY MOUNT HOLE & INSTALL LOCKNUT ON THE BACK SIDE OF THE CANOPY. ROTATE FIXTURE AS REQ'D & TIGHTEN LOCKNUT.
3. WCU SHOULD BE MOUNTED SO SSUF SHIELD (FLUSH LENS SHIELD) IS AIMED UP.
4. APPLY CANOPY GASKET TO BACK SIDE OF CANOPY, WIRE WITH CONNECTORS PER NEC & LOCAL CODES, AND ATTACH CANOPY TO JUNCTION BOX (BY OTHERS). IF J-BOX IS RECESSED INTO WALL, CAULKING AROUND CANOPY TO PREVENT WATER ENTRY INTO STRUCTURE IS REQUIRED.

WCD WALL MOUNTING

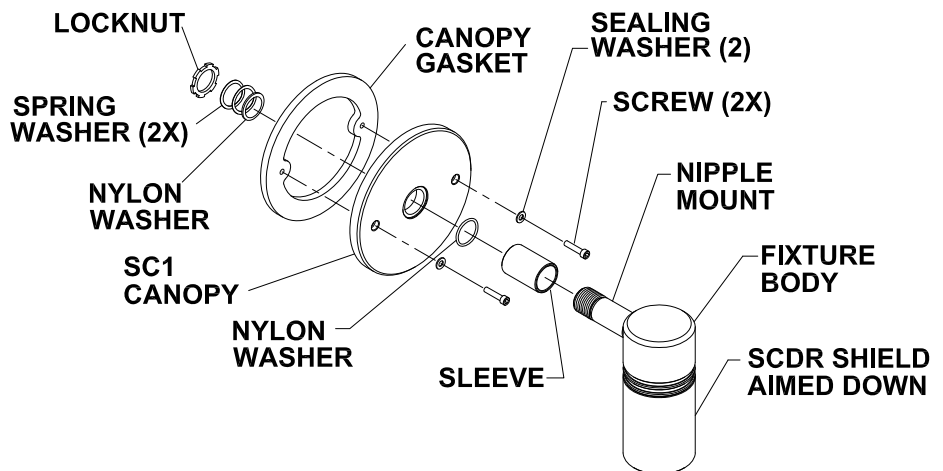

1. SLIDE SLEEVE & NYLON WASHER OVER LEADS & NIPPLE MOUNT AS SHOWN.
2. FEED FIXTURE LEADS & NIPPLE THRU CANOPY MOUNT HOLE & INSTALL LOCKNUT ON THE BACK SIDE OF THE CANOPY. ROTATE FIXTURE AS REQ'D & TIGHTEN LOCKNUT.
3. WCD SHOULD BE MOUNTED WITH SCDR SHIELD (COLLAR SHIELD) AIMED DOWN.
4. APPLY CANOPY GASKET TO BACK SIDE OF CANOPY, WIRE WITH CONNECTORS PER NEC & LOCAL CODES, AND ATTACH CANOPY TO JUNCTION BOX (BY OTHERS). IF J-BOX IS RECESSED INTO WALL, CAULKING AROUND CANOPY TO PREVENT WATER ENTRY INTO STRUCTURE IS REQUIRED.



INSTALLATION QUESTIONS?
CALL LSI FIELD SERVICE
800-436-7800 EXT 3300
FAX 513-984-9723

XALV WC LINE VOLTAGE INSTALLATION INSTRUCTIONS

WCC WALL MOUNTING

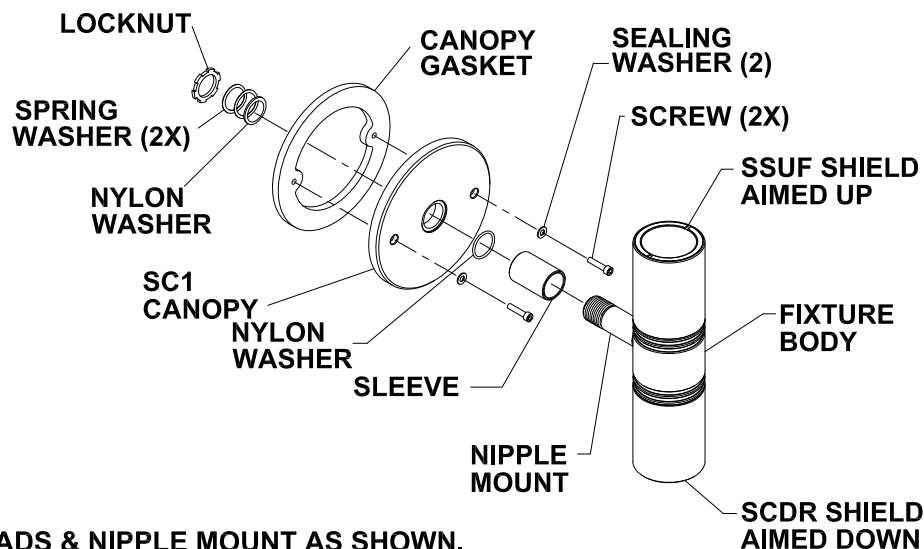

1. SLIDE SLEEVE & O-RING OVER LEADS & NIPPLE MOUNT AS SHOWN.
2. FEED FIXTURE LEADS & NIPPLE THRU CANOPY MOUNT HOLE & INSTALL LOCKNUT ON THE BACK SIDE OF CANOPY. ROTATE FIXTURE AS REQ'D & TIGHTEN LOCKNUT.
3. WCC SHOULD BE MOUNTED SO THAT SSUF SHIELD (FLUSH LENS SHIELD) IS AIMED UP, & SCDR SHIELD (COLLAR SHIELD) IS AIMED DOWN.
4. APPLY CANOPY GASKET TO BACK SIDE OF CANOPY, WIRE WITH CONNECTORS PER NEC & LOCAL CODES, AND ATTACH CANOPY TO JUNCTION BOX (BY OTHERS). IF J-BOX IS RECESSED INTO WALL, CAULKING AROUND CANOPY TO PREVENT WATER ENTRY INTO STRUCTURE IS REQUIRED.

LED MODULE SERVICE

WCU / LED20

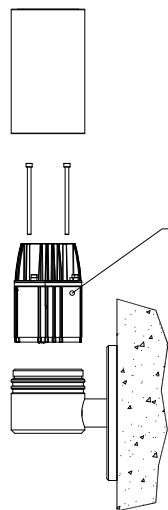

LED20 MODULE
LEVER SWITCH
ADJUST BRIGHTNESS

WCD / LED20

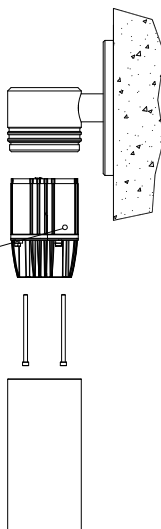

LED20 MODULE
LEVER SWITCH
ADJUST BRIGHTNESS

WCC / LED20

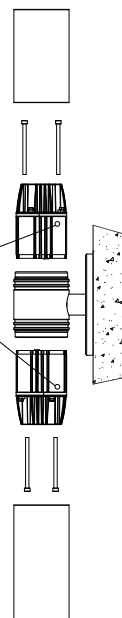

XALV WALL CYLINDER LED20 FIXTURE SERVICE

1. TURN OFF POWER BEFORE SERVICING!
2. REMOVE FIXTURE FROM WALL MOUNT J-BOX. REMOVE SHIELD BY ROTATING COUNTER CLOCK WISE TO ACCESS LED MODULE. REMOVE SCREWS RETAINING LED MODULE TO FIXTURE BODY.
3. REMOVE SILICONE WIREWAY SEAL BY SLIDING IT OFF OF THE FIXTURE LEADS.
4. LOOSEN GROUND WIRE RETAINING SCREW, AND RETAIN SCREW FOR REPLACEMENT.
5. PULL OLD MODULE UP & SLIDE LEADS OUT FROM WIREWAY.
6. REPLACE NEW MODULE BY ROUTING LEADS THRU WIREWAY, REPLACE GROUND & TIGHTEN, REPLACE WIREWAY SEAL, TIGHTEN LED MODULE RETAINING SCREWS, REPLACE SHIELD BY ROTATING CLOCKWISE UNTIL FULLY TIGHTENED. LUBRICATE SHIELD ORING SEAL WITH DOW CORNING 55 IF NEEDED
7. ADJUST LED20 MODULE BRIGHTNESS BETWEEN 100%, 80%, 55%, & 18% BY TOGGING LEVER SWITCH ON SIDE OF MODULE TO DESIRED BRIGHTNESS.