

Disassembly Instructions

Genius Architectural Wall Panel

Material Type: A . Steel B. Aluminum C. Plastic

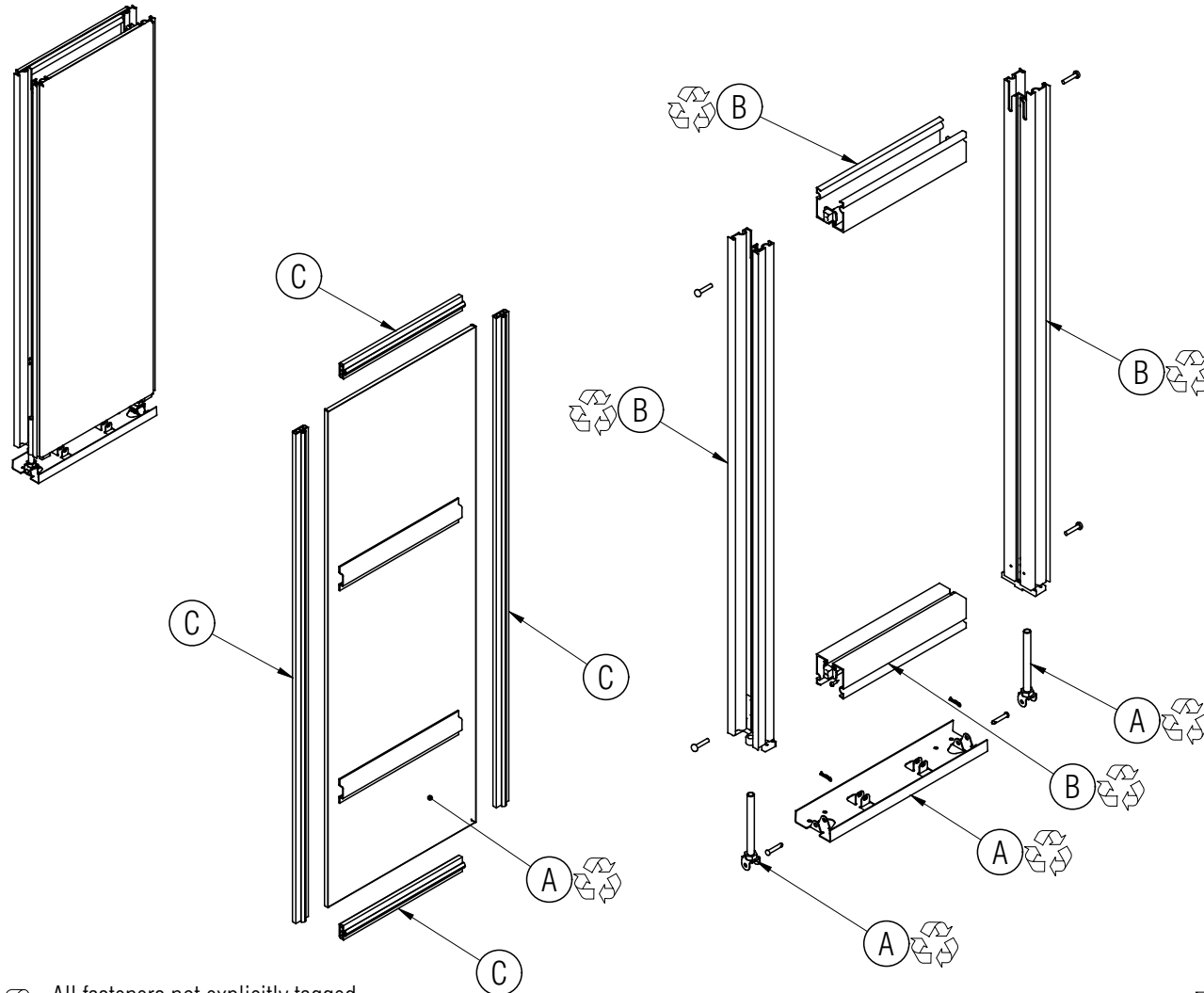

Procedure:

1. Pry off the panel shells from the frame. Remove the fiberglass insulation between the shells.
2. Strip the plastic mushroom connector strips from the back of each shell.
3. Remove the cotter pin from the clevis pin holding the leveling glide to the floor channel and pull out the clevis pin. Remove the leveling glide from each post.
4. Remove the screws holding the horizontal channels to the vertical posts and pull apart the frame.

General Notes:

1. Disassembly time: 10-15 minutes
2. This procedure assumes basic familiarity with hand tools and furniture terminology: no specialized training is required
3. All materials removed and disassembled shall be sorted and segregated with like materials and disposed of or recycled according to recycling availability or waste acceptance
4. For items to be recycled, refer to KI's End of Life Recycling Matrix and KI's End of Life Recovery Options Matrix, available at www.ki.com

All fasteners not explicitly tagged are Material Type A: Steel

Required Tools



Gloves



Safety Glasses

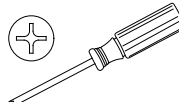

Phillips Screwdriver



Pry Bar

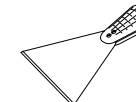

Putty Knife

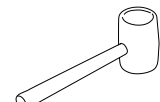

Rubber Mallet