

DESCRIPTION

The Fail-Safe CPI combines maximum security construction features with energy saving technology. This corner-mounted luminaire features a die-formed 20 ga. CRS housing containing no holes. UL/cUL listed, suitable for wet locations under covered ceilings. Constructed and manufactured for IP65 requirements.

Catalog #		Type
Project		
Comments		Date
Prepared by		

SPECIFICATION FEATURES

Housing

Die-formed 20 ga. CRS housing contains no holes. Polyester powder coat finish.

Fasteners

Flush-mounted, stainless steel machine screws.

Lens

One piece, clear, extruded lens with internal prism pattern. See Lens Options.

Lamps

By others.

Hinging

Two braided steel cables on one side of the door provide hinging.

Door

20 ga. CRS housing, cold rolled steel, fully gasketed door.

Ballast

Electronic Class P, CMB/ETL ballast.

Listings

UL/cUL listed for wet locations under covered ceiling.



MOUNTING DIMENSIONS

MOUNTING

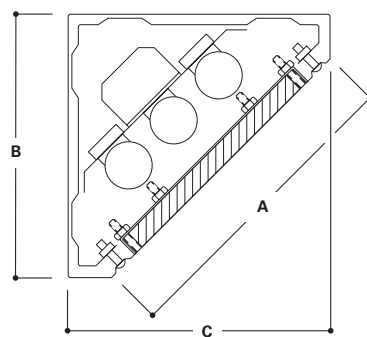
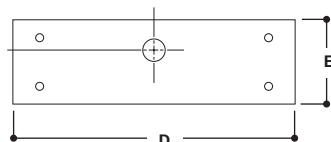

	A	B	C	D	E
2' Nom. Length	6 7/16" (164mm)	7 1/16" (179mm)	7 1/16" (179mm)	24" (610mm)	7 1/16" (179mm)
4' Nom. Length	6 7/16" (164mm)	7 1/16" (179mm)	7 1/16" (179mm)	48" (1219mm)	7 1/16" (179mm)

ORDERING INFORMATION

SAMPLE NUMBER: CPI-232-UNV-IK12-EB81

Series	Voltage	Lens Type	Door Finish Options
CPI=Fluorescent Corner Mount	120=120V 277=277V UNV=120V-277V	IK12=Pattern 12 Prismatic Acrylic, 0.125" thick IP12=Pattern 12 Prismatic Polycarbonate, 0.125" thick KSH25=Linear Ribbed Acrylic, 0.115" thick 93=Prismatic Tempered Glass, 0.156" thick	SSN=Stainless Steel, Brushed Finish SSP=Stainless Steel, Powder Coat Painted White
Lamp Type ²	4' Nominal Length	Ballasts	Options
2' Nominal Length 114=(1) 14W T5 Lamp 214=(2) 14W T5 Lamps 124=(1) 24W T5 Lamp 224=(2) 24W T5 Lamps 117=(1) 17W Lamp 217=(2) 17W Lamps 317=(3) 17W Lamps	128=(1) 28W T5 Lamp 128T8=(1) 28W T8 Lamp 228=(2) 28W T5 Lamps 228T8=(2) 28W T8 Lamps 328=(3) 28W T5 Lamps 328T8=(3) 28W T8 Lamps 154=(1) 54W T5HO Lamp 254=(2) 54W T5HO Lamps 354=(3) 54W T5HO Lamps 132=(1) 32W Lamp 232=(2) 32W Lamps 332=(3) 32W T8 Lamps	EB51= (1) Ballast for use with T5 lamp EB52= (2) Ballasts for use with T5 lamps ¹ EB81 = (1) Ballast for use with T8 lamp EB82 = (2) Ballasts for use with T8 lamps	EL4=EM Pack, T8, BX ² EL5=EM Pack, T5, T5HO ² GLR=Fuse and Holder SHN=Stainless Housing / Brushed Finish SHP=Stainless Housing / Polyester Finish

Notes:

- Cannot be used with 2' length fixtures.
- EM Pack not available with (2) T5 ballasts