

DESCRIPTION

Fail-Safe Changing Views Series is a new series of visual therapy luminaires by Eaton. Designed to bring warmth, ambience, and positive energy into a variety of environments, these luminaires help create a calming influence throughout any facility. Choose from a variety of images in the standard picture gallery to create single or multiple murals.

Catalog #		Type
Project		
Comments		Date
Prepared by		

SPECIFICATION FEATURES

Mounting

For use with standard NEMA Type G grid, 15/16", 1-1/2", or 2".

Materials

Constructed of 2x2 or 2x4 LED luminaire, a 1.75" deep grid riser, and an acrylic lens.

Lens

High quality acrylic photographic lens, 0.125" thick. Choose from 14 standard images (below), provide a custom digital image, or reference a readily available, non-proprietary public image.

LEDs

Nominal CRI = 85
4000K color temperature, 3400 initial lumens (2x2) and 6700 initial lumens (2x4)

Driver

Electronic, 0-10V standard.



CVEN

2' x 2'

2' x 4'

LED

Healthcare: Changing Views

RECESSED GRID

CVEN ENCV-IMAGE-SELECTION

TREE1



TREE3



TREE5



TREE2



TREE4



TREE6



FLWR1



FLWR2



FLWR3



CLOUD1



CLOUD2



CLOUD3



PALM1



PALM3



PALM2



PALM4

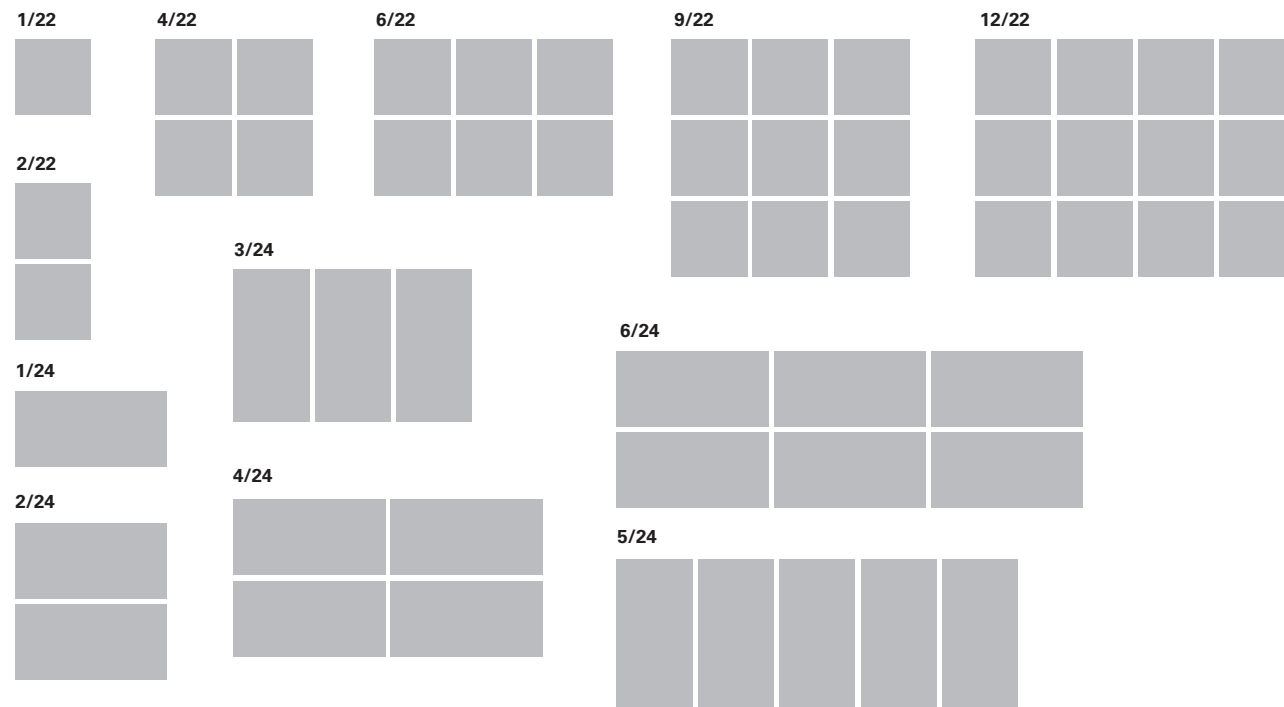

CONFIGURATION EXAMPLES

**Important Note:**

Configuration indicates quantity of fixtures. Only one catalog number per configuration is required.

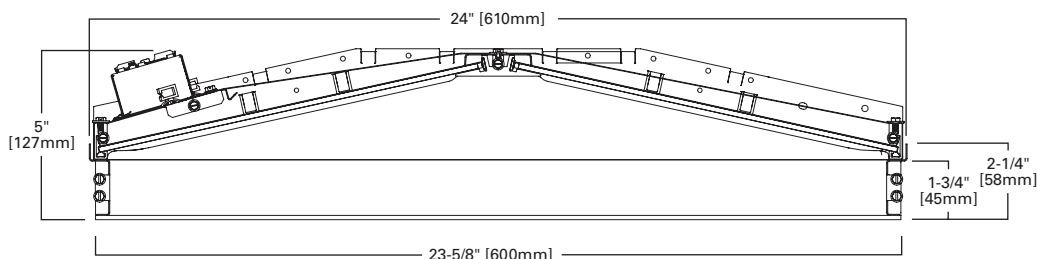

ORDERING INFORMATION

SAMPLE NUMBER: CVEN-24-4-LD2-UNV-EDC1-TREE1-4/22

CVEN	24	LD2					
Product Family CVEN=Encounter Changing Views			Voltage 120=120 277=277 UNV=120-277V		Image Number NI=No Image ¹ OPL=Opal/diffused Lens, 0.125" thick	Configuration (See Above) 1/22=(1) 2x2 2/22=(2) 2x2 4/22=(4) 2x2 6/22=(6) 2x2 9/22=(9) 2x2 12/22=(12) 2x2 1/24=(1) 2x4 2/24=(2) 2x4 3/24=(3) 2x4 4/24=(4) 2x4 5/24=(5) 2x4 6/24=(6) 2x4	Options EL7W=Emergency 2,3 Driver, 7W EL14W=Emergency 2,3 Driver, 14W
Width 24=24"					TREE1 TREE2 TREE3 TREE4 TREE5 TREE6 CLOUD1 CLOUD2 CLOUD3 PALM1 PALM2 PALM3 PALM4 FLWR1 FLWR2 FLWR3		Accessories (order separately) MSC4-PK =Mounting Security Clips. Use to secure fixture to grid or to attach tie-wires. DFCL-2448W-U =2' x 4' gasketed drywall framing kit. Ships with gasket to be applied in field. Cut out dimension 24.25" x 48.25" DFCL-2424W-U =2' x 2' gasketed drywall framing kit. Ships with gasket to be applied in field. Cut out dimension 24.25" x 24.25"
Length 2=2' 4=4'			Driver EDC1=Electronic Driver, Single Circuit, Non-Dimming EDD1=Electronic Driver, Single Circuit, 0-10V Dimming, 10% ED1D1=Electronic Driver, Single Circuit, 0-10V Dimming, 1% 5LTD1=Fifth Light DALI Driver, Dimming 1%				
LED Type LD2=LED Version 2.0							
Notes: 1. Changing View Luminaire ships with no lens attached. Luminaire will be an open Encounter, on a grid riser, 1 3/4" above the ceiling line. 2. Repositionable adhesive is used to secure fixture to lens. Separate the lens from the fixture to disengage the EZ Key. 3. Image lens must be removed to test emergency.							

Notes:

1. Changing View Luminaire ships with no lens attached. Luminaire will be an open Encounter, on a grid riser, 1 3/4" above the ceiling line.
2. Repositionable adhesive is used to secure fixture to lens. Separate the lens from the fixture to disengage the EZ Key.
3. Image lens must be removed to test emergency.