

## DESCRIPTION

6-inch LED recessed vandal resistant downlight specially designed for LED technology. Two-stage reflector system produces smooth distribution with excellent light control and low aperture brightness. Lumen packages include 1000, 1500, 2000 and 3000 delivered lumens with color temperatures of 2700K, 3000K, 3500K and 4000K. Bottom trim ring accepts polycarbonate, tempered glass or acrylic up to 7/16" thick, and fastens to the housing using (4) tamper-resistant screws.

Catalog #		Type
Project		
Comments		Date
Prepared by		

## SPECIFICATION FEATURES

**Lower Shielding Reflector**  
0.050" thick aluminum lower reflector in combination with a lensed upper optical chamber.

**Bottom Trim Ring**  
Steel trim ring, powder coat painted white, retained with (4) flush tamper-resistant screws. Stainless steel ring available.

**Plaster Frame Collar**  
Die-cast aluminum 1-1/2" deep collar accommodates ceiling materials up to 2".

**Universal Mounting Bracket**  
Accepts 1/2" EMT, C channel and bar hangers and adjusts 5" vertically from above and below the ceiling.

**Thermal**  
Extruded aluminum heat sink conducts heat away from the LED module.

**LED (Light-Emitting Diode)**  
LED system contains high brightness white LEDs combined with a high reflectance upper reflector and convex transitional lens producing even distribution with no pixilation. Rated for 50,000 hours at 70% lumen maintenance. Auto resetting, thermally protected, LEDs are turned off when safe operating temperatures are exceeded. Flexible disconnect allows for tool-less replacement of LED engine from below ceiling.

**Junction Box**  
(4) 1/2" and (2) 3/4" trade size pry-outs positioned to allow straight conduit runs. Listed for (8) #12 AWG (four in, four out) 90°C conductors and feed thru branch wiring.

**Driver**  
Driver can be serviced from above or through the aperture.

**Environmental**  
Fixture not to be operated in ambient temperatures above 40° C.

**Code Compliance**  
Thermally protected and CSA listed for protected wet locations. Optional IP66 Compliant from below the ceiling. Optional City of Chicago environmental air (CCEA) marking for plenum applications. EMI/RFI emissions per FCC 47CFR Part 18 Class B consumer limits. Non-IC rated - Insulation must be kept 3" from top and sides of housing. RoHS Compliant. Title 24 2008 Compliant with designated trims. Photometric testing completed in accordance with IES LM 79 standards. LED life testing completed in accordance with LM 80 standards.

**Warranty**  
5-year warranty.



## FFLD6A FV/S6LM0 FVBT6

6" Vandal Resistant LED  
Downlight  
Flush Lens

1,000, 1,500, 2,000 or 3,000 Lumens

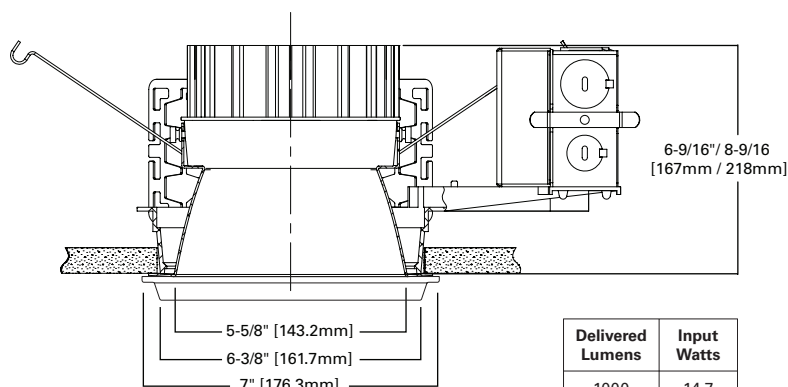

Delivered Lumens	Input Watts
1000	14.7
1500	22.6
2000	33.6
3000	46

## TOP VIEW

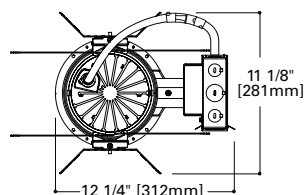

## TOP VIEW WITH BATTERY

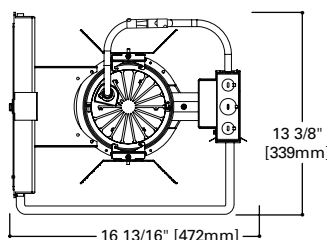

## ENERGY DATA

Delivered Lumens	Input Watts
1000	14.7
1500	22.6
2000	33.6
3000	46

## ORDERING INFORMATION

Example:

Line Item #1: Housing: **FFLD6A15D010TE** = 6" LED Vandal Resistant Plaster Frame, 1500 Lumen, Lutron Forward Phase DimmingLine Item #2: Power Module: **FERM6A10835** = 6" Vandal Resistant Power Module, 85 CRI, 3500K Color TemperatureLine Item #3: Reflector: **FV/S6LM0LI** = 6" Vandal Resistant Reflector, Specular ClearLine Item #4: Bottom Trim: **FVBT680/86** = 6" Vandal Resistant Bottom Trim, 0.125" Prismatic Acrylic Interior Lens, 0.250" Clear Polycarbonate Exterior Lens

Housing	Delivered Lumens <sup>1</sup>	Driver	Options	Power Module	Lumens	CRI	Color Temp	Reflector	Finish	Bottom Trim <sup>2, 3</sup>	Lens <sup>2, 3</sup>	Options	Accessories
				<b>FERM6A</b>					<b>LI</b>	<b>FVBT6</b>			
<b>FFLD6A</b> = 6" aperture <b>FFLD6ACP</b> = 6" aperture, Chicago plenum <sup>4</sup>  <b>10</b> = 1000 lumens <b>15</b> = 1500 lumens <b>20</b> = 2000 lumens <b>30</b> = 3000 lumens  <b>D010TE</b> = 120-277V, 0-10V 10% dimming or trailing edge 120V dimming <b>D5LT</b> = Fifth Light DALI dimming <b>DL3</b> = 1% - 100% dimming, 120-277V Lutron Hi-lume Ecosystem or 3-wire <b>DLT</b> = 1% - 100% dimming, 120V Lutron Hi-lume forward phase dimming <b>DMX</b> = DMX dimming <b>DE010</b> = 1 to 100% Dimming, 120-277V, 50/60Hz, 0-10V  <b>IEMBOD</b> = Emergency module, internal				<b>FERM6A</b> = 6" module  <b>10</b> = 1000 <b>15</b> = 1500 <b>20</b> = 2000 <b>30</b> = 3000  <b>8</b> = 80 <b>9</b> = 90  <b>27</b> = 2700K <b>30</b> = 3000K <b>35</b> = 3500K <b>40</b> = 4000K <b>27CP</b> = 2700K, Chicago Plenum <b>30CP</b> = 3000K, Chicago Plenum <b>35CP</b> = 3500K, Chicago Plenum <b>40CP</b> = 4000K, Chicago Plenum			<b>FV/S6LM0</b> = 6" Vandal Resistant Reflector <b>FV/S6LM0E</b> = 6" Vandal Resistant Reflector for use with IEM Integral Emergency option  <b>LI</b> = Specular Clear <b>W</b> = Gloss White  <b>FVBT6</b> = Vandal Resistant Bottom Trim, Powder Coat Painted Matte White <b>FVBT6SS</b> = Vandal Resistant Bottom Trim, Stainless Steel, Powder Coat Painted Matte White <b>FVBT6NAT</b> = Sealed Bottom Trim, Aluminum, Matte White Natatorium Finish, Stainless Steel Hardware  <b>80</b> = 0.125" Prismatic Acrylic <b>81</b> = 0.156" Prismatic Polycarbonate <b>82</b> = 0.187" Prismatic Polycarbonate <b>84</b> = 0.125" Clear Polycarbonate <b>85</b> = 0.187" Clear Polycarbonate <b>86</b> = 0.250" Clear Polycarbonate <b>94</b> = 0.187" Clear Tempered Glass <b>89BV</b> = 0.125" Clear Acrylic  <b>IP66</b> = IP66 Ingress Protection Compliant <b>AM</b> = Anti-microbial Paint, Bottom Trim Ring  <b>HB26</b> = C Channel Bar Hanger, 26" Long, Pair <b>HB50</b> = C Channel Bar Hanger, 50" Long, Pair <b>RMB</b> = Wood Joist Bar Hanger, 22" Long, Pair						

## Notes:

<sup>1</sup> Nominal delivered Lumens will vary depending on selected CCT, driver and reflector finish.<sup>2</sup> For 2-lenses, specify the interior lens followed by the exterior lens, separated by a forward slash. Ex.: 0.125" Prismatic Acrylic interior, 0.125" clear polycarbonate exterior is: FVBT6 80/84<sup>3</sup> 7/16" thick lens maximum (sum of interior and exterior lenses).<sup>4</sup> Not available with emergency battery pack.

## PHOTOMETRICS

See website for photometrics / IES file.