

DESCRIPTION

Fail-Safe's hospital patient room fixture - the MPR LED removes lighting elements from walls incorporating them into a multi-compartment ceiling fixture. Sections provide independent task illumination: patient reading light using (1) LED linear module puts the light at the head of the bed for patient use; ambient room light using (2) linear LED modules provides soft illumination via perforated wings while shielding direct source glare; examination light uses (4) linear LED modules and focuses high intensity illumination to torso for maximum patient appraisal with minimal wattage consumption.

SPECIFICATION FEATURES

Construction

Housing is fabricated from 0.047" thick aluminum.

Mounting

Recessed grid. For hard ceilings specify the DFCL-2448W-U drywall framing kit.

Finish

High gloss, electrostatically applied, white powder coat finish, average minimum reflectance 92%. Matte white powder coat finish on the ambient reflector(s).

Shielding

Reading: Semi-specular aluminum reflector.

Ambient: Frosted acrylic, linear ribbed center lens.
Exam: 0.140" Pattern 20 acrylic lens is standard. Pattern 12 clear acrylic, 0.125" thick available
Aluminum parabolic louver available, with or without an overlay.

Light Emitting Diode (LED)

LEDs available in 3000K, 3500K, 4000K, and 5000K with CR > 85. Projected life is 50,000 hours at 70% lumen maintenance.

Driver

Electronic Universal voltage, 0-10V dimming.

Labels

ETL listed for damp locations.



MPR3

2' x 4'
LD4 LED
Healthcare: Patient

RECESSED

DIMENSIONS

3 COMPARTMENT DIMENSIONS

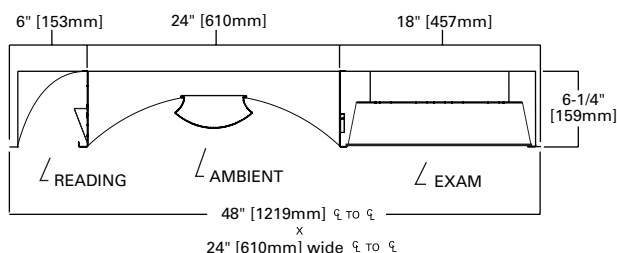

3 COMPARTMENT MOUNTING

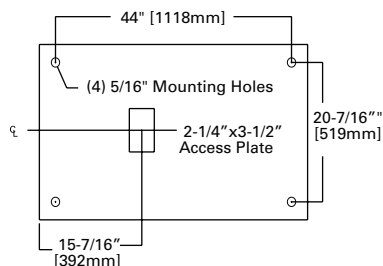

CEILING CUT-OUT DIMENSIONS (USING DFCL24W-U)

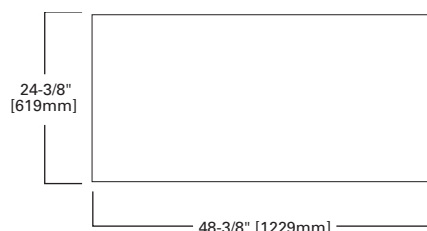

ORDERING INFORMATION

MPR3 (3 Function - Ambient/Exam/Reading)

SAMPLE NUMBER: MPR3-G-LD4-UNV-2STD/HI/LO-35-EDC-FA-OPL-LVCP

MPR3	G	LD4	UNV	/	/	FA
Product Family MPR3= 3 Compartment Ambient, Exam Reading		Voltage UNV=120V-277V				Color Temperature 30=3000K 35=3500K 40=4000K 50=5000K
Ceiling Type G=Grid ¹		# of LEDS (Ambient) 1=1 LED Module in Cross-Section 2=2 LED Modules in Cross-Section				EDC3 =Electronic Driver, Non-Dimming, 3 Circuits ⁷ EDD3 =Electronic Driver, 0-10V ⁷ 10% Dimming, 3 Circuits ED1D3 =Electronic Driver, 0-10V ⁷ 1% Dimming, 3 Circuits
LED LD4=LED Linear Module		Ambient Light Level STD=Standard LO=Low HI=High				Ambient Shielding FA=Frosted Acrylic, Linear Ribbed
		Exam Light Level STD=Standard LO=Low HI=High				Exam Shielding [Blank]=Pattern 20 Acrylic, 0.140" thick A12125 =Pattern 12 Acrylic, 0.125" thick OPL =White Smooth Opal lens, 0.125" thick S68I/OL = Specular Aluminum 6x8, 48-cell, 1-1/2" deep, opal overlay S68I/OLK12 = Specular Aluminum 6x8, 48-cell, 1-1/2" deep, Pattern 12 acrylic overlay ⁴
		Reading Light Level STD=Standard LO=Low HI=High				Options AM =Anti-microbial Paint LVCP =Low Voltage Relay ^{2,3} GLR =Fuse/Holder LLNL =Linear LED Night Light, 11" Length ⁵ LLNLA =Linear LED Night Light, Amber, 600 Lumens EL7W =7W Emergency Battery Pack ² EL10W =10W Emergency Battery Pack ^{2,6} EL14W =14W Emergency Battery Pack ²
						Accessories DFCL-2448W-U =Drywall Framing Kit, Cleanroom, White, 2' x 4', Gasketing included. Ceiling cutout 24.25" x 48.25" For anti-microbial DFCL, replace "W" with "AMW"

NOTES:

- For flange applications, order the accessory DFCL24W-U on a separate line item. Compatible with 15/16" NEMA G grid ceiling system.
- Must specify voltage.
- Normally open, mounting contact switch. Contact activation provides illumination seen across Ambient only-on, Reading only-on, Ambient and Reading-on, Ambient and Reading-off. To control only reading, specify LVCP/READ. To control only ambient, specify LVCP/AMB. Consult technical support for additional choices.
- For white louver, replace "S" with "W".
- LLNL uses 11" LED module (LD4), with separate driver. Nominal initial lumens = 600. LLNL is in the exam compartment. Available with LO or STD exam light level.
- EL10W illuminates two 22" LED Modules in the exam compartment. Available with LO or STD exam light level.
- EDC3, purple and gray low voltage dimming leads not connected. EDD3, purple and gray leads connected to driver, and presented at power supply entry.

NOMINAL INPUT WATTS

	LO	STD	HI
Ambient (1 module)	13w/ 1200 lumens	19w/ 1800 lumens	24w/ 2200 lumens
Ambient (2 module)	26w/ 2375 lumens	36w/ 3550 lumens	48w/ 4000 lumens
Exam	52w/ 3900 lumens	76w/ 5700 lumens	96w/ 7200 lumens
Reading	13w/ 910 lumens	19w/ 1330 lumens	24w/ 1680 lumens

Nominal input watts approximated, taking into account driver efficiency, LED wattage, other variables.