

## DESCRIPTION

The VRVT2 is an energy-efficient industrial Vaportite fixture that features rugged and durable construction. The VRVT2 incorporates a full metal fixture liner inside a reinforced fiberglass housing with a high impact diffuser. The Vaportite is suitable for interior and exterior applications and can be surface- or chain-mounted. The rugged, durable VRVT2 is perfect for coolers, car washes, breeze/walkways, canopies and other outdoor or indoor areas where environmental abuse is a problem.

Catalog #		Type
Project		
Comments		Date
Prepared by		

## SPECIFICATION FEATURES

### Construction

Fiberglass housing is reinforced polyester and self-extinguishing (ASTM-D635-74) plastic of a permanent pearl gray color. Top of housing has nine embossments (4' unit) and thirteen embossments (8' unit), providing mounting flexibility on uneven surfaces. A watertite hub for 1/2" conduit entry is provided at each end of housing (standard) for continuous feed. Polyurethane gasketing is formed in the housing providing a continuous seamless seal for the diffuser. Six sturdy cam latches (4' unit) and twelve (8' unit) with integral T20 stainless steel TORX® screws clamp diffuser tightly for a positive seal between housing, gasketing and diffuser.

### Reflectors

"DR" - Clear low brightness pattern acrylic with 15% high impact additive. "DR-100" - Clear low brightness pattern acrylic with

100% high impact additive.

Example: VT2-296DR-100 "LEX" - High impact clear low brightness pattern polycarbonate. LEXAN Example: VT2-296LEX.

### Electrical\*

Unit has full metal liner (channel) secured by brass internal/external mounting studs for positive grounding, maximum protection

and rigidity. Ballasts are CBM/ETL Class "P" certified suitable to plus 50°F (Cold temperature ballasts are available suitable to 0°F, on special order) Spring loaded lampholders.

### Labels

UL/cUL listed for Wet Locations.\*\* IP65 approved (4' only).

TORX® is a registered trademark of Camcar Division of Textron Inc.

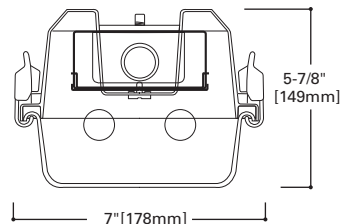

## LAMP CONFIGURATIONS

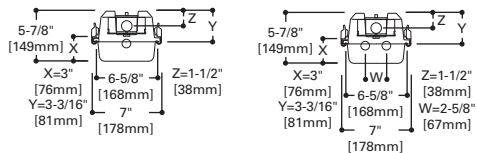

## MOUNTING DATA

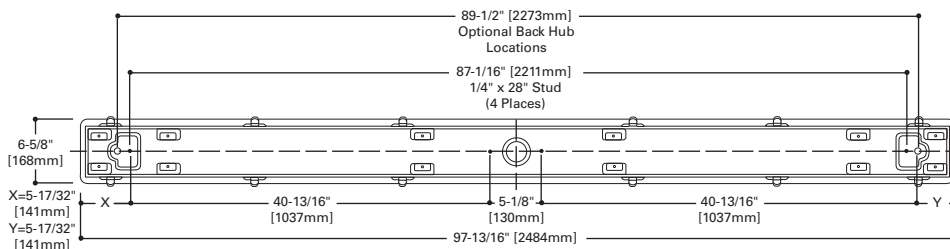
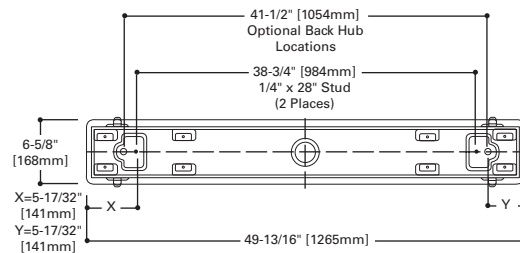

## INSTALLATION DATA

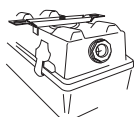

**MOUNTING BRACKETS**  
Furnished  
Two per 2' and 4' Unit  
Four per 8' Unit

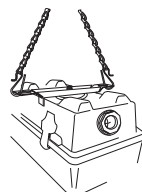

### OPTIONAL CHAIN HANGING SET (VT2-CHAIN/SET-U)

Includes 6 ft. of chain, 4 large S-Hooks and 4 small S-Hooks  
Order One (1) Kit for each 2' or 4' Fixture  
Two (2) Kits Recommended For 8' Fixture



## VRVT2

4' and 8' Lengths  
Fluorescent  
Vandal Resistant

Vapor Tight  
Slimline

## ENERGY DATA

Input Watts:

### EB Ballast & STD Lamps

148 (46)  
196 (85)  
196T8 (70)  
248 (74)  
296 (136)  
296T8 (110)

### ES Ballast & STD Lamps

296 (158)

### STD Ballast & STD Lamps

148 (60)  
196 (72)  
248 (102)

### Luminaire Efficacy Rating

LER = Ft-77

Catalog Number: VRVT2-296T8

Yearly Cost of 1000 lumens,  
3000 hrs at .08 KWH = \$3.12

\* Reference the lamp/ballast data in the Technical Section for specific lamp/ballast requirements.

\*\* Not suitable for wet locations if EL4 Option is added. Consult Pre-Sales Technical Support.



## ORDERING INFORMATION

SAMPLE NUMBER: VRVT2-296 DR-WL

Tandem	Series	No. of Lamps	Wattage (Length)	Lens Type	Voltage	Ballast Type	Options (Add as Suffix)
	<b>VRVT2</b>						
8T = 8' Length							
VRVT2							
1 or 2 Lamps (Not included)							
96 = 110W (96") 96T8=59W (96") SL							
Notes: For additional options, please consult Cooper Lighting Representative. <sup>1</sup> Optional VT2 1/2" Stem Bushing Available.							
				<b>DR</b> = Internal Prismatic Lens/ 15% DR High Impact Additive (Standard) <b>DR-100</b> =100% High Impact Additive <b>LEX</b> = High Impact Clear Polycarbonate LEXAN Lens/Low Brightness Pattern  <b>120</b> =120V <b>277</b> =277V <b>347</b> =347V <b>UNV</b> =Universal Voltage (120-277V)		<b>LEOC8</b> = Energy Saving Ballast (T8 Lamp only) <b>EB</b> = Generic Electronic Ballast <b>No. of Ballasts</b> 1 or 2 <b>Lamp Size</b> 8 = T8 5 = T5 (For specific Electronic Ballast specify Brand and Catalog Number.)	
						<b>GL</b> = Internal Single Element Fusing <b>GM</b> = Dual Element Fusing <b>EL4</b> = Emergency Lighting (self-contained) <b>EL8</b> = Emergency Lighting (self-contained) <b>RIF1</b> = Radio Interference Suppressor <b>TH</b> = (2) Top Watertight Hubs 1 <b>TEH</b> = (2) Top & (2) End - Watertite Hubs - (All Watertite Hubs Have 1/2" Conduit Entry) 1 <b>TILW</b> = Tandem In-Line Wiring Option (Consult TILW Option catalog page <b>PI/CPI</b> = Plug-In Option	
						<b>DL</b> =Damp Location Labeled <b>WL</b> =Wet Location Labeled <b>DD</b> =Deep Diffuser (Available on 4' fixtures. Deep housing standard on 8' fixtures.	
						<b>Accessories (Order separately)</b> <b>VRSD</b> =T20 Center Pin Tamperproof TORX®-head bit	

## PHOTOMETRICS

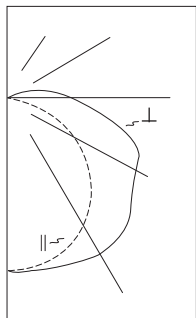

**VRVT2-296T8-DR-WL**  
Energy Saving Ballast  
F96T8/SPX35 Lamps  
5950 Lumens

Spacing criterion:  
(H) 1.3 x mounting  
height, (L) 1.6 x  
mounting height

Efficiency 76.5%

Test Report  
#ITL44180

LER = FI-77

Yearly Cost of 1000  
lumens, 3000 hrs at  
.08 KWH = \$3.12

## Coefficients of Utilization

Effective floor cavity reflectance										20%									
rc	80%				70%				50%			30%			10%			0%	
rw	70	50	30	10	70	50	30	10	50	30	10	50	30	10	50	30	10	0	
RCR																			
0	90	90	90	90	87	87	87	87	82	82	82	77	77	77	73	73	73	71	
1	79	75	71	67	77	72	69	65	68	65	62	64	61	59	60	58	56	54	
2	71	64	58	52	69	62	56	51	58	53	49	55	51	47	51	48	45	43	
3	64	55	48	42	62	53	47	41	50	45	40	47	43	39	44	41	37	35	
4	58	48	41	35	56	47	40	34	44	38	33	42	36	32	39	35	31	29	
5	53	43	35	30	51	41	34	29	39	33	28	37	32	27	35	30	27	25	
6	49	38	31	25	47	37	30	25	35	29	24	33	28	24	31	27	23	21	
7	45	34	27	22	44	33	27	22	32	26	21	30	25	21	29	24	20	19	
8	42	31	24	20	41	30	24	19	29	23	19	27	22	18	26	21	18	16	
9	39	29	22	17	38	28	22	17	27	21	17	25	20	16	24	19	16	15	
10	37	26	20	16	36	26	20	16	24	19	15	23	18	15	22	18	15	13	

## Zonal Lumen Summary

Zone	Lumens	%Lamp	%Fixture
0-30	1681	14.1	18.5
0-40	2870	24.1	31.5
0-60	5544	46.6	60.9
0-90	8432	70.9	92.6
90-180	675	5.7	7.4
0-180	9107	76.5	100.0

## Candela

Angle	Along H	45°	Across L
0	2048	2048	2048
10	2029	2024	2076
20	1930	1987	2107
30	1765	1943	2147
40	1535	1854	2093
50	1231	1664	1920
60	845	1398	1749
70	460	1228	1572
80	176	871	1118
90	28	489	741
100	28	254	466
110	14	93	216
120	7	54	55
130	5	36	49
140	6	17	35
150	5	7	17
160	5	4	6
170	3	3	3
180	0	0	0

## DEEP DIFFUSER

(Available for 4' Fixture Length)

To Complement Deep Diffuser Depth  
of 8' Fixture

