

## DESCRIPTION

The VRVT2 is an energy-efficient industrial Vaportite fixture that features rugged and durable construction. The VRVT2 incorporates a full metal fixture liner inside a reinforced fiberglass housing with a high impact diffuser. This Vaportite is suitable for interior and exterior applications and can be surface- or chain-mounted. The VT2 has been designed for maximum operation in commercial institutional and industrial environments where weathering, high temperature, humidity and dust or corrosive fumes are present.

## SPECIFICATION FEATURES

### Construction

Fiberglass housing is reinforced polyester and self-extinguishing (ASTM-D635-74) plastic of a permanent pearl gray color. Top of housing has thirteen (13) embossments (8' unit), providing mounting flexibility on uneven surfaces. A watertite hub for 1/2" conduit entry is provided at each end of housing (standard) for continuous feed. Polyurethane gasketing is formed in the housing providing a continuous seamless seal for the diffuser. Twelve (8' unit) sturdy cam latches with integral T20 stainless steel TORX® screws clamp diffuser tightly for a positive seal between housing, gasket and diffuser.

### Reflectors

"DR" - Clear low brightness pattern acrylic with 15% high impact additive. "DR-100" - Clear low brightness pattern acrylic with 100% high impact additive. Example: VRVT2- 296HODR-100 "LEX" - High-impact, clear, low brightness pattern polycarbonate. LEXAN Example: VRVT2- 296HOLEX.

### Electrical\*

Unit has full metal liner (channel) secured by brass internal/external mounting studs for positive grounding, maximum protection and rigidity. Ballasts are CBM/ETL Class "P" certified suitable to minus 20°F. Spring loaded lampholders.

### Labels

UL/cUL listed for wet locations.\*\*

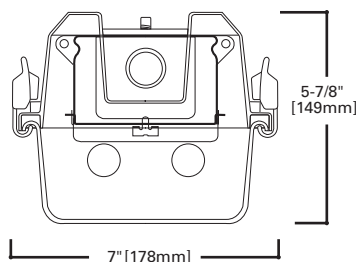

## LAMP CONFIGURATIONS

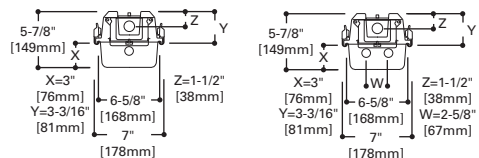

## MOUNTING DATA

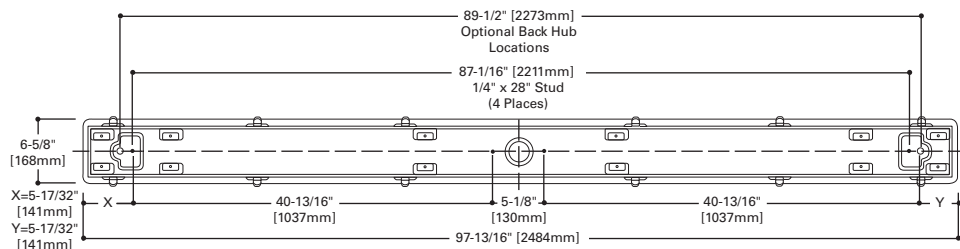

## INSTALLATION DATA

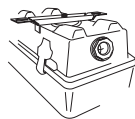

**MOUNTING BRACKETS**  
Furnished  
Two per 2' and 4' Unit  
Four per 8' Unit

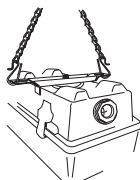

**OPTIONAL CHAIN HANGING SET**  
(VT2-CHAIN/SET-U)  
Includes 6 ft. of chain, 4 large S-Hooks and 4 small S-Hooks  
Order One (1) Kit for each 2' or 4' Fixture  
Two (2) Kits Recommended For 8' Fixture

TORX® is a registered trademark of Camcar Division of Textron Inc.

**Specifications and dimensions subject to change without notice.**  
Consult your representative for additional options and finishes.



## VRVT2

8' Length  
Vandal Resistant

Vapor Tight  
High Output

## ENERGY DATA

Input Watts:

**EB Ballast & STD Lamps**

296HO (208)

296HOT8 (160)

**STD Ballast & STD Lamps**

196HO (82)

248HO (145)

**STD Ballast & STD Lamps**

296HO (237)

**Luminaire Efficacy Rating**

LER = FI-50

**Catalog Number:** VRVT2-296HO DR-WL

**Yearly Cost of 1000 lumens,**  
**3000 hrs at .08 KWH = \$4.80**

\*Reference the lamp/ballast data in the Technical Section for specific lamp/ballast requirements.

\*\* Not Suitable for Wet Locations if EL4

Option is added. Consult Pre Sales Technical Support.

## ORDERING INFORMATION

SAMPLE NUMBER: VRVT2-296T8HO DR-WL

Series	No. of Lamps	Wattage (Length)	Lens Type	Voltage <sup>2</sup>	Ballast Type	Options (Add as Suffix)	Accessories (Order Separately)
<b>VRVT2</b>							
VRVT2			<b>DR</b> = Internal Prismatic Lens/ 15% DR High Impact Additive (Standard) <b>DR-100</b> =100% High Impact Additive <b>LEX</b> = High Impact Clear Polycarbonate LEXAN Lens/Low Brightness Pattern  <b>120</b> =120V <b>277</b> =277V <b>347</b> =347V <b>UNV</b> =Universal (120-277V)		<b>LEOC8</b> = Energy Saving Ballast (T8 Lamp only) <b>EB</b> = Generic Electronic Ballast No. of Ballasts 1 or 2 Lamp Size 8 = T8 (For specific Electronic Ballast specify Brand and Catalog Number.)	<b>GL</b> = Internal Single Element Fusing <b>GM</b> = Dual Element Fusing <b>EL4</b> = Emergency Lighting (self-contained) <b>EL8</b> = Emergency Lighting (self-contained) <b>RIF1</b> = Radio Interference Suppressor <b>TH</b> = (2) Top Watertight Hubs <sup>1</sup> <b>TEH</b> = (2) Top & (2) End - Watertite Hubs - (All Watertite Hubs Have 1/2" Conduit Entry) <sup>1</sup> <b>TILW</b> = Tandem In-Line Wiring Option (Consult TILW Option catalog page) <b>PI/CPI</b> = Plug-In Option	<b>VRSD</b> =T20 Center Pin Tamperproof TORX®-head bit
1 or 2 Lamps (Not included)							
96 =110W (96")HO <sup>1</sup> 96T8=59W (96") SL							

**Notes:**  
For additional options, please consult Cooper Lighting Representative.

<sup>1</sup> Optional VT2 1/2" Stem Bushing Available.

**Ambient Thermal Conditions:**  
Operating Ambient Temperature Limitations are applicable. Contact Sales Engineering for full "operating temperature range" of specific features.

**DL**=Damp Location Labeled  
**WL**=Wet Location Labeled

**DD**=Deep Diffuser (Available on 4' Fixtures. Deep Housing Standard on 8' Fixtures.)

## PHOTOMETRICS

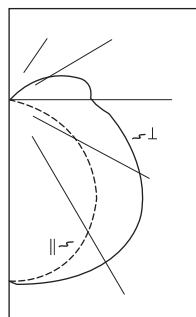

**VRVT2-296HO DR-WL**  
Energy Saving Ballast  
F96T12/CW/HO/EW  
Lamps  
8000 Lumens

Spacing criterion:  
(H) 1.3 x mounting  
height, (L) 1.6 x  
mounting height  
Efficiency 69.1%

Test Report  
#ITL44181

LER = FI-50

Yearly Cost of 1000  
lumens, 3000 hrs at  
.08 KWH = \$4.80

## Coefficients of Utilization

Effective floor cavity reflectance										20%									
rc		80%			70%			50%			30%			10%			0%		
rw		70	50	30	10	70	50	30	10	50	30	10	50	30	10	50	30	10	0
<b>RCR</b>																			
0	80	80	80	80	76	76	76	76	71	71	71	65	65	65	60	60	60	58	
1	71	66	63	59	67	64	60	57	59	56	54	54	52	50	50	48	47	44	
2	63	57	51	47	60	55	50	45	50	46	43	46	43	40	43	40	37	35	
3	57	49	43	38	55	47	42	37	44	39	35	40	36	33	37	34	31	29	
4	52	43	37	32	50	41	35	31	38	33	29	35	31	28	33	29	26	24	
5	48	38	32	27	45	37	31	26	34	29	25	31	27	23	29	25	22	20	
6	44	34	28	23	42	33	27	22	31	25	21	28	24	20	26	22	19	18	
7	41	31	24	20	39	30	24	20	28	22	19	26	21	18	24	20	17	15	
8	38	28	22	18	36	27	21	17	25	20	17	23	19	16	22	18	15	13	
9	35	26	20	16	33	25	19	15	23	18	15	21	17	14	20	16	13	12	
10	33	23	18	14	31	23	17	14	21	17	13	20	16	13	19	15	12	11	

## Zonal Lumen Summary

Zone	Lumens	%Lamp	%Fixture
0-30	1873	11.7	16.9
0-40	3187	19.9	28.8
0-60	6152	38.4	55.6
0-90	9276	58.0	83.9
90-180	1783	11.1	16.1
0-180	11059	69.1	100.0

## Candela

Angle	Along H	45°	Across L
0	2279	2279	2279
10	2260	2260	2329
20	2144	2229	2354
30	1958	2155	2361
40	1697	2034	2322
50	1360	1834	2182
60	935	1529	1902
70	496	1209	1596
80	176	952	1320
90	23	697	1043
100	20	644	1027
110	9	477	868
120	4	249	588
130	3	87	291
140	4	24	87
150	4	7	21
160	4	3	4
170	3	3	3
180	0	0	0