

## DESCRIPTION

Stadium Pro allows you to bring the dynamics of the game to life with consistent, precisely-delivered light that meets the stringent demands of international HDTV broadcasting, digital photography and slow-motion recording. Controlled intensity and uniformity removes the need for supplemental sports lighting while eliminating shadows, improving the appearance of moving objects and the ease with which camera operators can follow the action of the game for broadcast. Stadium Pro is the ultimate light for versatility and the best player, fan and broadcast experience.

## SPECIFICATION FEATURES

### Construction

Solid-state design means no moving parts and nothing to wear out or replace, providing maintenance-free operation for hundreds of thousands of hours.

### Optics

Custom-engineered optics direct light precisely where needed while minimizing glare.

### Precision Aiming

Integrated laser mount provides ability to precisely aim the fixture.

### Feedback

Telemetry to monitor health and status of each light is enabled through control system capabilities.

### Customization

Control options available to provide operational flexibility, create dynamic lighting scenes and control color temperature tuning.

### Electrical

Ultra-low EMI noise generation eliminates interference with surrounding electrical systems.

### Finish

Rugged, weather-tight design ensures durability even in harsh environments.

### Efficient Operation

Custom, integrated power supply operates at over 94% efficiency, ensuring lower temperature operation of the power supply and LEDs for fixture longevity and energy efficiency.



## STADIUM PRO

SPORTS LIGHTING

## DIMENSIONS

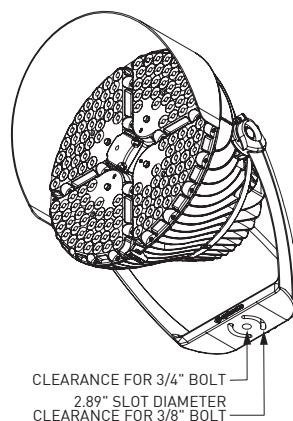
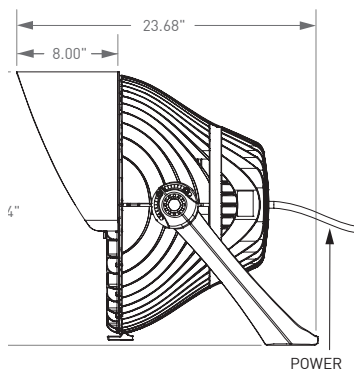
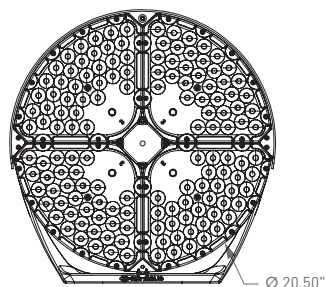

### CERTIFICATION DATA

IP66 Rated  
RoHS Compliant  
DesignLights Consortium™ Qualified

### EPA

Effective Projected Area (Sq. Ft.): 2.2

### SHIPPING DATA

Approximate Net Weight:  
55 lbs. (24.9 kg.)

## ORDERING INFORMATION

Model	Optics	Correlated Color Temperature (CCT)	Fixture Color	Controls
Stadium Pro	NEMA 2B NEMA 2 NEMA 3 NEMA 4 NEMA 5	Color temperature tuning	Black	Land Burst (wired DMX)

## ENERGY AND PERFORMANCE DATA

	Stadium Pro
Lumen Output	115,000
System Wattage	1000
Input Voltage	240VAC, 277VAC, 347VAC, 480VAC
L70 Hours	>225,000
Operating Temperature Range	-40°C — 55°C
Surge (Common Mode / Differential Mode)	1560VAC/Internal MOV protection 460J 10 KA Surge
IP Rating	IP66
NEMA Rating	NEMA 4X
Effective Projected Area (EPA)	2.2 ft <sup>2</sup>
Approximate Weight	55 lbs

## NOTES:

- Unless otherwise indicated, specifications were obtained in a 25°C ambient test environment. Changes in options, features and conditions may result in slightly different performance specifications among fixtures.
- Pure power is required to ensure proper function and lifetime of Eaton fixtures. Prior to installation, an analysis should be performed to verify site power meets these requirements.
  - High frequency voltage should be below -40dB or .01V between 3KHz and 100KH.
  - High frequency current should be below -50dB or .019A between 3KHz and 100 KHz.

If the power does not meet these criteria, waveform correction technology should be used to condition the power. Surge protection alone is not adequate. Eaton will not be liable for damage to fixtures due to poor power quality. Consult your lighting representative at Eaton for more information.
- Temperature rating is applicable when the fixture is mounted between 30–90 degrees. Mounting angles below 30 degrees are not recommended and ambient temperature should not exceed 25°C in this situation.

Series SD = Stadium	Wattage 1000 = 1000	Optics 2B = NEMA2B 2 = NEMA2 3 = NEMA3 4 = NEMA4 5 = NEMA5	CCT CT = Color Tuning	Fixture Color BLK = Black	Controls LB = LandBurst DMX
------------------------	------------------------	---	--------------------------	------------------------------	--------------------------------