



N/A



## ARROWLINEAR INDOOR

AC/RC3: BASE, WALL, CEILING

**Warning:** Before starting any work ensure that all sources of power are turned off. All work must meet local/national codes and be performed by a certified electrician. **Do not** mount fixtures vertically. Indoor fixtures cannot be used for outdoor applications.

BASE MOUNT

WALL MOUNT

CANTILEVER MOUNT

CEILING MOUNT

These installation instructions are valid with the above Arrowlinear mounting options.

### Complete Fixture Assembly

(Fixture lengths vary depending on lamp type; see lamp chart on page2)

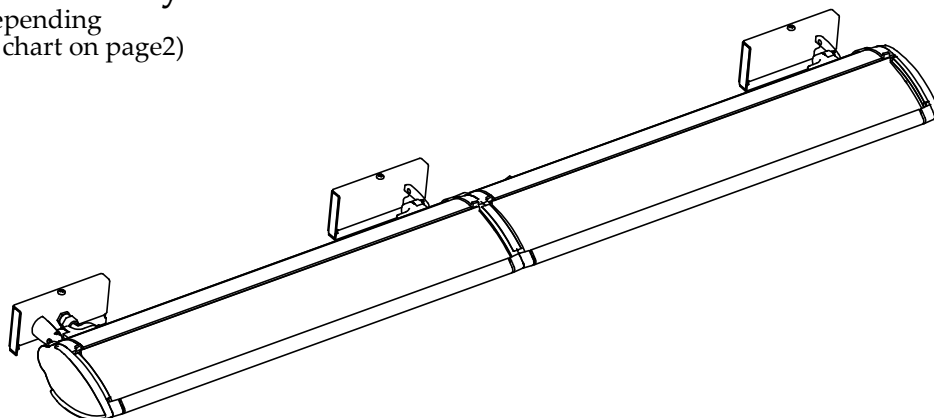

**Note:** All RC3 mounting is field adjustable

### Exploded View

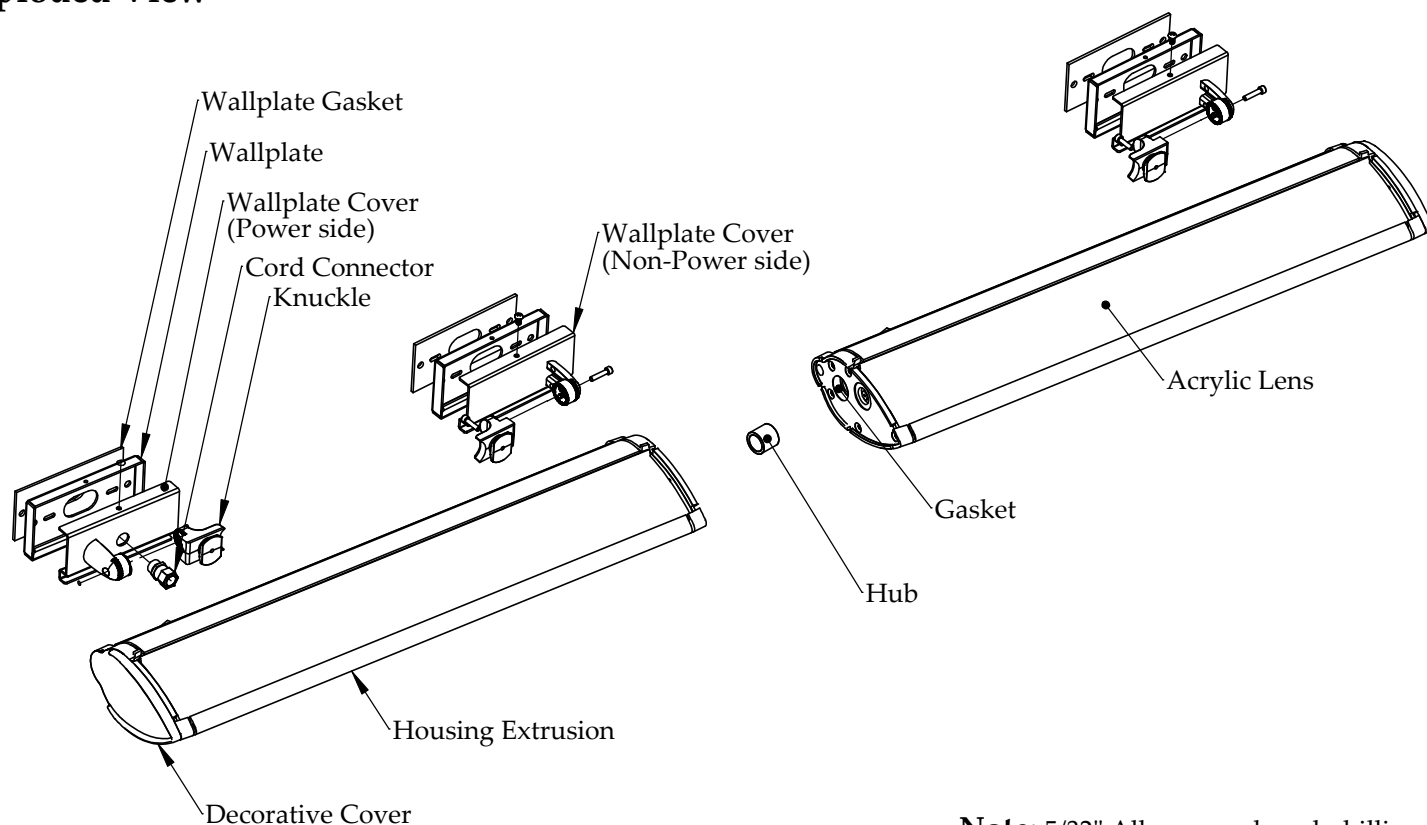

**Note:** 5/32" Allen wrench and phillips screw driver are required (supplied by others).



BASE MOUNT



WALL MOUNT

N/A

CANTILEVER MOUNT



CEILING MOUNT

These installation instructions are valid with the above Arrowlinear mounting options.

## ARROWLINEAR INDOOR

AC / RC3 : BASE, WALL,  
CEILING

**Warning:** Before starting any work ensure that all sources of power are turned off. All work must meet local/national codes and be performed by a certified electrician. **Do not** mount fixtures vertically. Indoor fixtures cannot be used for outdoor applications.

### Lamp Chart

Available Lengths	Available Wattages	Available Lamp Types	A- Mounting plate centers in(mm)	B-Mounting plate centers in(mm)
2FT	14W	(T5)	22 - 13/16IN (580mm)	26-7/8IN (682mm)
2FT	17W	(T8)		
2FT	24W	(T5 HO)		
2FT	22W	(LED)		
3FT	21W	(T5)	34 - 5/8IN (880mm)	38-11/16IN (982mm)
3FT	25W	(T8)		
3FT	39W	(T5 HO)		
3FT	33W	(LED)		
4FT	28W	(T5)	46 - 7/16IN (1180mm)	50-1/2IN (1282mm)
4FT	32W	(T8)		
4FT	54W	(T5 HO)		
4FT	44W	(LED)		
6FT	2 X 21W	(T5)	72 - 29/32IN (1852mm)	76-31/32IN (1954mm)
6FT	2 X 25W	(T8)		
6FT	2 X 39W	(T5 HO)		
6FT	3 X 33W	(LED)		
8FT	2 X 28W	(T5)	96 - 17/32IN (2452mm)	100-9/32IN (2555mm)
8FT	2 X 32W	(T8)		
8FT	2 X 54W	(T5 HO)		
8FT	2 X 44W	(LED)		
12FT	3 X 28W	(T5)	146 - 27/64IN (3719mm) MIDDLE ARM 73 - 7/32IN (1860mm)	150-15/32IN (3822mm) MIDDLE ARM 77-9/32 (1962mm)
12FT	3 X 32W	(T8)		
12FT	3 X 54W	(T5 HO)		
12FT	3 X 44W	(LED)		

**Note:** 12FT fixtures do require a middle arm. (See lamp chart)

### Mounting the Fixture Brackets

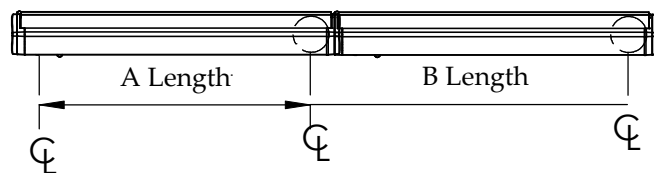

#### Prior to Roughing in J-Boxes:

1. Determine the location of fixture mounting and verify structure will support the weight of the fixtures. If necessary, use additional bracing to support fixture.
2. Using mounting plate centers provided in lamp chart, attach mounting arms to fixture assembly (ref. figure 1).
3. Install Horizontal J-Boxes (by others) (ref. figure 2).

1.

### Mounting Arm to Fixture Assembly

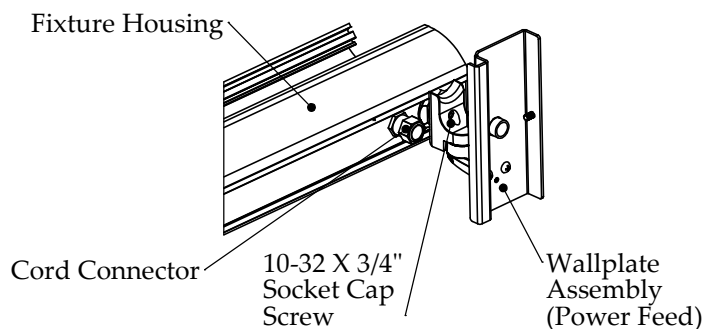

1. Assemble wallplate power feed and knuckle.
2. Once the wallplate arm assembly (Power Feed or Non Power) is assembled, place the Knuckle base horizontally into extrusion track located on back of the fixture.
3. Rotate the complete wallplate arm Power Feed assembly counter-clockwise 90°, and the Non-Power assembly clockwise 90°.
4. Adjust Mounting Arms horizontally to match the desired mounting location and tighten the 10-32 X 3/4" Socket Cap screw; use lamp chart for recommended standard spacing.

2.

### Mounting Power-side Assembly

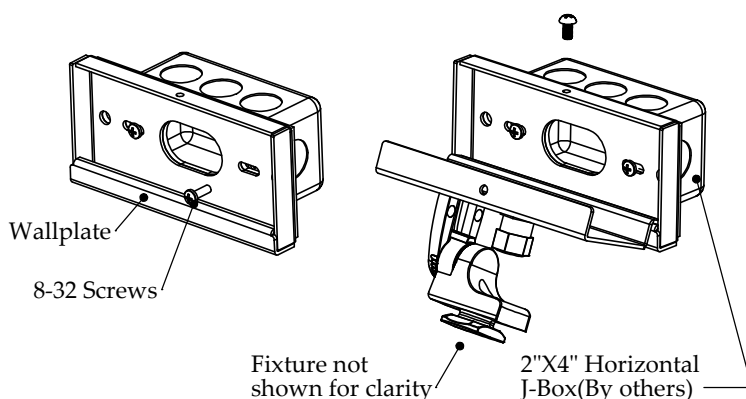

1. Once the RC3 mounting arms have been completely assembled, secure wallplate over the Horizontal J-box, use additional bracing to support. Using 8-32 screws for alignment purpose only, use appropriate 1/4" fasteners (by others), to mount to structure.
2. Use the hinge wallplate feature to hang the fixture while you wire the fixture power to the main power inside the J-box, making sure to rotate the fixture back up and secure using the provided hardware.



N/A



BASE MOUNT

WALL MOUNT

CANTILEVER MOUNT

CEILING MOUNT

These installation instructions are valid with the above Arrowlinear mounting options.

## ARROWLINEAR INDOOR AC / RC3: BASE, WALL, CEILING

**Warning:** Before starting any work ensure that all sources of power are turned off. All work must meet local/national codes and be performed by a certified electrician. **Do not** mount fixtures vertically. Indoor fixtures cannot be used for outdoor applications.

### Power Feed

1. Wire the power cord (supplied) to the inside of the fixture by running the power cord through the endcap and out the back through the cord connector.
2. Attach all wires and ensure all connections are properly matched. Hide wires inside the fixture and attach Decorative Cover using 10-32 X 1/2" Socket Cap screw.

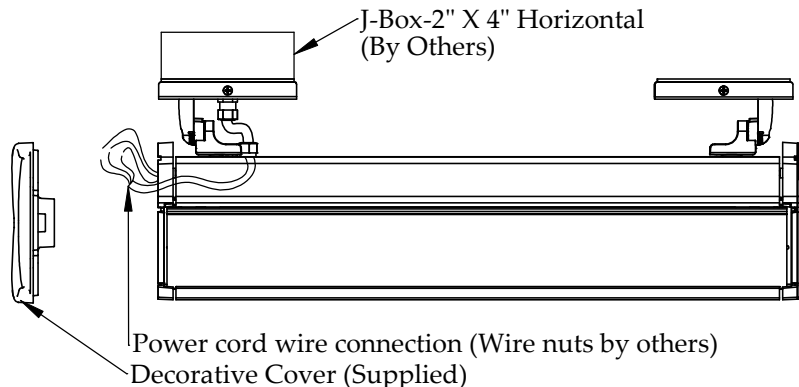

### Continuous Fixture Joining

(Fixture lengths vary depending on lamp type; see lamp chart on page 2)

1. Run the fixture power wires through the hub and connect to appropriate power wires of adjoining fixture. All wire push nuts should be placed inside either fixture.
2. Attach the two fixtures together; use the 10-32 X 1-1/8" Socket Cap Screw and nut as shown. Make sure wires run through the hub and the hub is seated properly in between the endcaps.

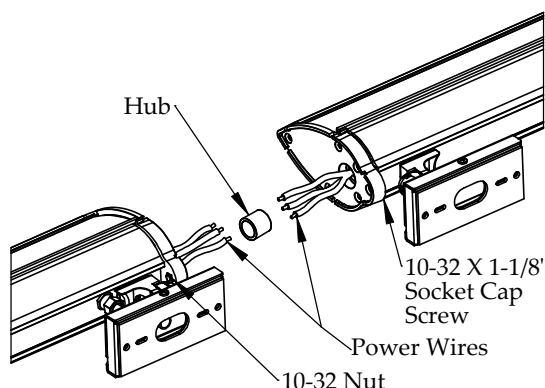

**Note:** Entire fixture not shown for clarity

### Mounting Plate Dimensions: in [mm]

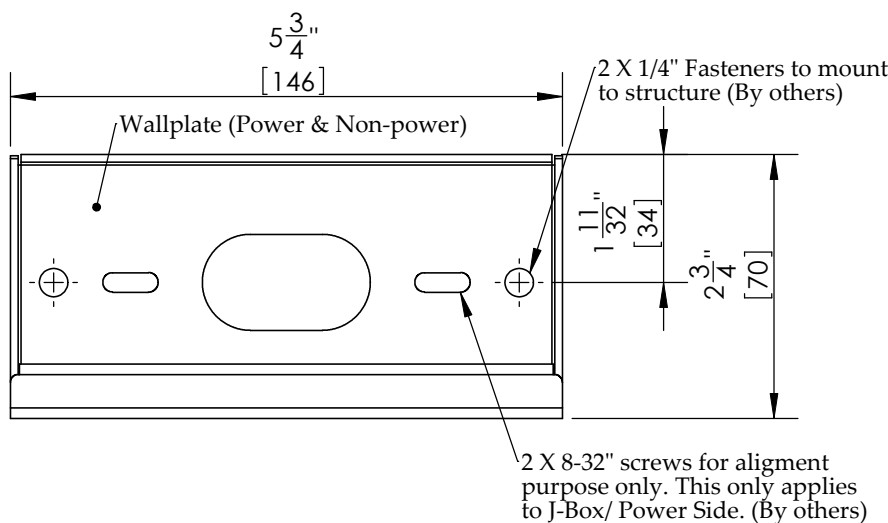
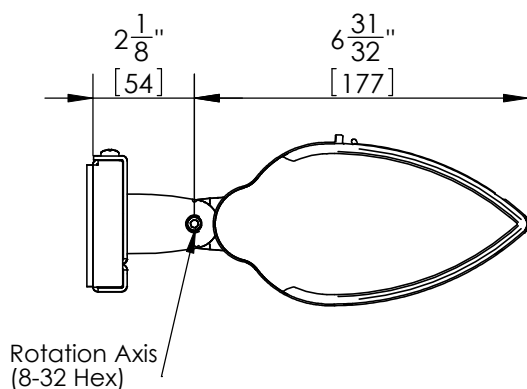

**Note:** Arrowlinear Wallplates are designed to accommodate 1/4" mounting hardware (by others); Hardware must meet Local / National codes and installation must be provided by a licensed contractor.