

DESCRIPTION

The Arrowlinear fixture is a linear asymmetric system of lighting designed for wall washing and signage type applications. The fixture has three color temperatures, multiple lengths and configurations, extruded aluminum housings, die cast end caps and mounting arms, and diffused acrylic lens. It is a simple and effective linear asymmetric lighting solution.

| Catalog # | Type |
|-------------|------|
| | |
| Project | |
| | |
| Comments | Date |
| | |
| Prepared by | |
| | |

SPECIFICATION FEATURES

Construction

Housing is corrosion-resistant. Type 6063-T6 aluminum extrusion with die-cast aluminum end caps. End caps are secured by concealed stainless steel fasteners. Housing, end caps, and lens are sealed with single, closed cell silicone gaskets. Stainless steel hardware is standard. Reflector is constructed from 22 gauge cold rolled

steel and pre-painted reflective white. A slightly diffused acrylic lens is standard, constructed of impact-resistant, U.V. stabilized virgin acrylic to prevent discoloration.

Electrical

LED fixtures use >0.9 power factor UL 1310 Class 2 AC to DC driver with built-in dimming. Integral LED light

engines are easily replaceable in the field. Offered in 80+ CRI for 3000K, 3500K, 4000K CCT.

Mounting

Fixture includes Slide-N-Mount™ adjustable, lockable, mounting arms constructed from Type 383 die-cast aluminum. Support structure by others.

Finish

Fixture housing is coated using electro-statically charged polyester powder coat paint for superior protection against fade and wear. Standard colors include white, silver, black, and bronze. Consult factory for custom colors.

Aiming

Fixture includes the PointGrab2™ lockable aiming system, providing minimum 180 degree vertical adjustment of the fixture housing in 5 degree increments. The aiming feature locks securely in place by means of a stainless steel locking mechanism.

Compliance

UL / cUL listed for use in damp locations.



ARROWLINEAR

LED

Base Mount

Asymmetric Indirect

Individual Linear

CERTIFICATION DATA
UL/cUL Dry Location Listing
LM79 Compliant

ENERGY DATA
>0.9 Power Factor
120V – 277V 50/60 Hz
25°C Ambient Temperature

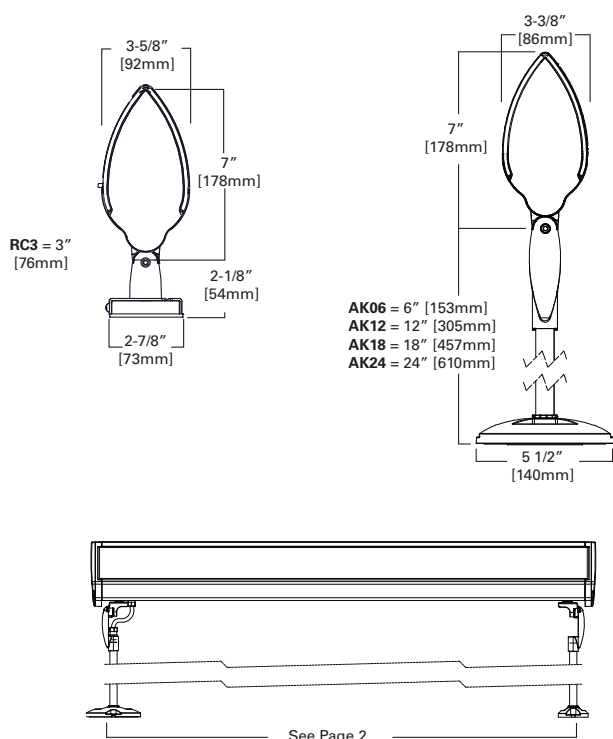

Refer to installation instructions for mounting details

ORDERING INFORMATION

Sample Number: A04-SI-A-2-LED-30K-120-W-AK6-LMC

| Series ^(1,2,3) | Size | Lens | Light Level | Lamp | Color Temperature |
|---|---|--|--|------------------|--|
| A02 = Arrowlinear 2' Unit A03 = Arrowlinear 3' Unit A04 = Arrowlinear 4' Unit A06 = Arrowlinear 6' Unit A08 = Arrowlinear 8' Unit A12 = Arrowlinear 12' Unit | Indoor SI = Extra Small - Indoor | A = Acrylic | 1 = See Energy & Performance Data Chart | LED = LED | 30K = 3000K 35K = 3500K 40K = 4000K |
| Voltage | Finish | Mounting ⁽⁴⁾ | Options | | |
| 120 = 120V 277 = 277V UNV = Universal | B = Black Z = Bronze S = Silver W = White C = Custom | RC3 = Rectangular Canopy, 3" Arm / Integral AK6 = 6" Adjustable Knuckle / Integral AK12 = 12" Adjustable Knuckle / Integral AK18 = 18" Adjustable Knuckle / Integral AK24 = 24" Adjustable Knuckle / Integral | B = Battery Pack D = Dimming E = Emergency LMC = Large AK Mounting Canopies (in lieu of standard) | | |

PHOTOMETRICS

Arrowlinear - Individual - Base

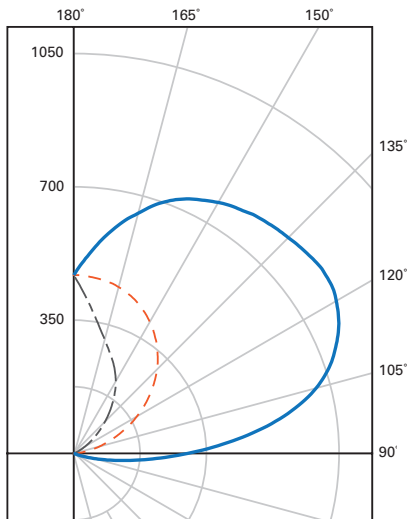

FILE NAME: A02-SI-A-2-LED-35K-1C-120-S-AK6-24

LAMP: 3500K

LUMENS: 1990

INPUT WATTS: 20.5 W

EFFICACY: 97.1 LPW

TEST REPORT: ITL87330-GONIOPHOTOMETRY

Information based on 2 ft. section



ZONAL LUMEN SUMMARY

| Zone | Lumens | % Fixture |
|--------|--------|-----------|
| 0- 30 | 0 | 0 |
| 0- 40 | 0 | 0 |
| 0- 60 | 0 | 0 |
| 0- 90 | 62 | 3.1 |
| 90-120 | 639 | 32.1 |
| 90-130 | 952 | 47.8 |
| 90-150 | 1537 | 77.2 |
| 90-180 | 1928 | 96.9 |
| 0-180 | 1990 | 100 |

ENERGY & PERFORMANCE DATA

| Individual Length | Lumens | Wattage | Length |
|-------------------|--------|---------|--------------------|
| 2ft | 1990 | 20.5 | 27-3/8" (695mm) |
| 3ft | 2985 | 30.7 | 39-3/16" (995mm) |
| 4ft | 3980 | 40.5 | 51" (1295mm) |
| 6ft | 5970 | 60.6 | 77-7/16" (1967mm) |
| 8ft | 7960 | 82.2 | 101-1/16" (2567mm) |
| 12ft | 11940 | 121.1 | 151-3/16" (3839mm) |

| Color Temperature Conversion Factor (per ft) | | |
|--|------------|------------|
| CCT | Lumens/ ft | Multiplier |
| 3000K | 923 | 0.927 |
| 3500K | 995 | 1.000 |
| 4000K | 1043 | 1.048 |

MOUNTING

RC3 Mount - Standard rectangular wall mount plate

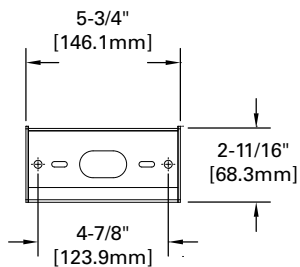

AK Mount - Standard circular wall mount plate

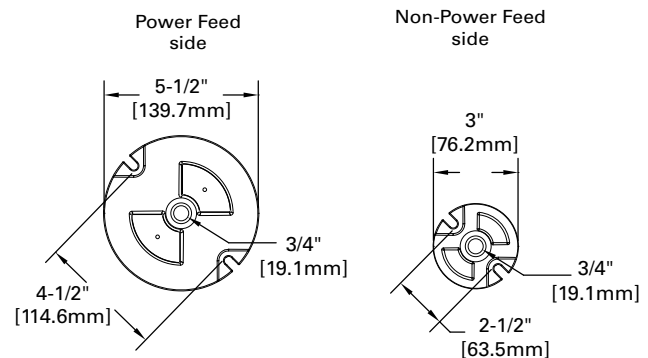

LMC Mount - Standard circular wall mount plate

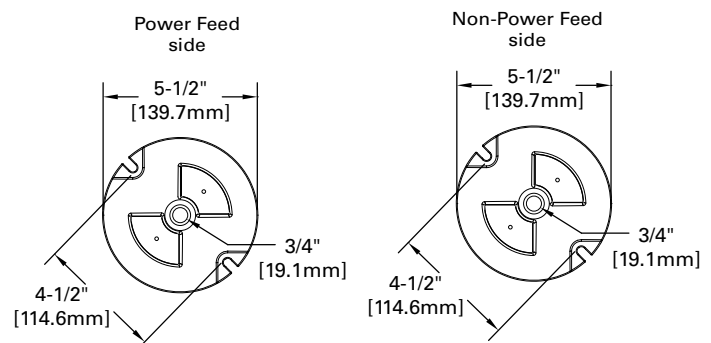

1. All options may not be available with all models.
2. 12'-0" fixtures require three mounting points
3. Slide 'N Mount adjustable lockable arms, are standard.
4. For RC3 mount: Use 2"x 4" horizontal j-box (by others) required for mounting.