

## DESCRIPTION

The Lumark Nighthawk III utilizes a soft-cornered aerodynamic design to provide excellent EPA ratings and an aesthetically pleasing appearance. Dark bronze polyester powder coat finish assures corrosion resistance and long-lasting aesthetics. U.L. listed and CSA certified for wet locations. The Nighthawk III uses an innovative die-cut optical design which delivers maximum beam control for storage areas, rail yards, loading docks and building perimeters.

Catalog #	Type
Project	
Comments	Date
Prepared by	

## SPECIFICATION FEATURES

### Construction

**LATCHES:** Formed aluminum flush draw-action latches offer easy access to lamp compartment without tools and maintain integrity of seal when closed. **HOUSING:** Aerodynamically designed die-cast aluminum housing has low EPA rating. **DOOR:** Die-cast aluminum with integral cast hinges for removal without tools. **GASKET:** Door gasket is foam-in-place silicone, providing maximum protection of interior components from the elements.

### Electrical

**BALLAST:** Ballast components are hard mounted to fixture housing for maximum heat dissipation and extended component and lamp life.

### Optical

**LENS:** Heat- and impact-resistant tempered glass. Lens is mounted flush with door surface to reduce wind drag and prevent dirt or moisture from accumulating. **REFLECTOR:** Computer designed die-cut reflector system delivers superior beam control and efficiency.

### Mounting

**Slipfitter:** Die-cast aluminum integral slipfitter mounts on nominal 2 3/8" or 3" O.D. tenons. A degree-marked quadrant is cast in for easy and accurate aiming. **Yoke:** Heavy-duty steel yoke provides flexibility in mounting from a variety of surfaces. **Trunnion:** Die-formed steel trunnion is easily adapted to many areas and allows easy fixture aiming.

**Efficiency Standards Notice**  
Select luminaires are manufactured to USA and California efficiency regulations.



## NK NIGHTHAWK III

250 - 1000W

Pulse Start Metal Halide

250 - 1000W

High Pressure Sodium

SLIPFITTER-, YOKE-, TRUNNION-  
MOUNT FLOODLIGHT

## DIMENSIONS

### SLIPFITTER-MOUNT

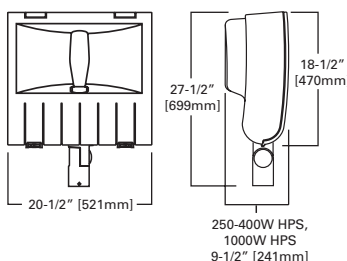

### YOKE-MOUNT

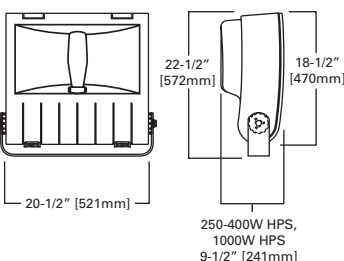

### TRUNNION-MOUNT

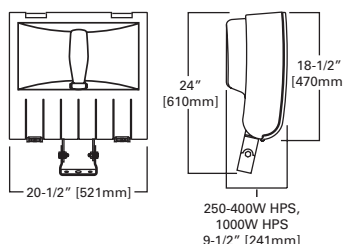

## DRILLING PATTERN FOR YOKE- AND TRUNNION-MOUNT

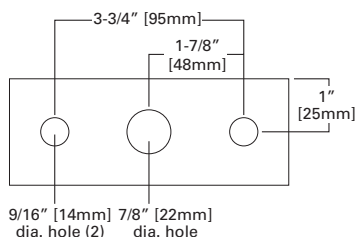

## TECHNICAL DATA

U.L. Wet Location Listed  
CSA Certified  
EISA Compliant ®

## EPA

Effective Projected Area: 2.7

## SHIPPING DATA

Approximate Net Weight:  
59 lbs. (27 kgs.)



# PHOTOMETRICS

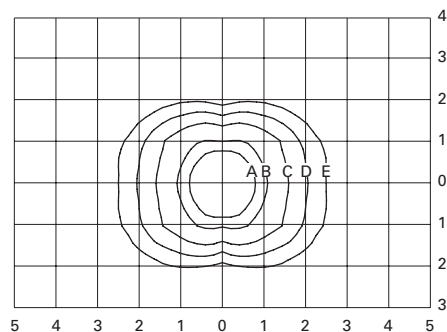

**HPNK-X76-400**  
400-Watt HP  
50,000-Lumen Clear Lamp

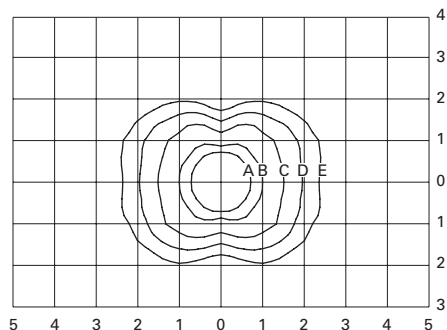

**MPNK-X76-400**  
400-Watt MP  
42,000-Lumen Clear Lamp

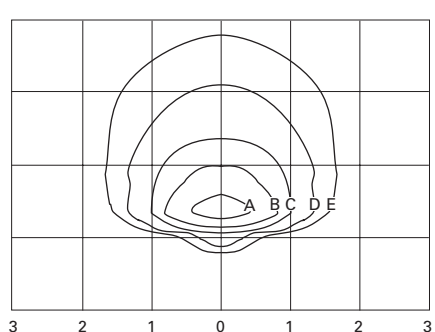

**HPNK-X76-1000**  
1000-Watt HP  
140,000-Lumen Clear Lamp

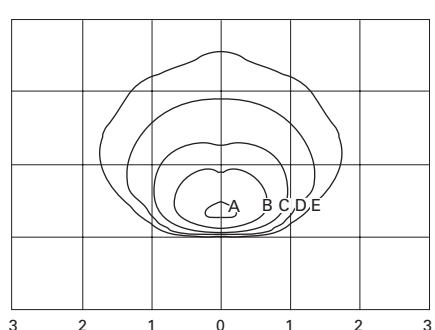

**MPNK-X76-1000**  
1000-Watt MP  
110,000-Lumen Clear Lamp

## Footcandle Table

Select mounting height and read across for footcandle values of each isofootcandle line. Distance in units of mounting height.

Mounting Height	Footcandle Values for Isofootcandle Lines				
	A	B	C	D	E
<b>400W</b>					
20'	10.00	5.00	2.00	1.00	0.50
25'	6.40	3.20	1.28	0.64	0.32
30'	4.44	2.22	0.89	0.44	0.22
35'	3.27	1.63	0.65	0.33	0.16
40'	2.50	1.25	0.50	0.25	0.13

## 1000W

30'	20.00	10.00	5.00	2.00	1.00
35'	14.69	7.35	3.67	1.47	0.73
40'	11.25	5.63	2.81	1.13	0.56
45'	8.89	4.44	2.22	0.89	0.44
50'	7.20	3.60	1.80	0.72	0.36

## EPA Ratings:

Fixture Angle	Wind Direction (sq. ft.)	
	Front	Side
45° from Horizontal	2.7	1.2
90° from Horizontal	4.2	1.2
0° from Horizontal	1.1	1.2

## ORDERING INFORMATION

Sample Number: MPNK-S76-400-277V

Lamp Type <sup>1</sup>	Product Family	Mounting	Distribution	Lamp Wattage	Voltage <sup>1</sup>
MP=Pulse Start Metal Halide HP=High Pressure Sodium	NK=Nighthawk III	S=Slipfitter T=Trunnion Y=Yoke	76=7H x 6V Beam Spread	MP 250=250W 400=400W 1000=1000W  HP 250=250W 400=400W 1000=1000W	120V=120V 208V=208V 240V=240V 277V=277V 347V=347V <sup>2</sup> 480V=480V MT=Multi-Tap, Wired 277V TT=Triple-Tap, Wired 347V <sup>2</sup>
Options (Add as Suffix)			Finish	Accessories (Order Separately) <sup>6</sup>	
F1=Single Fuse (120, 277 or 347V only) F2=Double Fuse (208, 240 or 480V only) Q=Quartz Restrike (Hot Strike Only) EM=Quartz Restrike with "Delay Relay" (Quartz lamp strikes at both hot and cold starts) <sup>3</sup> LL=Lamp Included <sup>4</sup> PER=NEMA Twistlock Photocontrol Receptacle PC=Button Type Photocontrol <sup>5</sup> T=Removable Quick-Disconnect Power Tray <sup>3</sup>			—=Bronze (Standard) BLK=Black GRY=Grey WHT=White	TYS-XX=Trunnion or Yoke Slipfitter for 2-3/8", 3", or 3-1/2" O.D. Tenon <sup>7</sup> VS/NK=Vandal Shield for 150 - 320W WG/NK=Wire Guard VS/NK/1000=Vandal Shield for 400 - 1000W Units OA/RA1016=Photoelectric Control, 105-285 Volt NEMA Type OA/RA1201=Photoelectric Control, 347V NEMA Type OA/RA1027=Photoelectric Control, 480V NEMA Type OA1028=Field Installed NEMA Twistlock Photocontrol Receptacle (Order Photocontrol Separately) TV/NK-XX=Top or Bottom Visor SV1/NK-XX=Single Side Visor SV/NK-XX=Double Side Visor OA/RA1013=Shorting Cap	

### NOTES:

- Consult an Eaton representative for lamp/ballast type/voltage compatibility.
- 88% efficient EISA Compliant fixtures not available in 347V or TT voltages.
- Not available in 1000W.
- Lamp is shipped separate from luminaire. Lamp is Eaton designated product based on luminaire requirements. Specified lamps must be ordered as a separate line item.
- PC option not available with trunnion or yoke mount.
- Replace XX with color designation.
- Not available with slipfitter-mount.

## STOCK SAMPLE NUMBER: (LAMP INCLUDED)

Sample Number: MPNKS40

Lamp Type	Product Family	Mounting	Lamp Wattage <sup>2</sup>	Accessories
MP=Pulse Start Metal Halide HP=High Pressure Sodium	NK=Nighthawk III <sup>1</sup>	S=Slipfitter Y=Yoke	40=400W 1K=1000W	TYS=Trunnion or Yoke Slipfitter for 2-3/8", 3", or 3-1/2" O.D. Tenon

### NOTES:

- Multi-tap ballast, 7Hx6V beam spread, bronze finish, and lamp are standard for stock product. Refer to In Stock Guide for availability.
- DOE/EISA regulations replace the state of California's requirements and CEC designation will no longer be required for California installations on products manufactured beginning February 10, 2017.