

DESCRIPTION

The Lumière Eon LED 303-S1-LEDB1 is a compact, low profile, dimmable LED sign lighting luminaire. It attaches to a wall or ceiling mounted straight arm and delivers full vertical adjustment (180°) for easy aiming. The 303-S1-LEDB1 provides either uplight or downlight depending upon how mounted or aimed. It mounts directly to any wall or ceiling surface over a standard 4" square junction box and comes standard with a universal input LED driver (120 - 277V, 50/60 Hz). Dimming is achieved with a standard ELV, reverse phase dimming driver or an optional 0-10V dimming driver. 303-S1-LEDB1 may be used indoors or outdoors and carries an IP66 rating.

SPECIFICATION FEATURES

Construction

Head and back plate are precision machined from corrosion-resistant 6061-T6 aluminum. A standard 12" or optional 24" and 36" length extruded straight arm provides 180° of vertical adjustment for easy aiming. Consult factory for additional lengths. A universal mounting plate and one piece silicone key hole gasket is provided for adaption to junction box or surface. Stainless steel hardware is included.

Mounting

The luminaire mounts directly to a standard 4" square junction box. For further mounting information see technical notes section on page 2.

Optical

LightBAR™ and optical assembly are sealed by a diffused, impact resistant tempered glass lens. The optical assembly is available in three distributions: T2 (lateral throw), T4 (forward throw) and T5X (Extra Wide Flood). Available in several color temperatures: 2700K, 3000K, 3500K, 4000K and TSAM (Amber). Both color temperature and distribution must be specified when ordering – see catalog logic for details. An edge-lit option is available.

Electrical

The 8.5W 303-S1-LEDB1 is standard with an ELV trailing edge phase dimmable driver that accepts a universal input (120-277, 50/60Hz). It will operate in -40°C to 50°C [-40°F to 122°F]. The driver incorporates surge protection. An optional 0-10V dimming driver is also available.

Finish

The luminaires are double protected by a RoHS compliant chemical film undercoating and polyester powder coat paint finish, surpassing the rigorous demands of the outdoor environment. The LightBAR™ cover plates are standard white and may be specified to match finish of luminaire housing (LCF). A variety of standard colors are available. RAL and custom color matches available upon request. Luminaires can also be brushed with a clear coat finish.

Warranty

Lumière warrants the EON series of fixtures against defects in material and workmanship for five (5) years. Auxiliary equipment such as LED drivers carries the original manufacturer's warranty.



303-S1-LEDB1 EON LED

APPLICATIONS:
CEILING / WALL MOUNT

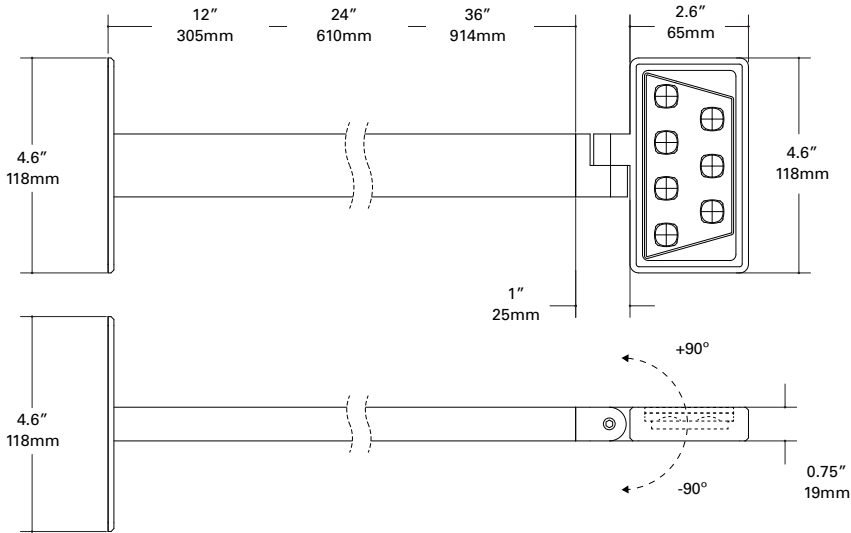

CERTIFICATION DATA

UL and cUL Wet Location Listed
LM79 / LM80 Compliant
ROHS Compliant
IP66 Ingress Protection Rated

TECHNICAL DATA

40°C Maximum Temperature Rating
External Supply Wiring 90°C Minimum



ORDERING INFORMATION

Sample Number: 303-S1-LEDB1-2700-UNV-T2-DIM10-BK-12-EDGE

Series ⁵	Color Temperature	Input Voltage	Optics	Dimming	Finish ¹	Stem Length ²	Options ^{3,4}
303-S1-LEDB1 Head contains one (1) Mini LightBAR™	2700=2700K 3000=3000K 3500=3500K 4000=4000K TSAM =Turtle Safe Amber (585-595nm)	UNV=Universal 120-277, 50/60Hz	T2=Type II, Lateral Throw T4=Type IV, Forward Throw T5X=Type V, Extra Wide Flood	DIMELV=Trailing Edge Phase DIM10=0-10V Dimming	Painted BK=Black BZ=Bronze CS=City Silver WT=White Premium Finish BA=Brushed	12=12" Stem 24=24" Stem 36=36" Stem	EDGE=Edge lit glass lens LCF=LightBAR cover plate matches housing finish

NOTES: 1 Custom and RAL color matching available upon request. Consult factory for further information. 2 Stem lengths are nominal (shown in inches). 3 Add suffix in the order shown. 4 LCF option not available when WT (white) finish is selected. 5 DesignLights Consortium™ Qualified and classified for DLC Standard. Refer to www.designlights.org for details on exact qualified EON 303-S1-LEDB1 product as not all configurations are DLC classified.

LUMEN MAINTENANCE

Ambient Temperature	TM-21 Lumen Maintenance (72,000 Hours)	TM-21 Reported L70(10k) (Hours)	Theoretical L70 (Hours)
25°C	> 94%	> 60,000	365,000
40°C			
50°C			

CURRENT DRAW

Model	Line Voltage	Current Draw
303-S1-LEDB1	120-277V, 50/60Hz	0.13A

LUMENS - CRI/CCT TABLE

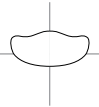
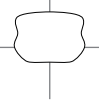
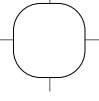
Optic Type	Distribution	Watts	Delivered Lumens	LPW	CCT (K) / Color	CRI nom. / Wavelength
T2 (Lateral Throw)		8.5	354	42	2700	95
			588	71	3000	75
			411	50	3500	85
			648	77	4000	75
T4 (Forward Throw)		8.5	180	28	TSAM (Amber)	585-595nm
			310	37	2700	95
			541	65	3000	75
			360	43	3500	85
T5X (Extra Wide Flood)		8.5	568	67	4000	75
			158	24	TSAM (Amber)	585-595nm
			381	46	2700	95
			663	80	3000	75
		6.5	443	53	3500	85
			698	83	4000	75
			194	30	TSAM (Amber)	585-595nm

NOTES: 1 When the LCF option is selected use a lumen multiplier of .85

OPTIONS

Edge

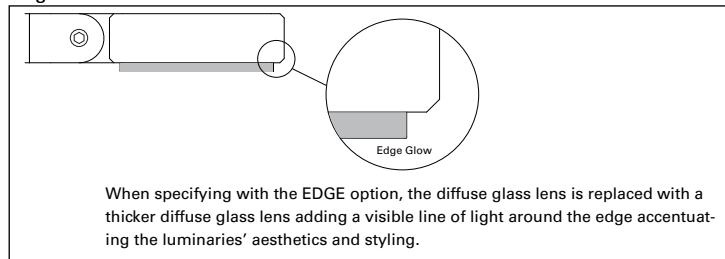

TECHNICAL NOTES

1. Junction box size and depth is important when specifying product. Recommended junction boxes include 2-1/8" deep, 4" square weld/drawn Crouse Hinds part numbers TP403, TP434, TP494, TP196, TP395 or equivalent. Use with included universal mounting plate or with Crouse-Hinds part number TP480 or equivalent cover with similar fixture mounting locations.
2. The universal wall plate provided with all EON wall mount fixtures can be used with an outdoor rated two gang 30.5 cubic inch capacity outlet box. Cooper Crouse-Hinds part numbers TP7086 – TP7122 or equivalent. The universal mounting plate will attach with four (4) 6-32 pan head/flat stainless steel screws (not provided).
3. Driver can be remote mounted in a junction box a max distance of 25 feet (voltage drop needs to be considered) or placed in the junction box behind the luminaire.
4. When specifying with the EDGE option, the diffused glass becomes thicker adding a visible line of light around the edge accentuating the luminaires' aesthetics and styling.
5. If Luminaire will not be dimmed, the Luminaire must be ordered with DIMELV option, but does not have to be dimmed.
6. Driver Dimensions:

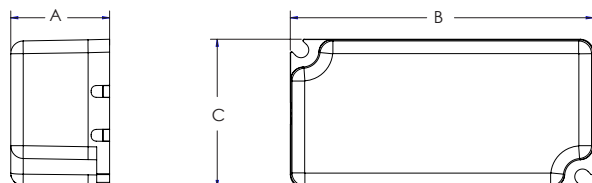

Luminaire Type	Dimming Type	Driver Dimensions in [mm]		
		A	B	C
303-S1-LEDB1	DIMELV	.98 [25.0]	2.78 [70.5]	1.14 [28.9]
	DIM10	.98 [25.0]	3.36 [85.3]	1.49 [37.9]