

## DESCRIPTION

The Lumière Eon LED 303-W1-LEDB1 is a compact, low profile, dimmable LED direct/indirect luminaire. The luminaire features full vertical adjustment (180°) for easy aiming and mounts directly to any wall or ceiling surface over a standard 4" square junction box. It is standard with a universal input LED driver (120 - 277V, 50/60 Hz). Dimming is achieved with a standard ELV, reverse phase dimming driver or an optional 0-10V dimming driver. 303-W1-LEDB1 may be used indoors or outdoors and carries an IP66 rating.

Catalog #	Type
Project	
Comments	Date
Prepared by	

## SPECIFICATION FEATURES

### Construction

Head and back plate are precision machined from corrosion-resistant 6061-T6 aluminum. A universal mounting plate and one piece silicone key hole gasket is provided for adaption to junction box or surface. Stainless steel hardware is included.

### Mounting

The luminaire mounts directly to a standard 4" square junction box. For further mounting information see technical notes section on page 2.

### Optical

LightBAR™ and optical assembly are sealed by a diffused, impact resistant tempered glass lens. The optical assembly is available in three distributions: T2 (lateral

throw), T4 (forward throw) and T5X (Extra Wide Flood). Available in several color temperatures: 2700K, 3000K, 3500K, 4000K and TSAM (Amber). Both color temperature and distribution must be specified when ordering – see catalog logic for details. An edge-lit option is available.

### Electrical

The 8.5W 303-W1-LEDB1 is standard with an ELV trailing edge phase dimmable driver that accepts a universal input (120-277, 50/60Hz). It will operate in -40°C to 50°C [-40°F to 122°F]. The driver incorporates surge protection. An optional 0-10V dimming driver is also available.

### Finish

The luminaires are double protected by a RoHS compliant chemical film undercoating and polyester

powder coat paint finish, surpassing the rigorous demands of the outdoor environment. A variety of standard colors are available. RAL and custom color matches available upon request. Luminaires can also be brushed with a clear coat finish. The LightBAR™ cover plates are standard white and may be specified to match finish of luminaire housing (LCF).

### Warranty

Lumière warrants the EON series of fixtures against defects in material and workmanship for five (5) years. Auxiliary equipment such as LED drivers carries the original manufacturer's warranty.



## 303-W1-LEDB1

EON LED

**APPLICATIONS:**  
CEILING / WALL MOUNT  
DIRECT  
INDIRECT

### CERTIFICATION DATA

UL and cUL Wet Location Listed  
LM79 / LM80 Compliant  
ROHS Compliant  
IP66 Ingressed Protection Rated

### TECHNICAL DATA

50°C Maximum Temperature Rating  
External Supply Wiring 90°C Minimum

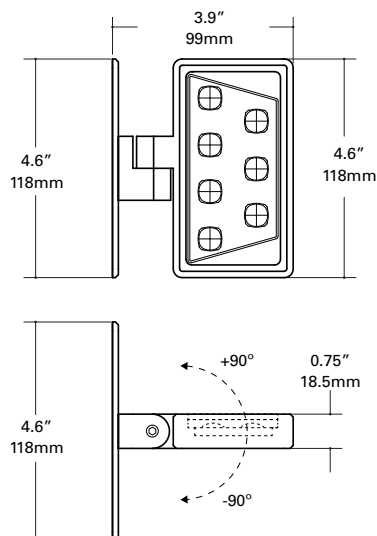

## ORDERING INFORMATION

Sample Number: 303-W1-LEDB1-2700-UNV-T2-DIM10-BK-EDGE

Series <sup>4</sup>	Color Temperature	Input Voltage	Optics	Dimming	Finish <sup>1</sup>	Options <sup>2,3</sup>
303-W1-LEDB1 Head contains one (1) Mini LightBAR™	2700=2700K 3000=3000K 3500=3500K 4000=4000K TSAM =Turtle Safe Amber (585-595nm)	UNV=Universal 120-277, 50/60Hz	T2=Type II, Lateral Throw T4=Type IV, Forward Throw T5X=Type V, Extra Wide Flood	DIMELV=Trailing Edge Phase DIM10=0-10V Dimming	Painted BK=Black BZ=Bronze CS=City Silver WT=White <b>Premium Finish</b> BA=Brushed NSS=Solid Stainless Steel	EDGE=Edge lit glass lens LCF=LightBAR cover plate matches housing finish

**NOTES:** 1 Custom and RAL color matching available upon request. Consult factory for further information. 2 Add suffix in the order shown. 3 LCF option not available when WT (white) finish is selected. 4 DesignLights Consortium™ Qualified and classified for DLC Standard. Refer to [www.designlights.org](http://www.designlights.org) for details on exact qualified EON 303-W1-LEDB1 product as not all configurations are DLC classified.

## LUMEN MAINTENANCE

Ambient Temperature	TM-21 Lumen Maintenance (72,000 Hours)	TM-21 Reported L70(10k) (Hours)	Theoretical L70 (Hours)
25°C	> 94%	> 60,000	365,000
40°C			
50°C			

## CURRENT DRAW

Model	Line Voltage	Current Draw
303-W1-LEDB1	120-277V, 50/60Hz	0.068A

## LUMENS - CRI/CCT TABLE

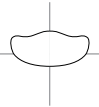
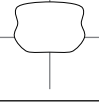
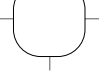
Optic Type	Distribution	Watts	Delivered Lumens	LPW	CCT (K) / Color	CRI nom. / Wavelength
T2 (Lateral Throw)		8.5	354	42	2700	95
			588	71	3000	75
			411	50	3500	85
			648	77	4000	75
		6.5	180	28	TSAM (Amber)	585-595nm
T4 (Forward Throw)		8.5	310	37	2700	95
			541	65	3000	75
			360	43	3500	85
			568	67	4000	75
		6.5	158	24	TSAM (Amber)	585-595nm
T5X (Extra Wide Flood)		8.5	381	46	2700	95
			663	80	3000	75
			443	53	3500	85
			698	83	4000	75
		6.5	194	30	TSAM (Amber)	585-595nm

NOTES: 1 When the LCF option is selected use a lumen multiplier of .85

## OPTIONS

### Edge

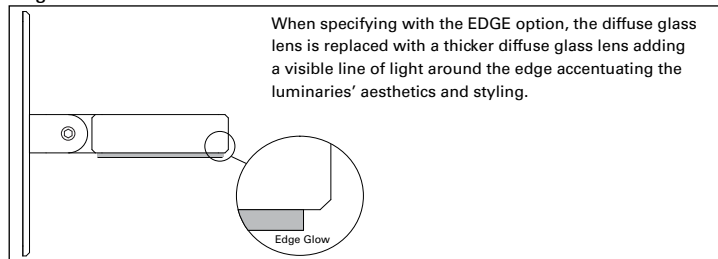

## TECHNICAL NOTES

- Junction box size and depth is important when specifying product. Recommended junction boxes include 2-1/8" deep, 4" square weld/drawn Crouse Hinds part numbers TP403, TP434, TP494, TP196, TP395 or equivalent. Use with included universal mounting plate or with Crouse-Hinds part number TP480 or equivalent cover with similar fixture mounting locations.
- The universal wall plate provided with all EON wall mount fixtures can be used with an outdoor rated two gang 30.5 cubic inch capacity outlet box. Cooper Crouse-Hinds part numbers TP7086 – TP7122 or equivalent. The universal mounting plate will attach with four (4) 6-32 pan head/flat stainless steel screws (not provided).
- Driver can be remote mounted in a junction box a max distance of 25 feet (voltage drop needs to be considered) or placed in the junction box behind the luminaire.
- When specifying with the EDGE option, the diffused glass becomes thicker adding a visible line of light around the edge accentuating the luminaires' aesthetics and styling.
- If Luminaire will not be dimmed, the Luminaire must be ordered with DIMELV option, but does not have to be dimmed.
- Driver Dimensions:

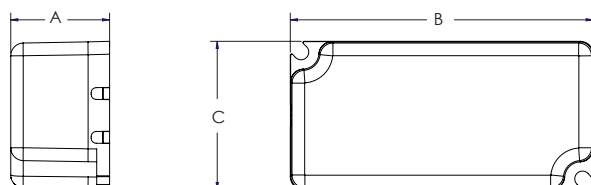

Luminaire Type	Dimming Type	Driver Dimensions in [mm]		
		A	B	C
303-W1-LEDB1	DIMELV	.98 [25.0]	2.78 [70.5]	1.14 [28.9]
	DIM10	.98 [25.0]	3.36 [85.3]	1.49 [37.9]