

## Installation Instructions for the Sure-Lites UX6 AC only Exit Sign. UX6 Exit Signs and Markers for Use in HAZARDOUS LOCATIONS



### WARNING

#### Risk of Fire/Electric Shock

If not qualified, consult an electrician.



### WARNING

#### Risk of Electric Shock

Disconnect power at fuse or circuit breaker before installing or servicing.

## Important Safeguards

WHEN USING ELECTRICAL EQUIPMENT, BASIC SAFETY PRECAUTIONS SHOULD ALWAYS BE OBSERVED INCLUDING THE FOLLOWING.

1. READ AND FOLLOW ALL SAFETY INSTRUCTIONS
2. Do not use near gas or electric heaters.
3. Do not use this equipment for other than the intended use.
4. Installation is to be performed only by qualified personnel.
5. Install in accordance with National Electric Code and local regulatory agency requirements.
6. The use of accessory equipment not recommended by the manufacturer may cause an unsafe condition.
7. Equipment should be mounted in locations and at heights where it will not readily be subjected to tampering by unauthorized personnel.
8. SAVE THESE INSTRUCTIONS

## INSTALLATION – HAZARDOUS LOCATIONS

**NOTE:** Wall or ceiling mounting using the canopy kit is not intended for hazardous locations. The canopy kit is not suitable for Hazardous Locations and is meant Non-Hazardous Locations installation only.

**NOTE:** For hazardous location compliance, the UX must be installed using the provided conduit hub. The UX should not be directly mounted to a junction box when used in hazardous locations.

1. For field supply connection to the unit, use suitable wiring method for the hazardous location per NEC. Circuit should not be energized at this time.
2. Remove the weather shield by removing the 4 screws in the corners (See Figure 1). Due to the airtight nature of the exit sign, the weather shield may be held on by a slight vacuum. If this occurs, carefully pry the corners of the shield with a flat head screwdriver, but do no damage the water shield or inner gasket.
3. Remove the stencil face by prying the snap fits on the side up, by placing a flat head screw driver in the slots and lifting (See Figure 1).
4. Choose the appropriate knock out for the mounting (left side, right side, or top or backplate), and knock it out using a hammer and flat blade screwdriver. Connect conduit using the ½" fitting provided (See Figure 4).
5. For single face units only, if needed, knock out the two round knock outs at the far left and right of the backplate, and apply foam gasket to the back of the exit sign. Use these holes to attach the UX to the wall using a standard #8 screw or larger. Only remove the gasket holes needed for installation. For double face units, proceed to Step 6.

**NOTE:** When mounting the UX, it is necessary to consider the weight of the exit sign, about 7 pounds. A suitable anchor is recommended, or mounting directly to a stud for the junction box the exit sign is mounted to.

6. After the frame is securely mounted, the stencil can be hung for "hands free" wiring using the Sure-Lites EZ Hang system. (See figure 2).



*Powering Business Worldwide*

Figure 1

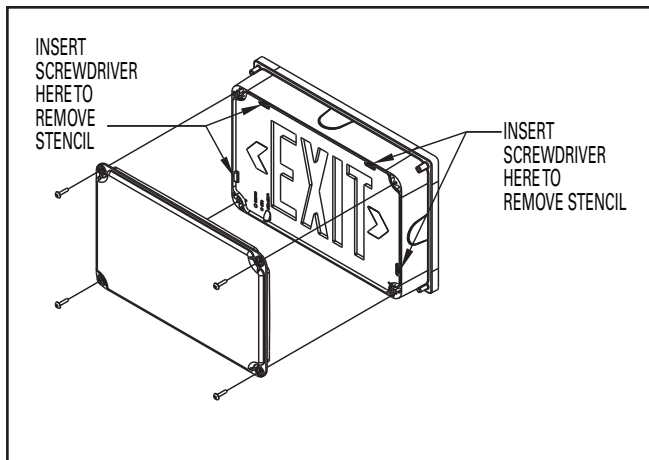

Figure 2

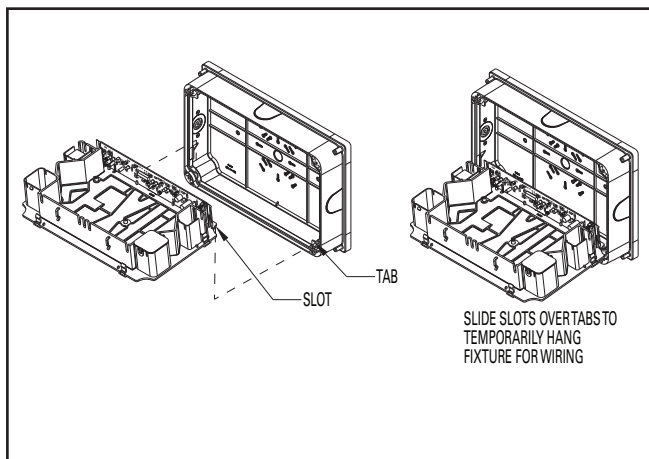

Figure 3

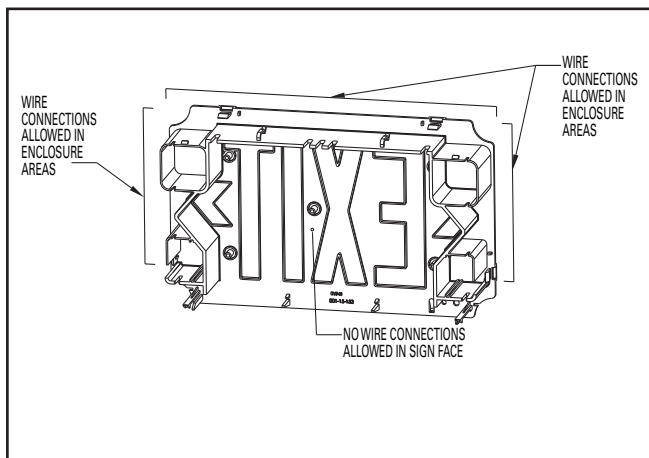
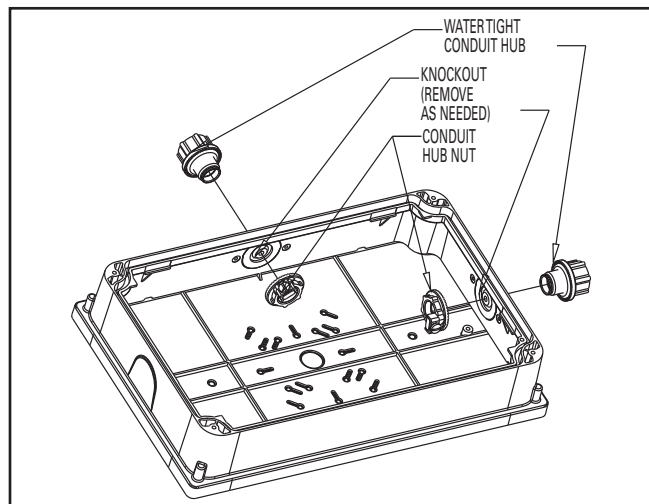

Figure 4



7. Connect power supply and ground in accordance with local codes. Wire connections as follows: 277VAC line to Orange lead or 120V line to Black lead; Neutral to white lead. Ground to Green Screw on backplate (single face), frame (double face) or conduit hub with integral terminal, if provided. Cap unused line lead with wire nut provided (see Schematic). Connections must be in the enclosure rated area of the frame (See Figure 3), not in the sign face. Make sure wires are routed so they do not create shadows on the face of the exit.
8. Determine which color sign face is needed. If red is needed, proceed to step 11.
9. If green is the desired color, remove the red lens from the stencil by removing the white vinyl caps holding the lens in place and replace it with the green lens provided. Replace the white vinyl caps.
10. On the LED circuit board, locate the red/green jumper (See Schematic). The jumper should be in the red position per the silk screen printing on the board. Pull gently upward on the jumper, then shift it one pin over to activate the green LEDs.
11. Replace the stencil cover assembly, and weather shield. To insure a water tight fit, make sure the gasket and weather shield edge are clean and free of debris.
12. Energize AC supply, LED display will come on.

**NOTE:** The foam gasket is suitable for smooth surfaces, but for rough surface mounting, silicone caulk should be used to prevent water from entering the exit sign.

## MAINTENANCE

**NOTE:** None required

**NOTE:** Servicing of any parts should be performed by qualified personnel. Only use replacement parts supplied by Eaton.

## TROUBLE SHOOTING GUIDE

If LED display does not illuminate, check the following:

1. Check AC supply – verify that unit has 24 hour AC supply.
2. Unit is shorted.
3. If following the above trouble shooting hints does not solve your problem, contact your local Eaton Lighting representative for assistance

## SCHEMATICS

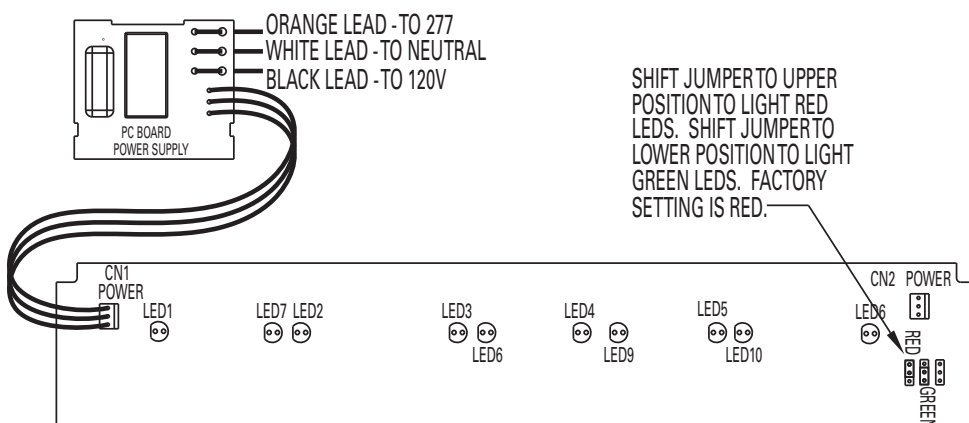

## WARRANTIES AND LIMITATION OF LIABILITY

Please refer to [www.eaton.com/LightingWarrantyTerms](http://www.eaton.com/LightingWarrantyTerms) for our terms and conditions.