

Installation Instructions – Define Perimeter Grid S121

⚠ WARNING

RISK OF ELECTRIC SHOCK—Disconnect power at fuse or circuit breaker before installing or servicing.

⚠ WARNING

Risk of fire/electric shock. If not qualified, consult an electrician.

⚠ WARNING

Risk of fire or electric shock. Luminaire's wiring, ballasts, or other electrical parts may be damaged when drilling for installation of reflector kit hardware. Check for enclosed wiring and components.

⚠ WARNING

The weight of the luminaire (ONLY) not to exceed 40 lbs.

NOTE: This product must be installed in accordance with the applicable installation code by a certified electrician familiar with the construction and operation of the product and hazards involved.

NOTE: Only those open holes indicated in the photographs and/or drawings may be made or altered as a result of kit installation. Do not leave any other open holes in an enclosure of wiring or electrical components.

NOTE: To prevent wiring damage or abrasion, do not expose wiring to edges of sheet metal or any sharp objects.

NOTE: Disconnect all power before proceeding.

Installation Instructions

Define Series (1" Housing Size)

Individual and Continuous Luminaires - Perimeter Installation
For Installation in Grid Ceilings

Warning: Before starting any work, ensure that all power sources are turned off. All work must meet local/national electrical codes and be preformed by a certified electrician.

Parts List

- Luminaire
- Grid Bracket/Joiner (pre-installed in fixture)
- Access Plate (pre-installed housing)
- Support Wire/Threaded Rod (by others)
- Shielded Cable (by others)
- J-rail
- Push-in Quick Connect
- Alignment Pins (pre-installed in fixture) (Continuous runs only)
- #8-32 2-1/2" Bolts and Nuts (Continuous runs only)
- 9/64" Allen Wrench (by others)
- 11/32" Flexible Nut Driver (by others)

Cross Section

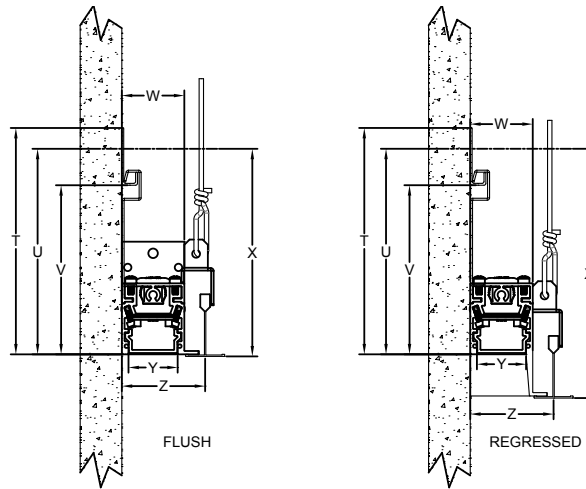

Grid Spacing Details

| Perimeter GRID | T | U | V | W | X | Y | Z |
|------------------------|------------------------------------|---|---------------------------------------|---------------|---|---------------|----------------------|
| Fixture Type | TOP OF J-RAIL TO BOTTOM OF FIXTURE | MOUNTING HOLE LOCATION TO BOTTOM OF FIXTURE | BOTTOM OF J-RAIL TO BOTTOM OF FIXTURE | FIXTURE WIDTH | MOUNTING HOLE LOCATION TO BOTTOM OF GRID (CRITICAL) | APERTURE SIZE | WALL TO GRID SPACING |
| Flush Installation | | | | | | | |
| Define 1 | 5.457" | 4.936" | 4.061" | 1.500" | 4.986" | 1.180" | 2.000" |
| Regressed Installation | | | | | | | |
| Define 1 | 5.457" | 4.936" | 4.061" | 1.500" | 5.986" | 1.180" | 2.000" |

Mounting Information - Extruded Trim Flange Details - Refer to submittal drawings for detailed flange information

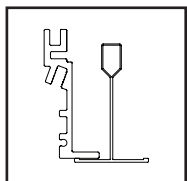

ETG
15/16"
T-Grid

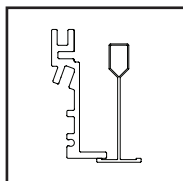

FTG
9/16"
T-Grid

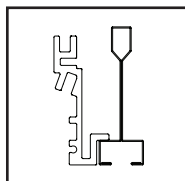

STG
Slotted
T-Grid

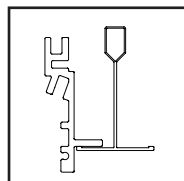

ETT
15/16" Tegular
T-Grid

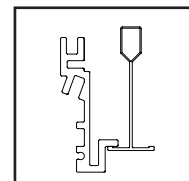

FTT
9/16" Tegular
T-Grid

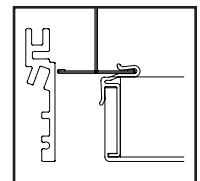

Trimless
Extruded Side

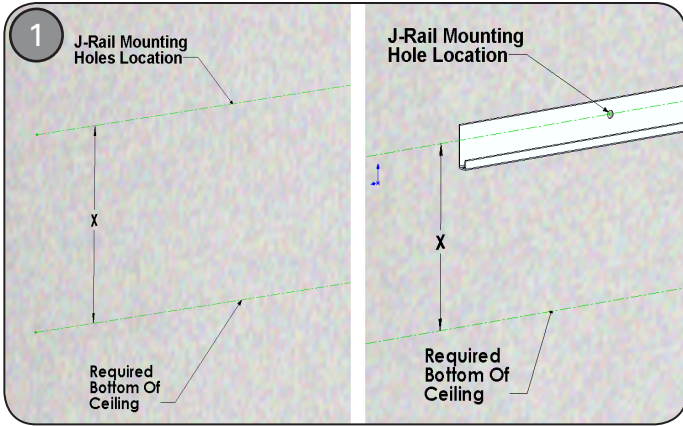

Mark wall at desired location for mounting J-rail. Use dimension "X" as shown on table of page 2 for locating the correct ceiling (bottom of grid) to mounting hole location. Using J-rail as a template, mark hole locations along wall for pre-drilling where needed. Secure J-rail to wall. Hardware, bracing, and other structural support for J-rail to be supplied and installed by contractor as needed.

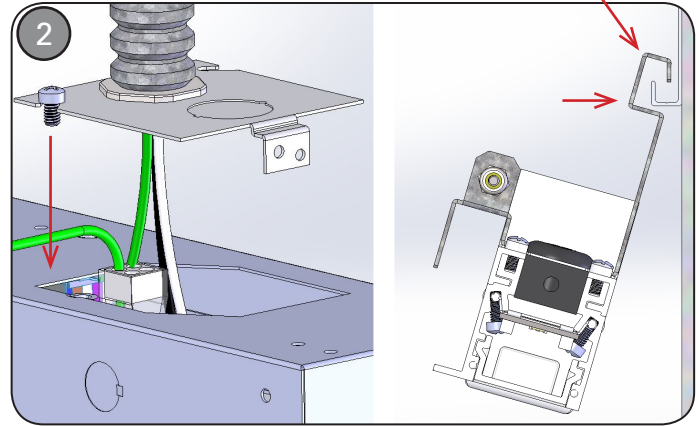

Bring power to remote enclosure. Remove access plate, make appropriate wire connections and re-secure access plate to remote enclosure. Lift fixture onto J-rail via perimeter brackets on side of fixture.

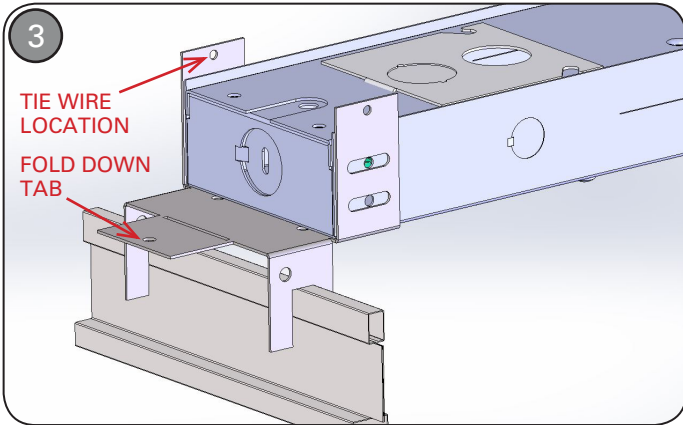

Secure remote enclosure to grid using provided clips. Grid clip allows tie wire attachments and/or attachment to grid through fold down tab.

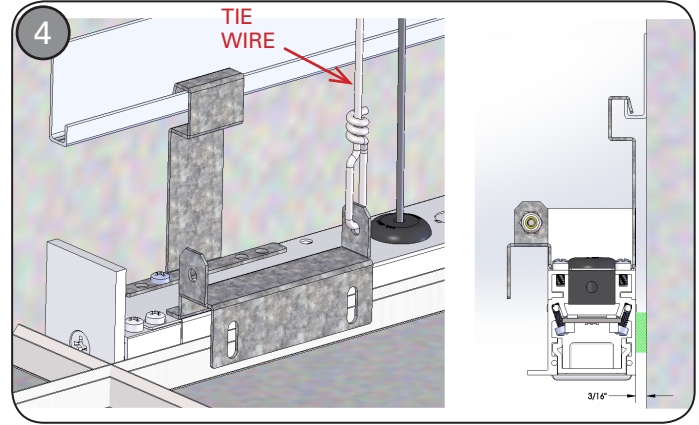

Secure fixture to structure via tie wires through grid bracket as required. Note: If desired or required, J-rail allows for up to 3/16" adjustment. Fixture can be shimmed for a shadow reveal effect if desired. Standard mounting is flush against wall. **OPTIONAL STEP:** Secure fixture to grid using #8 screws through grid bracket. Required for seismic installations.

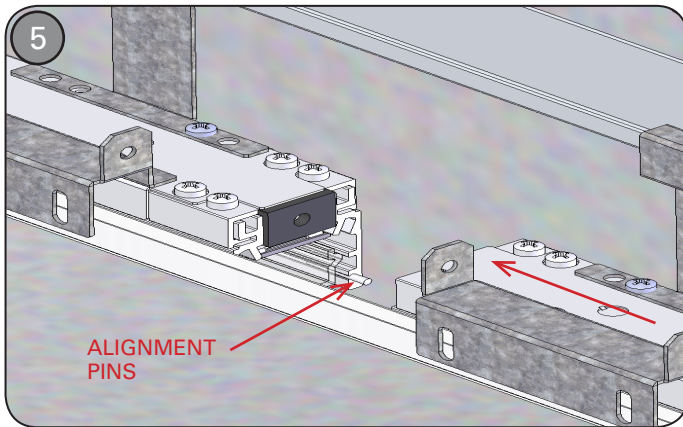

FOR CONTINUOUS RUNS: Hang next fixture in row on J-rail as in step 2. Push fixtures together ensuring alignment pins are properly connected.

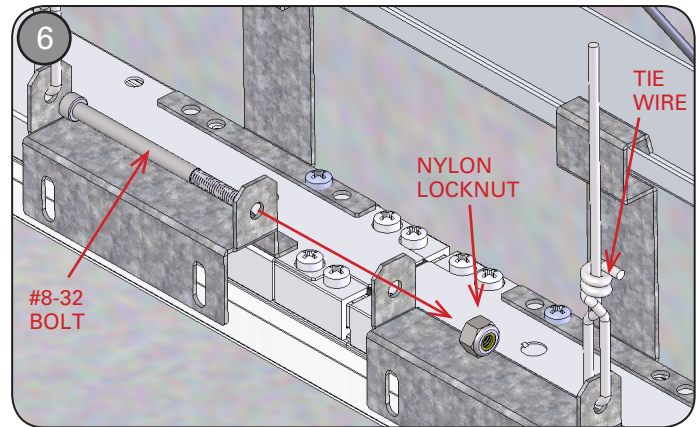

FOR CONTINUOUS RUNS: Secure run using #8-32 bolt and nut. Add tie wire for additional support where required.

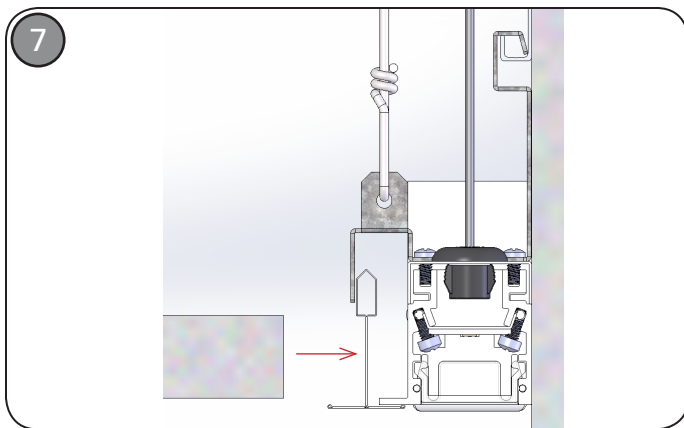

Install acoustic tiles to meet grid as required.

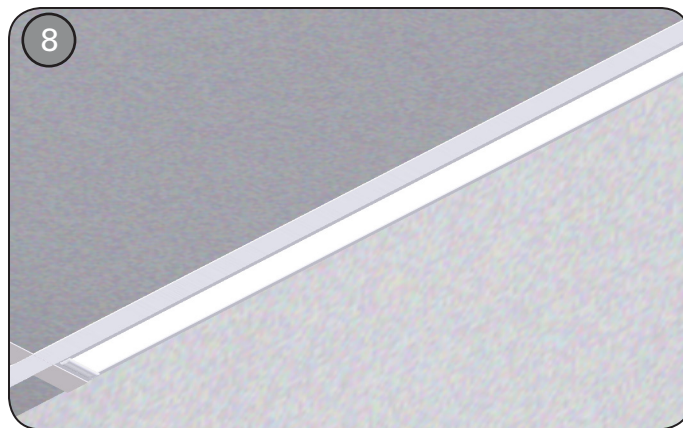

Installation completed. ETG (15/16" Flat Tee) installation shown.

Warranties and Limitation of Liability

Please refer to www.eaton.com/LightingWarrantyTerms for our terms and conditions.

Garanties et limitation de responsabilité

Veuillez consulter le site www.eaton.com/LightingWarrantyTerms pour obtenir les conditions générales.

Garantías y Limitación de Responsabilidad

Visite www.eaton.com/LightingWarrantyTerms para conocer nuestros términos y condiciones.

Eaton
1121 Highway 74 South
Peachtree City, GA 30269
P: 770-486-4800
www.eaton.com/lighting

Canada Sales
5925 McLaughlin Road
Mississauga, Ontario L5R 1B8
P: 905-501-3000
F: 905-501-3172

© 2016 Eaton
All Rights Reserved
Printed in USA
Imprimé aux États-Unis
Impreso en los EE. UU.
Publication No. TD518000EN
June 9, 2016

Eaton is a registered trademark.
All trademarks are property
of their respective owners.

Eaton est une marque de commerce
déposée. Toutes les autres marques
de commerce sont la propriété de leur
propriétaire respectif.

Eaton es una marca comercial
registrada. Todas las marcas
comerciales son propiedad de sus
respectivos propietarios.

Product availability, specifications,
and compliances are subject to
change without notice

La disponibilité du produit, les
spécifications et les conformités
peuvent être modifiées sans préavis

La disponibilidad de productos, las
especificaciones y los cumplimientos
están sujetos a cambio sin previo aviso