

Installation Instructions – Define Grid S121

⚠ WARNING

RISK OF ELECTRIC SHOCK—Disconnect power at fuse or circuit breaker before installing or servicing.

⚠ WARNING

Risk of fire/electric shock. If not qualified, consult an electrician.

⚠ WARNING

Risk of fire or electric shock. Luminaire's wiring, ballasts, or other electrical parts may be damaged when drilling for installation of reflector kit hardware. Check for enclosed wiring and components.

⚠ WARNING

The weight of the luminaire (ONLY) not to exceed 40 lbs.

NOTE: This product must be installed in accordance with the applicable installation code by a certified electrician familiar with the construction and operation of the product and hazards involved.

NOTE: Only those open holes indicated in the photographs and/or drawings may be made or altered as a result of kit installation. Do not leave any other open holes in an enclosure of wiring or electrical components.

NOTE: To prevent wiring damage or abrasion, do not expose wiring to edges of sheet metal or any sharp objects.

NOTE: Disconnect all power before proceeding.

Installation Instructions

Define Series (1" Housing Size))

Individual and Continuous Luminaires
For Installation in Grid Ceilings

Warning: Before starting any work, ensure that all power sources are turned off. All work must meet local/national electrical codes and be preformed by a certified electrician.

Parts List

- Fixture with Attached Remote Driver Enclosure
 - Grid Bracket/Joiner (pre-installed in fixture)
 - Access Plate (pre-installed in remote enclosure)
 - Support Wire (by others)
- Shielded Cable (by others)
 - Push-in Quick Connect
 - Alignment Pins (pre-installed in fixture) (Continuous runs only)
 - #8-32 2-1/2" Bolts and Nuts (Continuous runs only)
 - 9/64" Allen Wrench (by others)
 - 11/32" Flexible Nut Driver (by others)

Cross Section and Grid Spacing Details

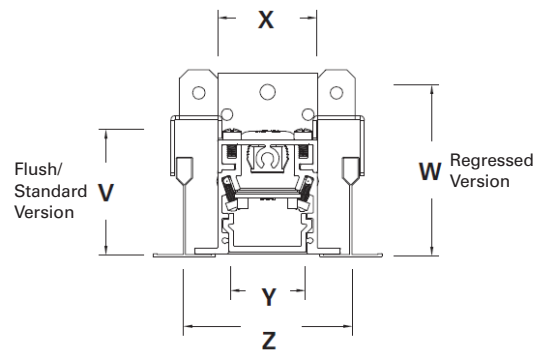

Define Cross Section Dimensions					
All Grid	V (Flush)	W (Regressed)	X	Y	Z
Define 1	1.734	2.705	1.500	1.180	2.500

Mounting Information - Extruded Trim Flange Details - Refer to submittal drawings for detailed flange information

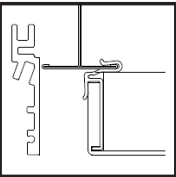

Trimless
Extruded Side

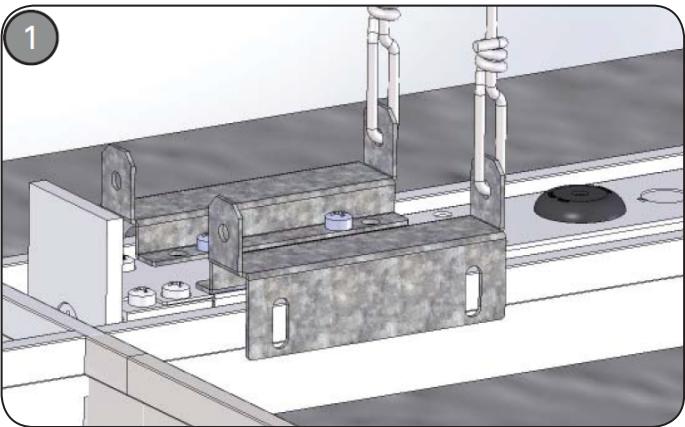

Install luminaire into Grid. Ensure Grid brackets secure over grid. Tie fixtures back to structure as shown. **OPTIONAL STEP:** Secure fixture to grid using #8 screws through grid bracket. Required for seismic installations.

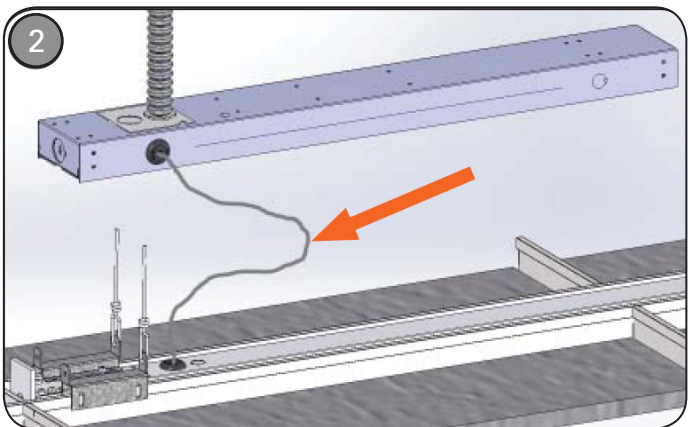

Each fixture length, in Individual or Continuous, is supplied with a pre-wired remote driver enclosure. Install driver enclosure using provided grid clips. Enclosure can be disconnected; ensure to mark enclosure and fixture if disconnected. Remote enclosure is supplied with MAXIMUM length low voltage, plenum rated cable. Cable can be shortened if desired. **DO NOT** lengthen cable.

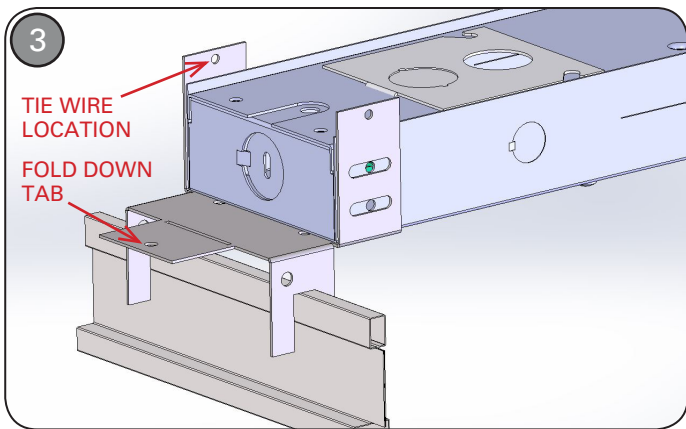

Secure remote enclosure to grid using provided clips. Grid clip allows tie wire attachments and/or attachment to grid through fold down tab.

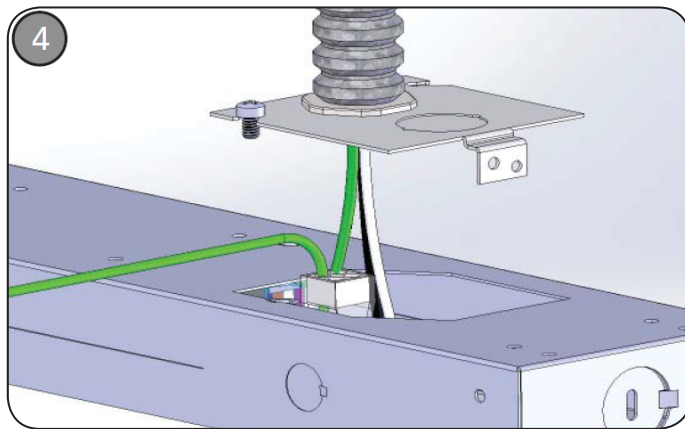

Bring power to remote enclosure. Remove access plate, make appropriate wire connections and re-secure access plate to remote enclosure.

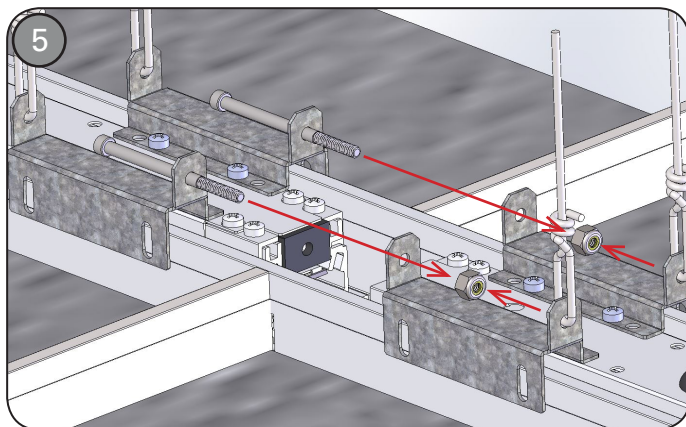

FOR CONTINUOUS RUNS: Connect through wiring using the provided push-in connectors. Tuck wiring into fixture and push together ensuring alignment pins are properly connected. Secure run using #8-32 bolts and nuts on each side of fixture through grid brackets.

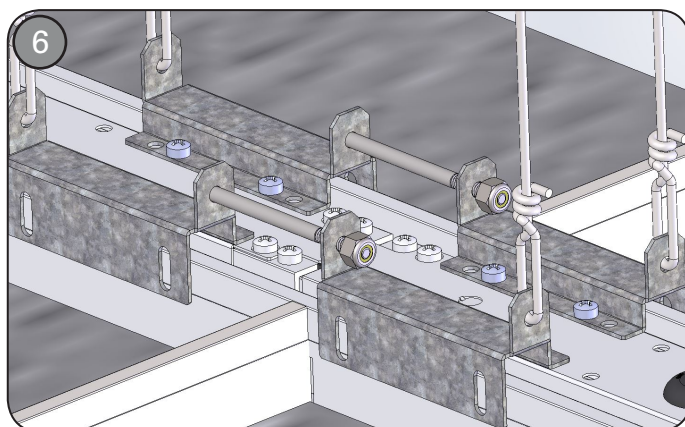

FOR CONTINUOUS RUNS: Secure next fixture in row using support wires on both sides of fixture.

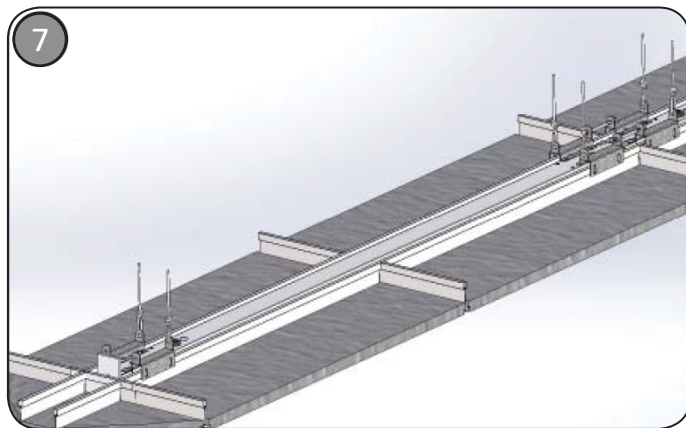

Installation completed for continuous run. Top view.

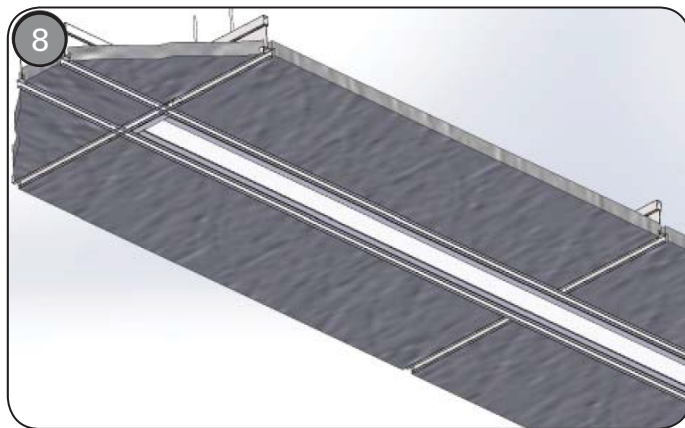

Installation completed. Bottom view.

Warranties and Limitation of Liability

Please refer to www.eaton.com/LightingWarrantyTerms for our terms and conditions.

Garanties et limitation de responsabilité

Veuillez consulter le site www.eaton.com/LightingWarrantyTerms pour obtenir les conditions générales.

Garantías y Limitación de Responsabilidad

Visite www.eaton.com/LightingWarrantyTerms para conocer nuestros términos y condiciones.

Eaton

1121 Highway 74 South
Peachtree City, GA 30269
P: 770-486-4800
www.eaton.com/lighting

Canada Sales

5925 McLaughlin Road
Mississauga, Ontario L5R 1B8
P: 905-501-3000
F: 905-501-3172

© 2016 Eaton

All Rights Reserved
Printed in USA

Imprimé aux États-Unis
Impreso en los EE. UU.
Publication No. TD518000EN
May 12, 2016

Eaton is a registered trademark.
All trademarks are property
of their respective owners.

Eaton est une marque de commerce
déposée. Toutes les autres marques
de commerce sont la propriété de leur
propriétaire respectif.

Eaton es una marca comercial
registrada. Todas las marcas
comerciales son propiedad de sus
respectivos propietarios.

Product availability, specifications,
and compliances are subject to
change without notice

La disponibilité du produit, les
spécifications et les conformités
peuvent être modifiées sans préavis

La disponibilidad de productos, las
especificaciones y los cumplimientos
están sujetos a cambio sin previo aviso