

INSTALLATION INSTRUCTIONS FOR CONTINUOUS RUNS PANELIT S52DIP-T5 WITH SINGLE CABLE

TO INSTALL FIXTURE RUNS, CONTRACTOR HAS TO HAVE THE FOLLOWING PARTS:

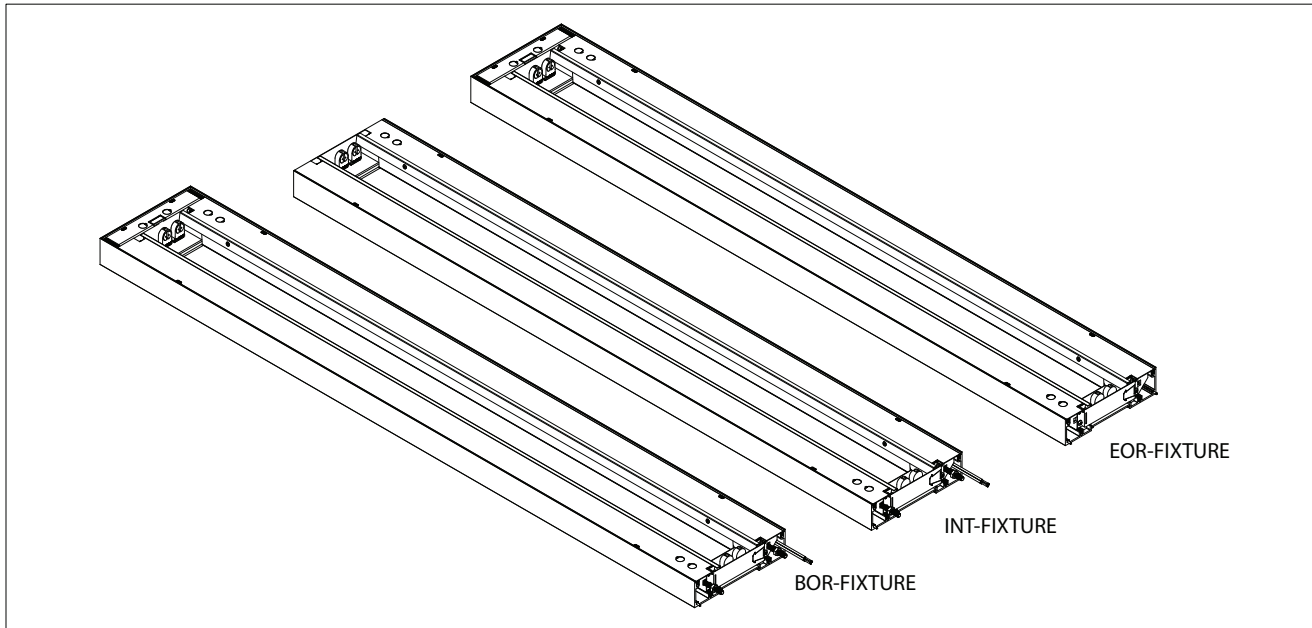

A) FIXTURES TO MAKE RUNS:

"BOR" - BEGINNING OF RUN
"INT" - INTERMEDIATE
"EOR" - END OF RUN FIXTURE.

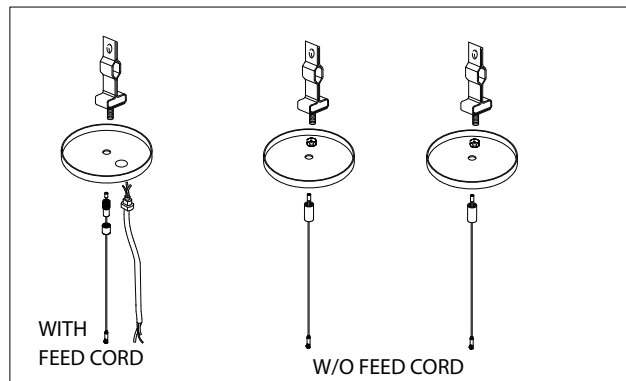

B) MOUNTING HARDWARE

INSTALLATION INSTRUCTIONS FOR CONTINUOUS RUNS PANELIT S52DIP-T5 WITH SINGLE CABLE

STEP 1: INSTALL MOUNTING HARDWARE
ACCORDING TO RUN CONFIGURATION

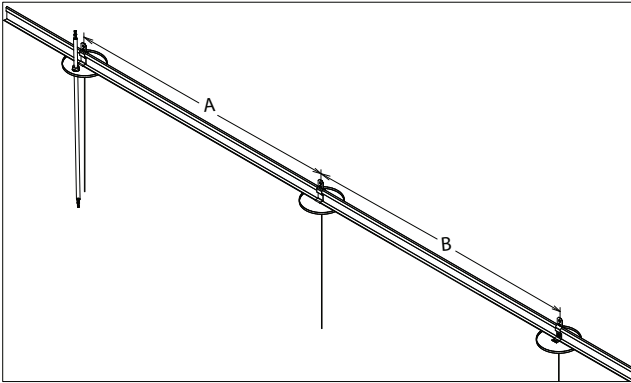

STEP 2: REMOVE BALLAST COVERS FROM FIXTURES
AND NUTS FROM CARRIAGE BOLTS.

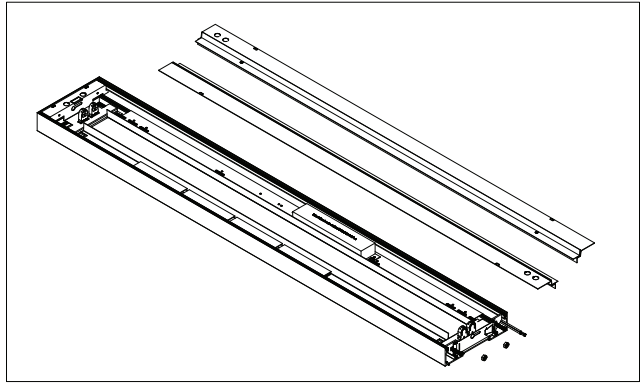

STEP 3: REMOVE GRIPLOCK FROM MOUNTING HARDWARE AND INSTALL GRIPLOCK ONTO FIXTURES

STEP 3a:
SCREW ON GRIPLOCK
HAS TO BE UNSCREWED AS FAR
AS POSSIBLE AT GRIPLOCK BODY.
OPEN TAB THAT COVERS GRIPLOCK WINDOW
USING A FLAT HEAD SCREWDRIVER

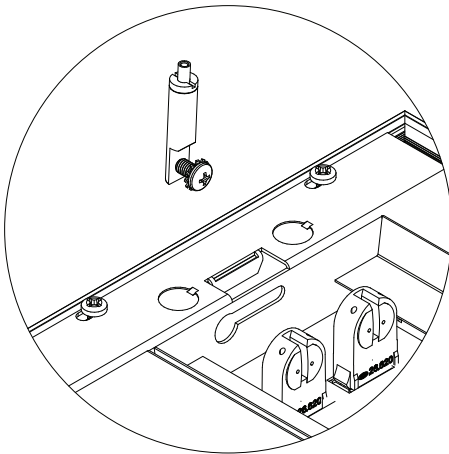

STEP 3b:
INSERT GRIPLOCK WITH SCREW AND
WASHER INTO GRIPLOCK WINDOW
AND INSERT GRIPLOCK SCREW INTO KEYHOLE

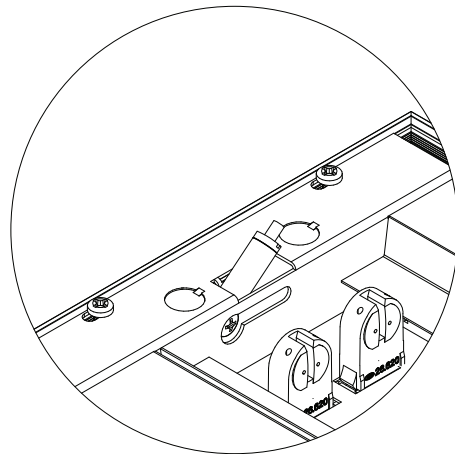

STEP 3c:
SLIDE SCREW TO MIDDLE OF SLOT

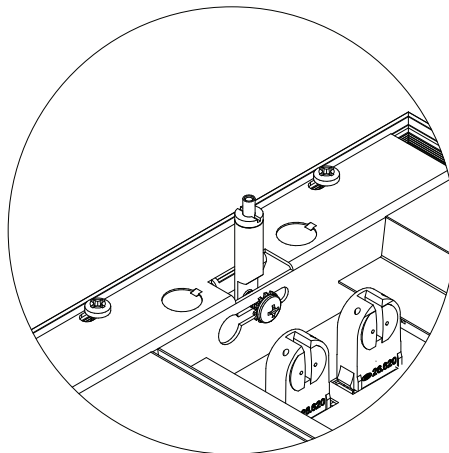

STEP 3d:
TIGHT SCREW TO FIX GRIPLOCK
ON MOUNTING BRACKET

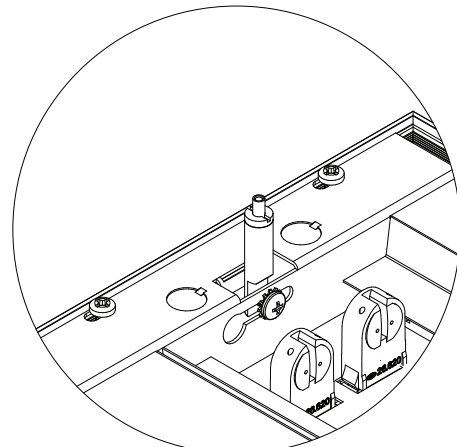

INSTALLATION INSTRUCTIONS FOR CONTINUOUS RUNS PANELIT S52DIP-T5 WITH SINGLE CABLE

STEP 4: BEND OUT TAPERED TABS.

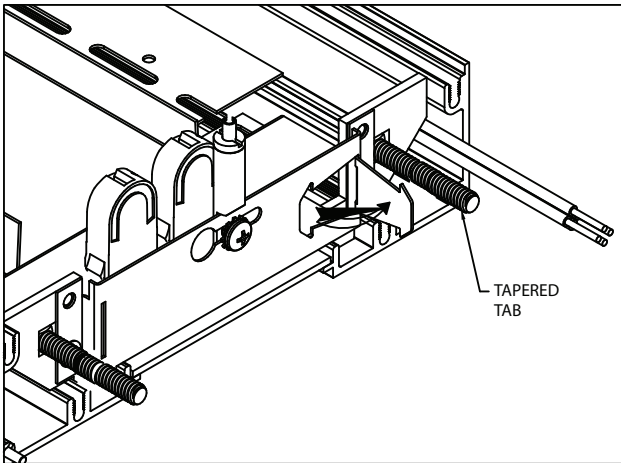

STEP 5: INSTALL FIRST "BOR" FIXTURE WITH TWO AIRCRAFT CABLES, THEN INSTALL THE SECOND FIXTURE WITH ONE ADDITIONAL CABLE AT THE OPPOSITE END OF THE JOINT.

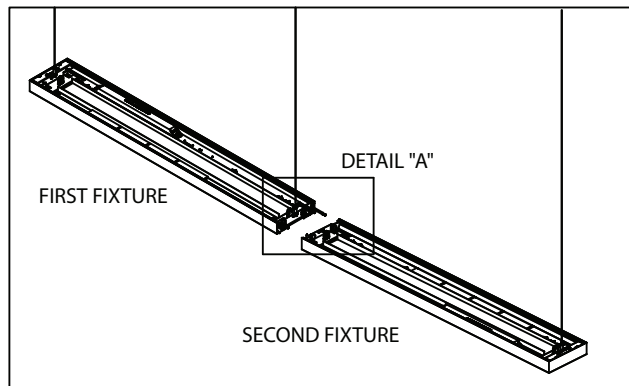

DETAIL "A"

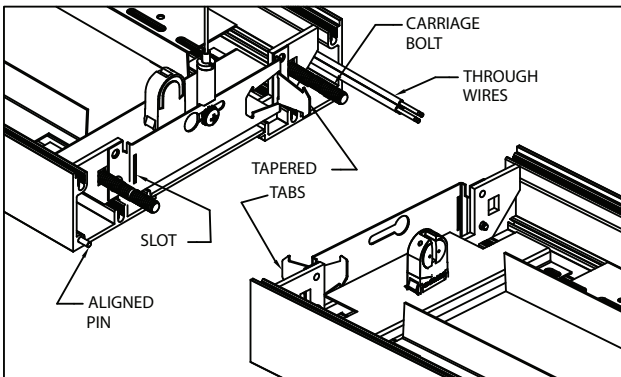

STEP 6: PUSH THROUGH WIRES FROM FIRST INTO SECOND FIXTURE. PUSH TAPERED TABS INTO SLOTS AND CARRIAGE BOLTS INTO RECTANGLE HOLES. FIXTURE 2 IS NOW SUPPORTED BY FIXTURE 1 AT THE JOINT.

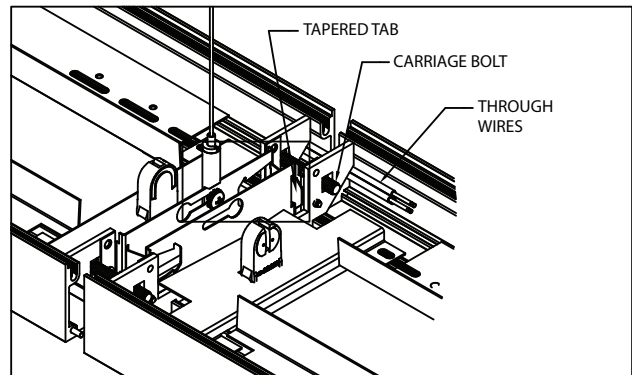

STEP 7: SLIDE GRIPLOCK TO END OF SLOT TO ALIGN TO RECEIVING HOLE OF JOINING FIXTURE

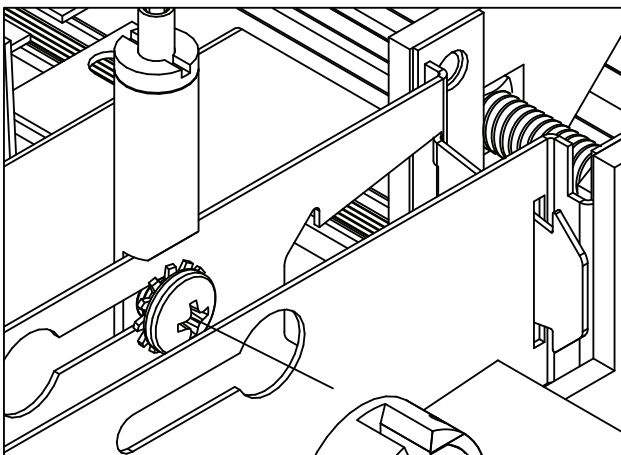

STEP 8: JOIN FIXTURES BY PULLING TOGETHER. INSERT ALIGNED PINS INTO HOLES AND FIX BY TIGHTENING NUTS ONTO CARRIAGE BOLTS.

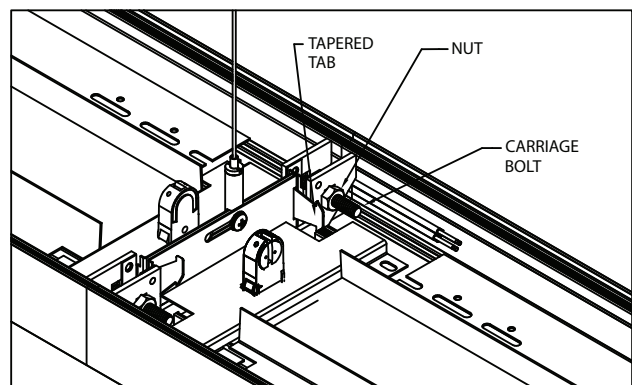

INSTALLATION INSTRUCTIONS FOR CONTINUOUS RUNS PANELIT S52DIP-T5 WITH SINGLE CABLE

STEP 9: MOVE GRIPLOCK TO CENTER OF SLOT AND ADJUST POSITION OF GRIPLOCK TO LEVEL FIXTURE IF IT IS NECESSARY, TIGHTEN GRIPLOCK SCREW

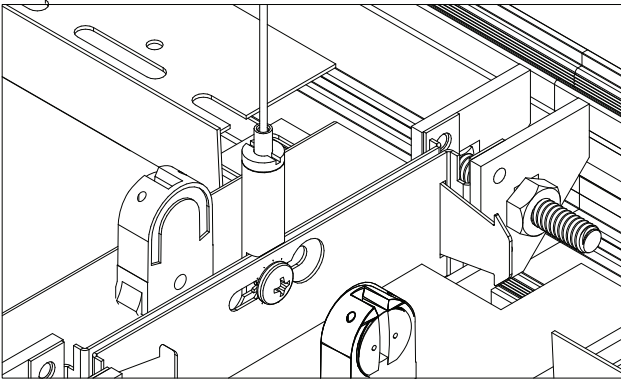

NOTE: STEPS 6 AND 7 HAVE TO BE REPEATED IF THERE ARE MORE FIXTURES IN THE RUN.

POWER MUST BE OFF BEFORE THIS STEP!

STEP 10: INSERT FEED CORD INTO FEED HOLE AND PULL FEED CORD INTO BALLAST AREA

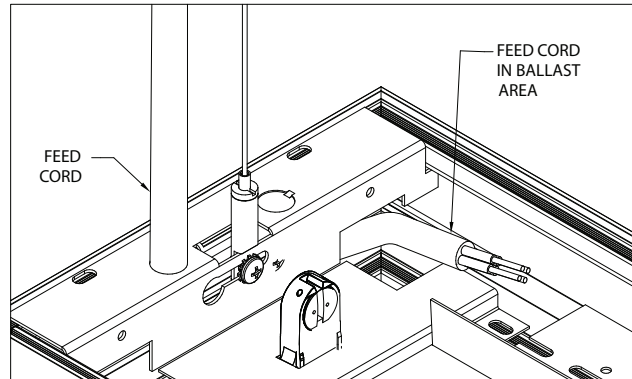

STEP 11: MAKE ELECTRICAL WIRE CONNECTION AT FEED CORD AND ALL THROUGH WIRE LOCATIONS FROM "BOR" FIXTURE TO ALL FIXTURES IN THE RUN.

STEP 12: INSTALL BALLAST COVERS

STEP 13: INSTALL LAMPS

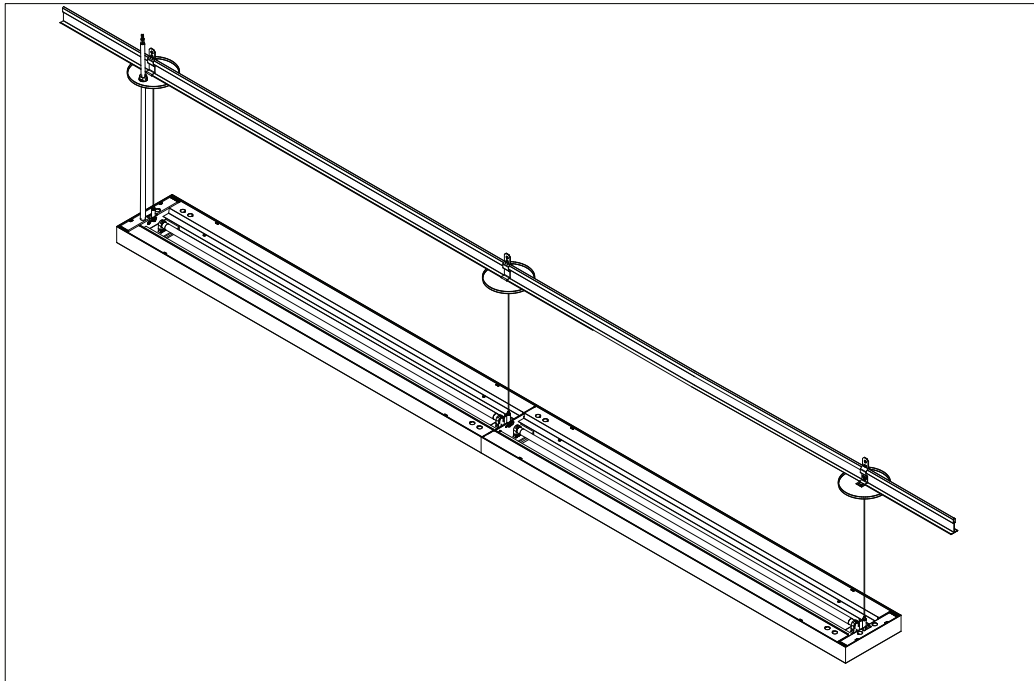

STEP 14: ALIGN FIXTURE TO HAVE IT STRAIGHT AND LEVEL BY ADJUSTING AIRCRAFT CABLE.