

## LENS REPLACEMENT INSTALLATION INSTRUCTIONS

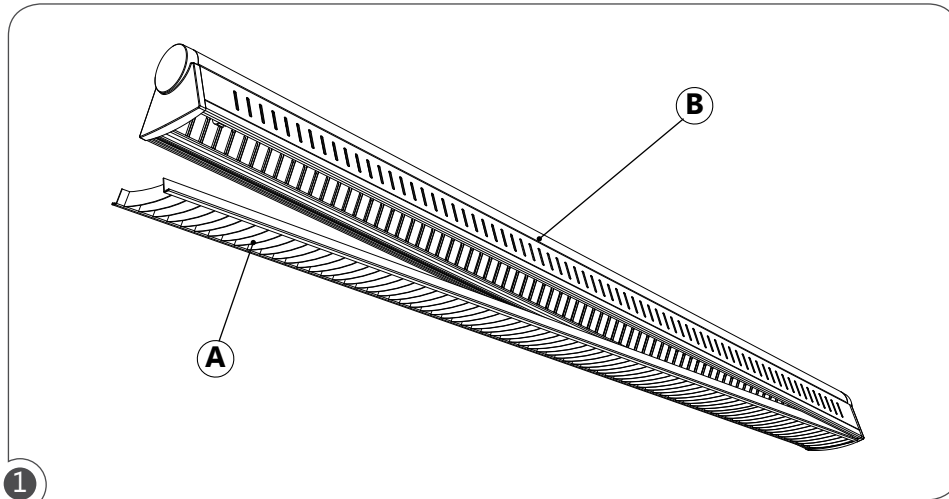

1 For Louver optics; Insert your fingers in the optics (A) at both ends and pull away from the fixture (B) from one end to the next end.

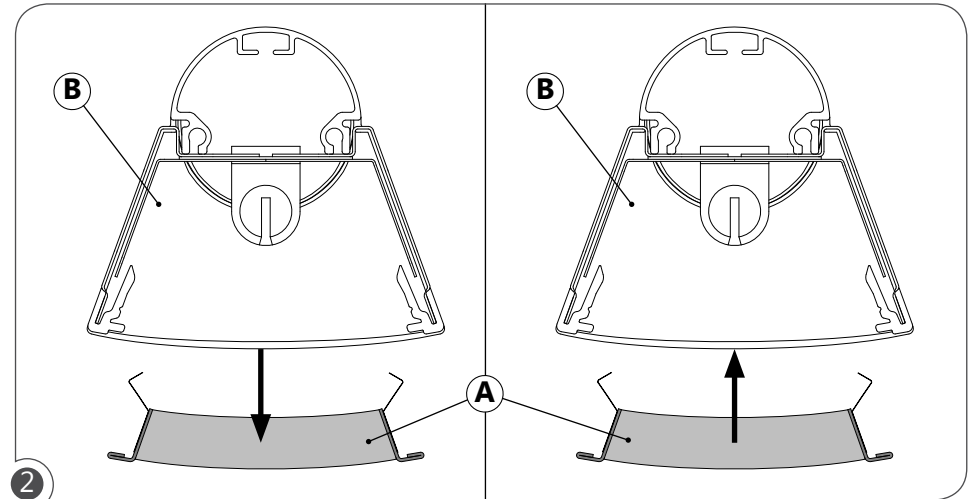

2 Once freed from the fixture (B), pull optics (A) downwards. To install, push optics (A) into the fixture (B). The optics (A) will snap into it's final place.

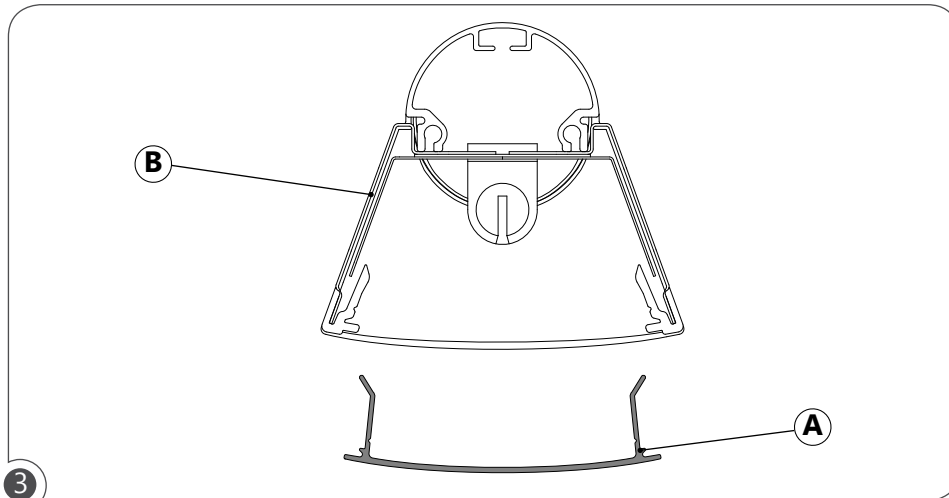

3 For Diffuser optics; Starting at one end, line up the sides of the optics (A) onto the inside of the fixture (B).

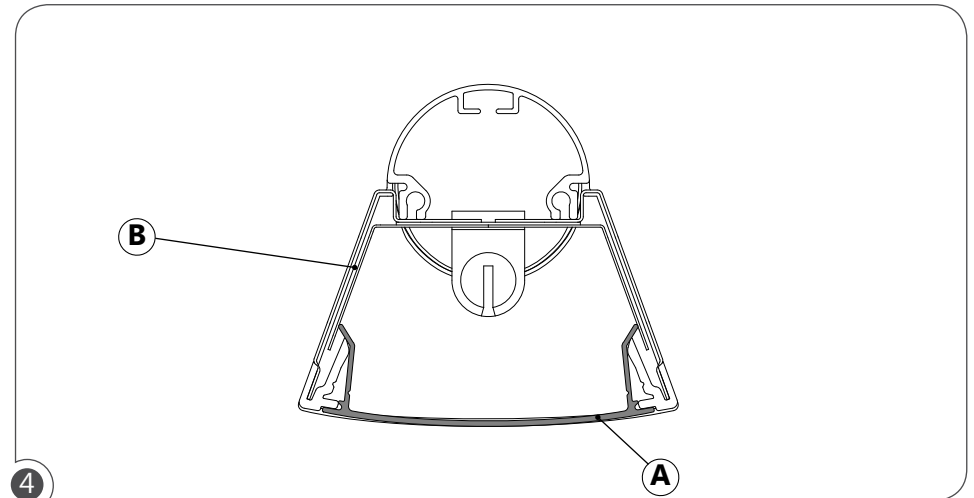

4 Pushing the optics (A) onto the fixture (B) from one end to the next end. The optics (A) will snap into it's final place.

