

1

Using the provided tool. Starting at one end of the fixture, insert the bent end of the tool into the fixture lens as shown in the above illustration.

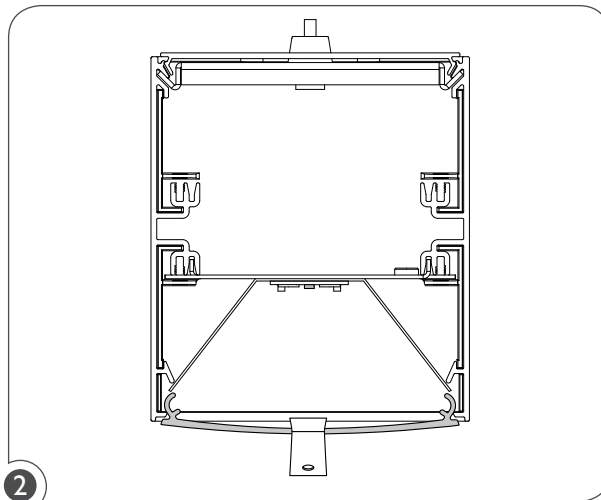

2

Push the tool away from the fixture and lever the lens outwards from the fixture.

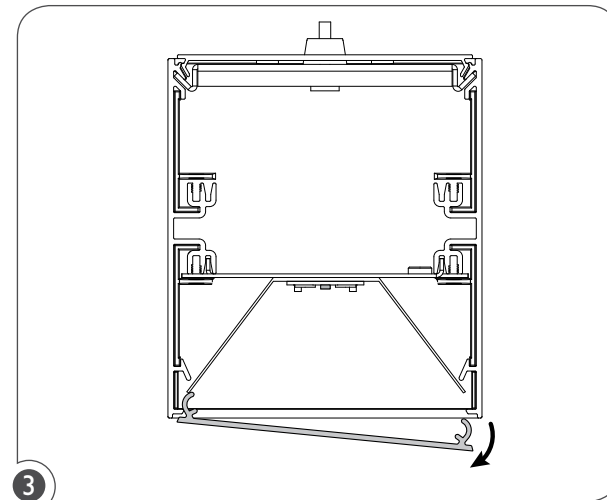

3

Continue removing the lens from one side of the fixture.

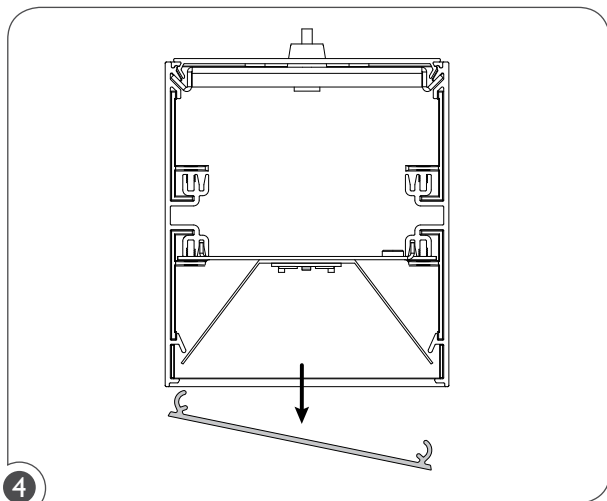

4

Remove the lens entirely from the fixture.

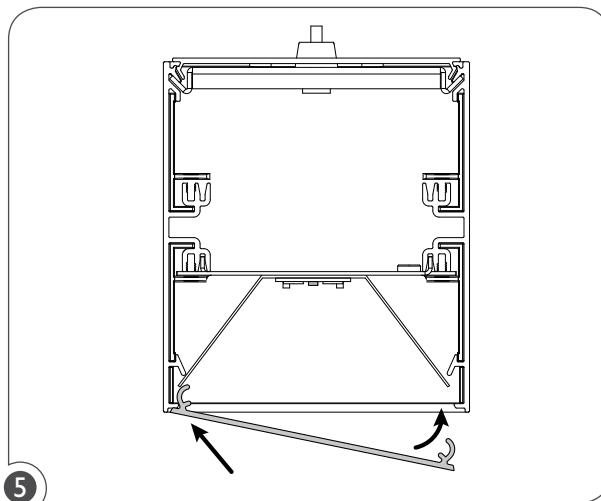

5

To install, slide lens inside the fixture by starting with one side and push inwards into the fixture until the lens snaps in place.

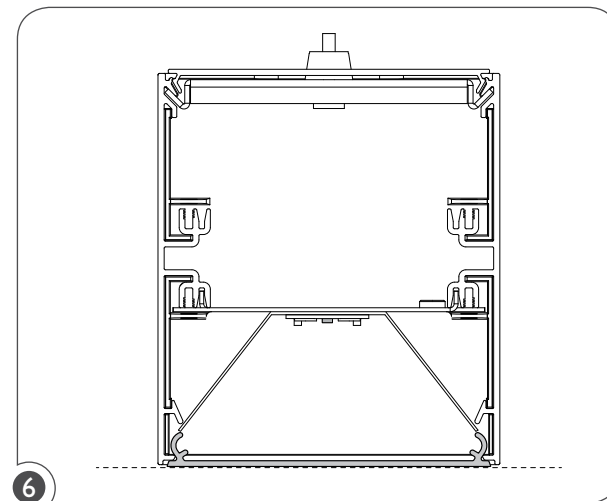

6

Make sure that the lens is firmly seated and leveled along the whole length of the fixture.

WARNING:

RISK OF FIRE AND ELECTRICAL SHOCK. FIXTURE MUST BE INSTALLED BY A QUALIFIED ELECTRICIAN ONLY IN ACCORDANCE WITH NATIONAL, LOCAL BUILDING AND ELECTRICAL CODES. DISCONNECT POWER AT ELECTRICAL PANEL BEFORE SERVICING.



Product design and development is an ongoing process at Axis Lighting. We reserve the right to change specifications. Contact Axis for the latest product information.

© 2010 Axis Lighting Inc.