

# Grab Bars

## Installation Instructions

Please read all instructions before installing products.

FIG. 1

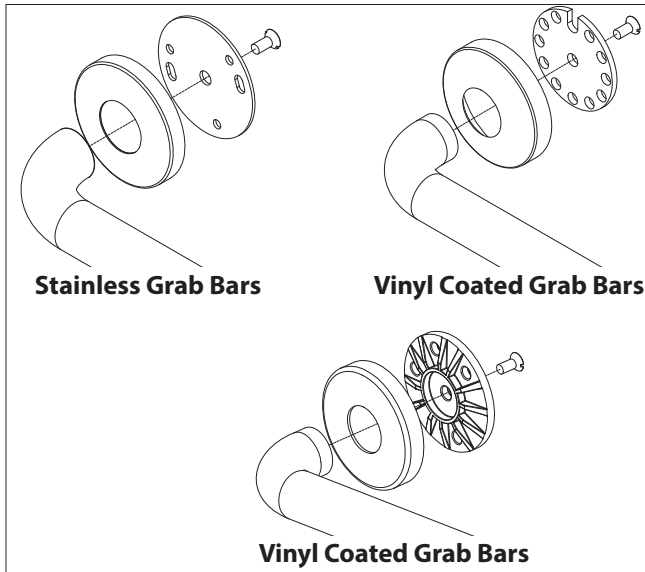

**Note:**

- Material must be stored, installed, and used in environmentally controlled conditions.
- Install grab bars into solid wall sub-structure or backing plates, if this is not possible use the Wing-Its fastening system as an alternate installation method.
- Mounting flanges rotates 360° to accommodate wall conditions.

**Standard Installation:**

1. Install mounting flanges onto the grab bar.  
*See Figure 1.*
2. Using a level determine the location of the grab bar.
3. Using the flanges as a template, transfer 3 holes per flange to the wall. *See Figure 2.*
4. Drill holes at each fastener location using the drill size for the appropriate fastener.
5. Where applicable install inserts into the holes from the previous step. *See Figure 3.*
6. Using the appropriate fasteners screw the grab bar onto the wall. *See Figure 3.*

**Note:**

- Some grab bars have a plastic concealing flange that needs to be installed between the wall and the mounting flange.
7. Snap the flange covers over the flanges.  
*See Figure 4.*

FIG. 2

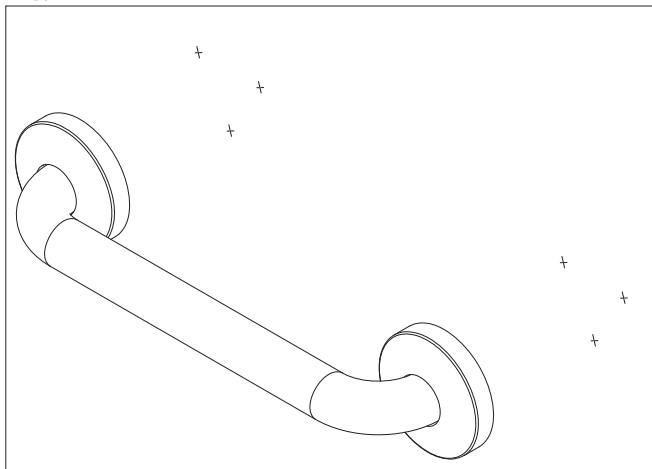

FIG.3

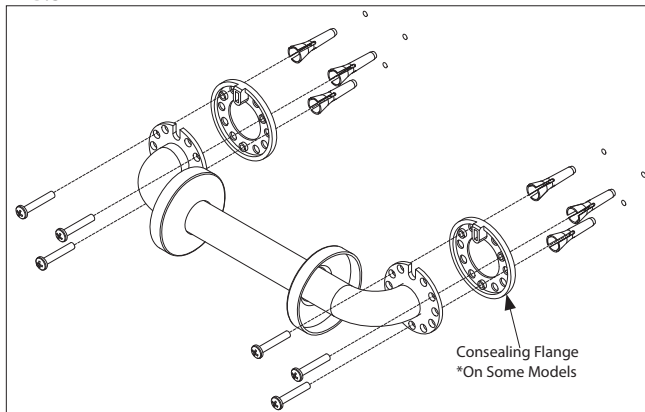
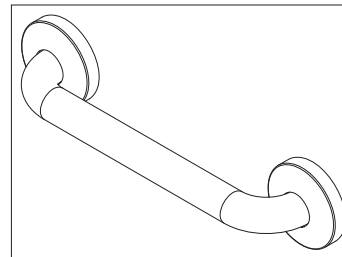

FIG.4



IPC.571/Rev.2

Installation Hotline • 866.EZINPRO  
Inprocorp.com • 800.222.5556 • 262.679.9010  
World Headquarters S80 W18766 Apollo Drive, Muskego, WI 53150 USA

**ENDURANT®**  
WASHROOM SYSTEMS

# Installation Instructions

## Grab Bars

FIG. 1

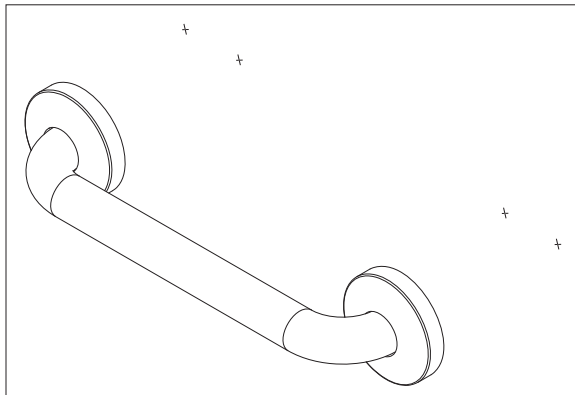

FIG. 2

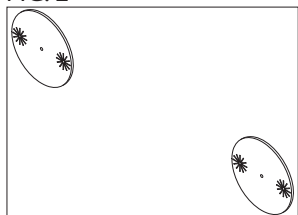

FIG. 3

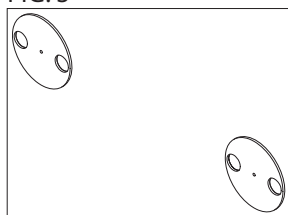

FIG. 4

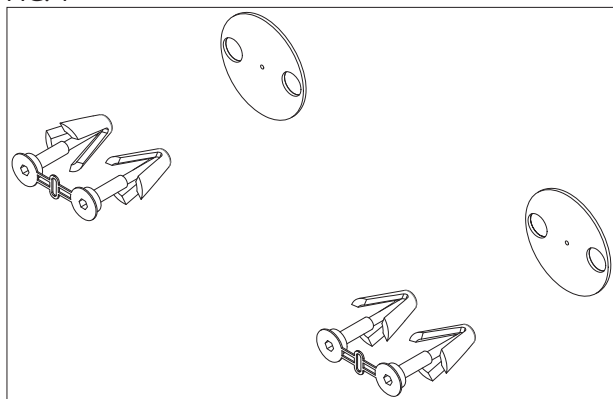
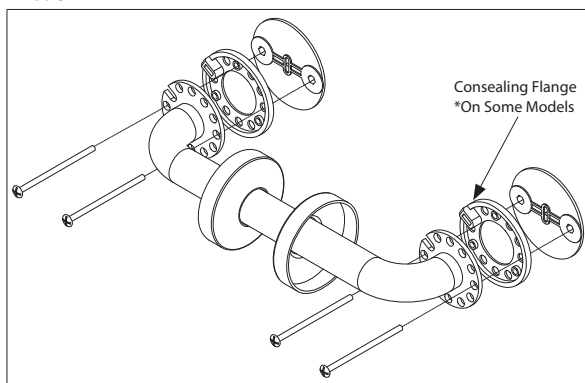

FIG. 5



### Wing-Its Installation:

1. Using the flanges as a template, transfer the 2 holes per flange that are directly across from each other to the wall. *See Figure 1.*
2. Remove the center holes and the liner from the adhesive pad and stick it to the wall, lining up the holes with your marks. *See Figure 2.*
3. Using a 3/4" drill bit drill holes at each mark. *See Figure 3.*
4. Remove the remaining liner from the adhesive pad.
5. Assemble the Wing-Its by pressing the wings into the faceplates by hand.
6. Before pressing the wings into the wall they need to be fully extended. Compress the wings and insert the wings into the holes until both wings are flush with the face of the wall. Then evenly press the faceplate into the holes making it flush with the wall. *See Figure 4.*

### Note:

- The wings will move through the wall when the faceplate is pressed into the wall, leaving the wings on the backside of the wall.
7. Using the supplied screws attach the grab bar to the Wing-Its. As the screws are tightened the wings will tighten against the wall for a secure fit. *See Figure 5.*

### Note:

- Some grab bars have a plastic concealing flange that needs to be installed between the Wing-Its and the mounting flange.
8. Snap the flange covers over the flanges. *See Figure 6.*

FIG. 6

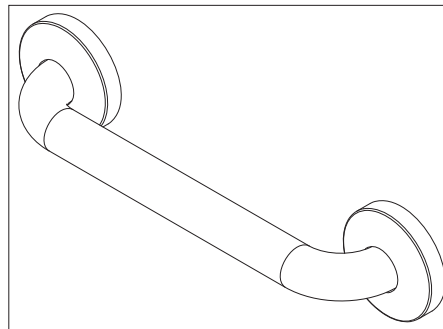

Installation Hotline • 866.EZINPRO

Inprocorp.com • 800.222.5556 • 262.679.9010

World Headquarters S80 W18766 Apollo Drive, Muskego, WI 53150 USA

**ENDURANT®**  
WASHROOM SYSTEMS