

#8 X 2" [M4x.7 x 50]
SELF-TAPPING SHEET METAL SCREW
(7 PER FRAME @ 18" [457] O.C.)
(JK061)

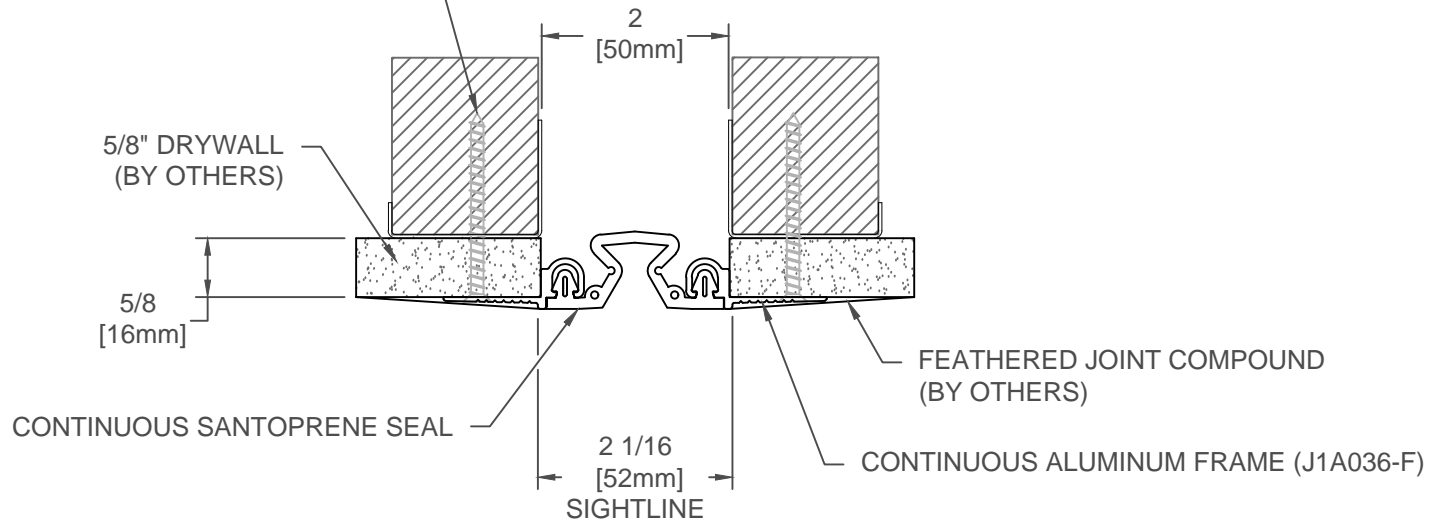

| SPECIFY SEAL COLOR: | |
|-----------------------|--|
| Black (J6D201) | |
| Beige (J6D202) | |
| Gray (J6D203) | |
| Off White (J6D204) | |
| Bright White (J2D205) | |

114-A07-050

| Joint Width | | Movement ± | | | |
|-------------|----|------------|----|----------|----|
| | | Horizontal | | Vertical | |
| US | mm | US | mm | US | mm |
| 2" | 51 | 1" | 25 | 1" | 25 |

FINISH:

JOINTMASTER™
EXPANSION JOINT SYSTEMS

DATE: 03-02-17
SCALE: 1:2
DOC: CADJM.079/Rev3

APPLICATION-
WALL/WALL, CEILING/CEILING
SEISMIC WALL AND CEILING
SYSTEMS

PROJECT:

CUSTOMER:

LOCATION:

inpro.

#8 X 2" [M4x.7 x 50]
SELF-TAPPING SHEET METAL SCREW
(7 PER FRAME @ 18" [457] O.C.)
(JK061)

5/8" DRYWALL
(BY OTHERS)

5/8
[16mm]

CONTINUOUS SANTOPRENE SEAL

3
[76mm]

3 1/16
[78mm]
SIGHTLINE

FEATHERED JOINT COMPOUND
(BY OTHERS)

CONTINUOUS ALUMINUM FRAME (J1A036-F)

SPECIFY SEAL COLOR:

| | |
|-----------------------|--|
| Black (J6D301) | |
| Beige (J6D302) | |
| Gray (J6D303) | |
| Off White (J6D304) | |
| Bright White (J2D305) | |

114-A07-075

| Joint Width | | Movement ± | | | |
|-------------|----|------------|----|----------|----|
| | | Horizontal | | Vertical | |
| US | mm | US | mm | US | mm |
| 3" | 76 | 1-1/2" | 38 | 1-1/2" | 38 |

FINISH:

JOINTMASTER™
EXPANSION JOINT SYSTEMS

DATE: 03-02-17

SCALE: 1:2

DOC: CADJM.079/Rev3

APPLICATION-
WALL/WALL, CEILING/CEILING
SEISMIC WALL AND CEILING
SYSTEMS

PROJECT:

CUSTOMER:

LOCATION:

inpro.

#8 X 2" [M4x.7 x 50]
SELF-TAPPING SHEET METAL SCREW
(7 PER FRAME @ 18" [457] O.C.)
(JK061)

5/8" DRYWALL
(BY OTHERS)

5/8
[16mm]

CONTINUOUS SANTOPRENE SEAL

4
[101mm]

4 1/16
[103mm]
SIGHTLINE

FEATHERED JOINT COMPOUND
(BY OTHERS)

CONTINUOUS ALUMINUM FRAME (J1A036-F)

SPECIFY SEAL COLOR:

| | |
|-----------------------|--|
| Black (J6D401) | |
| Beige (J6D402) | |
| Gray (J6D403) | |
| Off White (J6D404) | |
| Bright White (J2D405) | |

114-A07-100

| Joint Width | | Movement ± | | | |
|-------------|-----|------------|----|----------|----|
| | | Horizontal | | Vertical | |
| US | mm | US | mm | US | mm |
| 4" | 102 | 2" | 51 | 2" | 51 |

FINISH:

JOINTMASTER™
EXPANSION JOINT SYSTEMS

DATE: 03-02-17

SCALE: 1:2

DOC: CADJM.079/Rev3

APPLICATION-
WALL/WALL, CEILING/CEILING
SEISMIC WALL AND CEILING
SYSTEMS

PROJECT:

CUSTOMER:

LOCATION:

inpro.

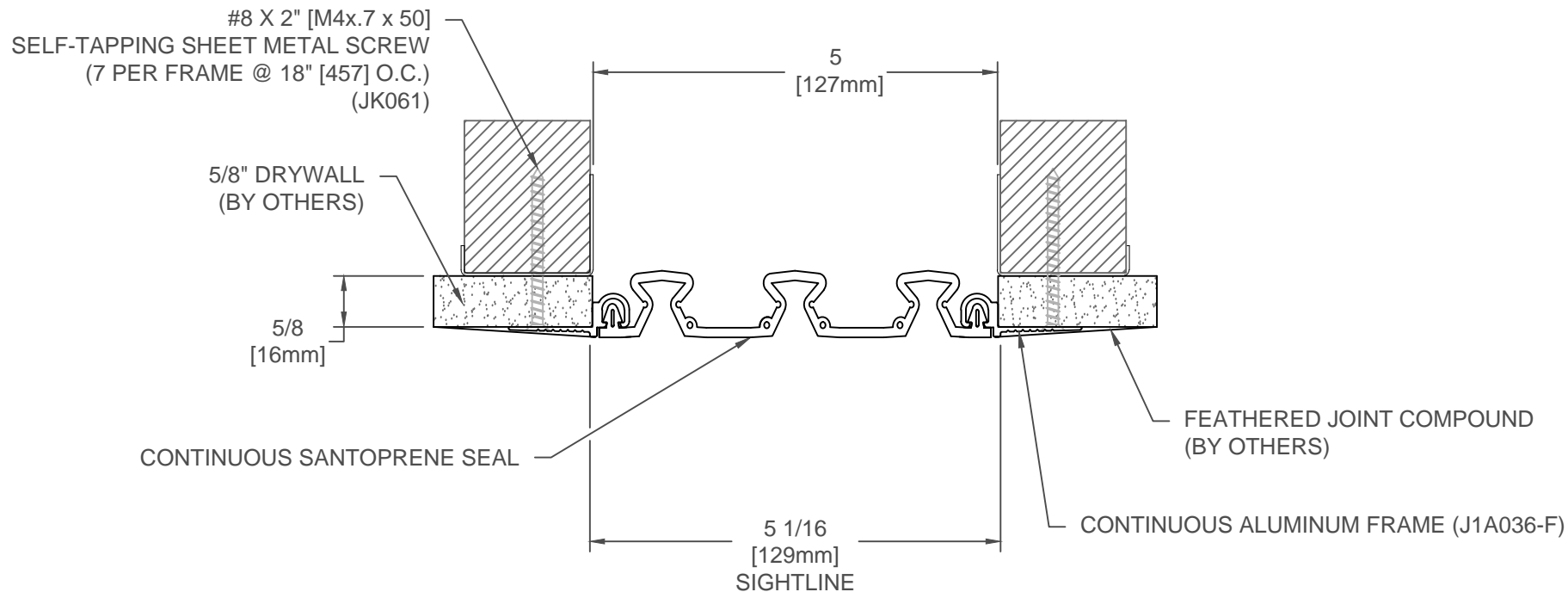

| SPECIFY SEAL COLOR: | |
|-----------------------|--|
| Black (J6D501) | |
| Beige (J6D502) | |
| Gray (J6D503) | |
| Off White (J6D504) | |
| Bright White (J2D505) | |

114-A07-125

| Joint Width | | Movement ± | | | |
|-------------|-----|------------|----|----------|----|
| | | Horizontal | | Vertical | |
| US | mm | US | mm | US | mm |
| 5" | 127 | 2 1/2" | 64 | 2 1/2" | 64 |

FINISH:

JOINTMASTER™
EXPANSION JOINT SYSTEMS

DATE: 03-02-17
SCALE: 1:2
DOC: CADJM.079/Rev3

APPLICATION-
WALL/WALL, CEILING/CEILING
SEISMIC WALL AND CEILING
SYSTEMS

PROJECT:

CUSTOMER:

LOCATION:

inpro.

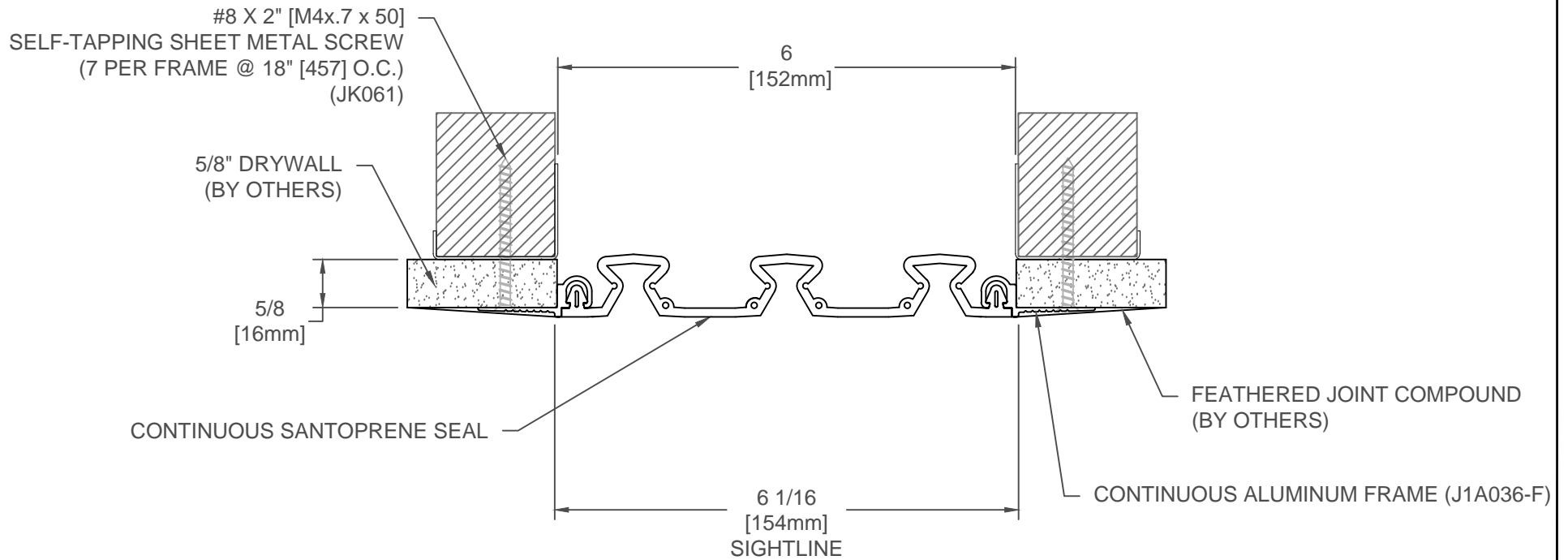

| SPECIFY SEAL COLOR: | |
|-----------------------|--|
| Black (J6D601) | |
| Beige (J6D602) | |
| Gray (J6D603) | |
| Off White (J6D604) | |
| Bright White (J2D605) | |

114-A07-150

| Joint Width | | Movement ± | | | |
|-------------|-----|------------|----|----------|----|
| | | Horizontal | | Vertical | |
| US | mm | US | mm | US | mm |
| 6" | 152 | 3" | 76 | 3" | 76 |

FINISH:

JOINTMASTER™
EXPANSION JOINT SYSTEMS

DATE: 03-02-17
SCALE: 1:2
DOC: CADJM.079/Rev3

APPLICATION-
WALL/WALL, CEILING/CEILING
SEISMIC WALL AND CEILING
SYSTEMS

PROJECT:

CUSTOMER:

LOCATION:

inpro.