

691-A01-025

Joint Width		Movement ±			
		Horizontal		Vertical	
US	mm	US	mm	US	mm
1"	25	1/2"	13	1/2"	13

FINISH: MILL

JOINTMASTER EXPANSION JOINT SYSTEMS <small>A DIVISION OF INPRO</small>	DATE: 7-21-15	APPLICATION: CURB MOUNTED CENTERING BAR ROOF/ROOF CONDITION	PROJECT:	
	SCALE: 1:4		CUSTOMER:	
	DOC: CADJM.003/Rev3		LOCATION:	

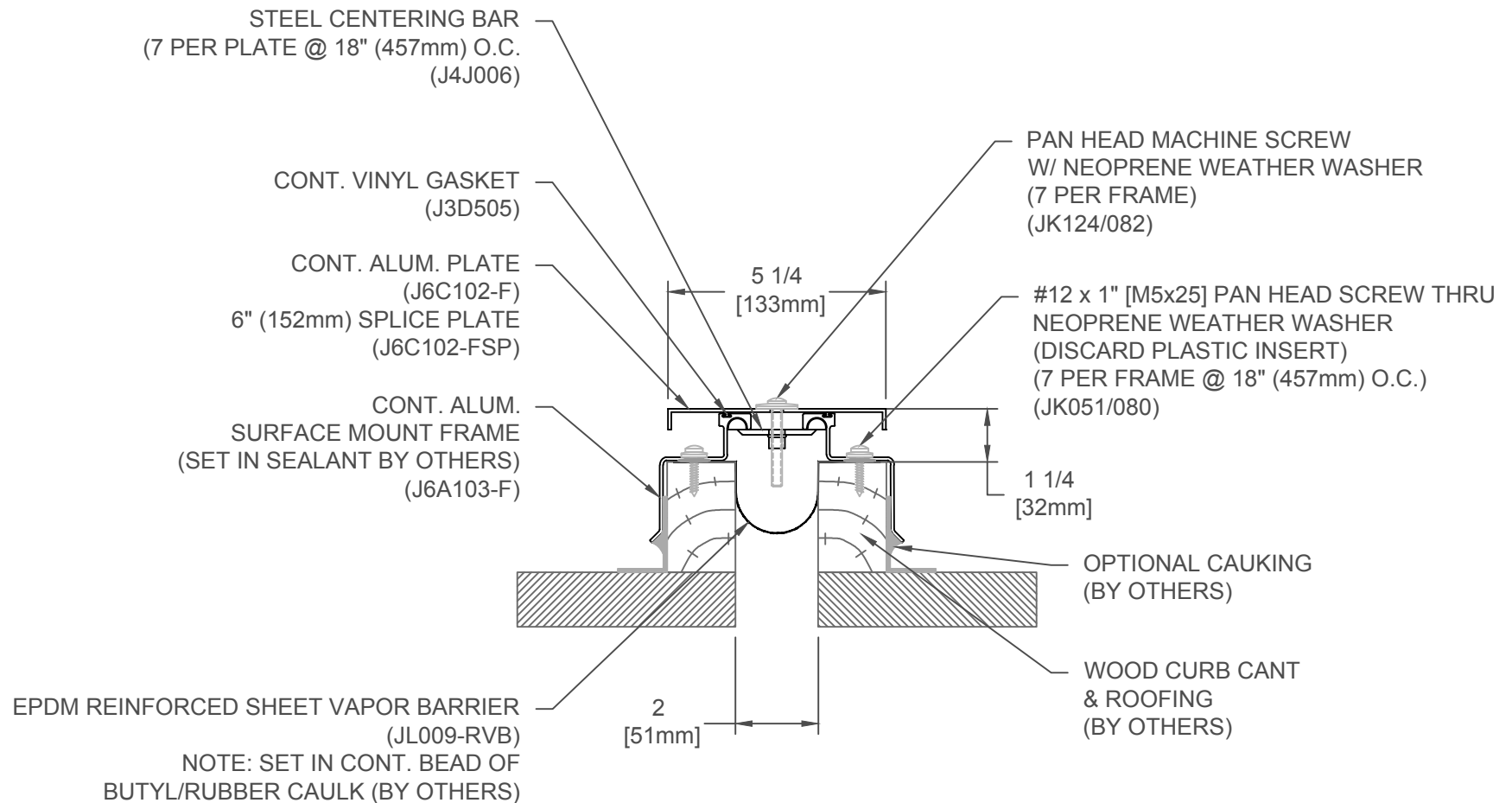

691-A01-050

Joint Width		Movement ±			
		Horizontal		Vertical	
US	mm	US	mm	US	mm
2"	51	1"	25	1"	25

FINISH: MILL

• **JOINTMASTER®**
EXPANSION JOINT SYSTEMS
A DIVISION OF INPRO®

DATE: 5-22-09

SCALE: 1:4

DOC: CADJM.003/Rev3

APPLICATION:
CURB MOUNTED CENTERING BAR
ROOF/ROOF CONDITION

PROJECT:

CUSTOMER:

LOCATION:

inpro.

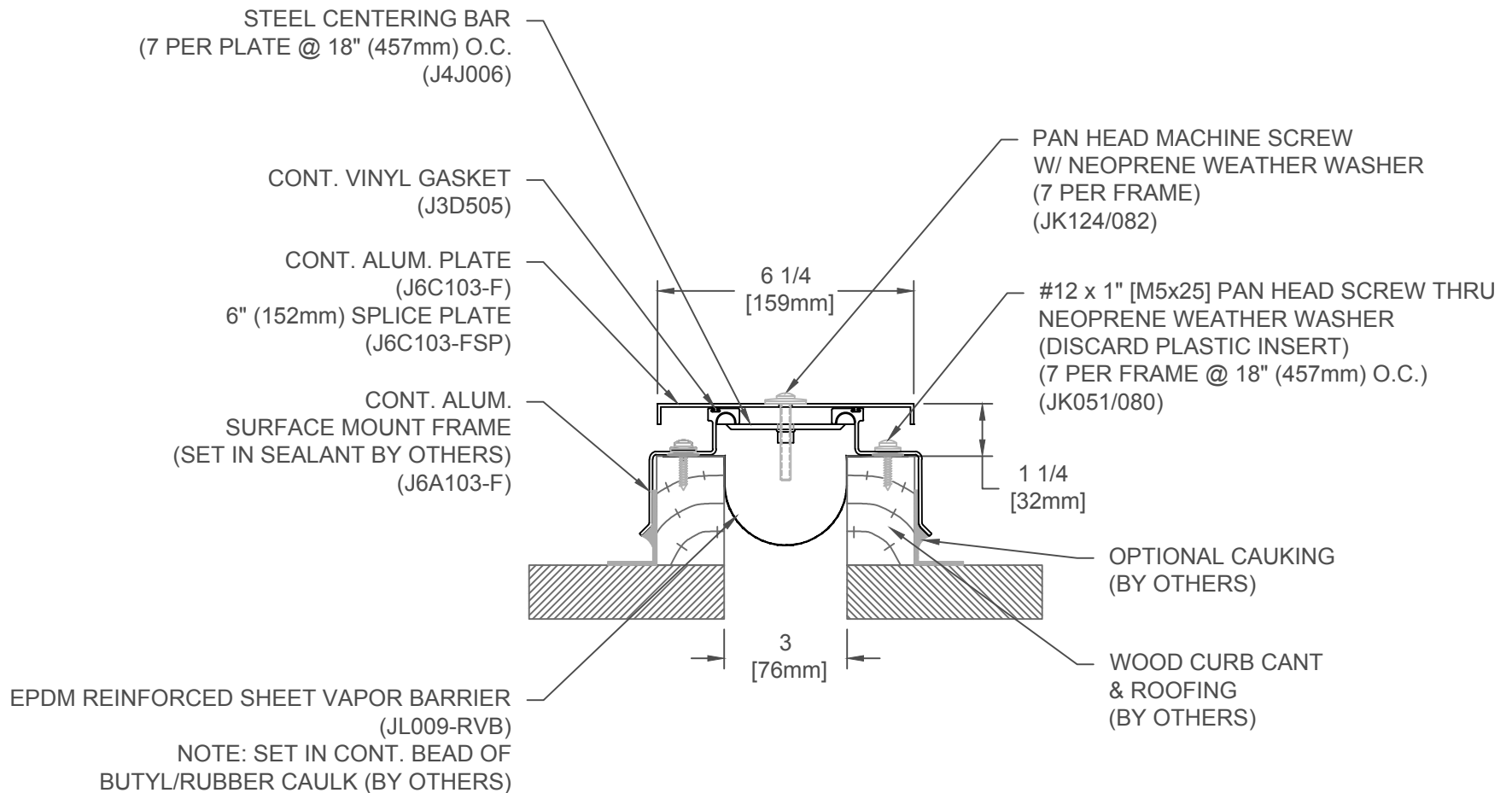

691-A01-075

Joint Width		Movement ±			
		Horizontal		Vertical	
US	mm	US	mm	US	mm
3"	76	1-1/2"	38	1-1/2"	38

FINISH: MILL

• **JOINTMASTER®**
EXPANSION JOINT SYSTEMS
A DIVISION OF INPRO®

DATE: 5-22-09

SCALE: 1:4

DOC: CADJM.003/Rev3

APPLICATION:
CURB MOUNTED CENTERING BAR
ROOF/ROOF CONDITION

PROJECT:

CUSTOMER:

LOCATION:

inpro.

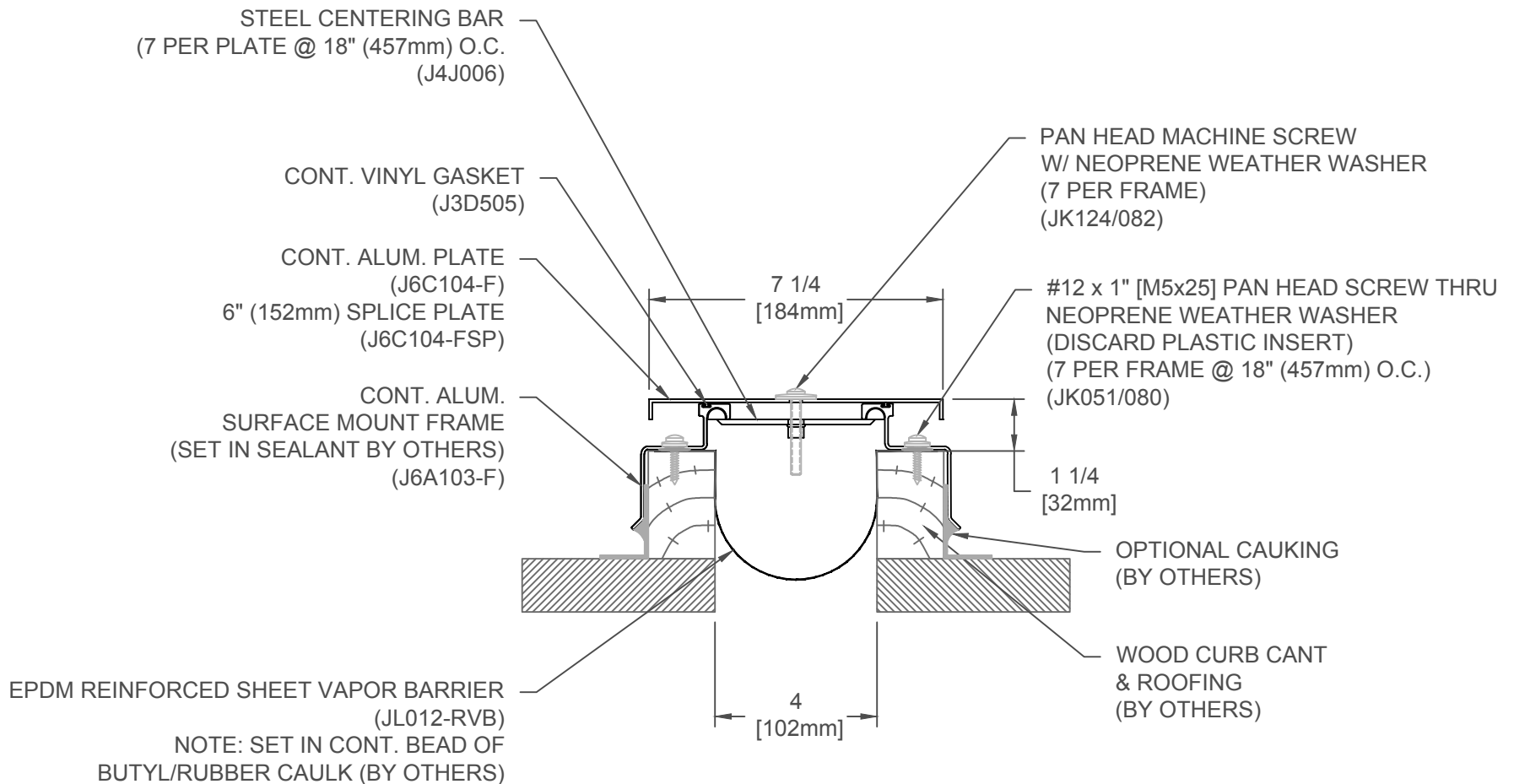

691-A01-100

Joint Width		Movement ±			
US	mm	Horizontal		Vertical	
US	mm	US	mm	US	mm
4"	102	2"	51	2"	51

FINISH: MILL

• **JOINTMASTER®**
EXPANSION JOINT SYSTEMS
A DIVISION OF INPRO®

DATE: 5-22-09

SCALE: 1:4

DOC: CADJM.003/Rev3

APPLICATION:
CURB MOUNTED CENTERING BAR
ROOF/ROOF CONDITION

PROJECT:

CUSTOMER:

LOCATION:

inpro.

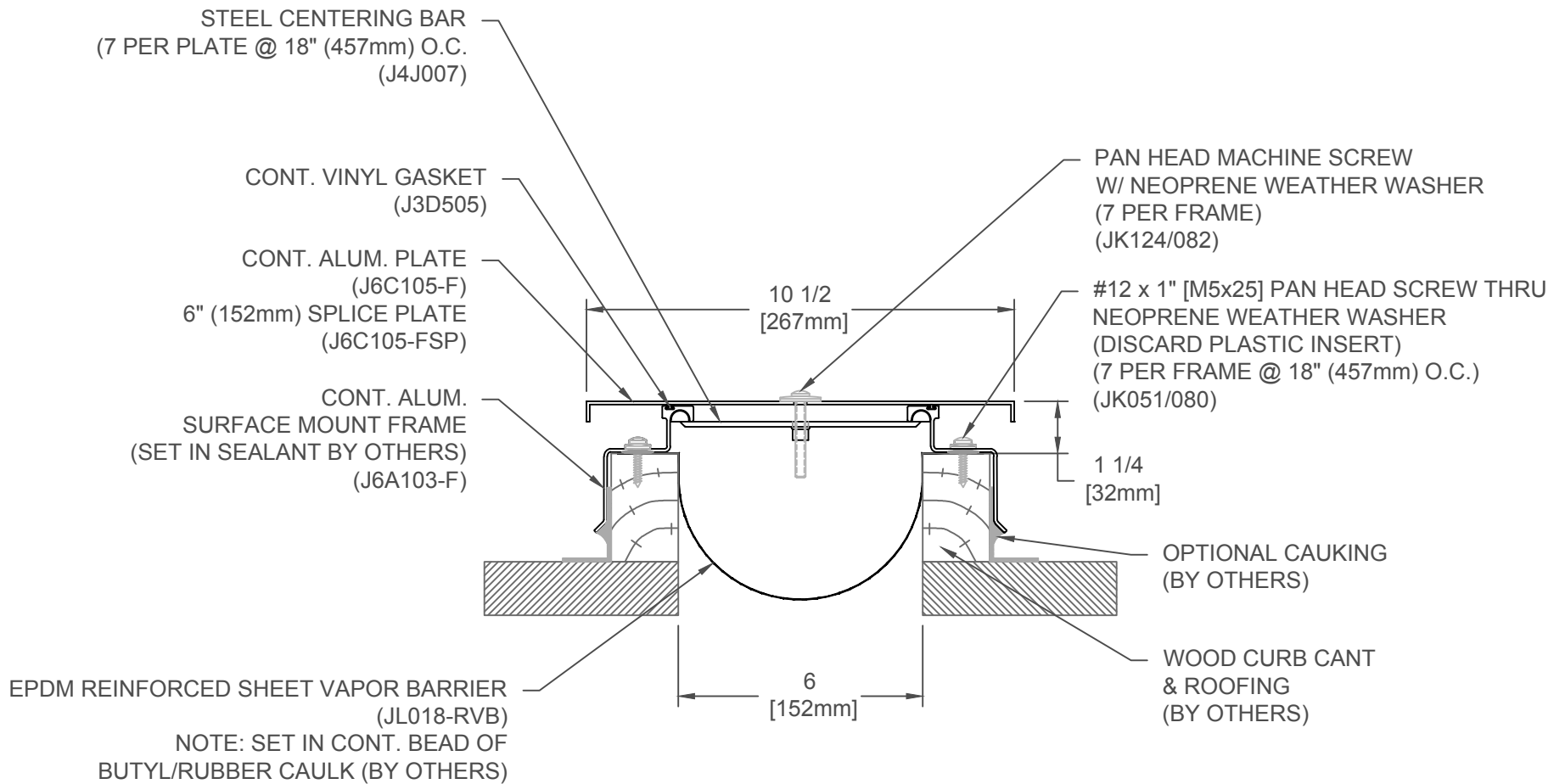

691-A01-150

Joint Width		Movement ±			
		Horizontal		Vertical	
US	mm	US	mm	US	mm
6"	152	3"	76	3"	76

FINISH: MILL

JOINTMASTER
EXPANSION JOINT SYSTEMS
A DIVISION OF INPRO

DATE: 5-22-09

SCALE: 1:4

DOC: CADJM.003/Rev3

APPLICATION:
CURB MOUNTED CENTERING BAR
ROOF/ROOF CONDITION

PROJECT:

CUSTOMER:

LOCATION:

inpro.

STEEL CENTERING BAR
(7 PER PLATE @ 18" (457mm) O.C.)
(J4J008)

CONT. VINYL GASKET
(J3D505)

CONT. ALUM. PLATE
(J6C106-F)
6" (152mm) SPLICE PLATE
(J6C106-FSP)

CONT. ALUM.
SURFACE MOUNT FRAME
(SET IN SEALANT BY OTHERS)
(J6A103-F)

EPDM REINFORCED SHEET VAPOR BARRIER
(JL018-RVB)

NOTE: SET IN CONT. BEAD OF
BUTYL/RUBBER CAULK (BY OTHERS)

PAN HEAD MACHINE SCREW
W/ NEOPRENE WEATHER WASHER
(7 PER FRAME)
(JK124/082)

#12 x 1" [M5x25] PAN HEAD SCREW
THRU NEOPRENE WEATHER WASHER
(DISCARD PLASTIC INSERT)
(7 PER FRAME @ 18" (457mm) O.C.)
(JK051/080)

1 1/4
[32mm]

OPTIONAL CAUKING
(BY OTHERS)

WOOD CURB CANT
& ROOFING
(BY OTHERS)

13 1/2
[343mm]

8
[203mm]

691-A01-200

Joint Width		Movement ±			
US	mm	Horizontal		Vertical	
US	mm	US	mm	US	mm
8"	203	4"	102	4"	102

FINISH: MILL

JOINTMASTER
EXPANSION JOINT SYSTEMS
A DIVISION OF INPRO

DATE: 5-22-09

SCALE: 1:4

DOC: CADJM.003/Rev3

APPLICATION:
CURB MOUNTED CENTERING BAR
ROOF/ROOF CONDITION

PROJECT:

CUSTOMER:

LOCATION:

inpro.

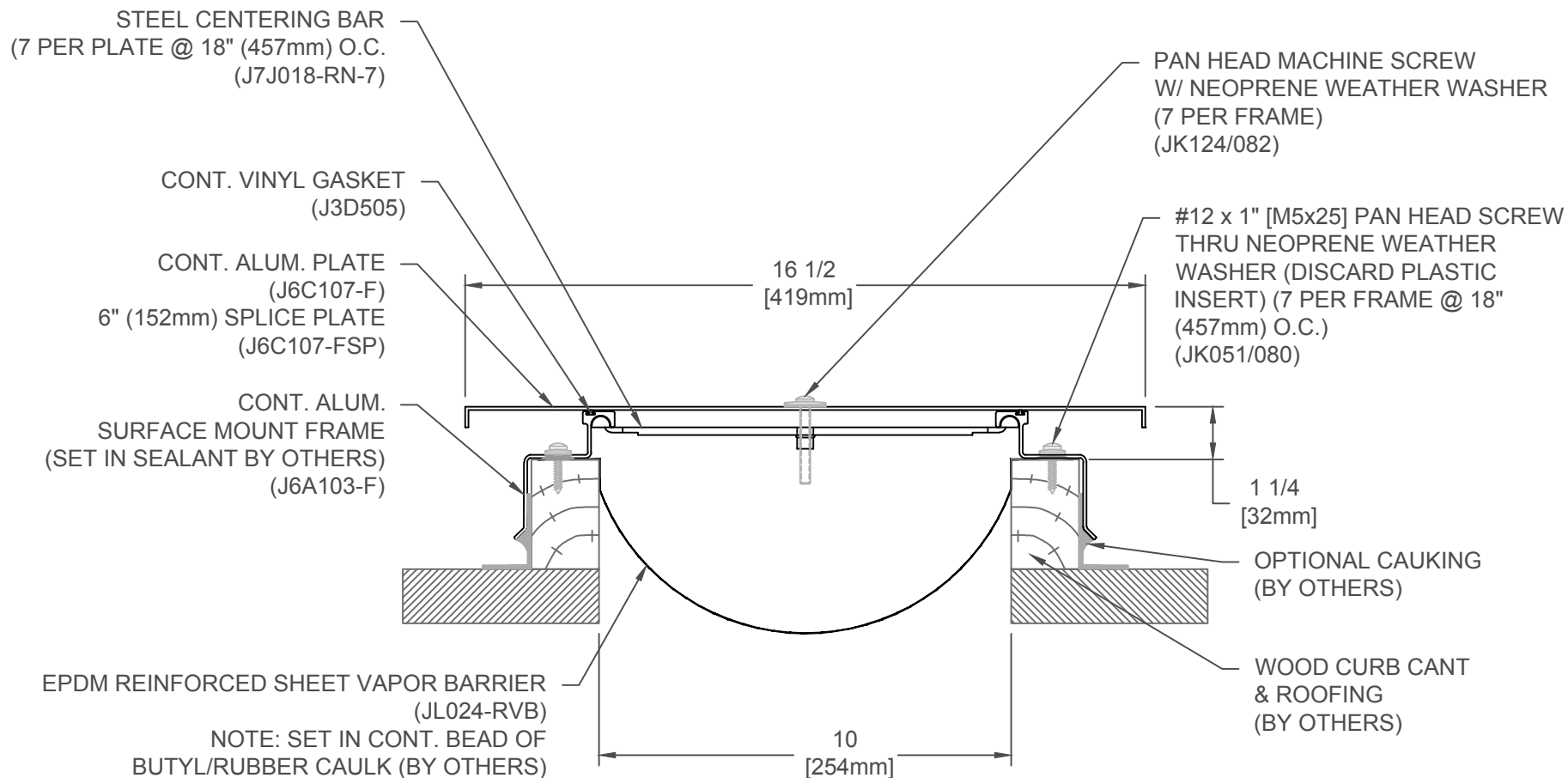

691-A01-250

Joint Width		Movement ±			
		Horizontal		Vertical	
US	mm	US	mm	US	mm
10"	254	5"	127	5"	127

FINISH: MILL

JOINTMASTER
EXPANSION JOINT SYSTEMS
A DIVISION OF INPRO

DATE: 12-7-16

SCALE: 1:4

DOC: CADJM.003/Rev3

APPLICATION:
CURB MOUNTED CENTERING BAR
ROOF/ROOF CONDITION

PROJECT:

CUSTOMER:

LOCATION:

inpro.

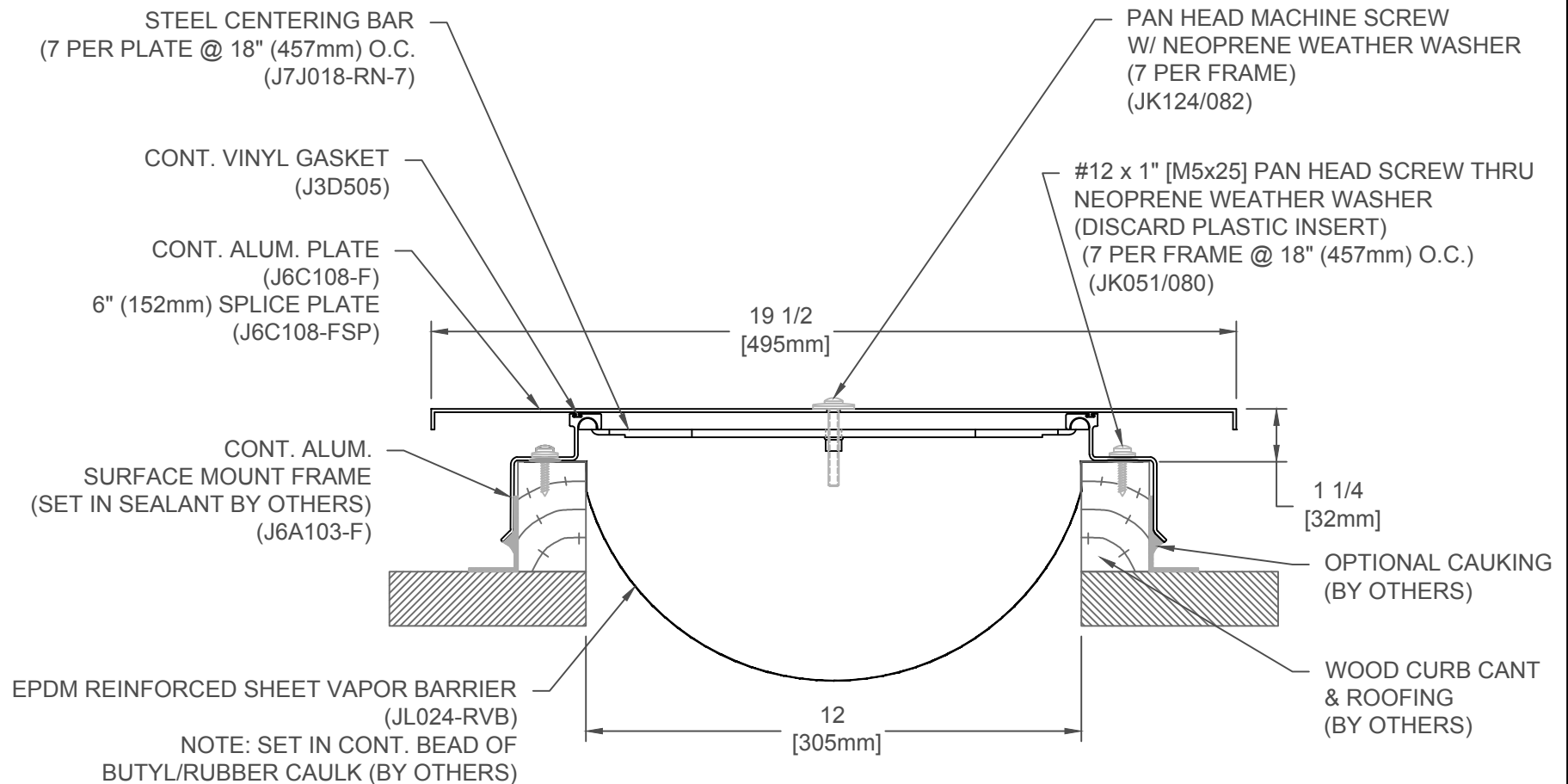

691-A01-300

Joint Width		Movement ±			
		Horizontal		Vertical	
US	mm	US	mm	US	mm
12"	305	6"	152	6"	152

FINISH: MILL

JOINTMASTER
EXPANSION JOINT SYSTEMS
A DIVISION OF INPRO

DATE: 5-22-09

SCALE: 1:4

DOC: CADJM.003/Rev3

APPLICATION:
CURB MOUNTED CENTERING BAR
ROOF/ROOF CONDITION

PROJECT:

CUSTOMER:

LOCATION:

inpro.

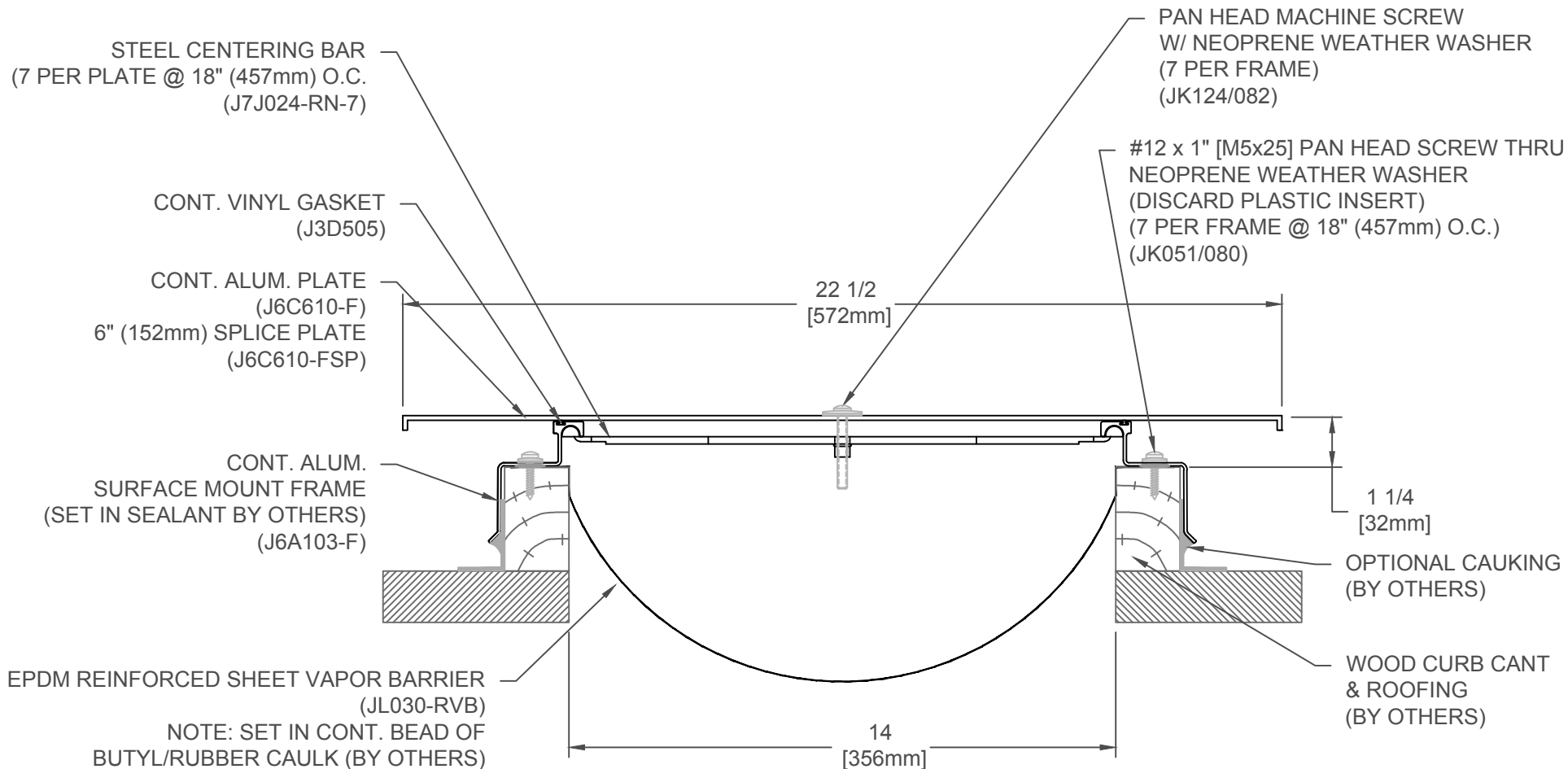

691-A01-350

Joint Width		Movement ±			
		Horizontal		Vertical	
US	mm	US	mm	US	mm
14"	356	7"	178	7"	178

FINISH: MILL

JOINTMASTER
EXPANSION JOINT SYSTEMS
A DIVISION OF INPRO

DATE: 12-7-16

SCALE: 1:4

DOC: CADJM.003/Rev3

APPLICATION:
CURB MOUNTED CENTERING BAR
ROOF/ROOF CONDITION

PROJECT:

CUSTOMER:

LOCATION:

inpro.

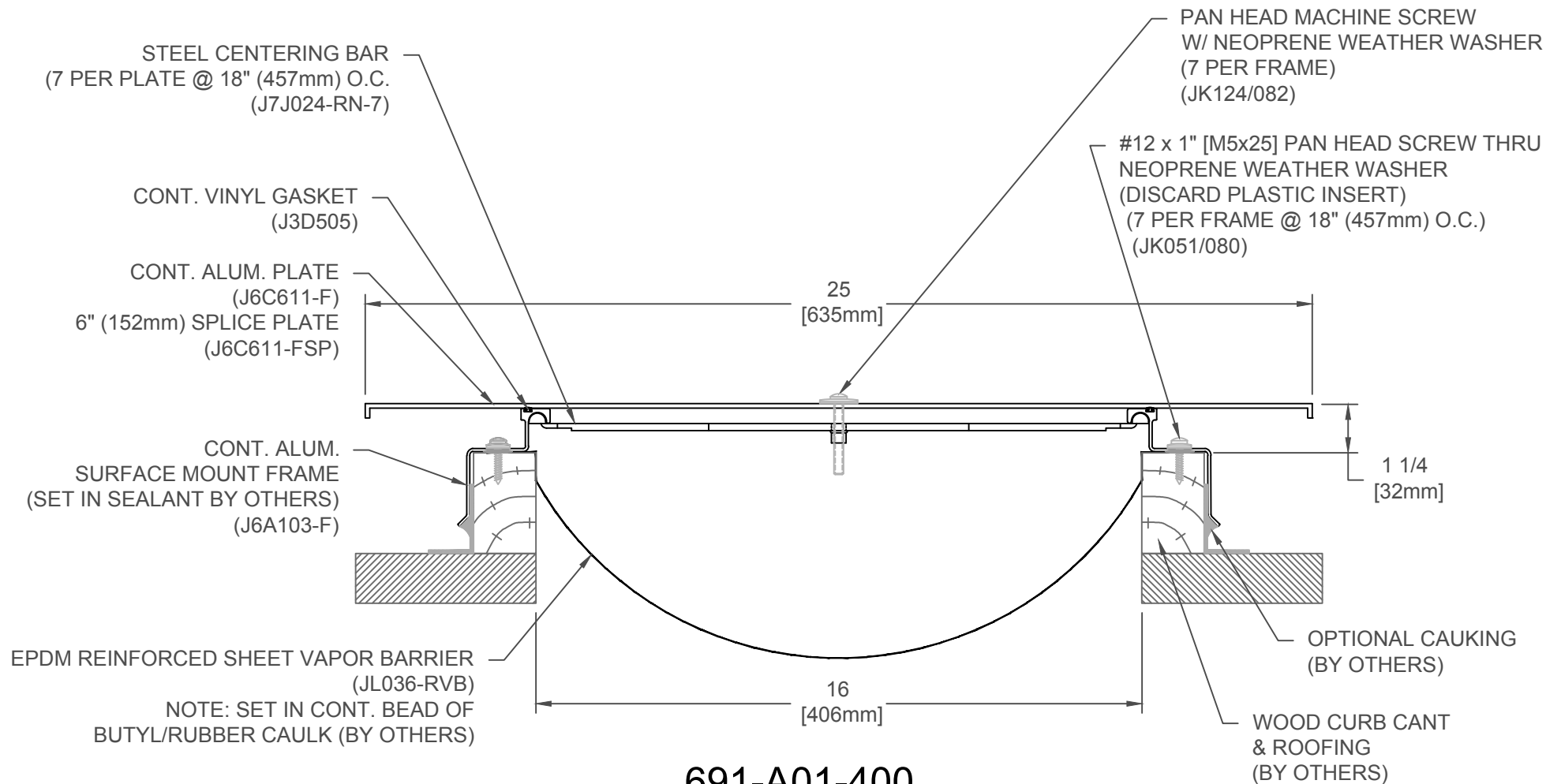

Joint Width		Movement ±			
		Horizontal		Vertical	
US	mm	US	mm	US	mm
16"	406	8"	203	8"	203

FINISH: MILL

• JOINTMASTER®
EXPANSION JOINT SYSTEMS
A DIVISION OF INPRO®

DATE: 12-7-16

SCALE: 1:4

DOC: CADJM.003/Rev3

APPLICATION:
CURB MOUNTED CENTERING BAR
ROOF/ROOF CONDITION

PROJECT:

CUSTOMER:

LOCATION:

inpro.