

Installation Instructions

Ascend™ Elevator Protection System

IMPORTANT: *If someone else (outside of your company) did field measurements, please confirm elevator cab has a wall substrate (is not a stick, stud, skeleton, nor picture frame construction cab) before tearing down existing finishes. It is the responsibility of the facility and installer to verify the cab substrate before installation.*

If cab does not have a wall substrate (i.e. Wood or Steel Sheet) it is the responsibility of the installer to provide substrate to meet local codes.

Please read all instructions before installing panels.

Material must be stored, installed and used in environmentally controlled conditions.

Inspect all components before install.

Recommend Tools

- Tin Snips
- 4" Hand Held Grinder (with cut-off wheel)
- Metal Finishing File
- Tape Measure
- 3ft. Level
- Power Drill
- 1/2" Drill Bit
- 3/16" Drill Bit
- Non-Marking Rubber Mallet
- Pry Bars
- Phillips Head Driver
- Felt Tipped Marker
- Denatured Alcohol
- Clean rags

Fasteners

S-clips/Frieze:

HW118: #8 x 3/4 PH Truss HD Tapping (Wood Walls)

HW120: #8 x 3/4 RD Washer HD (Metal Walls)

Toe Kicks/Reveal Retainer:

HW117: #8 x 3/4 PH Flat Undercut (Wood Walls)

HW119: #8 x 3/4 PH Flat Undercut (Metal Walls)

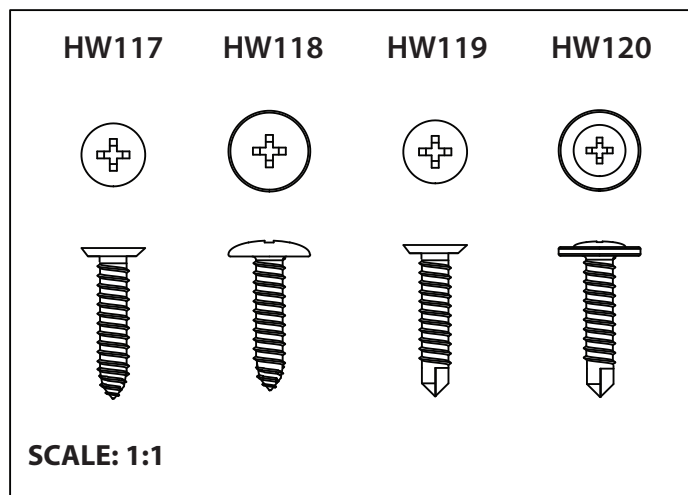

IPC.1859/REV.6

Installation Hotline • 866.EZINPRO
Inprocorp.com • 800.222.5556 • 262.679.9010
World Headquarters S80 W18766 Apollo Drive, Muskego, WI 53150 USA

ASCEND™ •
ELEVATOR PROTECTION SYSTEMS
A DIVISION OF INPRO®

1

Installation Instructions Edge Reveal & Toe Kick Installation

INSTALL CORNER REVEALS

1. Locate edge & inside corner reveals. Remove the protective coating from the front face of the reveal.
2. Remove backing from adhesive strips on the back of the reveal pieces. Install reveals flush to the edge / corner pressing with firm pressure.
Tip: Position the bottom edge of the reveals and tilt into place, keeping piece tight to corner conditions.

Figure 1

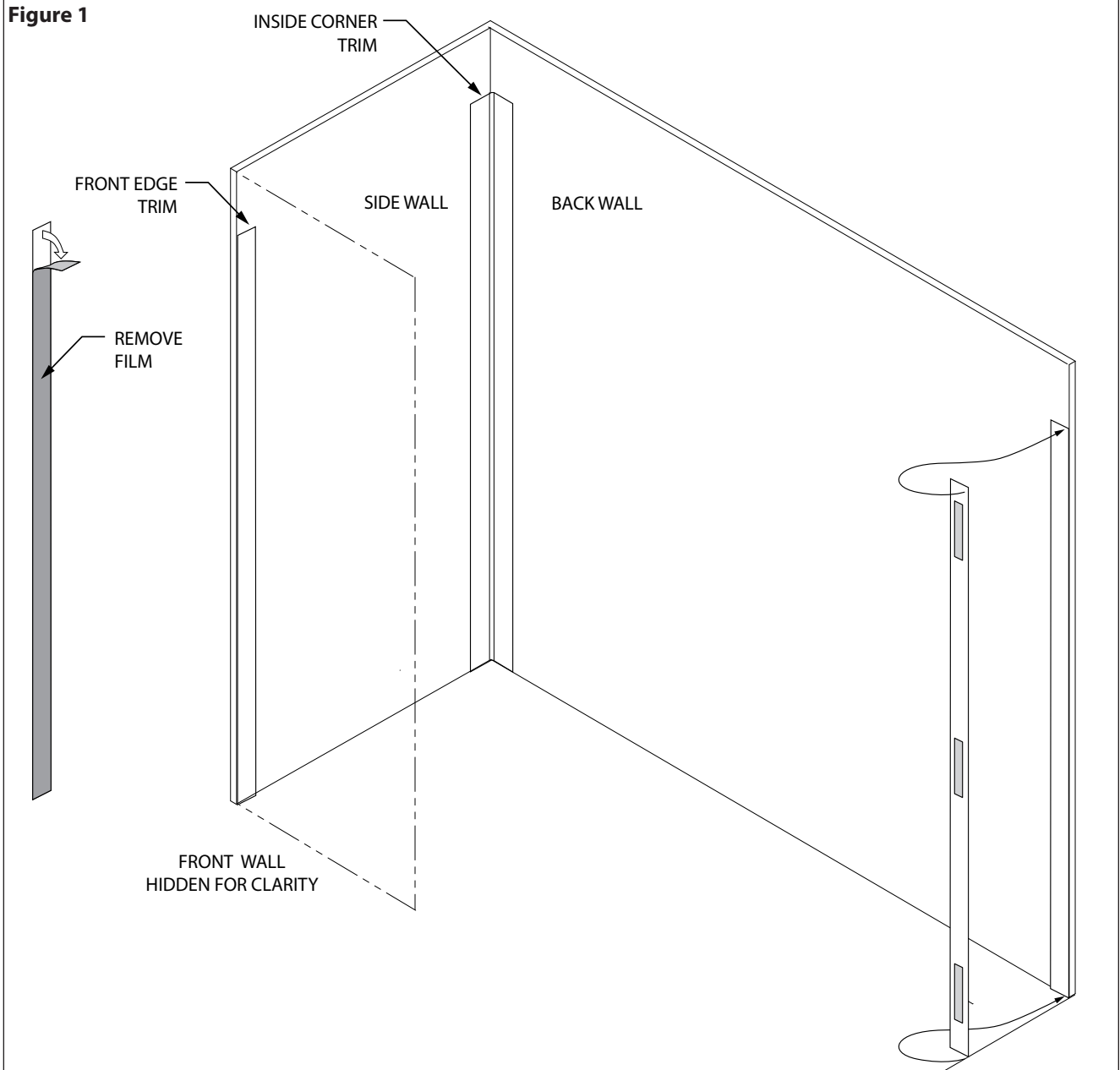

Installation Hotline • 866.EZINPRO

Inprocorp.com • 800.222.5556 • 262.679.9010

World Headquarters S80 W18766 Apollo Drive, Muskego, WI 53150 USA

ASCEND™ •

ELEVATOR PROTECTION SYSTEMS
A DIVISION OF INPRO®

1

Installation Instructions Edge Reveal & Toe Kick Installation

INSTALL TOE KICK

Measure the width of the wall where you would like to begin installation. Mark the center line of the wall .

1. Remove protective film from the toe kick and position it flush against the wall as shown below. Ensure the V shaped notch is located on the center line of the wall. Check to see if toe kick is level. Attach using HW117/119 screws
2. If bottom lip of toe kick extends outward from the wall, remove toe kick, and lay against the wall with bottom edge flush to wall. Mark the front edge of the C brackets from the back of the toe kick on the wall, install Z-clip so the recess is flush with marked line. Re position toe kick on wall and slide to engage the c-channels onto the Z-clip.

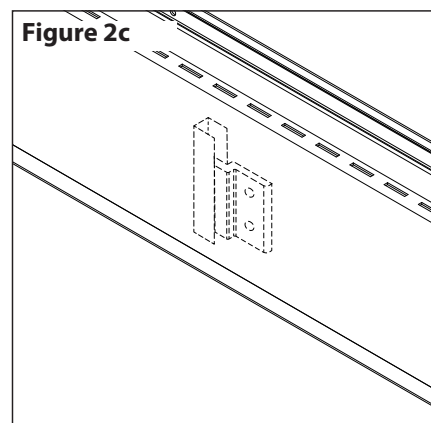
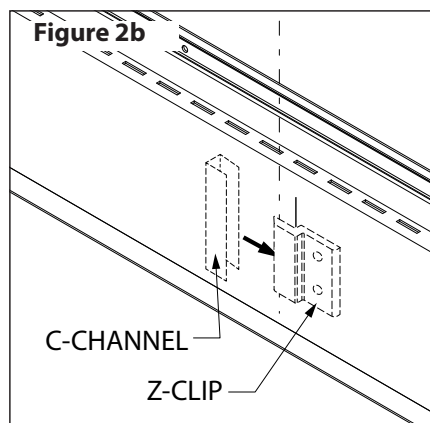
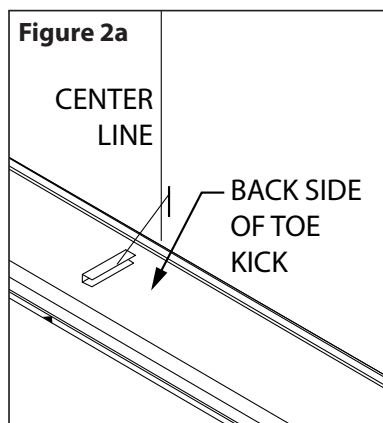
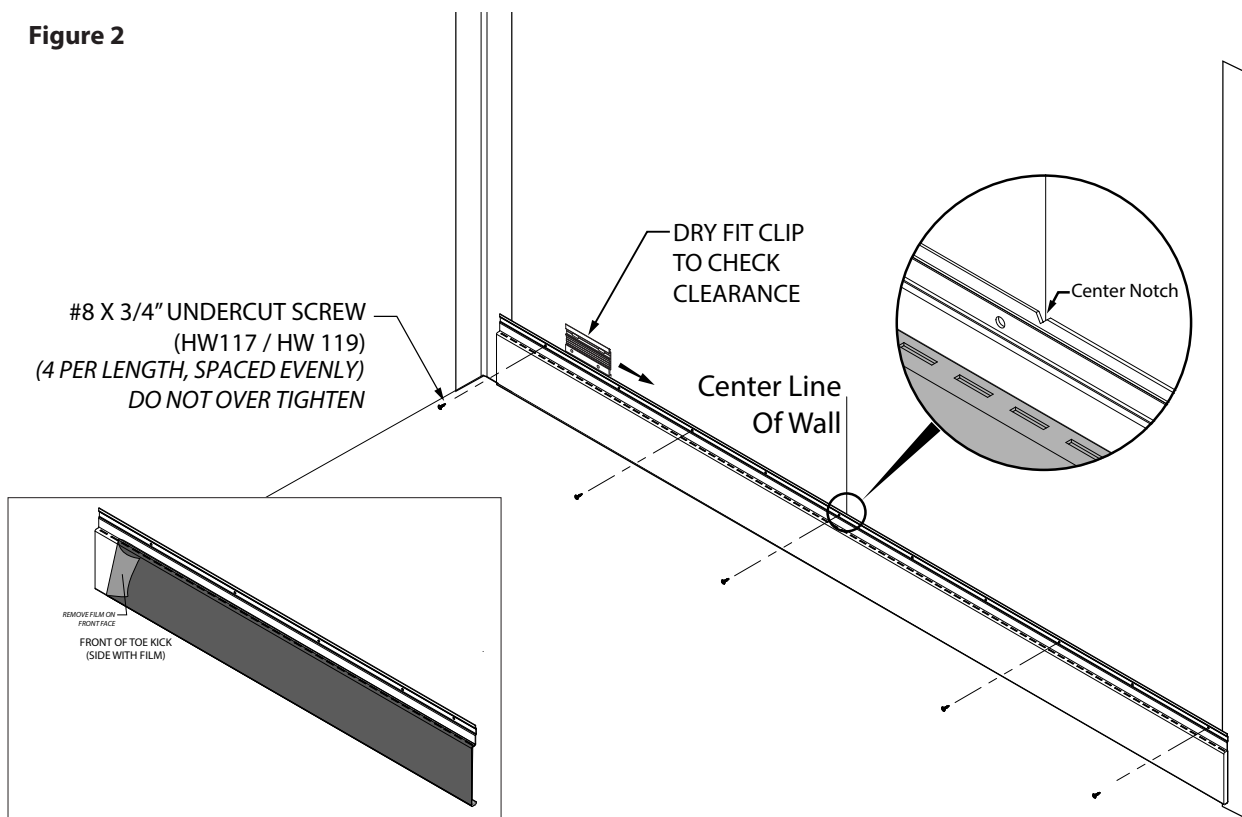

Figure 2



Installation Hotline • 866.EZINPRO

Inprocorp.com • 800.222.5556 • 262.679.9010

World Headquarters S80 W18766 Apollo Drive, Muskego, WI 53150 USA

ASCEND™

ELEVATOR PROTECTION SYSTEMS
A DIVISION OF INPRO®

2_a Installation Instructions

Style Layout Guide

Before beginning panel installation , Un-crate panels for each cab. If possible lay out on a protected surface. Each panel comes with a panel label what provides its installation location.

CLIP LOCATION GUIDE

1. Verify the panel labels are correctly located at top edge of all panels.

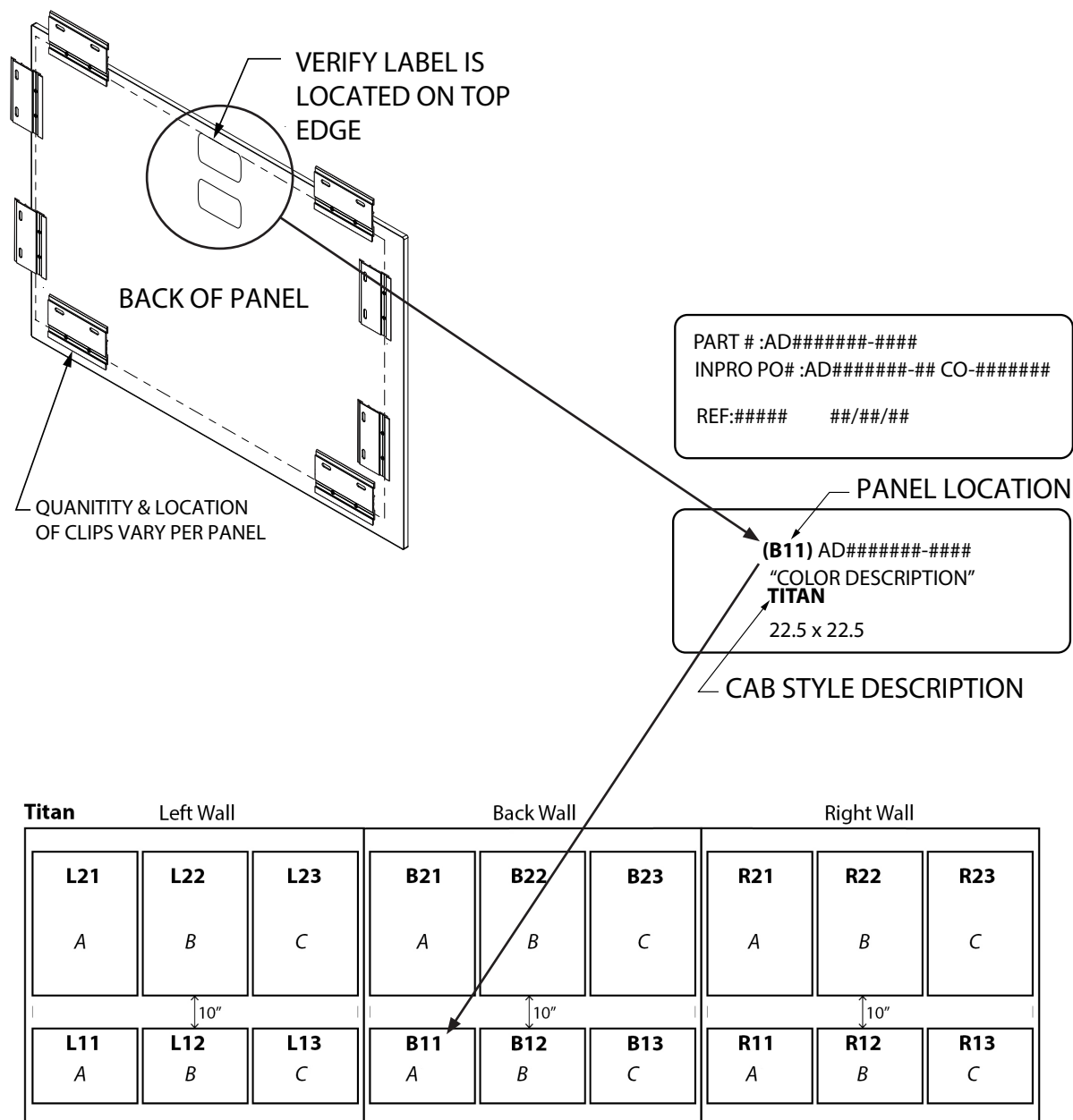

2_a

Installation Instructions Style Layout Guide

STYLE LAYOUT GUIDE

Phoenix

Left Wall

Back Wall

Right Wall

L41 A	L42 B	L43 C	B41 A	B42 B	B43 C	R41 A	R42 B	R43 C
L31 A	L32 B	L33 C	B31 A	B32 B	B33 C	R31 A	R32 B	R33 C
L21 A	L22 B	L23 C	B21 A	B22 B	B23 C	R21 A	R22 B	R23 C
L11 A	L12 B	L13 C	B11 A	B12 B	B13 C	R11 A	R12 B	R13 C

**CLIP LAYOUT
REFERENCE**

*This panel uses
the clip layout
shown on
panel "C"*

Corvus

Left Wall

Back Wall

Right Wall

L31 A	L32 B	L33 C	B31 A	B32 B	B33 C	R31 A	R32 B	R33 C
L21 A	L22 B	L23 C	B21 A	B22 B	B23 C	R21 A	R22 B	R23 C
L11 A	L12 B	L13 C	B11 A	B12 B	B13 C	R11 A	R12 B	R13 C

Zenith

Left Wall

Back Wall

Right Wall

L11 A	L12 B	L13 C	B11 A	B12 B	B13 C	R11 A	R12 B	R13 C
-----------------	-----------------	-----------------	-----------------	-----------------	-----------------	-----------------	-----------------	-----------------

Orion

Left Wall

Back Wall

Right Wall

L21 A	L22 B	L23 C	B21 A	B22 B	B23 C	R21 A	R22 B	R23 C
L11 D			B11 D			R11 D		

Installation Hotline • 866.EZINPRO

Inprocorp.com • 800.222.5556 • 262.679.9010

World Headquarters S80 W18766 Apollo Drive, Muskego, WI 53150 USA

ASCEND™

ELEVATOR PROTECTION SYSTEMS
A DIVISION OF INPRO®

2_a

Installation Instructions Style Layout Guide

STYLE LAYOUT GUIDE

Columba	Left Wall	Back Wall	Right Wall
	L41 <i>D</i>	B41 <i>D</i>	R41 <i>D</i>
	L31 <i>D</i>	B31 <i>D</i>	R31 <i>D</i>
	L21 <i>D</i>	B21 <i>D</i>	R21 <i>D</i>
	L11 <i>D</i>	B11 <i>D</i>	R11 <i>D</i>

Hercules	Left Wall	Back Wall	Right Wall
	L31 <i>D</i>	B31 <i>D</i>	R31 <i>D</i>
	L21 <i>D</i>	B21 <i>D</i>	R21 <i>D</i>
Handrail Panel	10"	10"	10"
	L11 <i>D</i>	B11 <i>D</i>	R11 <i>D</i>

Titan	Left Wall	Back Wall	Right Wall
	L21 <i>A</i>	B21 <i>A</i>	R21 <i>A</i>
	L22 <i>B</i>	B22 <i>B</i>	R22 <i>B</i>
	L23 <i>C</i>	B23 <i>C</i>	R23 <i>C</i>
Handrail Panel	10"	10"	10"
	L11 <i>A</i>	B11 <i>A</i>	R11 <i>A</i>
	L12 <i>B</i>	B12 <i>B</i>	R12 <i>B</i>
	L13 <i>C</i>	B13 <i>C</i>	R13 <i>C</i>

Vela	Left Wall	Back Wall	Right Wall
	L21 <i>A</i>	B21 <i>A</i>	R21 <i>A</i>
	L22 <i>B</i>	B22 <i>B</i>	R22 <i>B</i>
	L23 <i>C</i>	B23 <i>C</i>	R23 <i>C</i>
Handrail Panel	10"	10"	10"
	L11 <i>D</i>	B11 <i>D</i>	R11 <i>D</i>

Installation Hotline • 866.EZINPRO

Inprocorp.com • 800.222.5556 • 262.679.9010

World Headquarters S80 W18766 Apollo Drive, Muskego, WI 53150 USA

ASCEND™

ELEVATOR PROTECTION SYSTEMS
A DIVISION OF INPRO®

2_a

Installation Instructions Style Layout Guide

CLIP LAYOUT REFERENCE GUIDE

Showing the back side of the panels (clip quantity may vary)

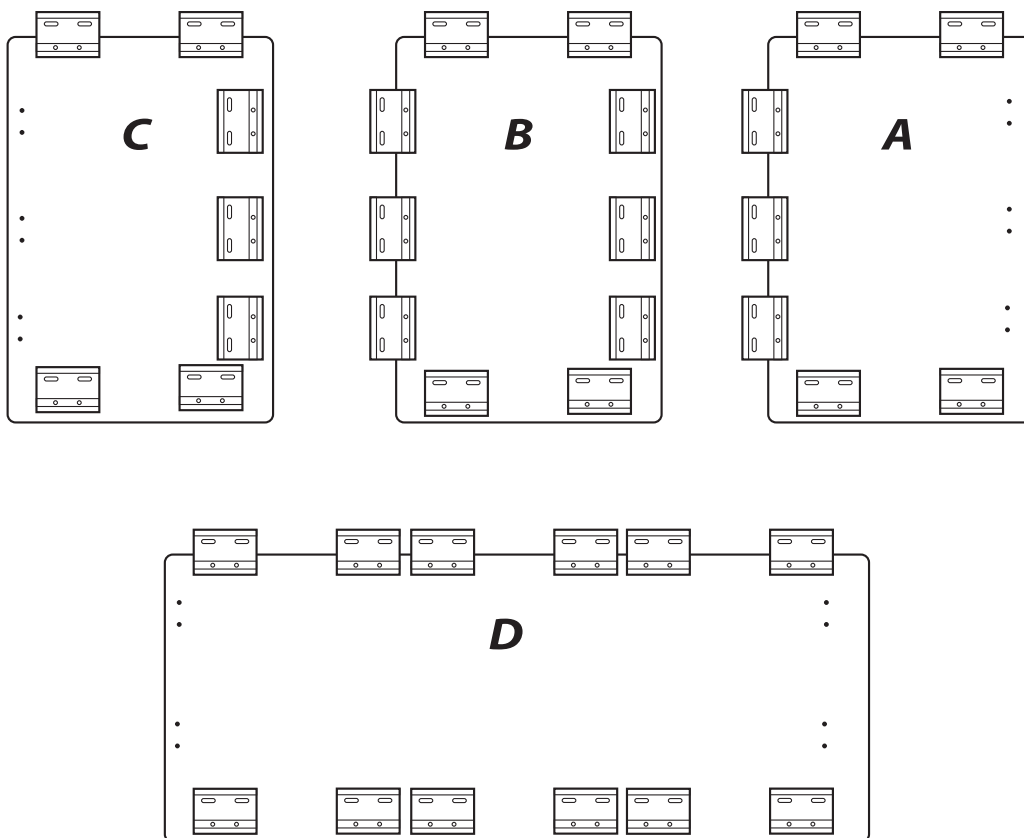

2

Installation Instructions Wall Panel and Reveal Installation

INSTALL PANELS - Reference style guide and panel clip layout guide

1. Start panel installation from left to right. Place panel flat against the wall, slide panel down until the bottom clip lock into the toe kick flange.
2. Position panel so its edge is flush with edge of toe kick (see figure 5/6)
3. Fasten the panel to the wall using supplied HW118/120 screws through the S-clips on the top and right side of the panel with a minimum one screw per clip

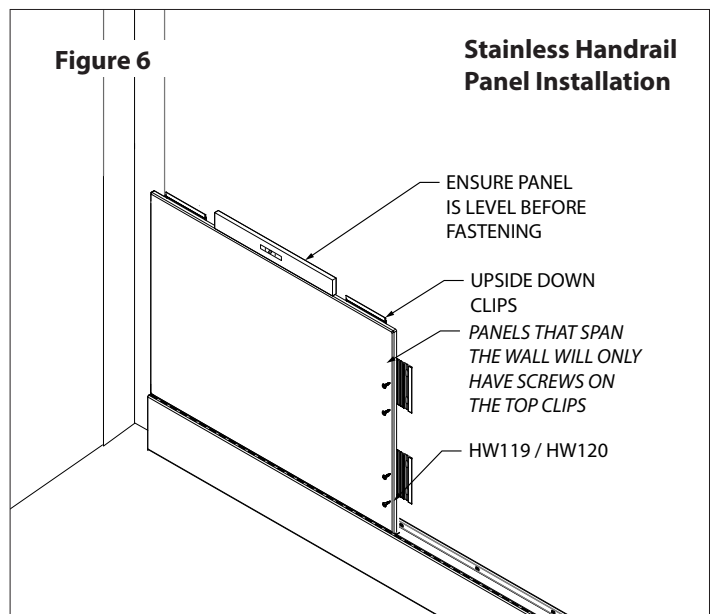
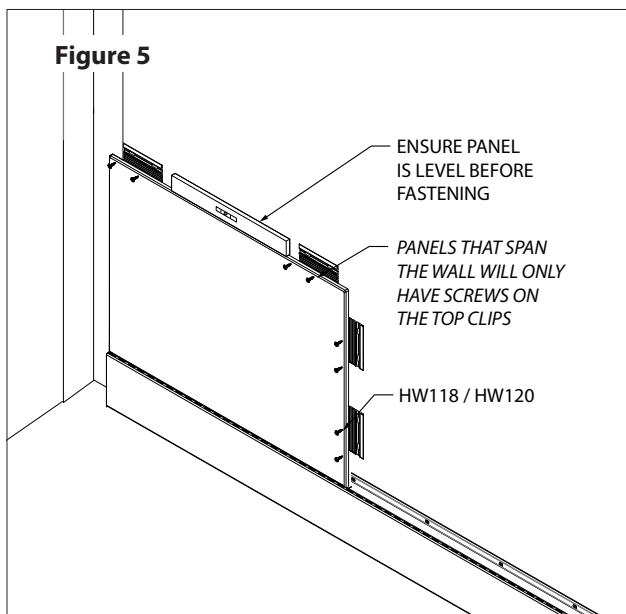
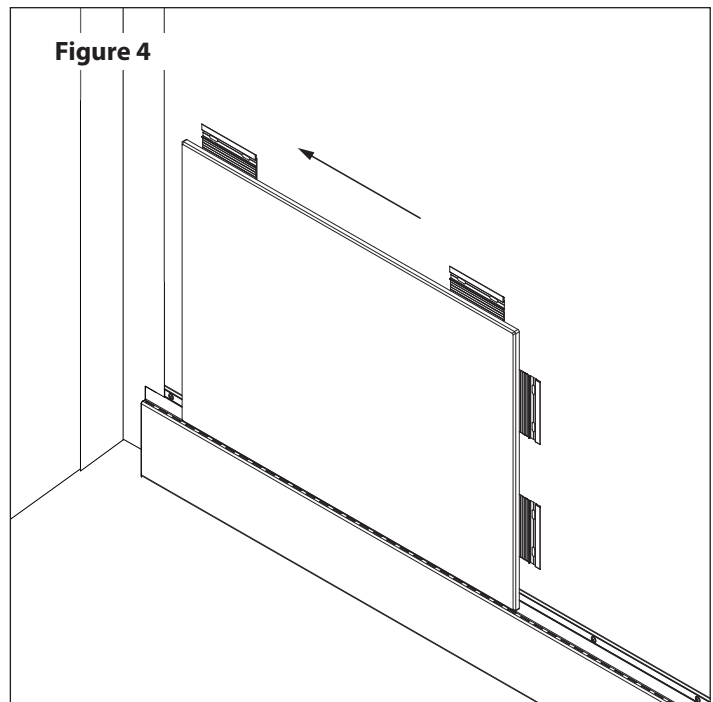
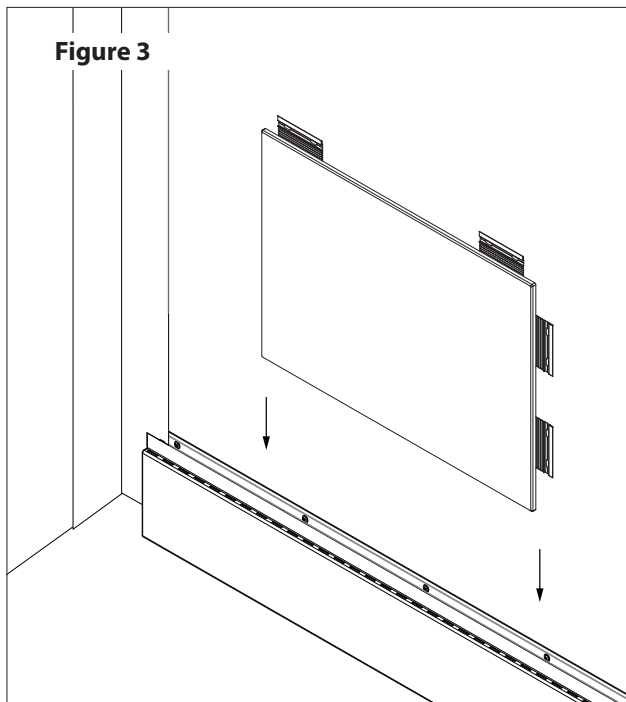

2

Installation Instructions Wall Panel and Reveal Installation

INSTALL VERTICAL REVEAL

1. After panel is installed on the wall, find the correct length vertical reveal. Remove the protective film from the reveal (see figure 7)
NOTE: Reveals run slightly longer, this will allow the vertical reveals to tuck under the horizontal reveals. For the first row of panels, bottom edge of the reveal should be visually flush to the bottom edge of the panel. (See figure 8)
2. Place single sided foam tape (large roll of black tape) so it spans the gap in each clip. (See figure 9)
3. Apply double sided foam tape to grooved recess in panel clips and install reveal. Tuck left edge of reveal behind panel and pivot into position. Continue install with next panel. (See figure 10)
4. If the cab style includes a hand rail panel, skip to page titled "HANDRAIL INSTALLATION -ON HANDRAIL PANEL" in **section 4** after the first row of panels is installed. *Corresponding Styles: Hercules, Titan, & Vela*

Figure 7

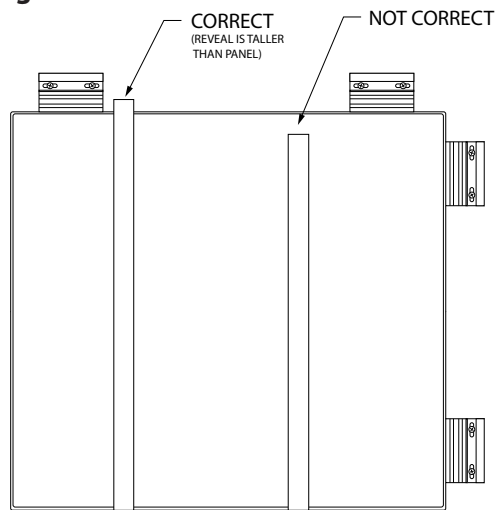

Figure 8

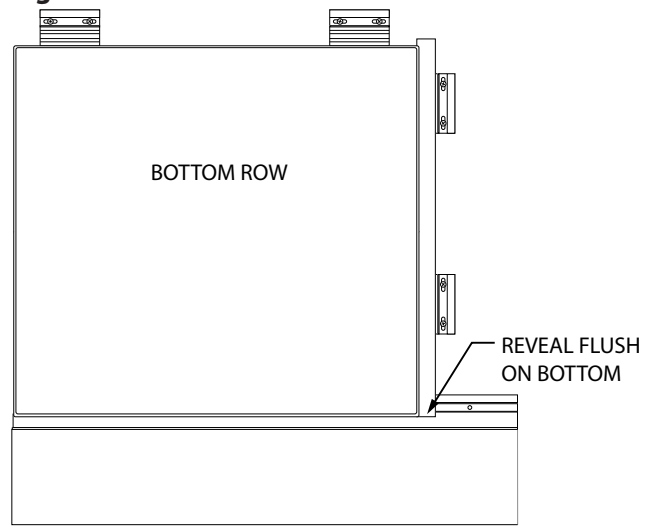

Figure 9

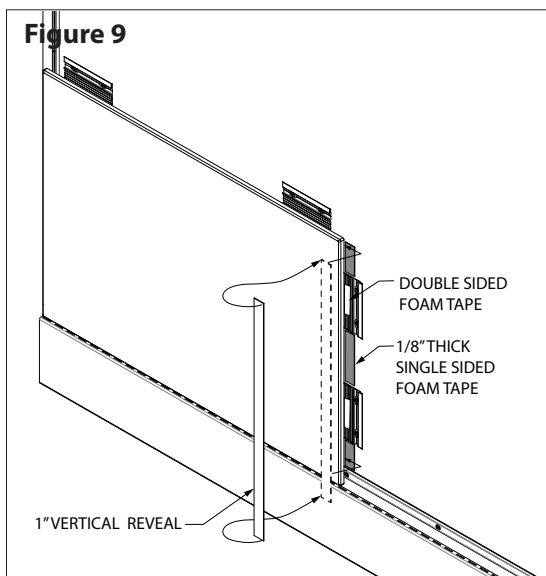
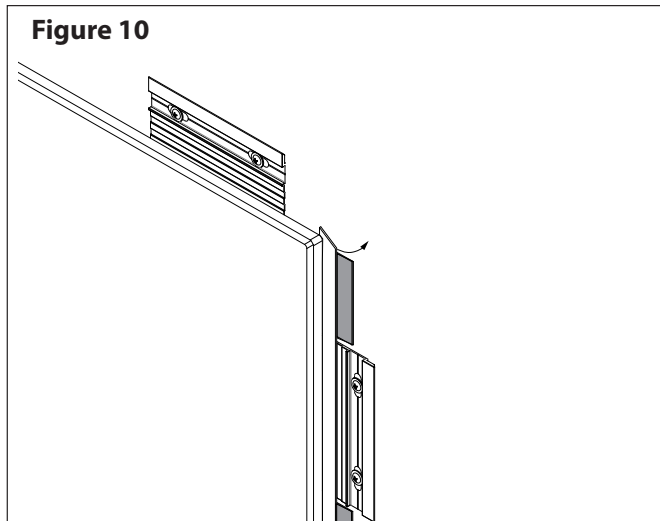

Figure 10



Installation Hotline • 866.EZINPRO

Inprocorp.com • 800.222.5556 • 262.679.9010

World Headquarters S80 W18766 Apollo Drive, Muskego, WI 53150 USA

ASCEND™

ELEVATOR PROTECTION SYSTEMS
A DIVISION OF INPRO®

2

Installation Instructions Wall Panel and Reveal Installation

INSTALL HORIZONTAL REVEAL & EDGE TRIM

1. After the first row of panels are installed, slide one reveal retainer behind each end of the installed row. Ensure the flat edge is flush with the edge of the panels. Attach to wall using HW118/120 screws (see figure 12) Secure retainer after each row to ensure the retainer stays flush with edge of the panels.
2. Place single sided foam tape (large roll of black tape) so it spans the gap in each clip. Apply double sided tape to the panel clips. Install horizontal reveal. (NOTE: Horizontal reveal will be the same length as the entire row of panels edge to edge) Attach to wall using HW117/119 screws

NOTE: Make sure to tuck vertical reveals under the horizontal reveals.

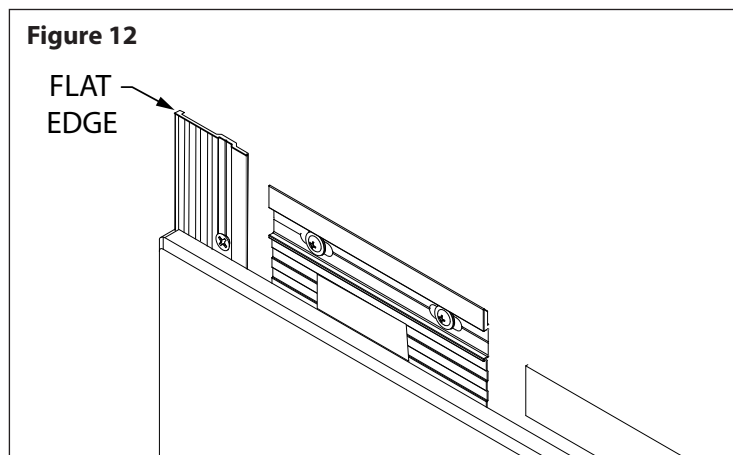
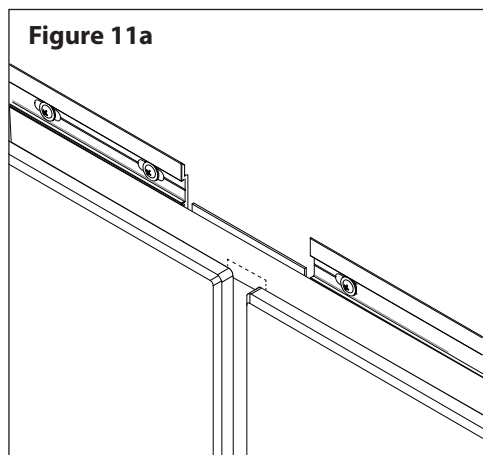
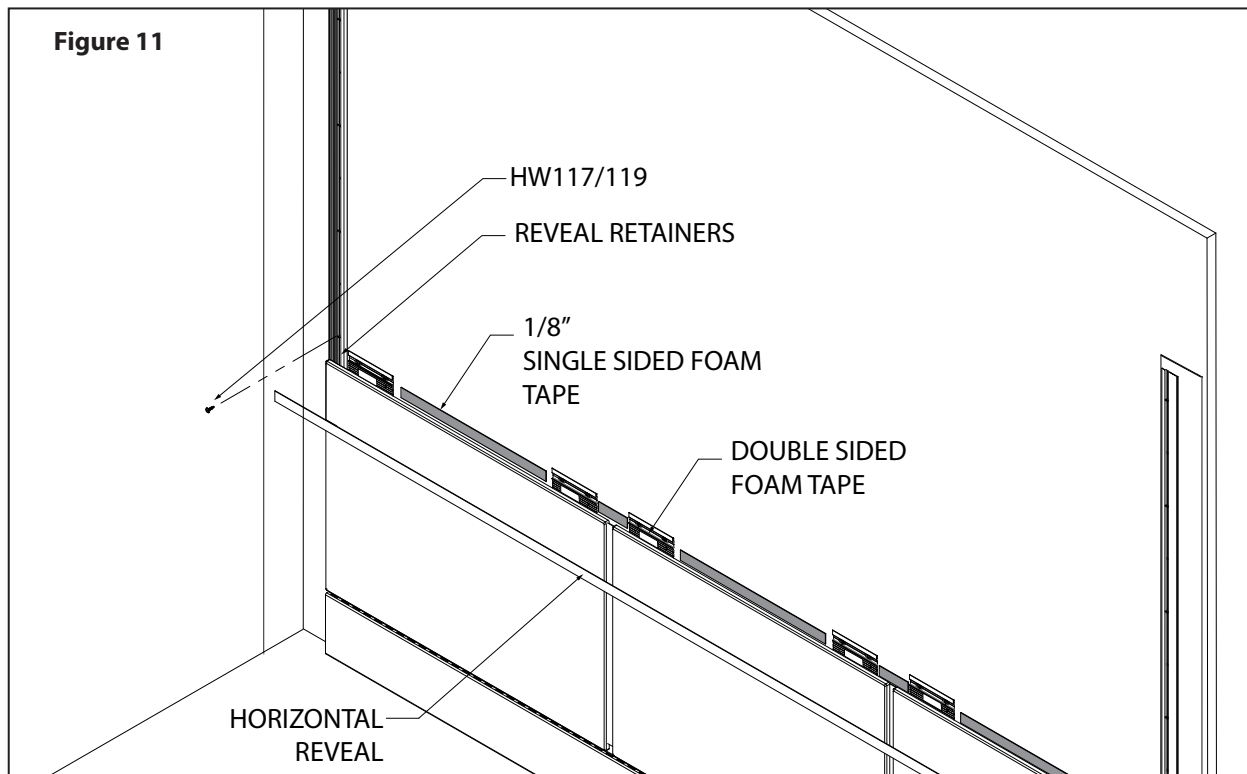

2

Installation Instructions Wall Panel and Reveal Installation

INSTALL SECOND ROW-

1. After the horizontal reveal is installed on the first row continue to next row repeating wall panel and reveal process. Securing the reveal retainer after each row ensuring it is flush with the edge of the panel.
2. Before installing final row of panels, dry fit the top panels, and mark the top edge on the reveal retainers. (Figure 13a) Remove panel and mark a line downward at a 45° angle (see figure 13b). Cut the reveal retainer on the angled line (see figure 13c)

NOTE: Angled cut allows frieze to seat down into position.

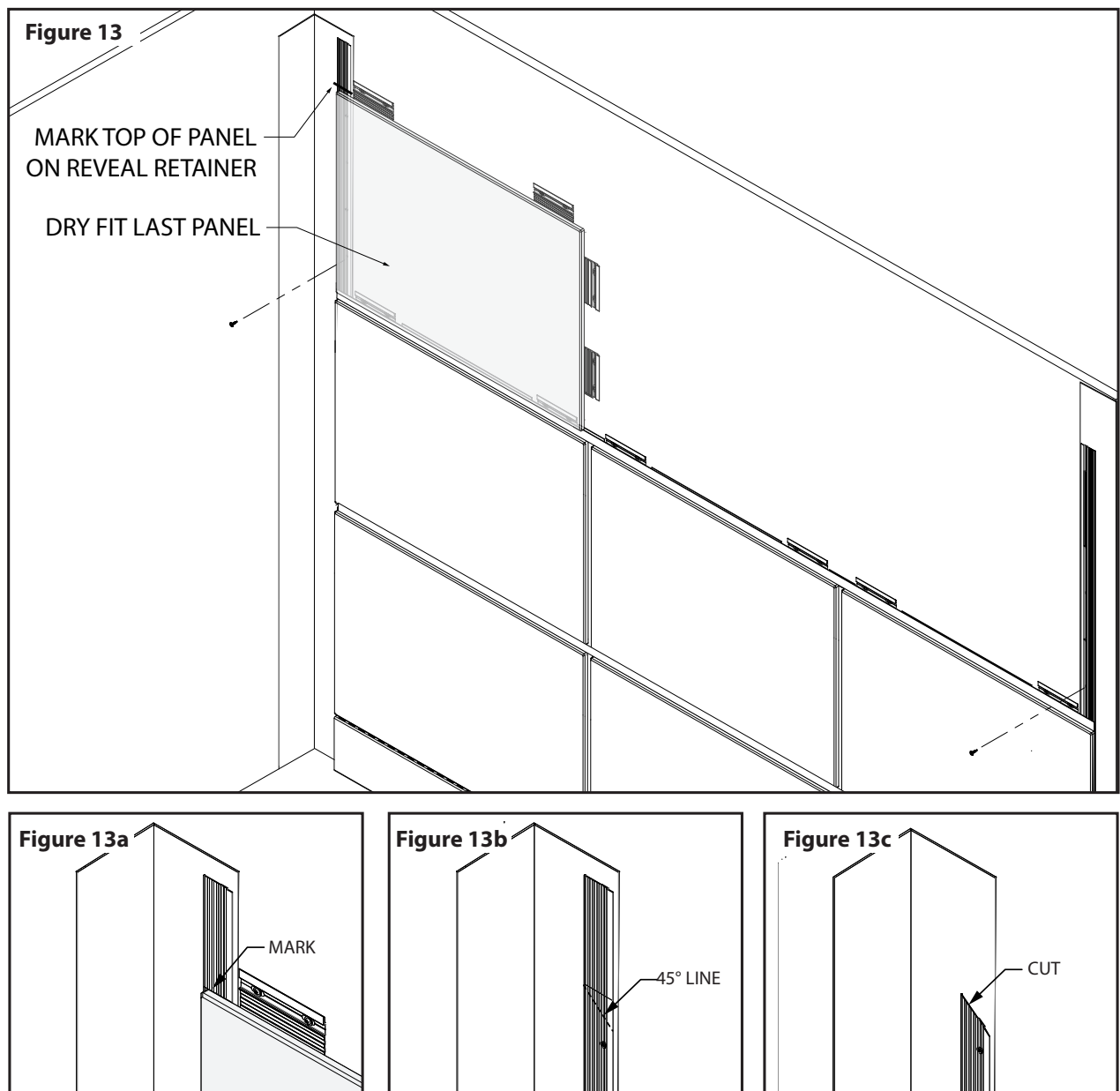

3

Installation Instructions Frieze Install

FRIEZE INSTALLATION -

1. After all panels have been installed, install the frieze by inserting the short lip into the clips, then pivot the frieze into position and secure using HW118/120 screws.

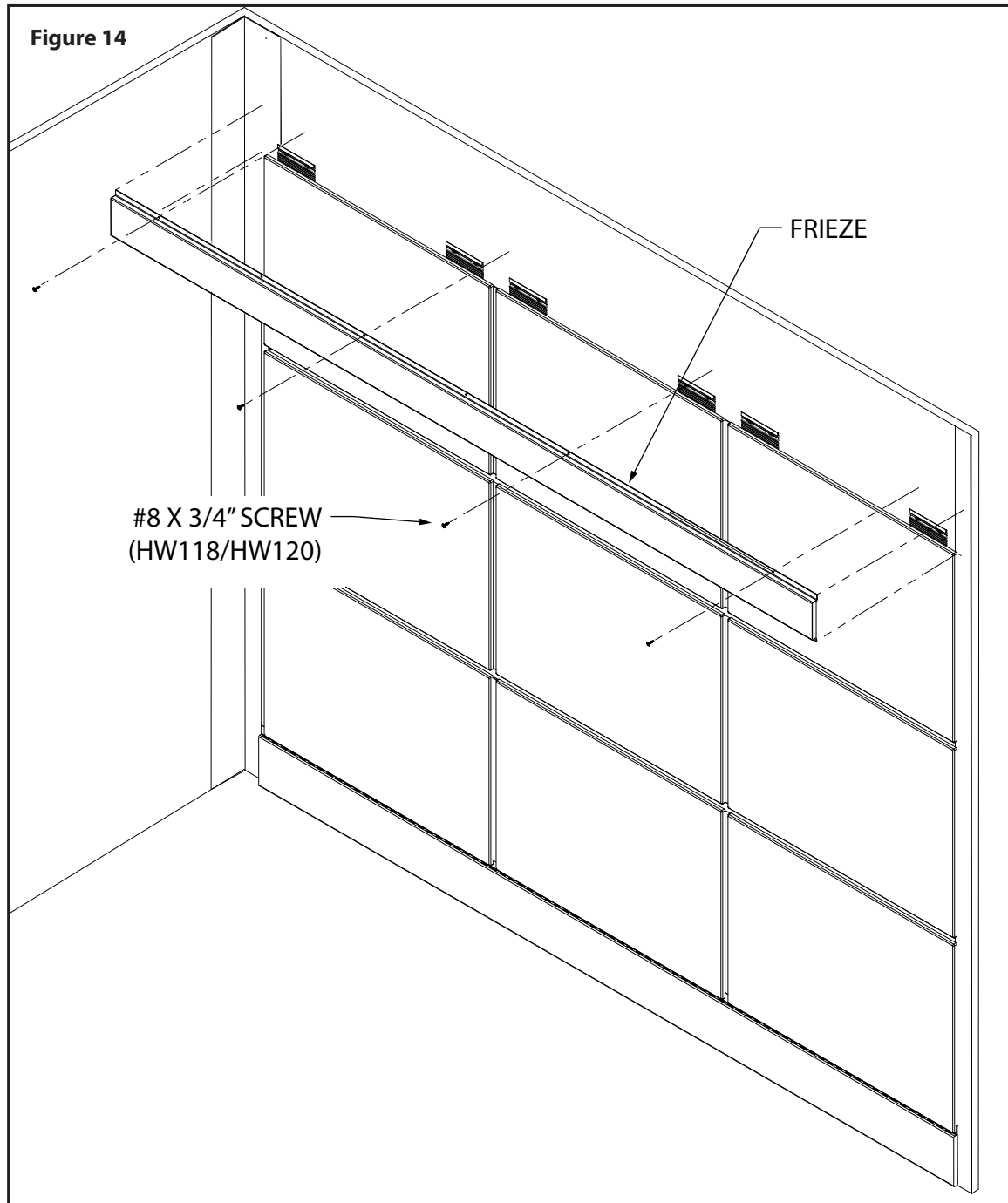

Installation Hotline • 866.EZINPRO

Inprocorp.com • 800.222.5556 • 262.679.9010

World Headquarters S80 W18766 Apollo Drive, Muskego, WI 53150 USA

ASCEND™ •

ELEVATOR PROTECTION SYSTEMS
A DIVISION OF INPRO®

4

Installation Instructions Handrail Install

HAND RAIL INSTALLATION - ON PANELS

1. Position the handrail and brackets on center against the wall. Mark the bracket locations, ensure the handrail is level.
2. Drill the marked hole locations using a 1/2" drill bit, install the supplied toggle bolts by sliding locking collar flush and tight against the face of the panel. TIP: For the bracket to sit flush cut the collar off the toggle using a *sharp* chisel, with flat edge against the panel using light taps on the chisel.
3. Install the handrail. Remove the bracket from the back of the handrail. Locate the bracket at each hole location, and carefully thread the supplied bolt into the toggle. TIP: Turn the bracket so the set screw faces down for a finished look. Install handrail and fasten in place using the set screw..

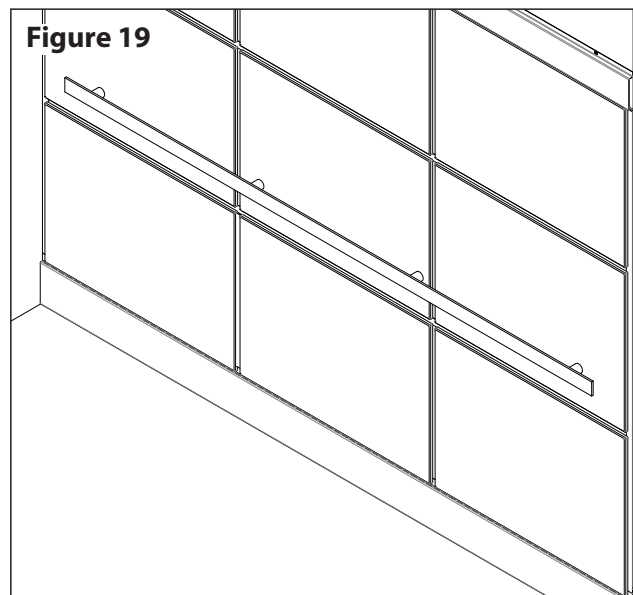
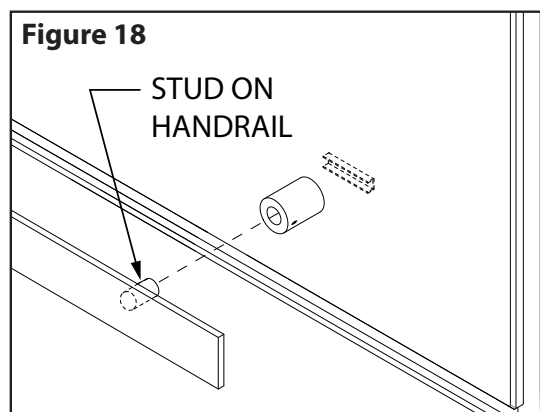
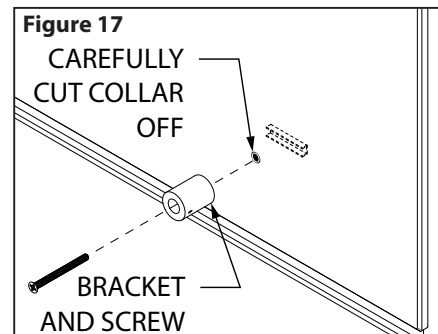
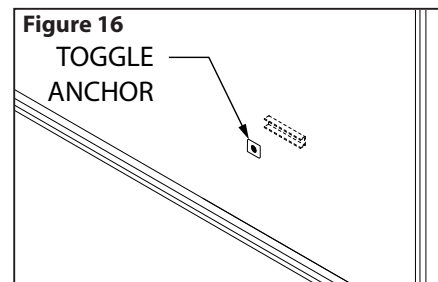
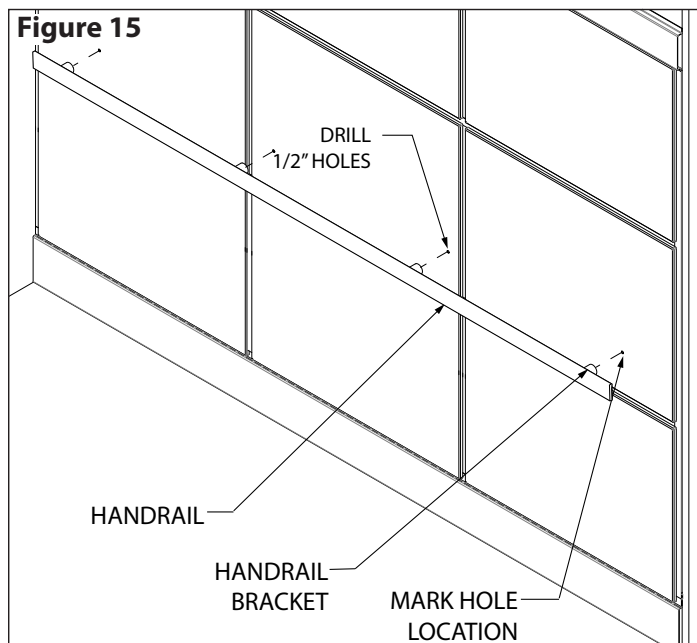

4

Installation Instructions Handrail Install

HAND RAIL INSTALLATION - ON HANDRAIL PANEL

1. Install first row of panels.
2. Dry fit the Stainless Steel Handrail Panel so the small lip sits flat into the reveal groove of the clip. Ensure the panel is aligned on both sides of the panel below. Mark the predrilled hole locations on the panel.
3. Remove handrail panel. Drill the marked holes using a 1/2" drill bit.
4. Install the supplied toggle anchors at each location. Ensure the collar is installed tight.
5. Replace the Stainless Steel Handrail panel, Remove the protective coating from the front side of the handrail panel.
6. Install the handrail bracket with the supplied 3" machine screws.

Continued →

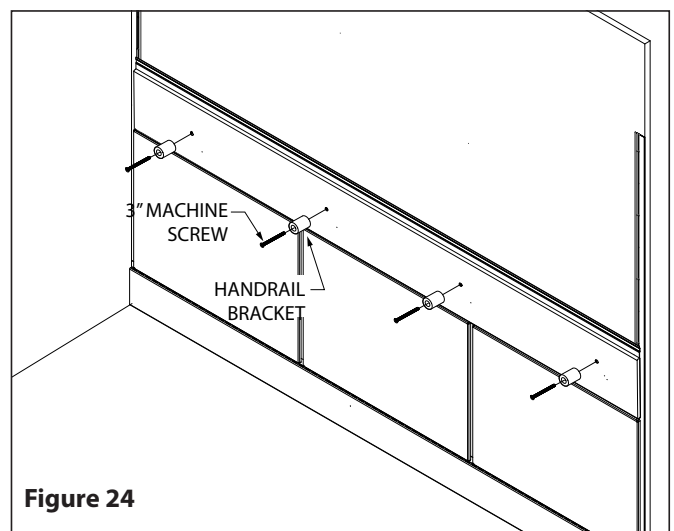
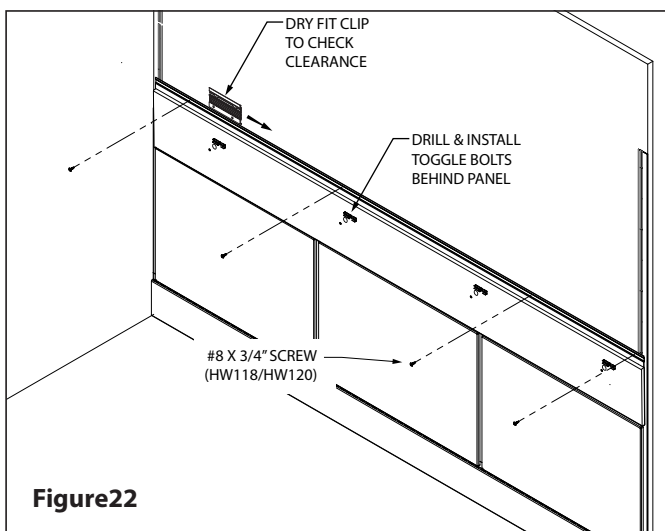
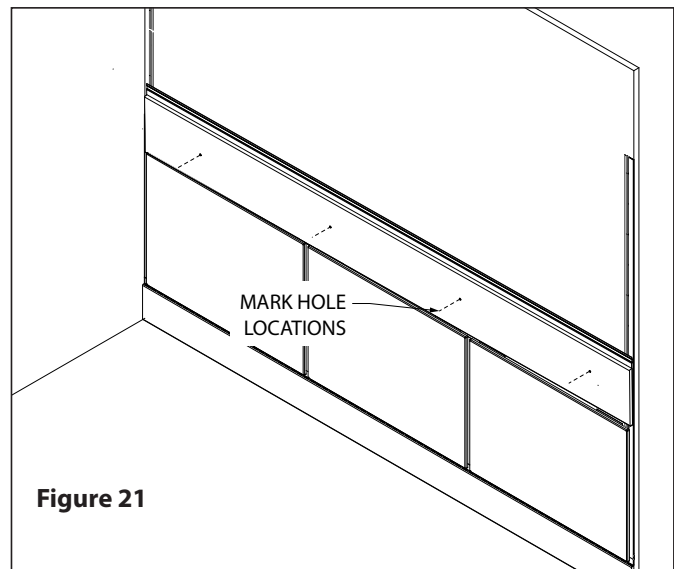
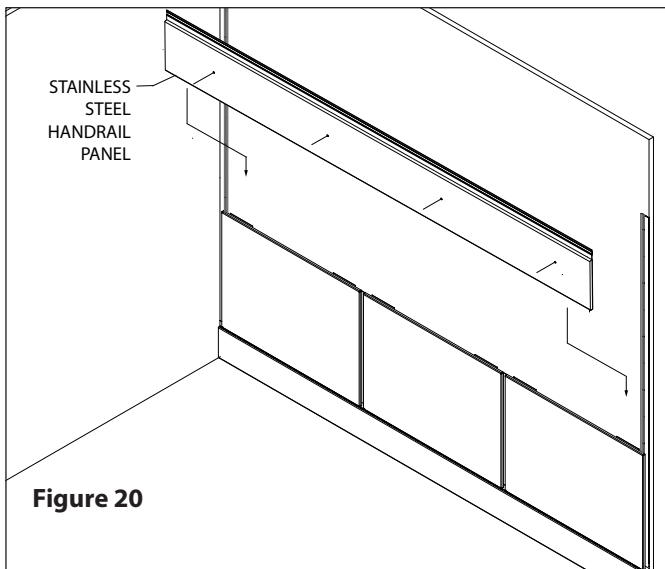

4

Installation Instructions Handrail Install

HANDRAIL INSTALLATION - ON HANDRAIL PANEL

7. Install handrail into the brackets by aligning the welded studs located on the back of the bracket
8. Continue panel installation (see section 3). Once the panels are installed, install the handrail into the brackets, secure the handrail in place using the set screws. TIP: Rotate handrail brackets so the set screw faces downward for a finished look

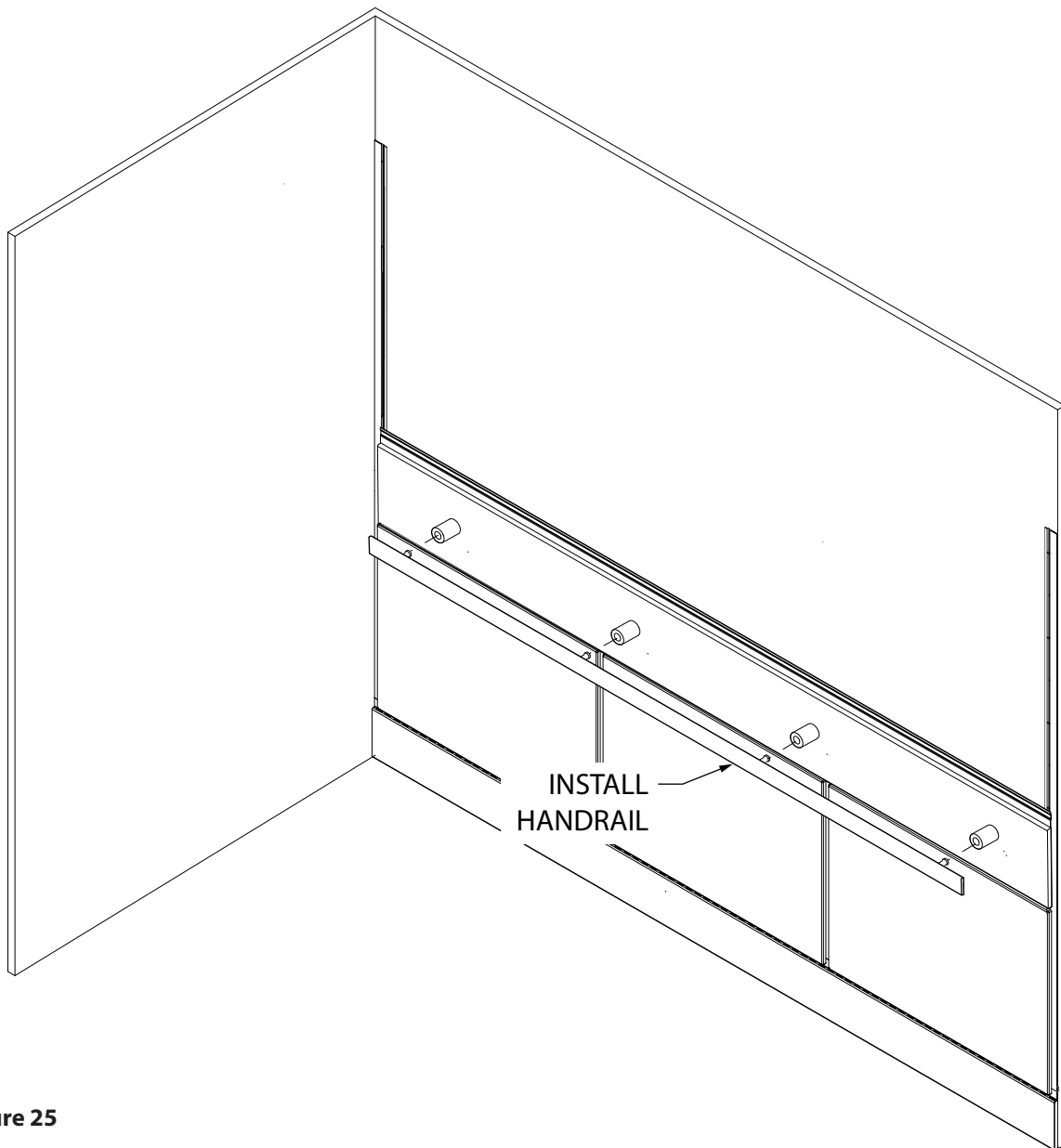

Figure 25