

# Parts Diagram ■

Doni™ Seating Collection  
Armless Task Chair

June 2016

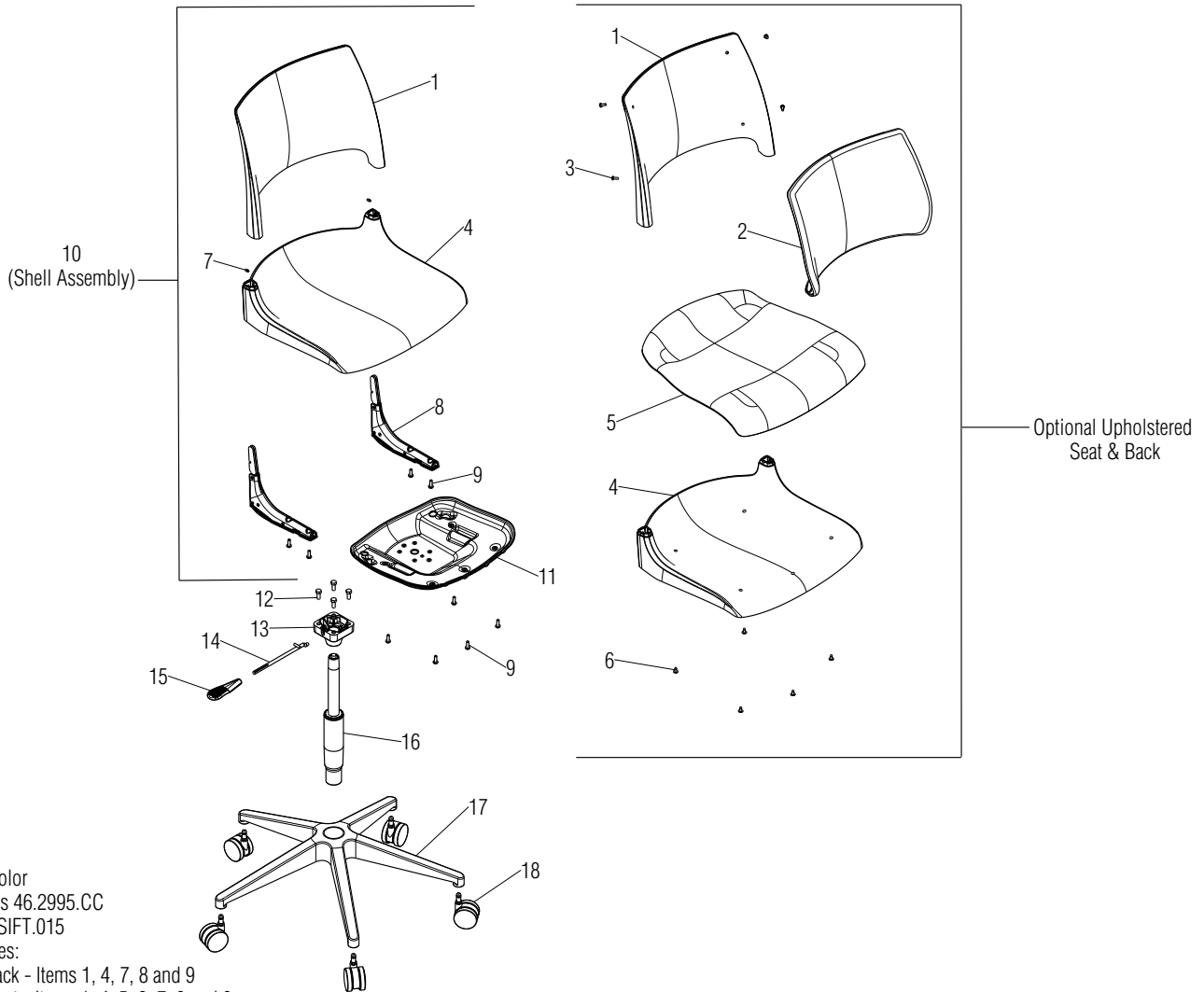

.XX = Select Color  
15.1084.D uses 46.2995.CC  
15.1078 uses SIFT.015

Item 10 includes:  
Poly Seat & Back - Items 1, 4, 7, 8 and 9  
Upholstered Seat - Items 1, 4, 5, 6, 7, 8 and 9  
Upholstered Seat & Back - Items 1, 2, 3, 4, 5, 6, 7, 8 and 9

| Item | Part Number | Item Description  | Qty | Item | Part Number | Item Description   | Qty |
|------|-------------|---|-----|------|-------------|--|-----|
| 1    | 4201.XX     | Backrest, Chair (Poly Back Only)                                | 1   |      | 4225.B.XX   | Assembly, Seat, Back & Mechanism w/ Upholstered Seat & Back  | 1   |
|      | 4201.U.XX   | Backrest, Chair with Liner (Upholstered Back Only)              | 1   | 11   | 46.4244     | Weldment, Doni Seat Support                                  | 1   |
| 2    | DNRBC.XX    | Cushion, Backrest (Upholstered Back Only)                       | 1   | 12   | 12.2003     | Screw, 5/16-18 x 3/4" HX SLF F                               | 4   |
| 3    | 12.0110.XX  | Screw, 10-24 x 1/2" PTH (Upholstered Back Only)                 | 4   | 13   | PT.08.6000  | Casting, Pedestal Cylinder                                   | 1   |
| 4    | 4200.XX     | Seat, Chair (Poly Seat Only)                                    | 1   | 14   | PT.15.6005  | Lever, Height Adjustment                                     | 1   |
|      | 4200.U.XX   | Seat, Chair with Liner (Upholstered Seat Only)                  | 1   | 15   | PT.06.6040  | Handle, Pedestal   | 1   |
| 5    | DNRSC.XX    | Cushion, Seat (Upholstered Seat Only)                           | 1   | 16   | 15.1084.D   | Cylinder, Pneumatic Height Adjustment, Type D                | 1   |
| 6    | 12.0055.CZ  | Screw, #10-16 x 1/2" PTH Type AB T/F ZC (Upholstered Seat Only) | 5   |      | 15.1078     | Cylinder, Gas Seat Height Adjustment (Used w/ SIFT.015 Base) | 1   |
| 7    | 46.4230     | Set Screw, M5 x 0.8 x 10 Hex Socket                             | 2   | 17   | 46.2995.XX  | Base, 5-Blade Cylinder                                       | 1   |
| 8    | 46.4202     | Assembly, Backrest Support Mechanism                            | 2   |      | SIFT.015    | Aluminum Base, Sift Task Chair (Used w/ 15.1078 Cylinder)    | 1   |
| 9    | 12.0011     | Screw, M6 x 18 PPH BosScrew                                     | 9   | 18   | 09.0440.XX  | Caster, 60mm Diameter Carpet                                 | 5   |
| 10   | 4225.XX     | Assembly, Seat, Back & Mechanism                                | 1   |      | 09.0441.BL  | Caster, 60mm Diameter Hard Floor                             | 5   |
|      | 4225.U.XX   | Assembly, Seat, Back & Mechanism w/ Upholstered Seat            | 1   |      |             |  |     |

