

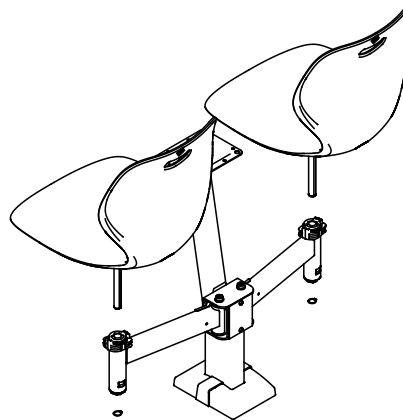

# Disassembly Instructions

## University Lecture Hall Seating

Material Type: A. Steel B. Plastic

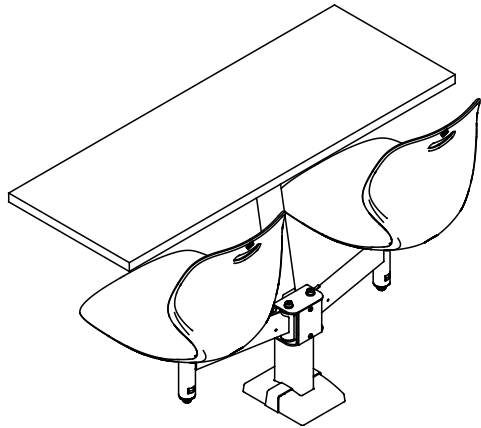

 All fasteners not explicitly tagged or shown are Material Type A: Steel

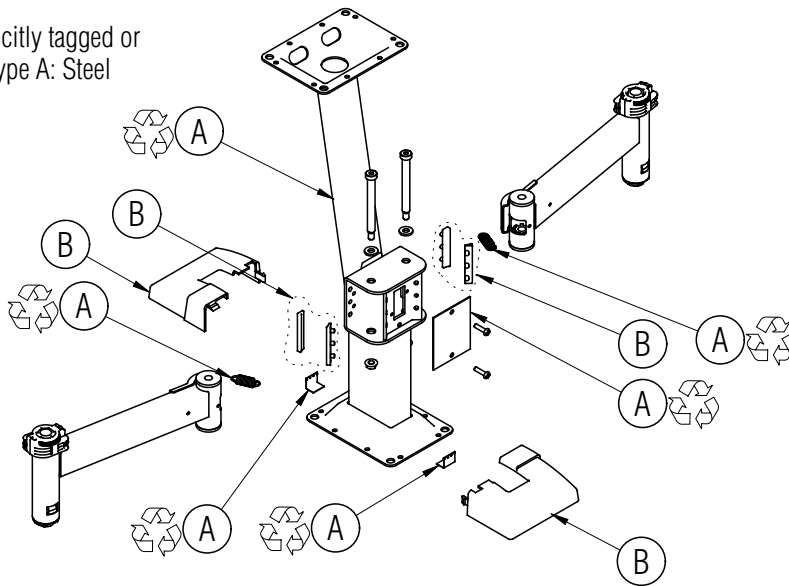

### Procedure:

1. Remove the screws holding the worksurface to the base assembly and remove the worksurface.
2. Remove the retaining ring holding the seat swivel mechanism to the seat and lift out the seat assembly.
3. Remove the screws holding the swing arm cover plate onto the base assembly and remove the plate.
4. Unclip the springs inside the swing arm mount to allow the swing arms to swing freely.
5. Remove the pivot bolt, washer and nut holding on each arm and remove the arms.
6. Pry off the trim covers at the foot of the base and remove the nuts holding the base to the floor. Remove the base and trim clips.

(continued on next page)

### General Notes:

1. Disassembly time: 20-30 minutes
2. This procedure assumes basic familiarity with hand tools and furniture terminology: no specialized training is required
3. All materials removed and disassembled shall be sorted and segregated with like materials and disposed of or recycled according to recycling availability or waste acceptance
4. For items to be recycled, refer to KI's End of Life Recycling Matrix and KI's End of Life Recovery Options Matrix, available at [www.ki.com](http://www.ki.com)



### Required Tools



Gloves



Safety Glasses

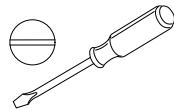

Flat Screwdriver

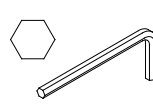

Allen Wrench

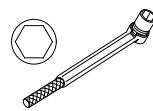

Hex Socket Wrench

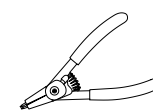

Snap Ring Pliers



Combination Wrench



Pry Bar

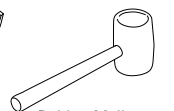

Rubber Mallet

# Disassembly Instructions

University Lecture Hall Seating

Material Type: A. Steel B. Plastic



Procedure (continued):

7. Remove the screws holding the seat to the seat spider and remove the seat.
8. Remove the screws holding the upper cam onto the top of the seat pivot tube and pull off the upper cam, lower cam, spacers, bearing and return spring.
9. Remove the bottom pivot bushing by pinching the sides and driving it out downwards.
10. Remove clip holding the arm pivot shield onto the arm and remove the shield.
11. Remove the arm pivot bushings.

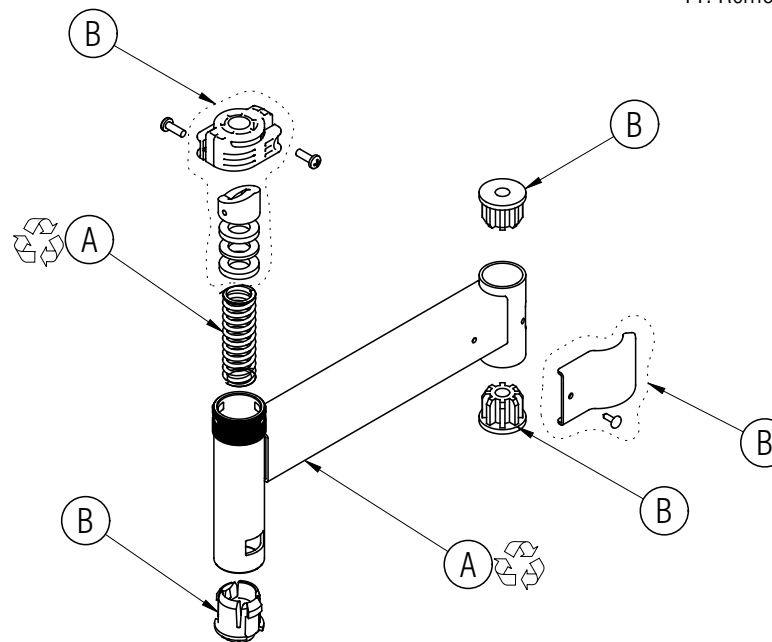
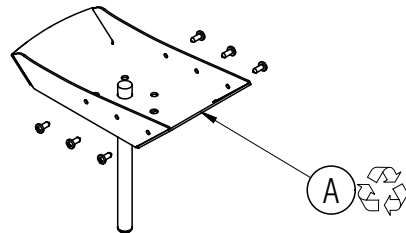
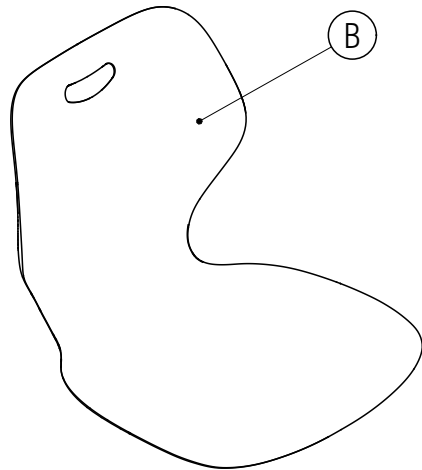

## Required Tools



Gloves



Safety Glasses

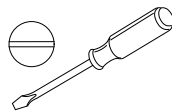

Flat Screwdriver

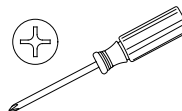

Philips Screwdriver

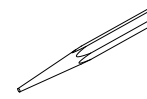

Drift Punch

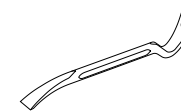

Pry Bar

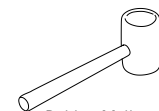

Rubber Mallet