

METALWORKS™ Tin
Lay-in, Tegular, and Nail-up

Inspiring Great Spaces™

Armstrong®
CEILING & WALL SYSTEMS



Cast a Reflection

Meld a classic look with modern performance.

Now, you can get an extra microperforated acoustical tin ceiling with a grid concealing 9/16" Tegular edge.

Bring the glamour back.

With 10 standard and 24 premium patterns in six reflective finishes, you can add a little eye candy to your next design.

Drive vintage to the very corners.

Use a variety of decorative filler panels or one of many stylish cornices to complement 2' x 4' Nail-up panels.



METALWORKS™ Tin

Edge Details



9/16" Lay-in (L9)
15/16" Lay-in (L5)
Nail-up (NU – 2' x 4' only)



9/16" Tegular (T9)



15/16" Tegular (T5)

On the cover: MetalWorks Tin 9/16" Tegular item 56003 Extra Microperforated in Copper with Lay-in Filler item 56009 Extra Microperforated in Copper on Suprafine® 9/16" Exposed Tee suspension system in Bronze; Lancaster Dispensing Company, Lancaster, PA



MetalWorks™ Tin Lay-in item 56008, Lay-in Filler item 56009, and Cornice item 56052 in Chrome with Prelude® XL® 15/16" suspension system in Silver Satin; TrustTexas Bank, SSB, Kyle, TX

Perforation Options



B1 (Unperforated)



B3 (Extra Microperforated)
Hole size: 0.7mm (.028")

KEY SELECTION ATTRIBUTES

- Industry's only:
 - Extra microperforated panels provide acoustics with minimal visual interruption
 - 9/16" Tegal panels reduce visibility of the suspension system
- Antique-type visuals with authentic details
- Variety of standard color and pattern options in 2' x 2' Lay-in and Tegal or 2' x 4' Nail-up sizes
- 2' x 2' 15/16" Lay-in coffer patterns available in three colors
- 18" x 18" Tin infill panels available for Metaphors® Coffers; for details, visit armstrong.com/metaphors
- Wide range of decorative accessories
- Coordinating Armstrong suspension system options
- Additional patterns, fillers and cornices available as premium options; for details, contact Architectural Specialties at 1 877 ARMSTRONG, select options 1-1-4

TYPICAL APPLICATIONS

- Retail
- Restaurant
- Hospitality

METALWORKS™ Tin

Lay-in, Tegular, and Nail-up
smooth texture

PANELS – Standard * 2' x 2' (Lay-in or Tegular) or 2' x 4' (Nail-up)



Item 56001

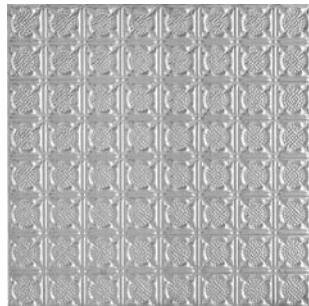

Item 56002

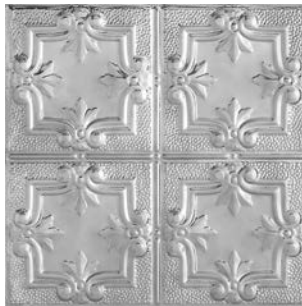

Item 56003



Item 56004

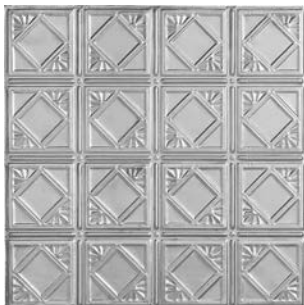

Item 56005

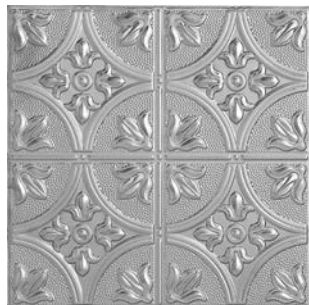

Item 56006



Item 56007



Item 56008

* Only items 56001, 56002, 56003, and 56004 are available with a Tegular edge detail.

NOTE: Panels are directional and must be installed in the same direction.

COFFERS – Standard 2' x 2' (15/16" Lay-in only)



Item 6661



Item 6662

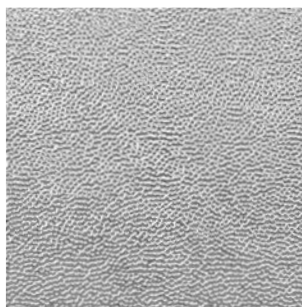

Item 56009

NOTE: Coffers items only available unperforated in White, Bare Steel, and Lacquered Steel finishes.

Borders/Fillers – Standard 2' x 2' (Lay-in only)

FINISHES (Available on standard and premium patterns, coffers, fillers, and cornices)



White (TWH)



Bare Steel (TNA)*



Lacquered Steel (TLS)



Copper (TCP)

* Bare Steel is unfinished and must be field painted to prevent tarnishing over time. The Bare Steel finish may contain slight hairline markings that are visible at eye view, but are covered when painted. For customers who desire the look of natural steel, the Lacquered Steel finish is recommended. These tiles are clear lacquered on both sides and come with plastic PVC to prevent scratching.

See MetalWorks Tin installation instructions (BPLA-297442) at armstrong.com/tin for more information.

PANELS – Premium 2' x 2' (Lay-in) or 2' x 4' (Nail-up only)



Item 6550



Item 6551

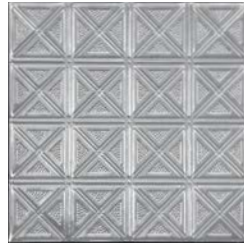

Item 6552

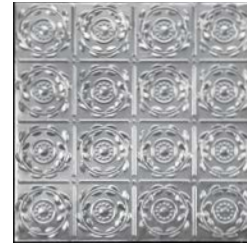

Item 6553

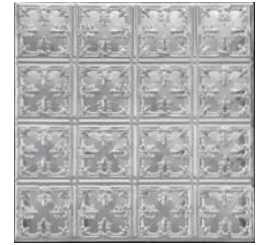

Item 6554



Item 6555



Item 6556

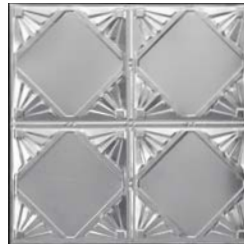

Item 6557

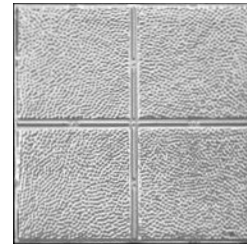

Item 6558



Item 6559



Item 6560

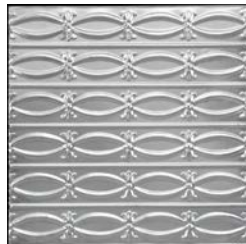

Item 6561



Item 6562



Item 6563



Item 6564



Item 6565



Item 6566

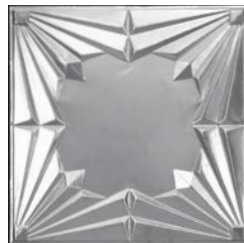

Item 6567



Item 6568



Item 6569



Item 6570



Item 6571

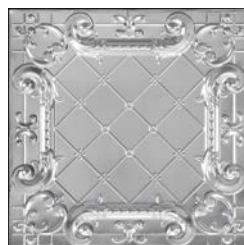

Item 6572



Item 6573

FILLERS – Premium 2' x 4' (Nail-up only)

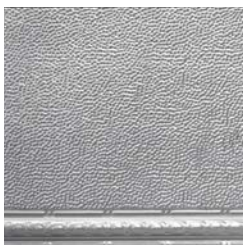

Item 6574
(with 2-1/2" molding)



Item 6575
(with 3" molding)

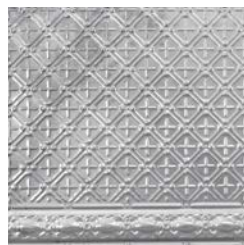

Item 6576
(with 4" molding)



Item 6577

For more information and to order premium patterns, fillers, and cornices, please contact the Architectural Specialties team at 1 877 ARMSTRONG, select options 1-1-4

CORNICES – Standard (Nail-up only)*

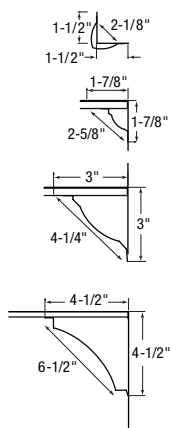

Item 56054

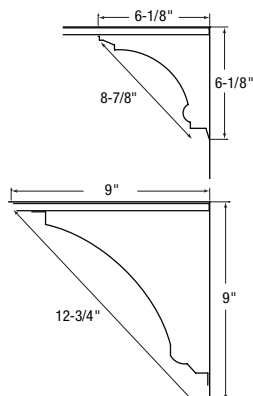

Item 56055



Item 56056

CORNICES – Premium (Nail-up only)*

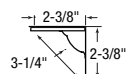

Item 6578

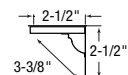

Item 6579

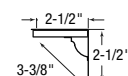

Item 6589

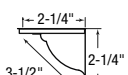

Item 6580

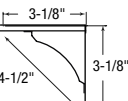

Item 6581

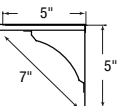

Item 6582

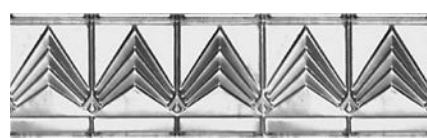
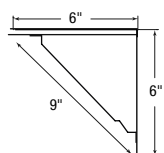

Item 6583

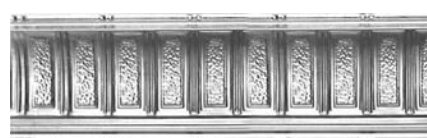
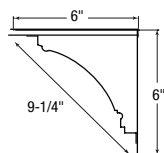

Item 6584

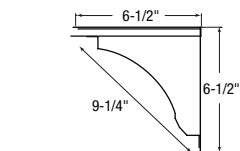

Item 6585

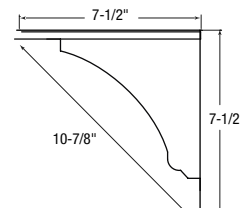

Item 6586

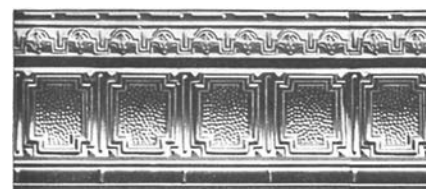
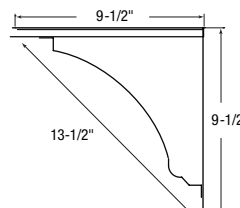

Item 6587

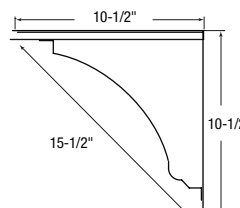

Item 6588

* NOTE: All cornices are 48" long



Nail-up item 56004 in Copper



Coffers Lay-in item 5662 in Lacquered Steel

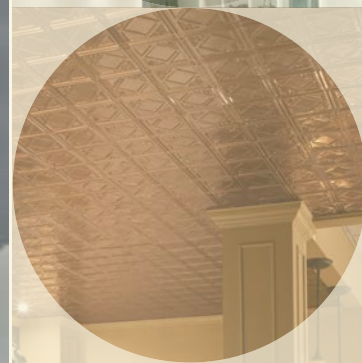

Nail-up item 56005 in Copper

MetalWorks™ Tin 15/16" Tegular item 56007
Extra Microperforated in Lacquered Steel;
The Burger Garage, Long Island City, NY



Before: Mineral Fiber Ceiling

Case Study

Project: The Burger Garage

Location: Long Island City, NY

Product: MetalWorks™ Tin Ceiling

Challenge: When owners Jim and Adam Pileski purchased an old Chinese/Italian restaurant, they knew they wanted to transform it into a high-quality burgers and fries establishment. They also knew they wanted to transform the look of the space from a traditional, but very outdated, ambiance to that of a vintage garage, thereby giving the space a whole new personality while keeping in sync with its location in a semi-industrial area.

Solution: Working with the owners, architect John Artuso completely gutted the space and created an interior design based around a retro garage look, including the use of old service station signs, gas pumps, hanging lamps, old tires, and classic 50's seating.

As part of the new design, he also replaced the existing traditional acoustical ceiling with a MetalWorks Tin ceiling from Armstrong in a lacquered steel finish. MetalWorks Tin ceilings are offered in eight standard decorative patterns, 24 special order patterns, and five standard finishes, including lacquered steel, bare steel, chrome (plated), copper (plated), and white.

"The introduction of the pressed tin look in the ceiling was a perfect complement to the industrial look the owners wanted," Artuso states. "Plus, the look and feel of metal was in line with everything else in the space."

After: MetalWorks Tin 15/16" Tegular item 56007
Extra Microperforated in Lacquered Steel



The 2' x 2' Tegular ceiling panels are installed in a 15/16" suspension system in a coordinating color. The combination of the panel reveal edge and the grid color diminishes the overall visibility of the suspension system.

To enhance acoustics in the space, the panels are extra microperforated. The perforations are only 7mm in diameter, which makes them virtually invisible, but when backed with an acoustical fiberglass infill, the panels achieve a Noise Reduction Coefficient (NRC) of 0.85, meaning they absorb 85% of the sound that strikes them.

METALWORKS™ Tin
Lay-in, Tegular, and Nail-up
smooth texture

UP TO **25%** STEEL **54%** ALUMINUM RECYCLED CONTENT







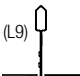
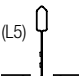

LEED®

- energy management
- construction waste mgmt
- regional materials
- design for flexibility
- EPD
- recyclable/extended

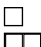
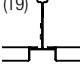
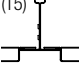
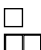
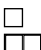
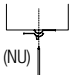
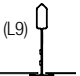
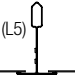
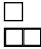
Calculate LEED contribution at
armstrong.com/greengenie

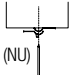
LOCATION DEPENDENT

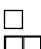
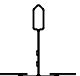
PATTERNS – STANDARD*

Edge Profile	Item Number *	Dimensions (Inches)	Fire Rating
METALWORKS™ Tin			
 (L9)	 (L5)	56001 _____ 24 x 24" 24 x 48" (Nail-up)	 Class A
9/16" Lay-in	15/16" Lay-in	56002 _____ 24 x 24" 24 x 48" (Nail-up)	 Class A
 (T9)	 (T5)	56003 _____ 24 x 24" 24 x 48" (Nail-up)	 Class A
9/16" Tegal	15/16" Tegal	56004 _____ 24 x 24" 24 x 48" (Nail-up)	 Class A
 (NU) Nail Up†			
 (L9)	 (L5)	56005 _____ ** 24 x 24" 24 x 48" (Nail-up)	 Class A
9/16" Lay-in	15/16" Lay-in	56006 _____ 24 x 24" 24 x 48" (Nail-up)	 Class A
 (NU) Nail Up†		56007 _____ 24 x 24" 24 x 48" (Nail-up)	 Class A
		56008 _____ 24 x 24" 24 x 48" (Nail-up)	 Class A
		56009 _____ 24 x 24" 24 x 48" (Nail-up**)	 Class A
Coffers			
 15/16" Lay-in	6661B1L5 ____	24 x 24" Coffer	 Class A
	6662B1L5 ____	24 x 24" Coffer	 Class A

PERFORMANCE

Dots represent high level of performance.

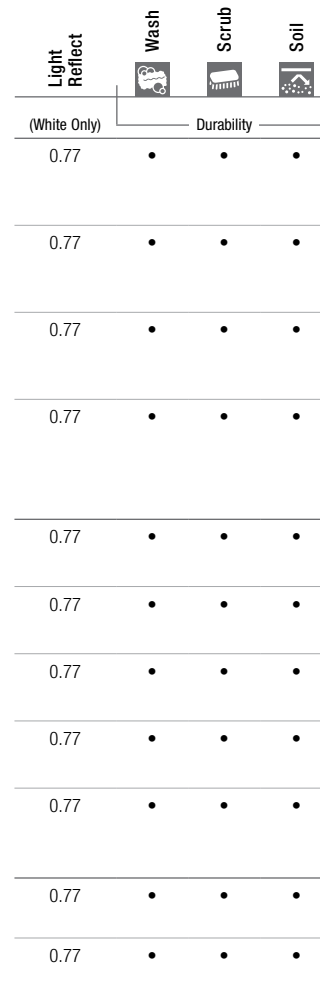

ACOUSTICAL INFORMATION

Perforation	% Open Area	NRC NRC
B1	0%	—
B3	1.5%	0.25 0.85*

* NRC 0.85 with optional fiberglass infill (item 8200100) when using Lay-in or Tegular panels (not applicable for Nail-up).

* When specifying or ordering, include the appropriate 2-letter edge detail, 2-letter perforation, and 3-letter color suffix with the item number. For example: 56001B 1 L 9 T N A is item 56001 Unperforated 9/16" Lay-in Bare Steel. For Coffers items, include 3-letter color suffix only (TWH, TNA, TLS).

† Nail-up panel unperforated only

** Larger scale available as an option custom item 6577

NOTE: Field painting extra microperforated panels will affect acoustical performance.

Item Numbering Key

Step 1: Choose a Pattern (Item #)	Step 2: Choose a Perforation (2-digit suffix)	Step 3: Choose an Edge detail (2-digit suffix)	Step 4: Choose a Color (3-digit suffix)
<input type="checkbox"/> 56001	<input type="checkbox"/> B1 = Unperforated	<input type="checkbox"/> L9 = Lay-in 9/16"	<input type="checkbox"/> TWH = White
<input type="checkbox"/> 56002	<input type="checkbox"/> B3 = Extra Microperforated	<input type="checkbox"/> L5 = Lay-in 15/16"	<input type="checkbox"/> TCP = Copper
<input type="checkbox"/> 56003		<input type="checkbox"/> T9 = Tegular 9/16"	<input type="checkbox"/> TNA = Bare Steel
<input type="checkbox"/> 56004		<input type="checkbox"/> T5 = Tegular 15/16"	<input type="checkbox"/> TLS = Lacquered Steel
<input type="checkbox"/> 56005		<input type="checkbox"/> NU = Nail-up (2' x 4')	
<input type="checkbox"/> 56006			
<input type="checkbox"/> 56007			
<input type="checkbox"/> 56008			
<input type="checkbox"/> 56009			

Example: 56001 B1 L9 TWH

METALWORKS™ Tin

Lay-in, Tegal, and Nail-up smooth texture

SUSPENSION SYSTEM (See catalog for Prelude® XL® and Suprafine® XL components.)

15/16"	Prelude XL
9/16"	Suprafine XL

COORDINATING SUSPENSION SYSTEM COLORS Due to printing limitations, shade may vary from actual product.

MetalWorks Tin Color

White (TWH)	Copper (TCP)	Bare Steel (TNA) Lacquered Steel (TLS)	Bare Steel (TNA) Lacquered Steel (TLS)
----------------	-----------------	---	---

Suspension System Color

White (WH)	Bronze (BZ)	Silver Satin (SA)	Gun Metal Grey (MY)
---------------	----------------	----------------------	------------------------

ACCESSORIES

Item Number	Description	Dimensions	Color	Pieces/Carton*
56051__*	Cornice	1-1/2" x 2-1/8" x 48"	See above	—
56052__	Cornice	3" x 3" x 48"	See above	—
56053__	Cornice	1-7/8" x 1-7/8" x 48"	See above	—
56054__	Cornice	4-1/2" x 4-1/2" x 48"	See above	—
56055__	Cornice	6-1/8" x 6-1/8" x 48"	See above	—
56056__	Cornice	9" x 9" x 48"	See above	—
5600__	Conehead Nails (installs up to 200 SF per carton)	1-1/4"	See above	—
5600HDC	Hold Down Clips	—	—	1000 pcs/ctn
8200100	Fiberglass Infill Panel	2' x 2' x 1"	Black	12

- * When specifying or ordering, include the appropriate 3-letter color suffix with the item number (56051TWH).
- * Pieces per carton will vary based on order size.

PHYSICAL DATA

Material

Steel — thickness .010"
For Chrome and Copper panels:
Aluminum — thickness .020"

Surface Finish

Copper v — plated
Bare Steel — unfinished
White — factory-applied powder-coated finish
Lacquered Steel — factory-applied lacquered finish

Fire Performance

ASTM E84 surface burning characteristics. Flame Spread Index 25 or less. Smoke Developed Index 50 or less.
Class A per IBC.

ASTM E1264 Classification

Fire Class — Class A
Unperforated steel ceiling panels — Type XX, Pattern J, Z
Perforated steel ceiling panels — Type XX, Pattern C, J, Z

Design Considerations

As a result of the strain put on panels when they are embossed, you may find it necessary to use hold down clips (item 5600HDC) to keep the panels flat in the suspension system. Due to the natural characteristics of Lay-in and Tegal edges on this tin product, panels may not lay flush. MetalWorks Tin panels are produced from steel or aluminum and are designed to emulate an antique-type visual. Periodic "wrinkles" or dents may cause panels to appear not to be flat; these characteristics add to the antique effect and are not considered manufacturing defects.

Bare Steel is unfinished and must be field-painted to prevent tarnishing over time. The Bare Steel finish may contain slight hairline markings that are visible at eye view, but are covered when painted. For customers who desire the look of natural steel, the Lacquered Steel finish is recommended. These panels are clear lacquered on both sides and come with plastic PVC to prevent scratching.

See armstrong.com/tin for more details.

Recommended Suspension System

9/16" Suprafine® XL® suspension system
15/16" Prelude® XL suspension system

Warranty

Details at armstrong.com/warranty

Weight

Steel — 0.45 lbs/SF
Coffers — 0.52 lbs/SF
Aluminum — 0.38 lbs/SF



TechLine™ / 1 877 ARMSTRONG
1 877 276 7876
armstrong.com/tin
BPCS-3982-815

LEED® is a registered trademark of the U.S. Green Building Council
All other trademarks used here are the property of AWI Licensing Company and/or its affiliates
© AWI Licensing Company, 2015 • Printed in the United States of America

