

Please read entire guide prior to starting installation.

NOTES

1. All installations must be executed in accordance with local codes.
2. The installing contractor assumes all liability for the safety and code compliance of the installation.
3. Optic Arts is not liable for any damages caused by improper wiring, circuit overloading, power surges, poor system design or layout, negligence or other conditions.

FLEX STP INSTALLATION GUIDE

1.

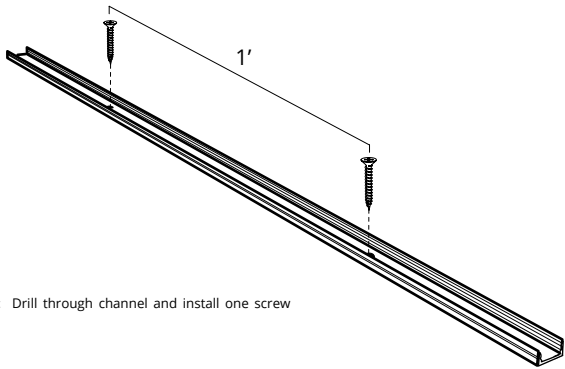

1.1 Channel without mounting clips: Drill through channel and install one screw per foot.

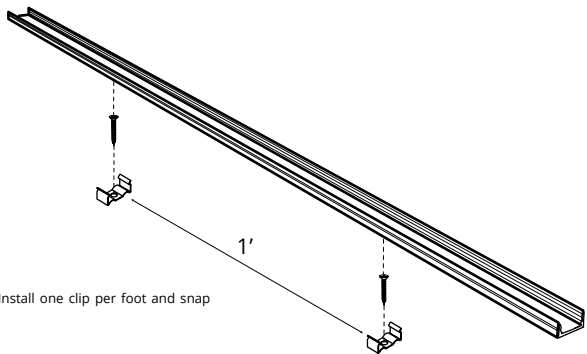

1.2 Channel with mounting clips: Install one clip per foot and snap channel into clips.

a) Join channels end to end if aligning multiple channels for longer runs.

FLEX STP INSTALLATION GUIDE

2.

2.1 Remove liners from the back of the FLEX STP.

2.2 Install FLEX STP into channel avoiding any bubbles, folds, or creases.

2.3 Apply pressure to FLEX STP by firmly, but gently, pressing down with your fingers.

2.4 Install FLEX.ZIP mounting clip 3" away from end of mounting tape.

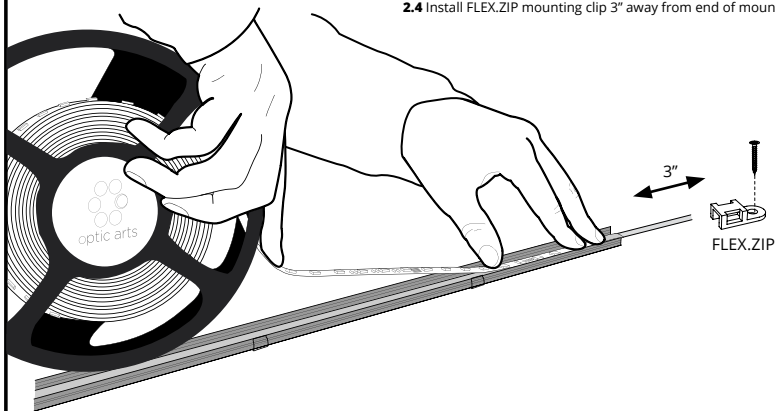

3.

3.1 Place a bead of the provided UV glue adhesive on each corner of the FLEX STP at the power feed end and the dead end. Make sure the glue covers the complete ends and wraps around the heatshrink for the power feed side. **Do NOT get any glue onto the LED's.**

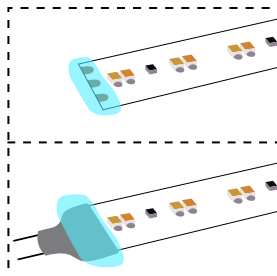
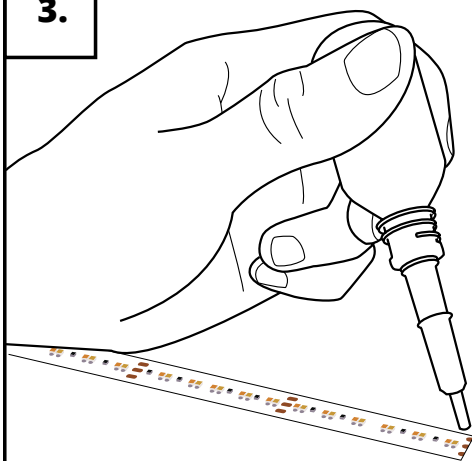

FLEX STP INSTALLATION GUIDE

4.

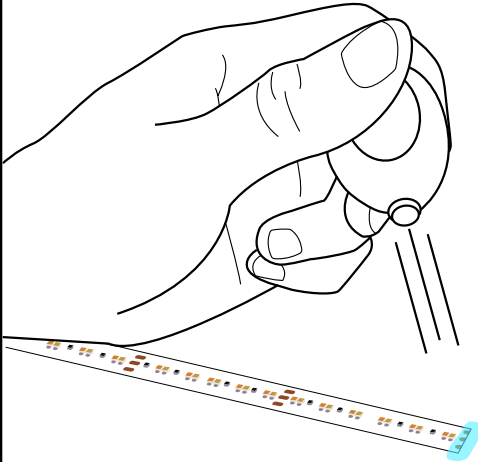

2.1 Cure the UV glue by holding the provided UV Lamp close to the top of applied glue for one minute. Use protective eye wear before turning on the UV Lamp. **Do NOT look directly into UV lamp when turned on.**

5.

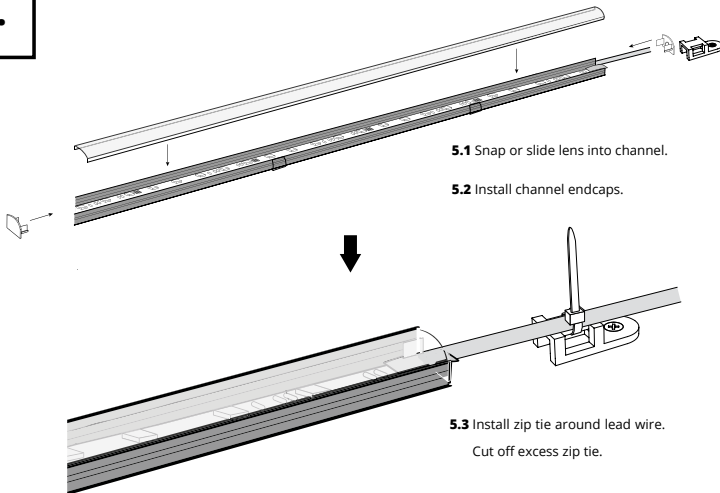

5.1 Snap or slide lens into channel.

5.2 Install channel endcaps.

5.3 Install zip tie around lead wire.
Cut off excess zip tie.