

If you have a problem, question, or request, call your local dealer, or Steelcase Line 1 at **888.STEELCASE** (888.783.3522) for immediate action by people who want to help you. (Outside the U.S.A., Canada, Mexico, Puerto Rico, and the U.S. Virgin Islands, call: 1.616.247.2500) Or visit our website: www.steelcase.com
 © 2008 Steelcase Inc.
 Grand Rapids, MI 49501
 U.S.A.
 Printed in U.S.A.

PROFILE OF HARDWARE FOR CLARITY

M6 x 16mm
Pan Head Screw

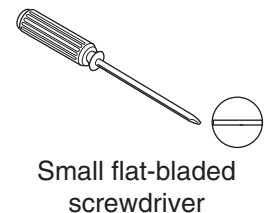
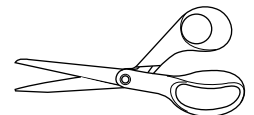
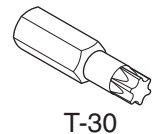
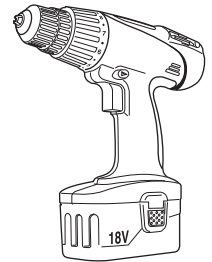
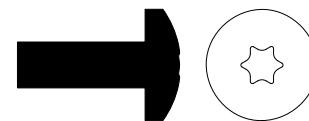

If you want to save the back shell, use this method.

1. Begin removing the back fabric by first inserting screwdriver (1a) and prying as shown (1b). Once fabric is pried away from the back shell, it is now easy to loosen the rest of the fabric using your hand working right to left. Pull fabric out of the way so screws may be removed in step 2 (1c).

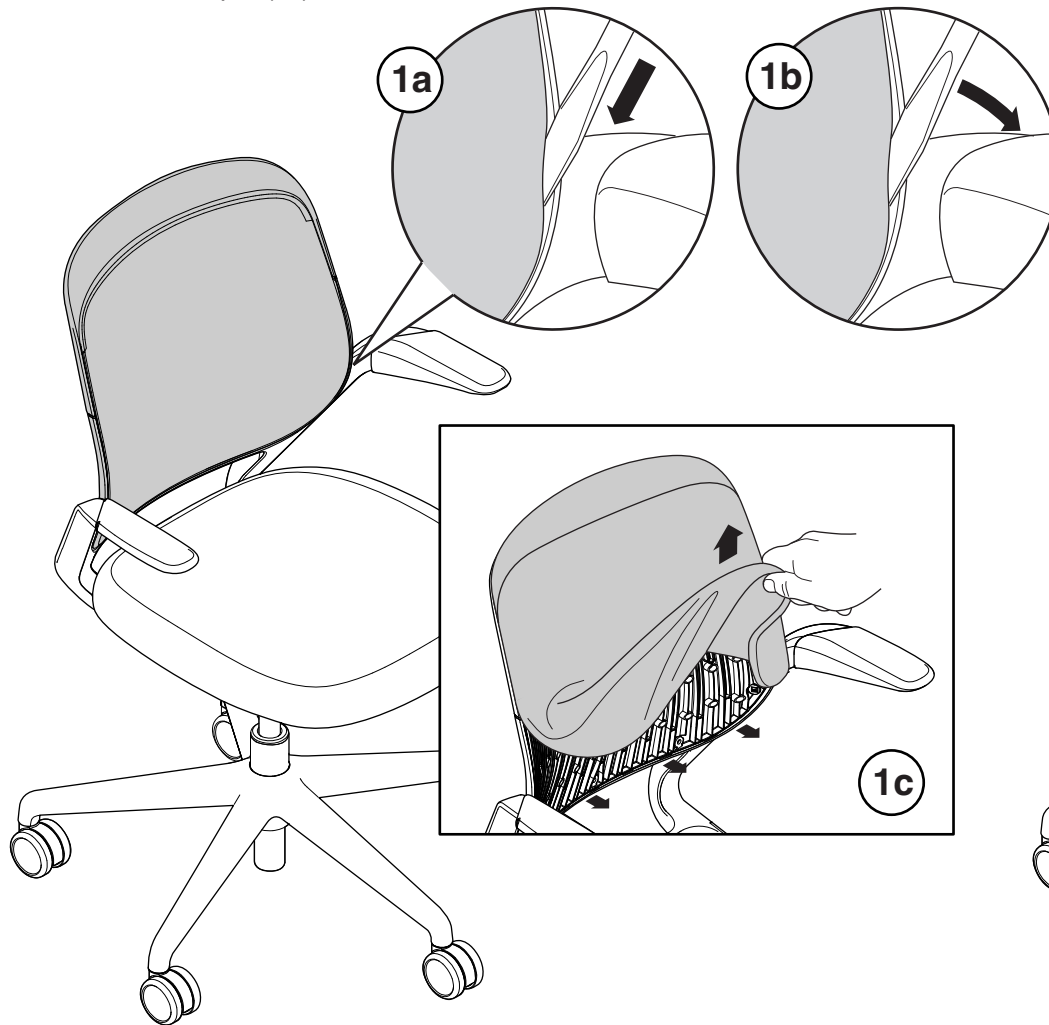

or

If you want to throw away the back shell, use this method.

1. Cut the fabric on back with scissors. This will allow you to gain access to the screws that must be removed in order to replace the back shell.

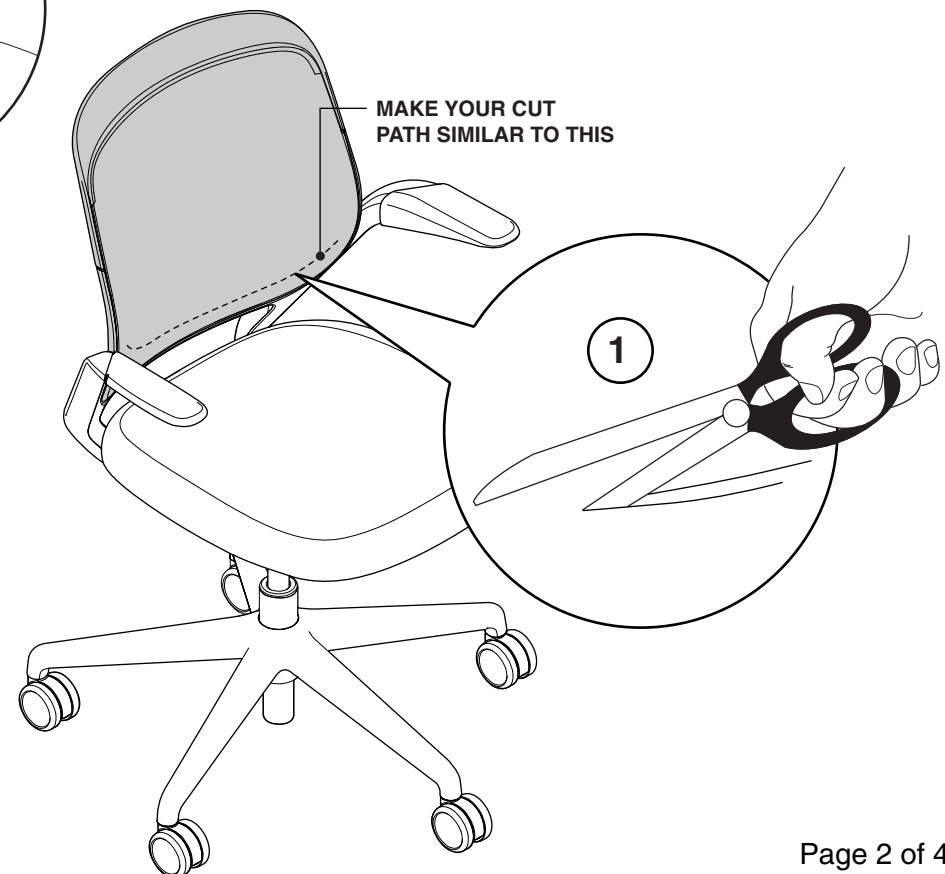

2. Remove five (5) M6 x 16mm pan head screws using a T-30 torx bit.

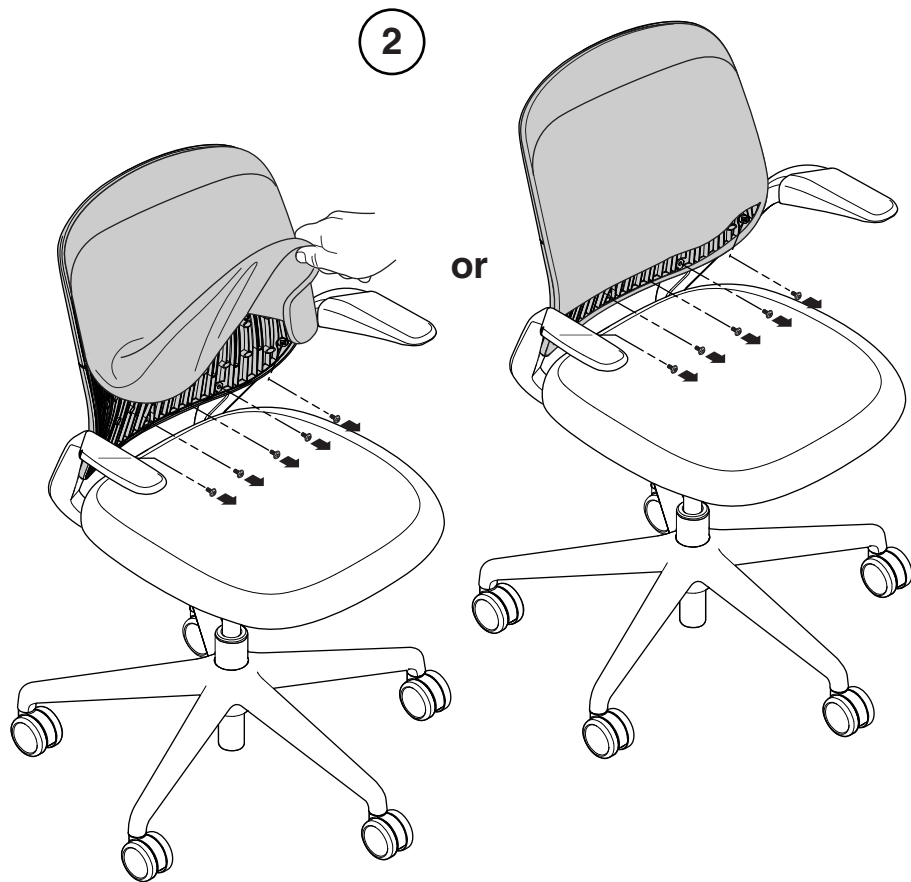

3. Remove existing back shell.

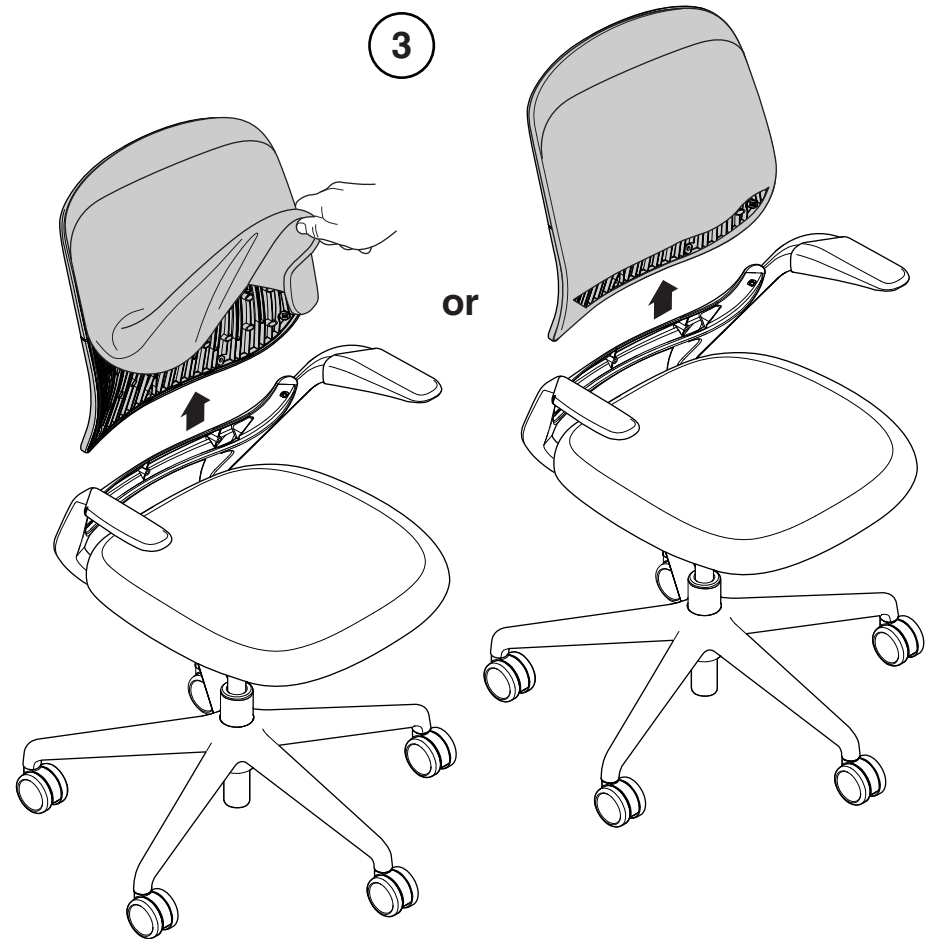

- 4.** Place new back into place and secure with five (5) M6 x 16mm pan head screws to a torque of 50-70 in-lbs.

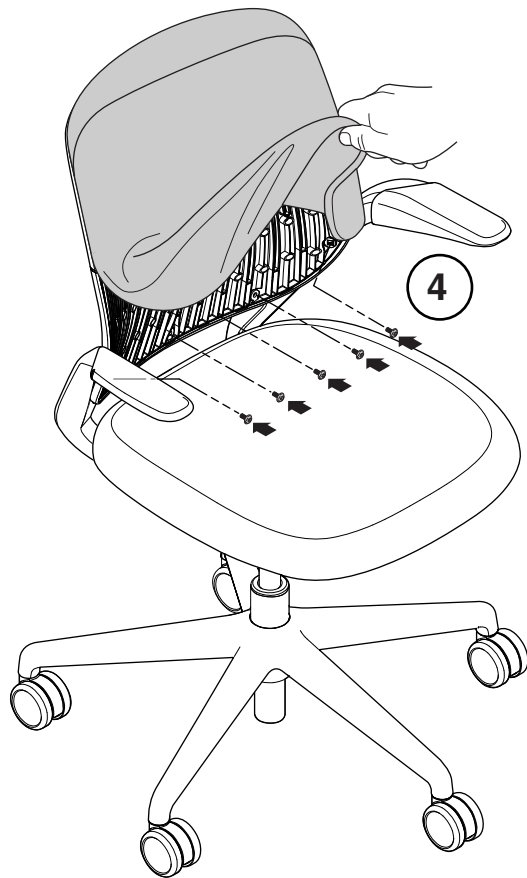

- 5.** Tuck the rest of the fabric into the back shell by working the fabric toward the center of the bottom of the shell.

NOTE: There is a groove in the back shell that will accept the edge of the fabric.

