

### Fixed Shelf Installation

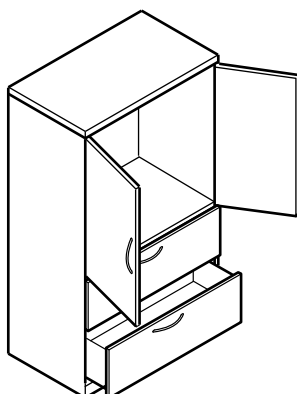

### 1.5-Hi Adjustable Shelf Adjustment

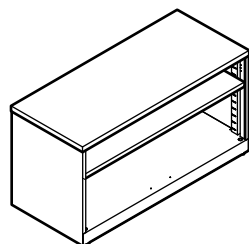

### Adjustable Shelf and Display Installation

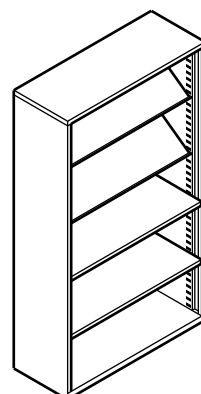

### Open Side Tower Shelf Installation

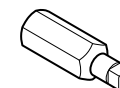
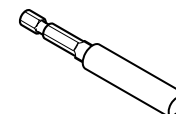
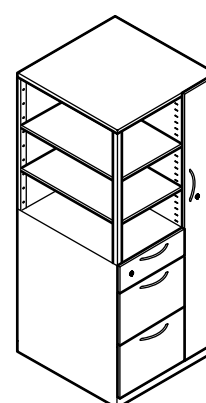

#2 SQ. DRIVE BIT

### Table of Contents

Page	Topic
2	Fixed Shelf Installation
3	1.5-Hi Adjustable Shelf Adjustments
4	Adjustable Shelf Installation
5	Installing a Display Shelf
6	Open Side Tower Shelf Installation

If you have a problem, question, or request, call your local dealer, or Steelcase Line 1 at **888.STEELCASE** (888.783.3522) for immediate action by people who want to help you. (Outside the U.S.A., Canada, Mexico, Puerto Rico, and the U.S. Virgin Islands, call: 1.616.247.2500) Or visit our website: [www.steelcase.com](http://www.steelcase.com)

© 2010 Steelcase Inc.  
Grand Rapids, MI 49501  
U.S.A.

Printed in U.S.A.

## Fixed Shelf Installation

**1.** Insert bracket (1a) and rotate down (1b).

**2.** Set shelf on brackets. Locate in one of two positions "proud" or "flush" (based on door/drawer type). Rear is for flush units and front is for proud units.

**3.** Screw shelf to bracket from underside using pan head screw supplied. Use a flat head screw only when a stacking lift up door is on top of a lift door.

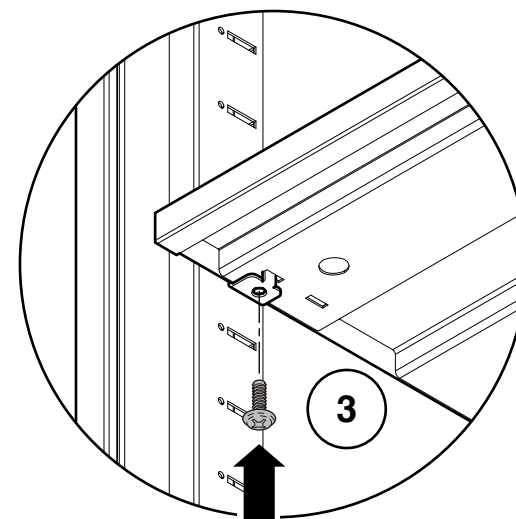
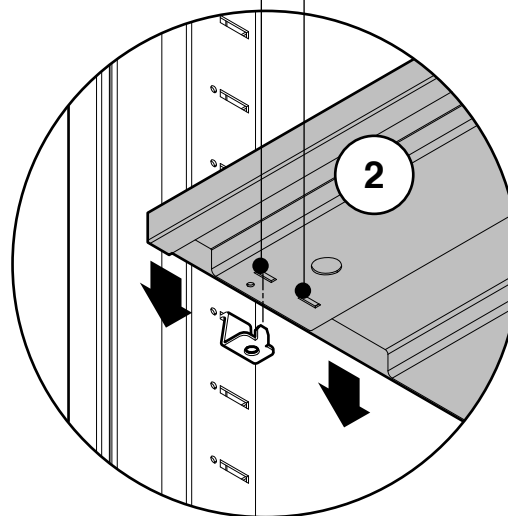
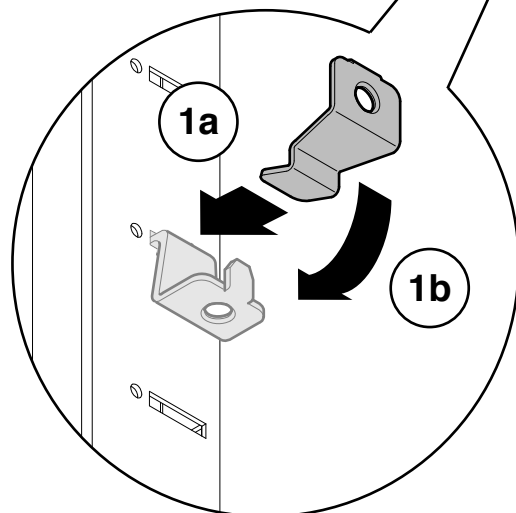
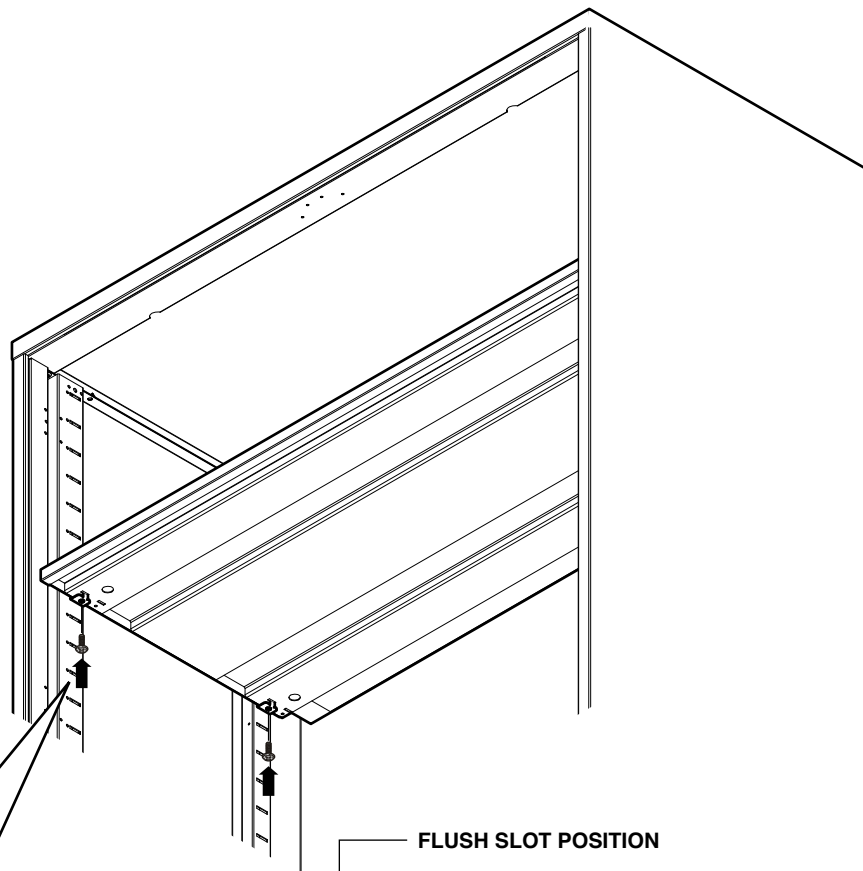

## 1.5-Hi Adjustable Shelf Adjustments

- 1.** Lift up shelf to remove it from the four (4) shelf brackets.
- 2.** Remove all four (4) brackets as shown.
- 3.** Reinstall all four (4) brackets by reversing step 2.
- 4.** Before placing shelf onto brackets, note which slots are aligned with the brackets (proud or flush). Install shelf onto the brackets by reversing step 1.

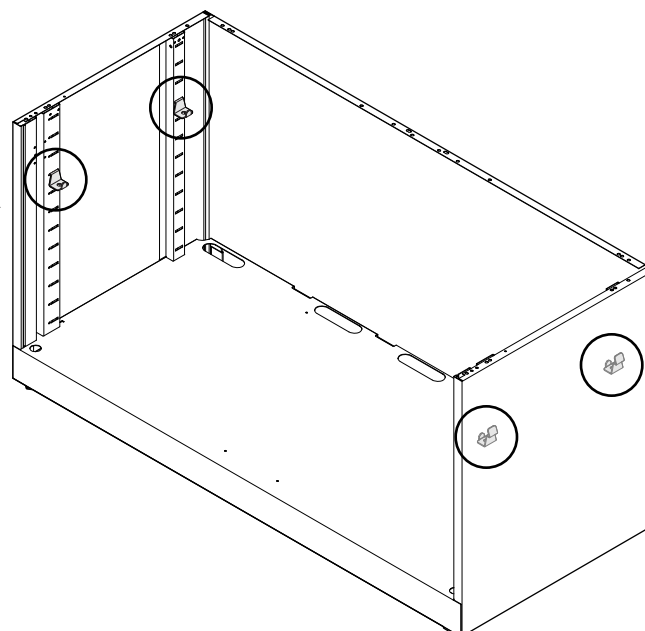
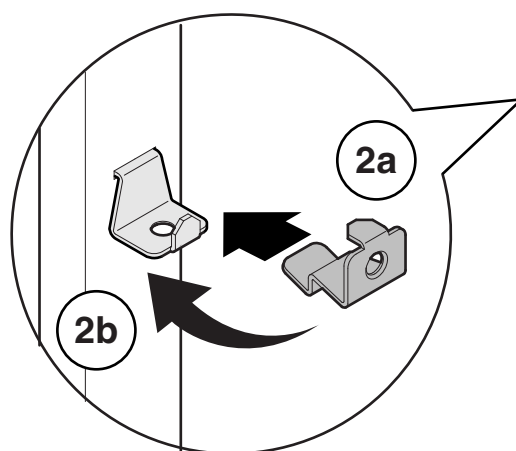
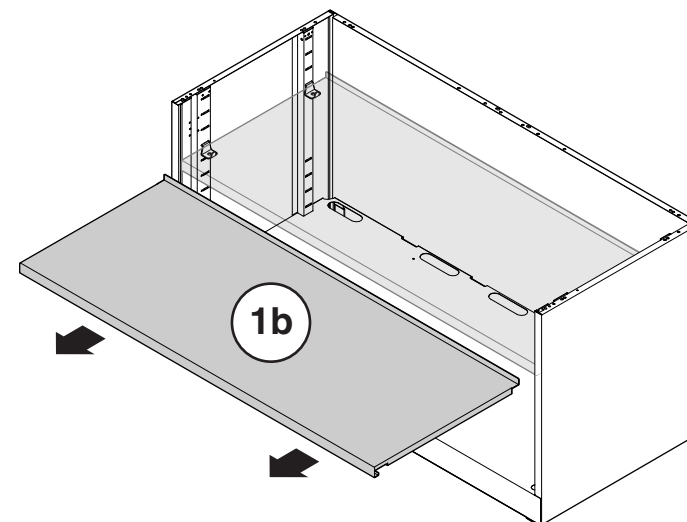
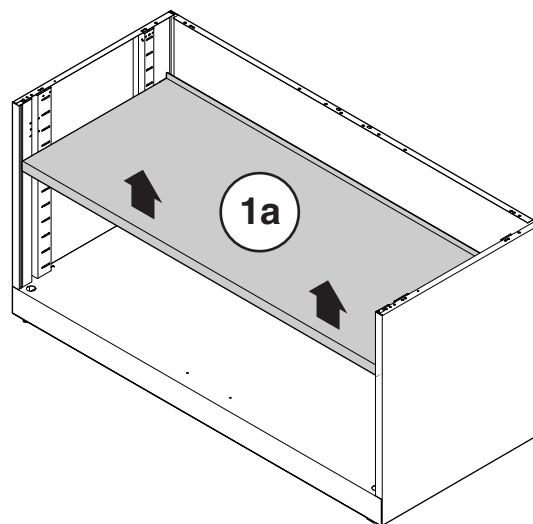

### Shelf Installation (Proud)

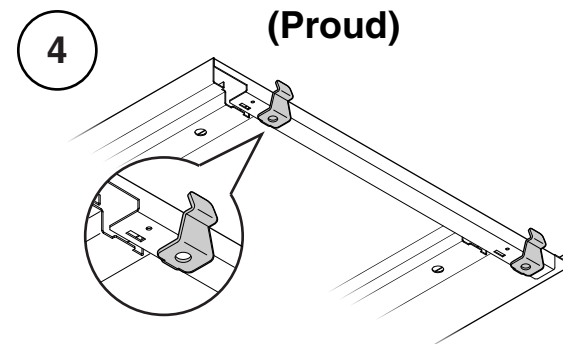

### Shelf Installation (Flush)

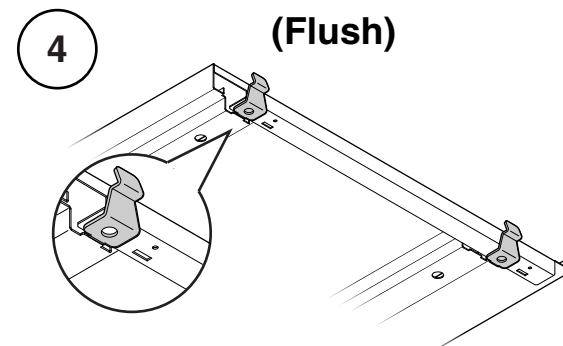

## Adjustable Shelf Installation

1. Insert all four (4) brackets in position shown.

**NOTE:** Bracket can be installed in two (2) different orientations. This gives 3/4" adjustment increments in cabinet.

2. Place shelf on top of brackets. Make sure the shelf falls onto detail on bracket. The shelf has two (2) positions in the case. If the door hits the shelf when it is closed, move the shelf to the rearward position.

Rear position is used for flush units. Front position is used for proud units.

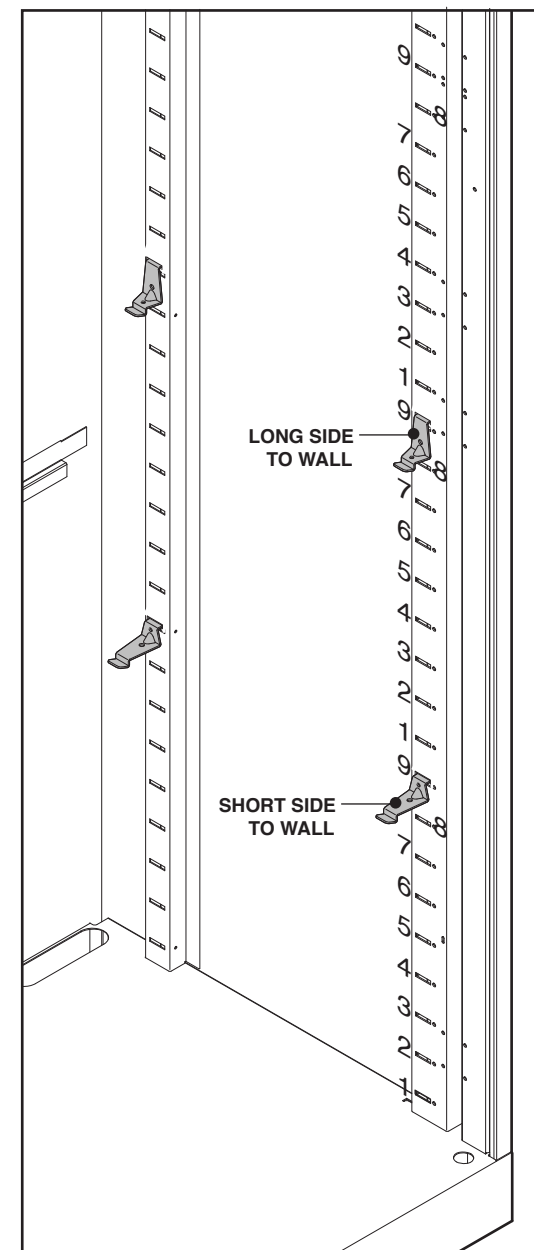
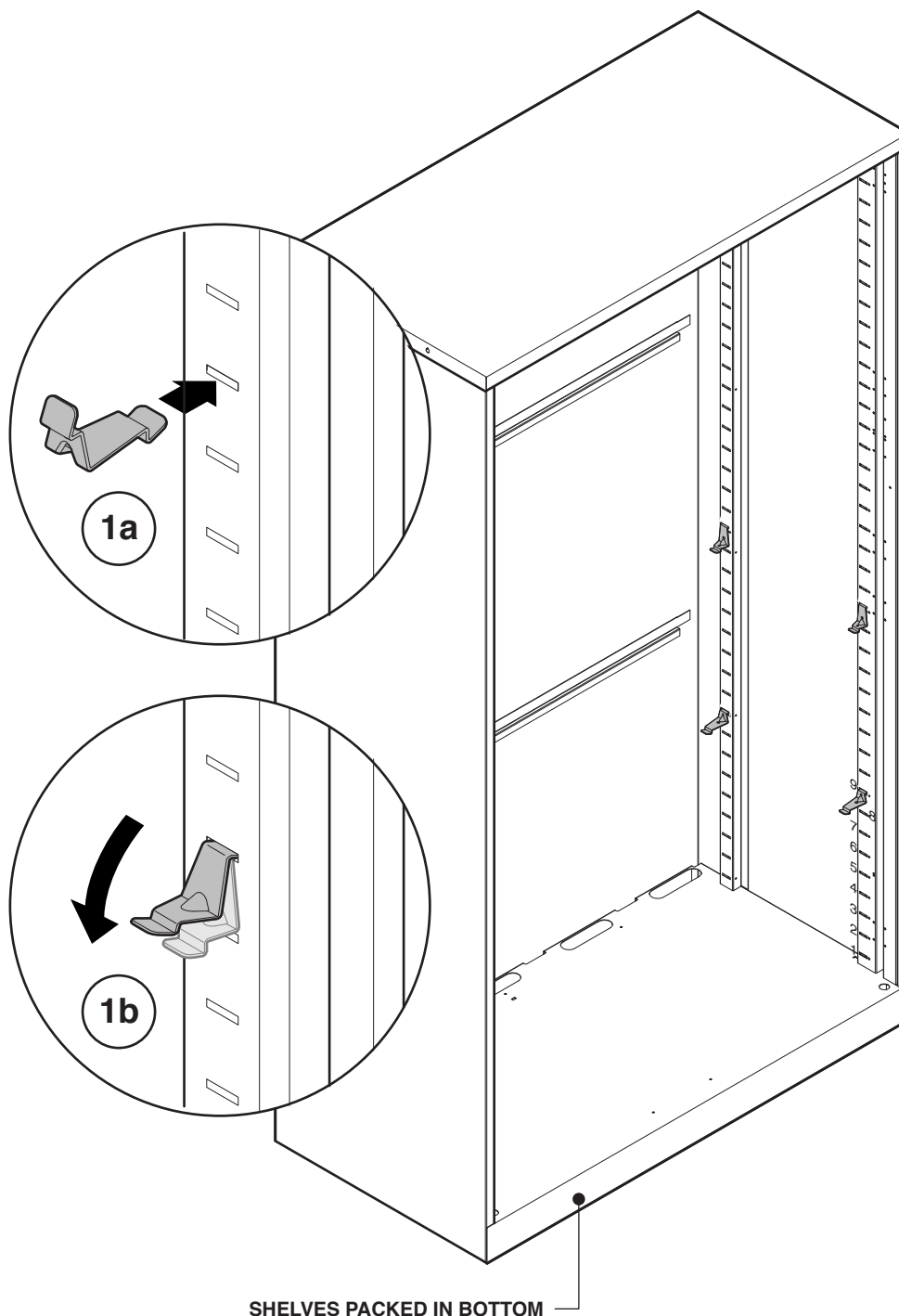

For binder storage between shelves, follow this bracket placement.

## Installing a Display Shelf

### 1. Install display shelf bracket:

- Align tabs to slot locations.
- Slide bracket to rear of case.
- To remove display shelf bracket, pull tab out until bracket can slide forward.

### 2. To install display shelf:

- Slide down until the hook engages and the shelf rests on the bottom flange.
- Add #10-32 x 1/2" screw.

**TIP:** If the display shelf is in the lowest position, the screw is not required.

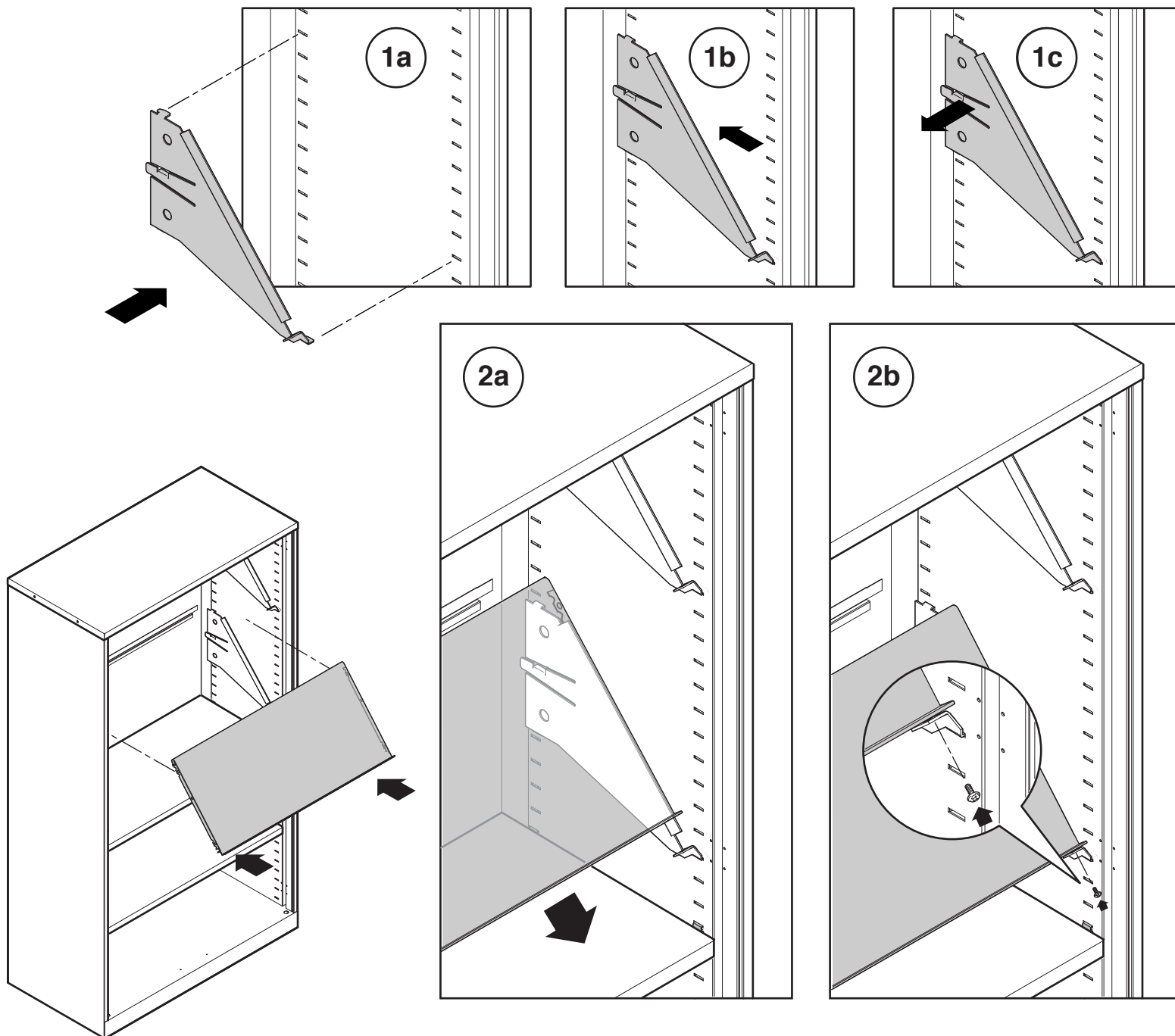

## Open Side Tower Shelf Installation

1. Select desired hole elevation.
2. Insert shelf support parts into holes.
3. Set shelf in place (non-handed).

