

# OPERATING INSTRUCTIONS

## CaféWay™ Racetrack Tables

October 2014

### TABLE TOP OPERATION

#### OPENING

To open table for in-use position, disengage storage latch to release the table from storage position (Figure 1 & Detail A). Slowly and gently lower table pushing out on stools until the safety mechanism engages (Figure 2). To release table from the safety latch position, lift up on the table while raising the lock rod toward the tabletop (Figure 3). Lower the table until the lock engages (Figure 4).

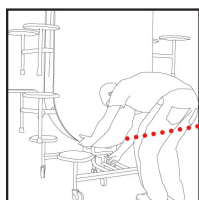

Figure 1



Detail A

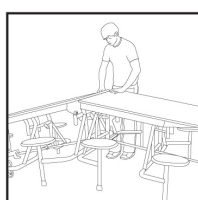

Figure 2

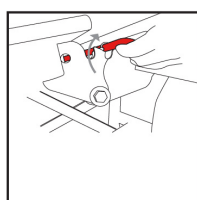

Figure 3

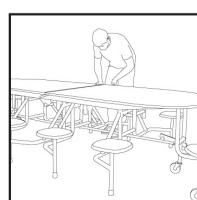

Figure 4

#### CLOSING

To close table for storage, locate the lock rod with one hand while placing the other hand on table's edge (Figure 5). Push down on the table while raising the lock rod toward the table to release safety lock position (Figure 6). Grasp edges of table and pull upward to close. Once folded flat, latch the storage lock. Table is now locked and in storage position (Figure 7 & Detail B).

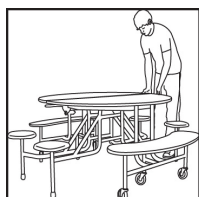

Figure 5

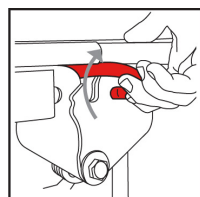

Figure 6

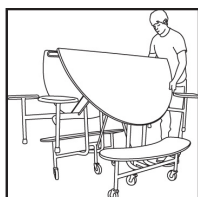
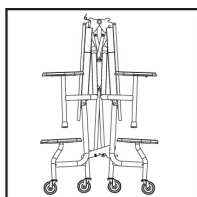

Figure 7



Detail B

#### MOVING

To properly move the table and avoid table tipping, push from the end of the folded table while facing the center lock rod (Figure 8). Do NOT push from the flat table side as this may cause tipping (Figure 9).

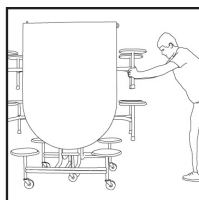

Figure 8

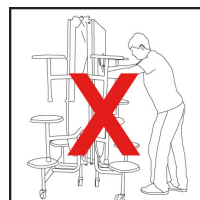

Figure 9

