



This product must be installed in accordance with applicable national and local electrical and construction codes by a person familiar with the construction and operation of the product and the hazards involved. Failure to comply with the following installation instructions may result in death or serious injury.

⚠ WARNING

SEPARATION OF FIELD INSTALLED POWER LIMITED CIRCUIT (DIMMING/CONTROL) WIRING FROM THE BRANCH CIRCUIT WIRING IN THE OUTLET BOX ARE TO BE MADE IN ACCORDANCE WITH LOCAL AND/OR NATIONAL ELECTRICAL INSTALLATION CODES.

⚠ WARNING

DISCONNECT POWER BEFORE INSTALLING OR SERVICING TO AVOID ELECTRICAL SHOCK.

⚠ WARNING

DO NOT EXCEED FIXTURE SPECIFIED VOLTAGE.

⚠ WARNING

DO NOT USE IF FIXTURE, PARTS OR CONNECTORS ARE DAMAGED.

CAUTION

FAILURE TO FOLLOW THESE INSTRUCTIONS EXACTLY AS DESCRIBED HEREIN WILL VOID THE WARRANTY.

KIT CONTENTS

- 1 - 1 FT LOI LEADER CABLE WITH SEALING CAP
- 2 - JUNCTION BOX, COVER AND HARDWARE
- 3 - STRAIN RELIEF COMPONENTS AND SEALS FOR CABLE (2x)
- 4 - INSULATING RESIN
- 5 - JUNCTION BOX CAP

NOTICE

LOI-JBOX ACCESSORY DOES NOT FIT IN 1 FT BLOCKOUT.

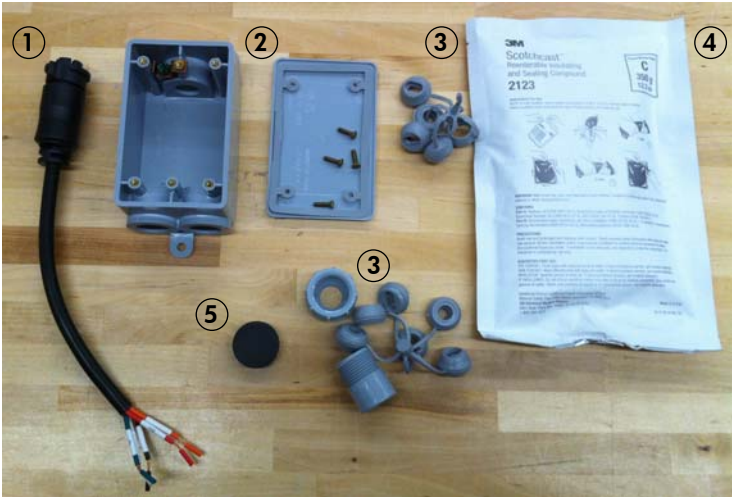

STEP 1. STRAIN RELIEF ASSEMBLY

INSTALL STRAIN RELIEF COMPONENTS ON 1 FT LOI LEADER CABLE (PROVIDED) AND POWER INPUT CABLE (BY OTHERS). SELECT THE SEALING GASKET APPROPRIATE FOR YOUR CABLE.

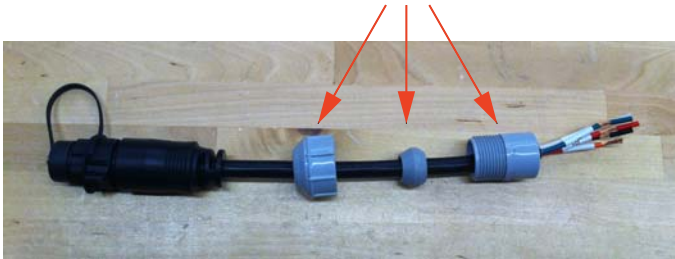

STEP 2. INSTALL POWER INPUT CABLE

TIGHTEN STRAIN RELIEF ASSEMBLY AND INSTALL POWER CABLE ON JBOX. SEAL STRAIN RELIEF CONNECTION WITH PVC GLUE (BY OTHERS).

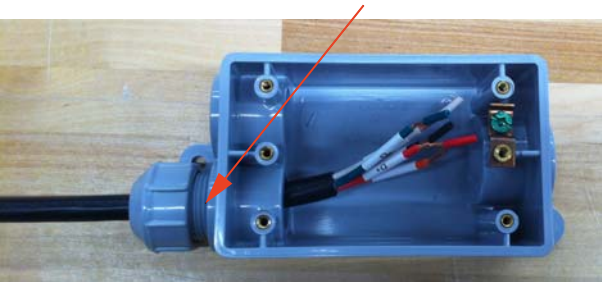

CAUTION

RUN FEEDING CABLE THROUGH CONDUIT AND COUPLERS THAT ARE APPROPRIATE FOR YOUR INSTALLATION

BE SURE TO LEAVE A MINIMUM 3" LENGTH OF CABLE AND WIRE LEADS INSIDE THE JBOX TO MAKE CONNECTIONS

STEP 3. INSTALL LEADER CABLE - OUTPUT TO PACBOX

TIGHTEN STRAIN RELIEF ASSEMBLY AND INSTALL LEADER CABLE ON JBOX. SEAL STRAIN RELIEF CONNECTION WITH PVC GLUE (BY OTHERS)

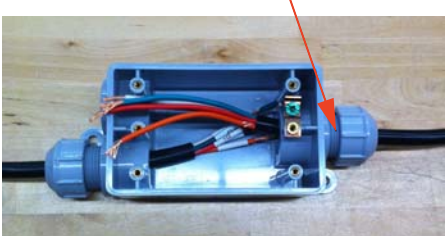

BE SURE TO LEAVE A MINIMUM 3" LENGTH OF CABLE AND WIRE LEADS INSIDE THE JBOX TO MAKE CONNECTIONS

STEP 4. POWER AND DATA CONNECTIONS

MAKE CONNECTIONS ACCORDING TO THE SPECIFIED CONTROL TYPE. WIRE MARRETES ARE PROVIDED BY OTHERS.

Non-Dimming, Lumentalk control options

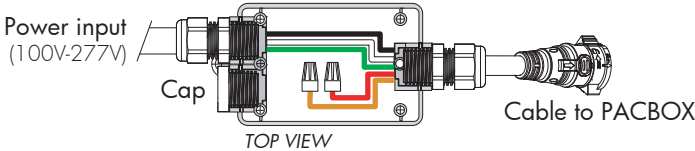

0-10V, DIM/DTW, DALI, Lutron® EcoSystem® control options

Separate power and data feeds

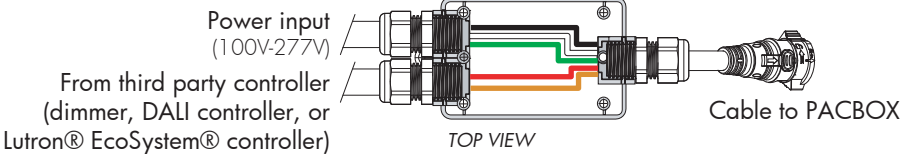

DMX/RDM, DMX/RDM1 control options

Combined power and data feeds

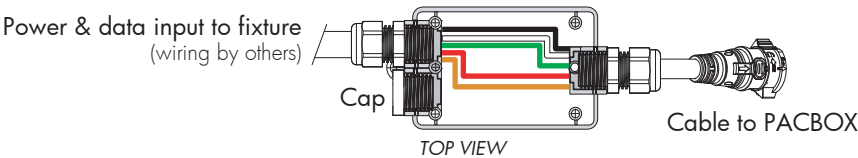

Maximum 32 DMX/RDM enabled fixtures per CBX output.

American Color Code	CE Color Code	USE
Green	Yellow/Green	Ground
Black	Brown	Live 100-277V
White	Blue	Neutral
Red	Black	Data +
Orange	Grey	Data -

STEP 5. INSTALL SEALING CAP

INSTALL JUNCTION BOX CAP ON UNUSED ENTRY POINT.

PUSH ALL THE WIRES TO THE BOTTOM OF THE JBOX TO BE SURE THAT THE BOX WILL CLOSE PROPERLY.

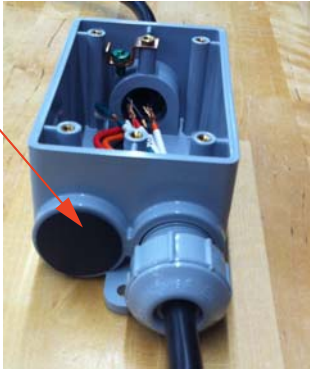

CAUTION

BE SURE TO TEST ALL CONNECTIONS BEFORE POURING THE RESIN.

STEP 6. POUR RESIN



MIX RESIN ACCORDING TO THE MANUFACTURER'S INSTRUCTIONS AND POUR RESIN INTO THE JBOX.

ALLOW RESIN TO SET COMPLETELY BEFORE COMPLETING THE FINAL STEP.

STEP 7. CLOSE JBOX



CLOSE THE JBOX USING THE GASKET AND COVER PLATE (4X SCREWS INCLUDED).

PLACE THE JBOX INSIDE THE LOI BLOCKOUT.

CONNECT LEADER CABLE TO THE PACBOX.

4X+

lumenbin™, a proprietary binning method, guarantees color temperature consistency within a 3-step MacAdam ellipse.

lumen**talk**™ lumenear™ Combine lumentranslator with Lumentalk-enabled luminaires housing Lumenpulse's proprietary lumenear control card to build your Lumentalk system.