

Project Name

Qty

Type

Catalog / Part Number

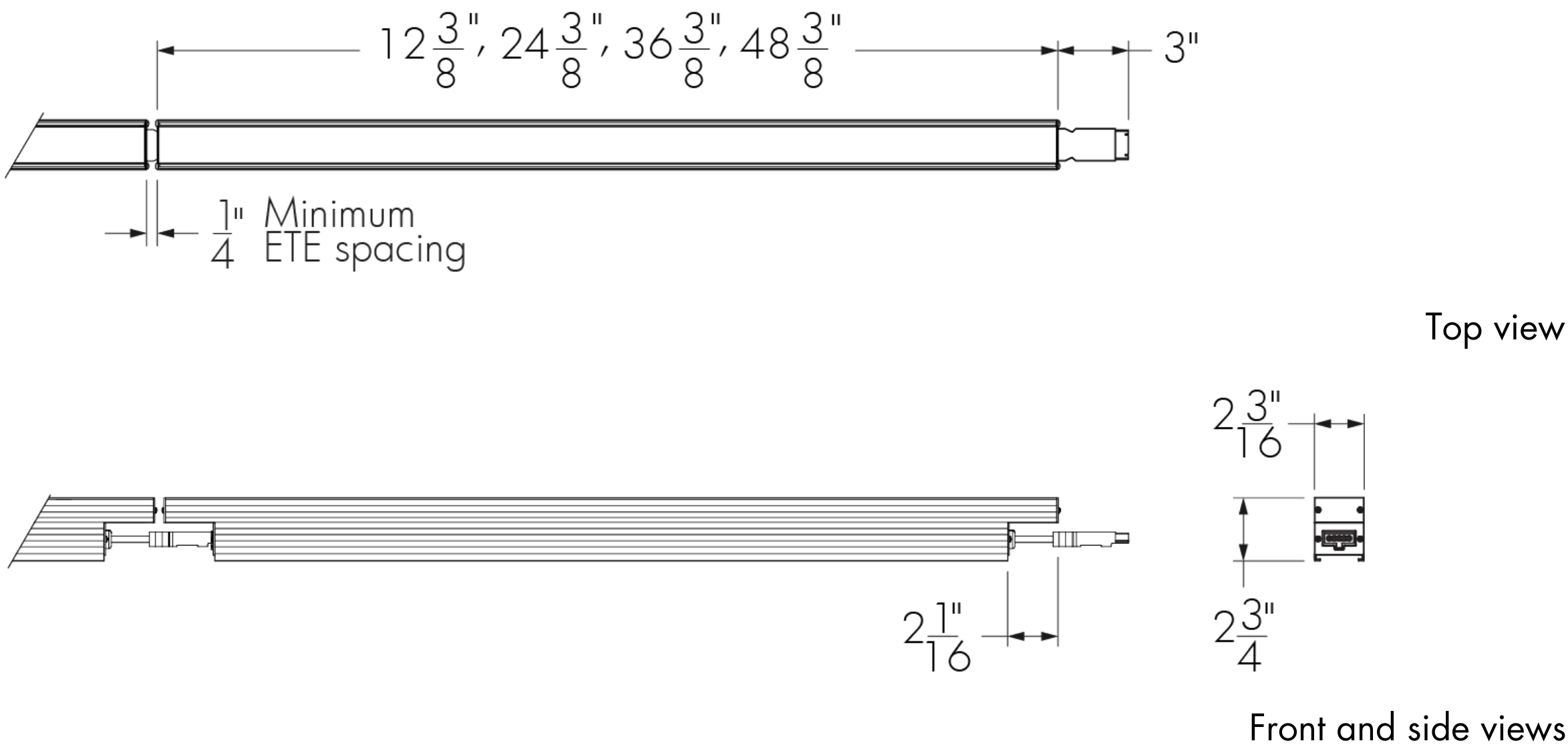

Photometric Summary

|         | Delivered output (lm) | Intensity (peak cd) |
|---------|-----------------------|---------------------|
| WW      | 3,824                 | 4,728               |
| 8°x8°   | 3,963*                | 62,855*             |
| 10°x10° | 4,329                 | 41,284              |
| 10°x30° | 3,752*                | 25,721*             |
| 10°x60° | 3,459                 | 13,078              |
| 10°x90° | 3,503*                | 7,349               |
| 30°x30° | 3,689*                | 13,982*             |
| 30°x60° | 3,425                 | 4,625               |
| 60°x60° | 3,638                 | 3,145               |
| 90°x90° | 3,518*                | 1,890*              |

Based on HO 4000K, 4ft [1219mm] configuration.  
Photometric performance is measured in compliance with IESNA LM-79-08.  
\*Estimated. Consult website for the latest photometric files.

Optics

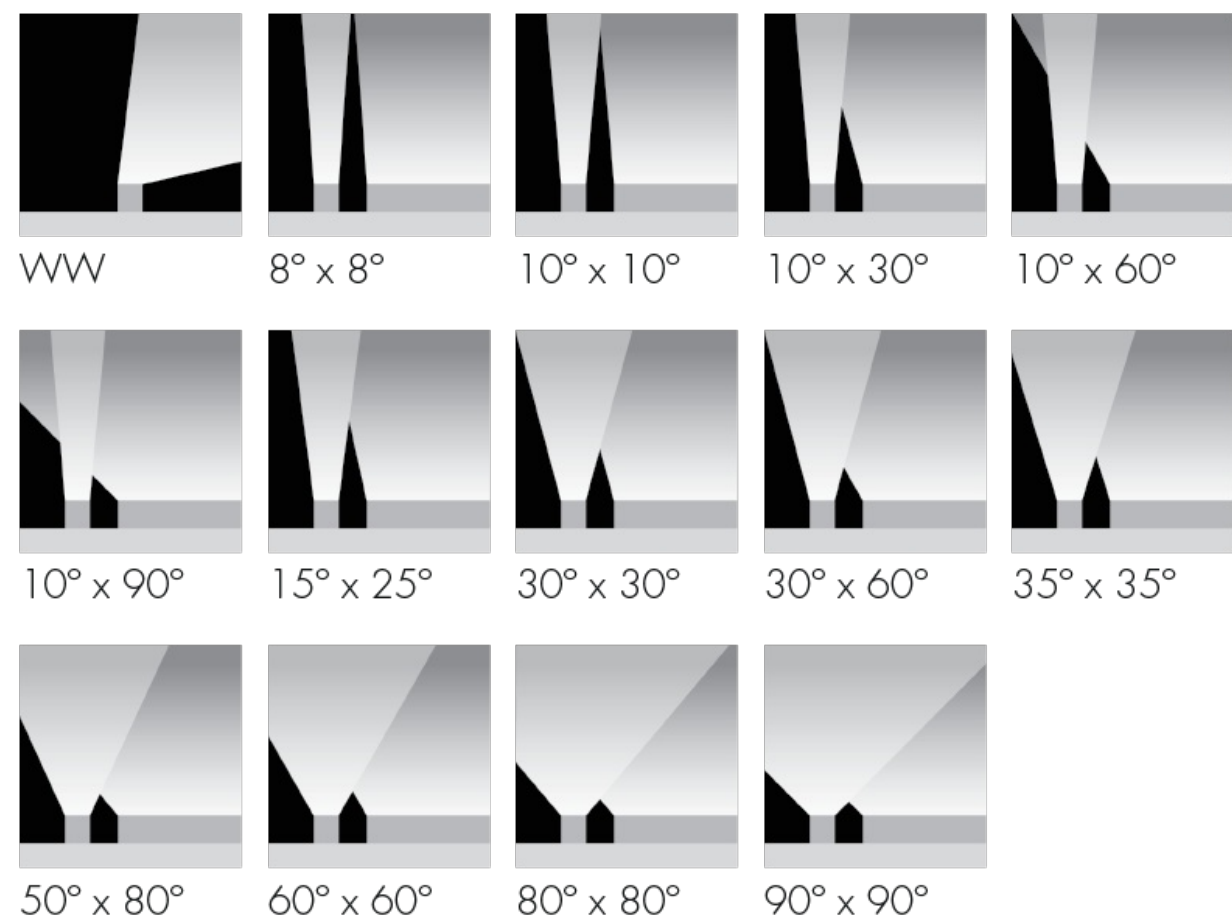

Description

The Lumenfacade Interior is a high-performance interior LED luminaire for grazing or wall washing applications. Featuring second generation LED technology, the luminaire is available in 12 in, 24 in, 36 in or 48 in sections, and can be configured with a number of options including: optics for grazing or flood lighting; a choice of outputs (RO 8.5 W/ft or HO 15.25 W/ft); various color temperatures or static colors; various mounting options, finishes, accessories and controls. The Lumenfacade is also available with a unique asymmetric wallwash distribution, providing exceptional uniformity and brightness for walls and signage.

Features

|                             |   |
|-----------------------------|---|
| Color and Color Temperature | 2200K, 2700K, 3000K, 3500K, 4000K, Red, Green, Blue   |
| Length (nominal)            | 12 in, 24 in, 36 in, 48 in  |
| Optics                      | Asymmetric Wallwash, 8° x 8°, 10° x 10°, 10° x 30°, 10° x 60°, 10° x 90°, 15° x 25°, 30° x 30°, 30° x 60°, 35° x 35°, 50° x 80°, 60° x 60°, 80° x 80°, 90° x 90°  |
| Power Consumption           | 5 W/ft (meets ASHRAE standards for linear lighting on building facades - not available for 12 in fixture lengths), 8.5 W/ft (RO version), 15.25 W/ft (HO version), Typically 20% higher for 12 in fixture lengths |
| Warranty                    | 5-year limited warranty   |
| Performance                 |   |
| Illuminance at Distance     | Minimum 1 fc at 114 ft (HO 4000K, 48 in fixture, 10° x 60°, DMX/RDM)  |
| Color Consistency           | 2 SDCM, 3 SDCM (2200K)  |
| Color Rendering             | Minimum CRI 80  |
| Lumen Maintenance           | L70 280,000 hrs, L95 35,000 hrs   |

Colors and Color Temperatures

2200K

2700K

3000K

3500K

4000K

Red

Green

Blue

Controls

ON/OFF

0-10V

DALI

lumen talk™

DMXrdm

EcoSystem.  
Enabled

Certifications

UL

us

CE

✓

RoHS

5

YEARS

lumenpulse

Physical

|                   |  |
|-------------------|--|
| Housing Material  | Low copper content extruded aluminum                           |
| Lens Material     | Clear acrylic  |
| Hardware Material | Stainless steel  |
| End Cap Material  | Aluminum   |
| Surface Finish    | Electrostatically applied polyester powder coat                |
| Weight            | 12 in: 2.1 lbs, 24 in: 3.7 lbs, 36 in: 5.3 lbs, 48 in: 6.8 lbs |

Electrical and control

|                                      |  |
|--------------------------------------|--|
| Voltage                              | 100 to 277 volts   |
| Fixture Cable                        | Power and data in one cable, End-to-end configuration standard (factory installed input cable - no jumper cable needed for minimum spacing between two fixtures) |
| Fixture Cable and Connector Color    | Black for Black Sandtex, Bronze Sandtex and Silver Sandtex finishes, White for Smooth white finish   |
| Leader Cable Conductors              | 3C #16-3 (NO, LT control), 5C #16-5 (DIM, DALI, ES, DMX/RDM control)   |
| Maximum Cable and Fixture Run Length | 252 ft (On/Off, 277V, RO version), 164 ft (On/Off, 277V, HO version)   |
| Control                              | On/Off control, Lumentalk, 0-10V dimming, DALI dimming, Lutron® EcoSystem® Enabled dimming, DMX/RDM enabled  |
| Resolution (DMX/RDM)                 | Per foot or per fixture (configured with LumenID V3 software), 8-bit or 16-bit   |

Environmental

|                       |  |
|-----------------------|--|
| Environment           | Indoor applications only   |
| Storage Temperature   | -40 °F to 185 °F (device must reach start-up temperature value before operating) |
| Start-up Temperature  | -13 °F to 122 °F   |
| Operating Temperature | -40 °F to 122 °F   |

Accessories (order separately)

|                                 |  |
|---------------------------------|--|
| Optical Accessories             | Lumenfacade Interior Radial Louver   |
| Cables                          | Lumenfacade Interior Leader Cable, Lumenfacade Interior Jumper Cable   |
| Control Boxes                   | DMX/RDM enabled (daisy chain or star configuration), Ethernet enabled (daisy chain or star configuration), Lumentalk Data Bridge |
| Control Systems                 | Lumentone™ 2, Pharos® kit  |
| Diagnostic and Addressing Tools | LumenID, LumentalkID   |



Asymmetric wallwash optic details

WWLF - Asymmetric wallwash optic, left feed

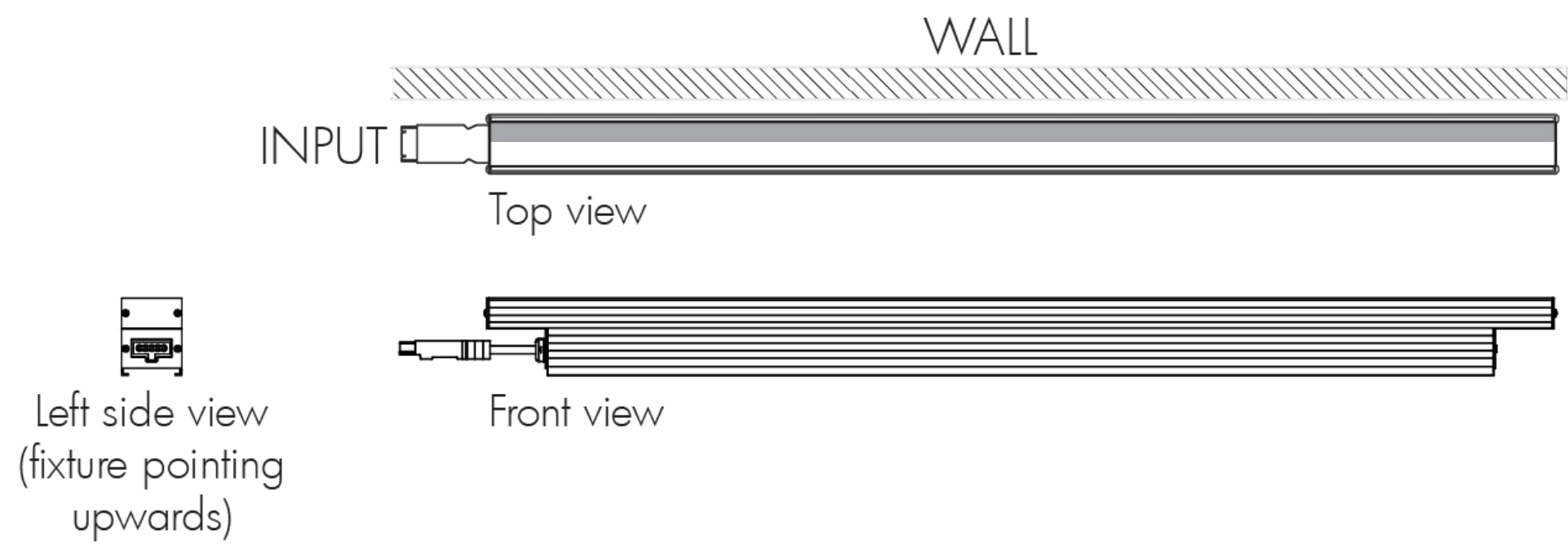

WWRF - Asymmetric wallwash optic, right feed

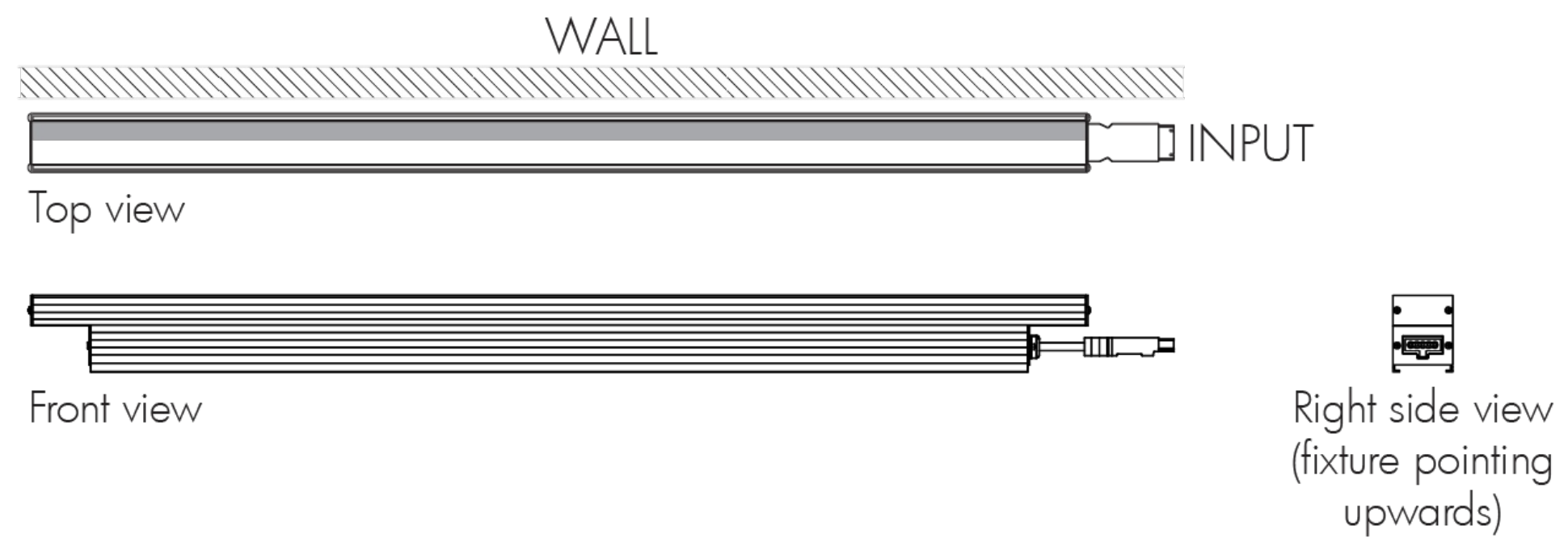

- Always position frosted side toward the wall.
- Fixture's feeding side is based on uplight installations. Feeding sides are reversed when fixture is used in a downlight application.
- Recommended setback from wall is 1/10 of the wall height. Example: 2 ft setback for a 20 ft wall.

Mounting options

Surface Mount

SAM - Slim Adjustable Mounting

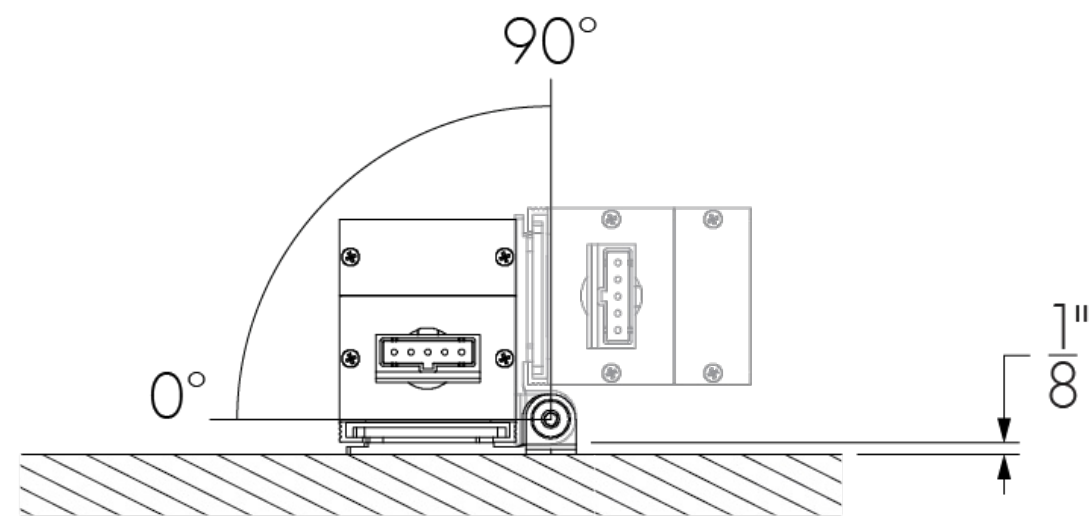

SAM - Mounting hole pattern

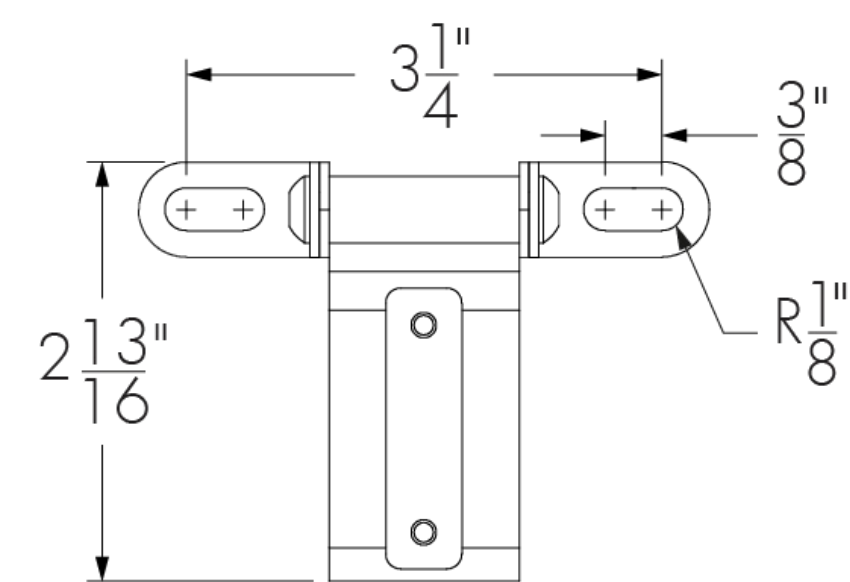

UMP - Fixed Mounting

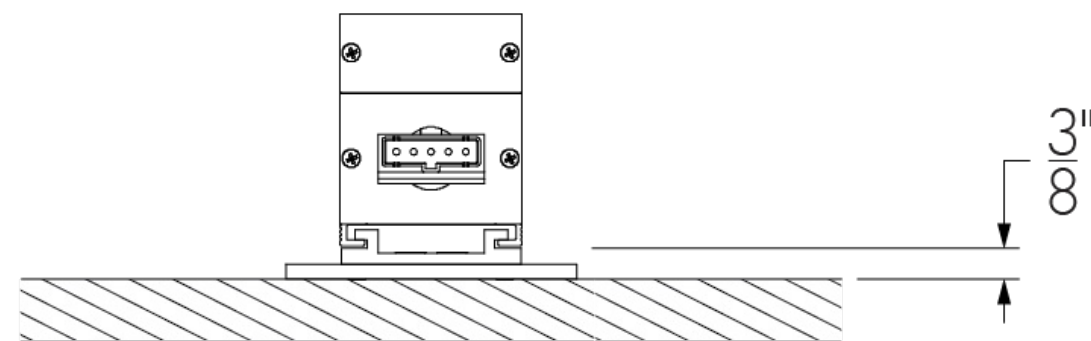

UMP - Mounting hole pattern

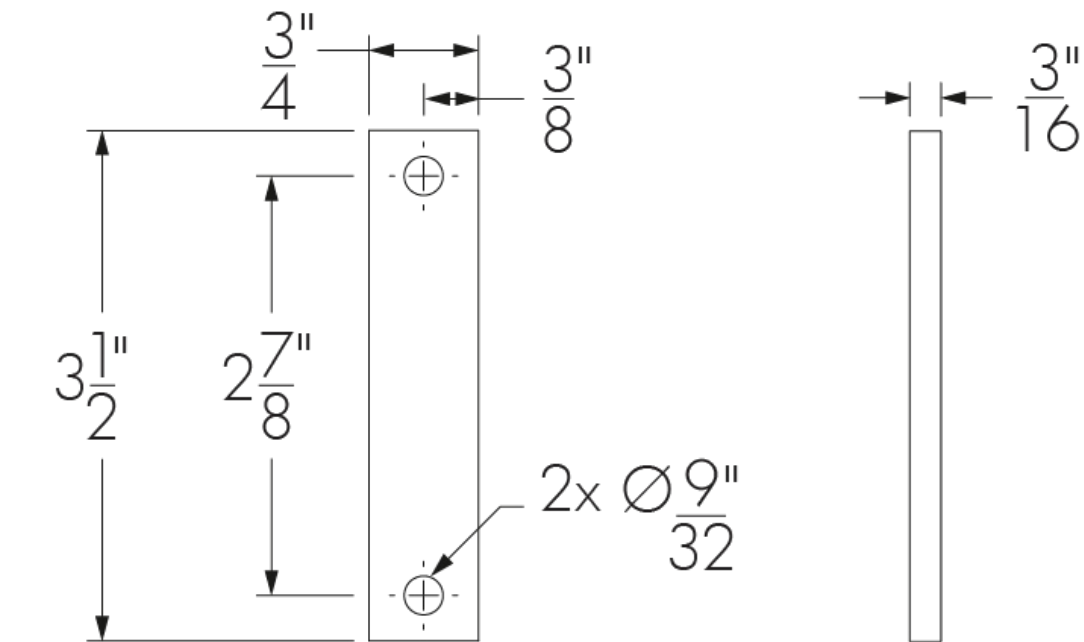

Wall Mount

UMAS - Universal Adjustable Mounting

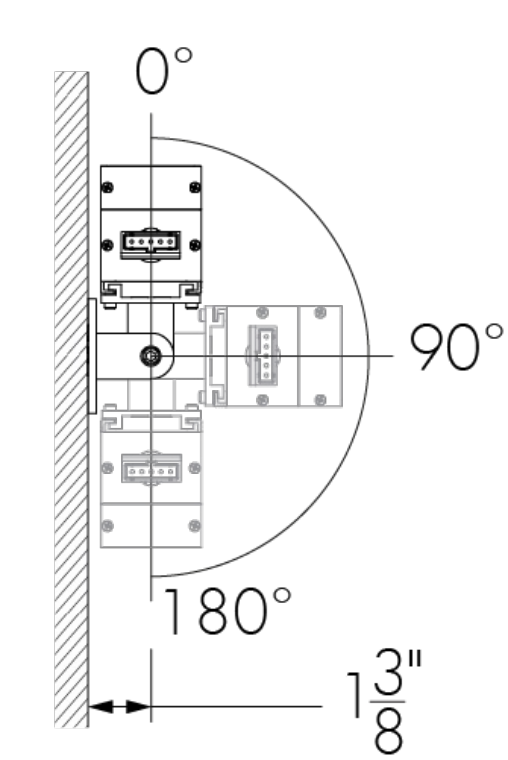

UMAS - Mounting hole pattern

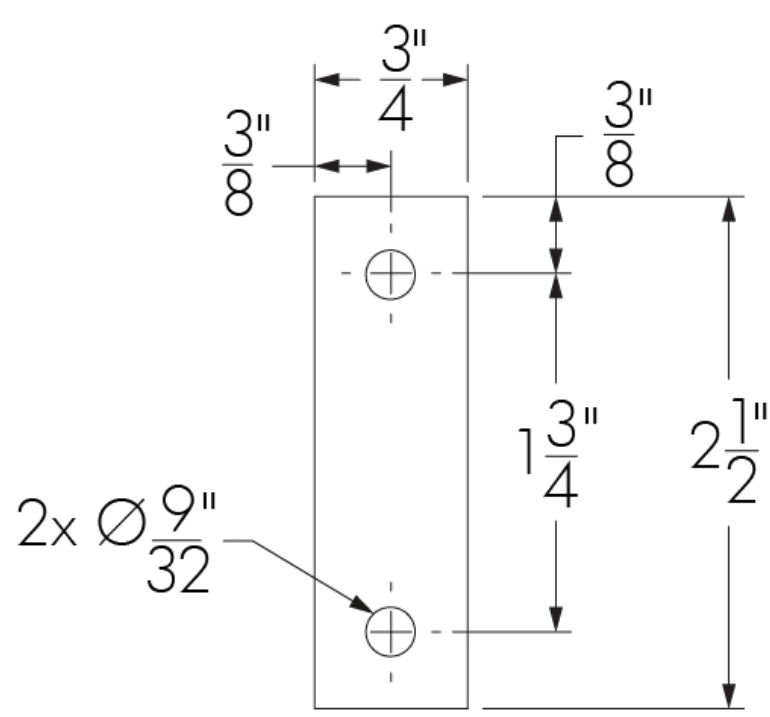

WAM2 - Adjustable Wall Mounting 2 in

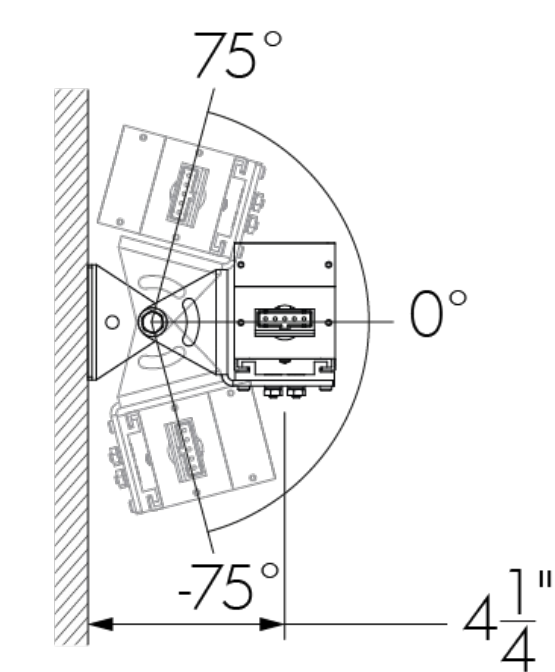

WAM2 - Mounting hole pattern

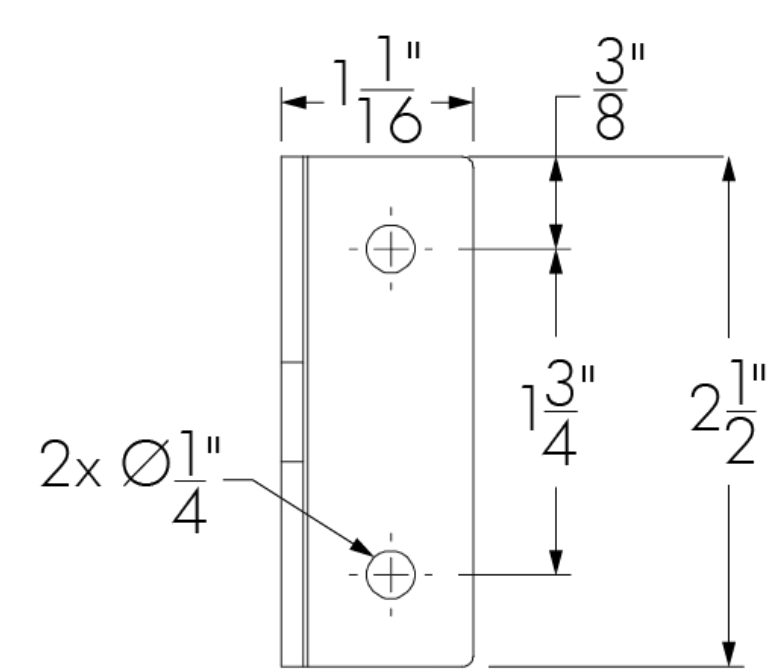

WAM6 - Adjustable Extended Arm Mounting 6 in

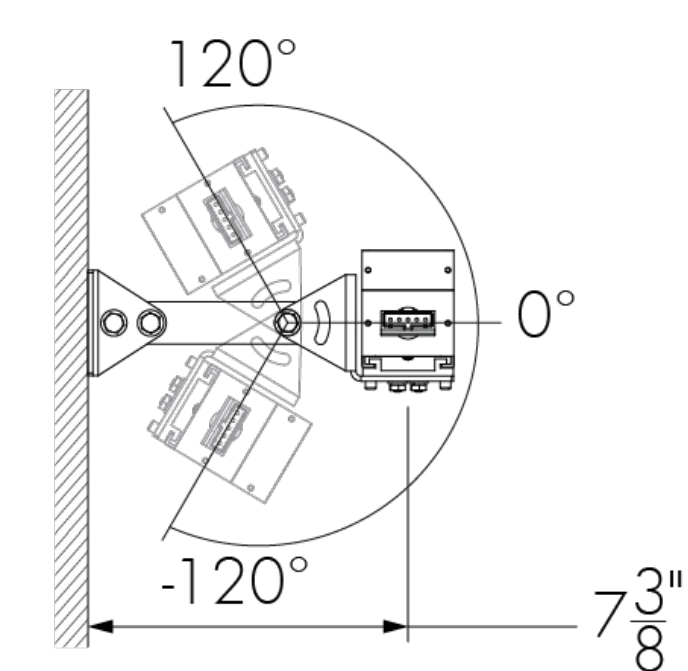

WAM6 - Mounting hole pattern

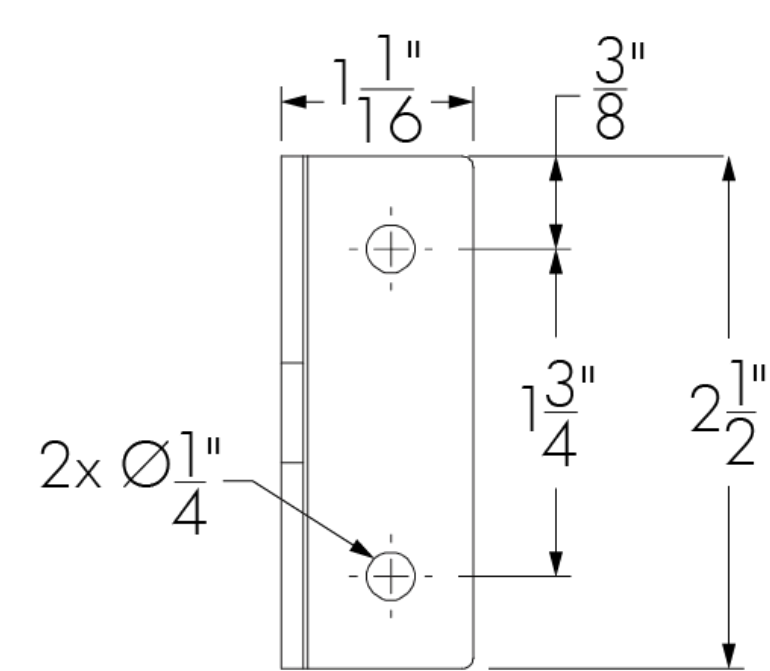

WAM12 - Adjustable Extended Arm Mounting 12 in

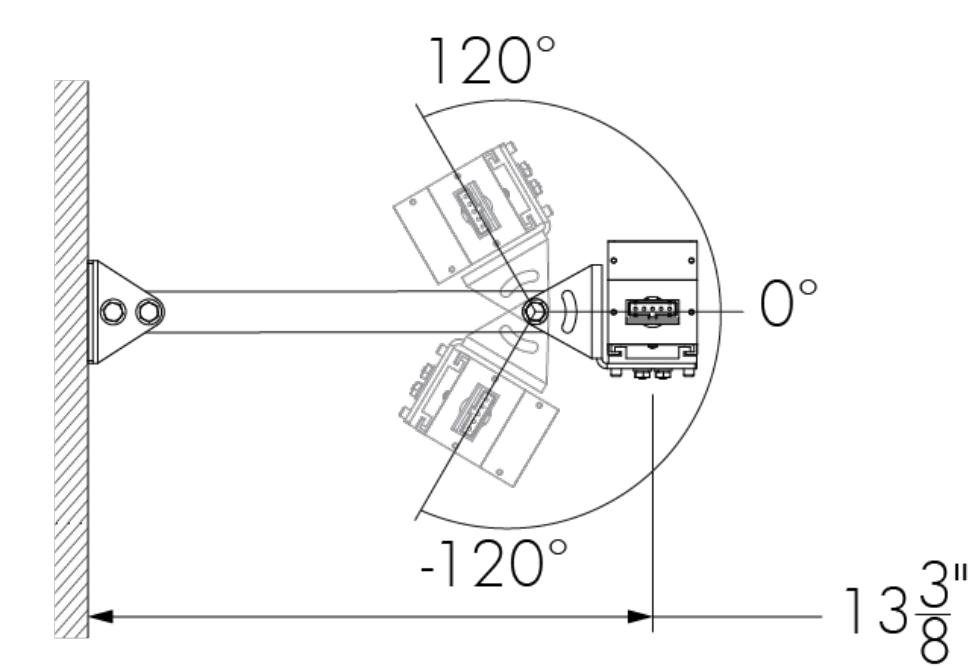

WAM12 - Mounting hole pattern

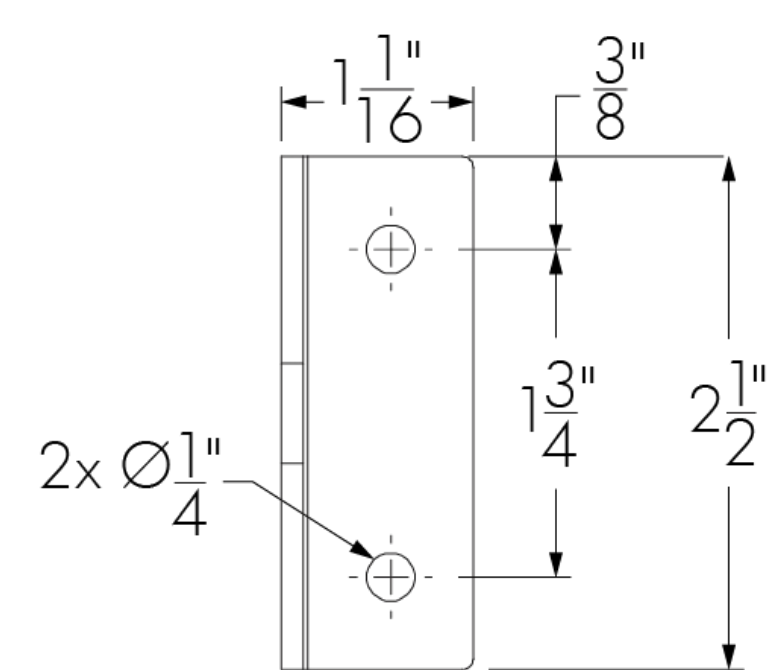

WAM18 - Adjustable Extended Arm Mounting 18 in

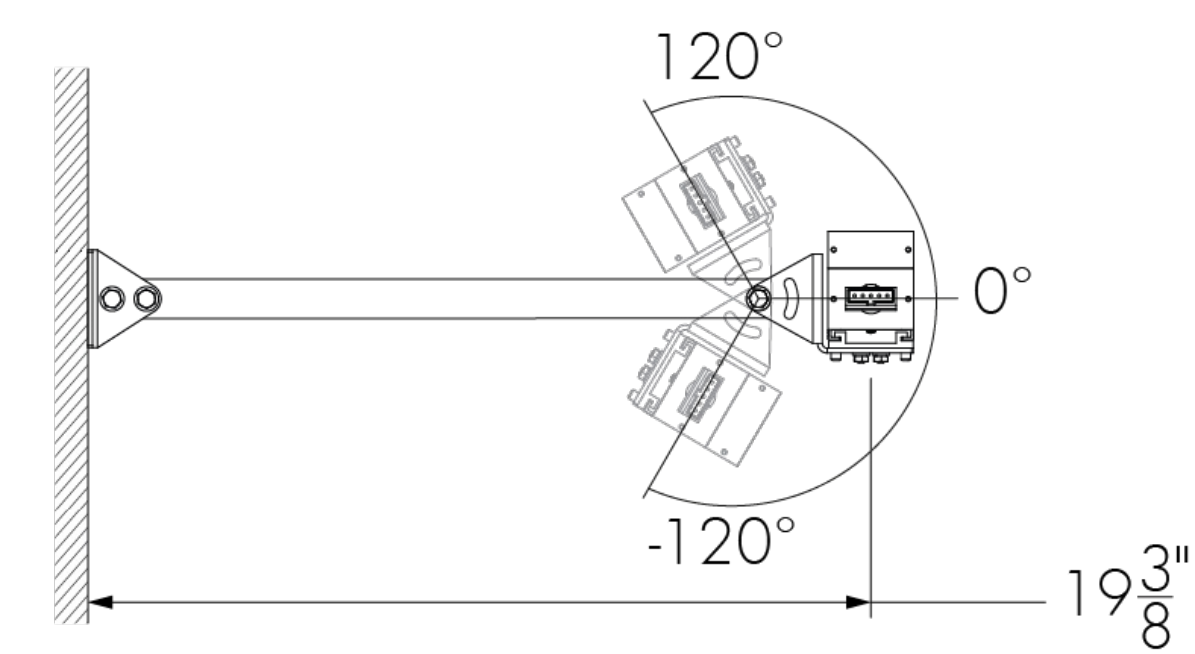

WAM18 - Mounting hole pattern

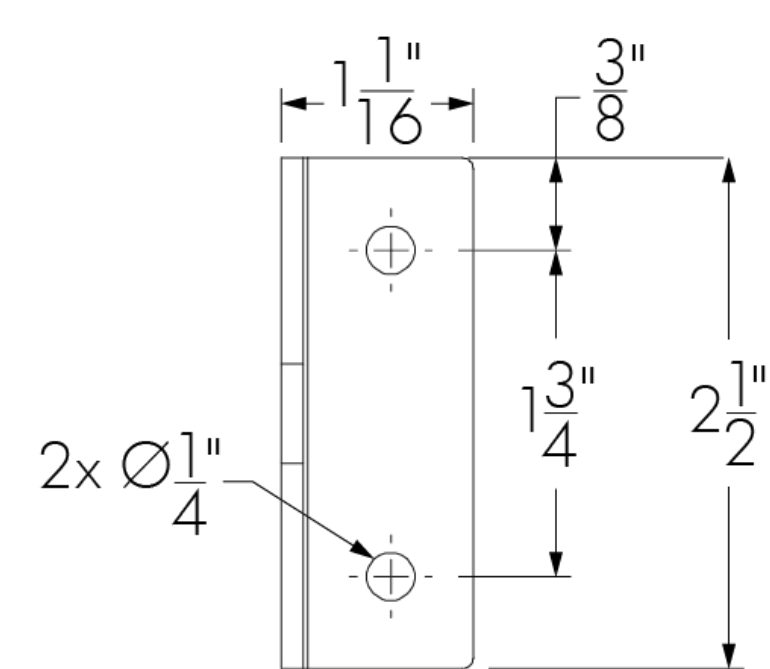

Optical accessories (order separately)

LOGiRD - Radial louver for Lumenfacade Interior

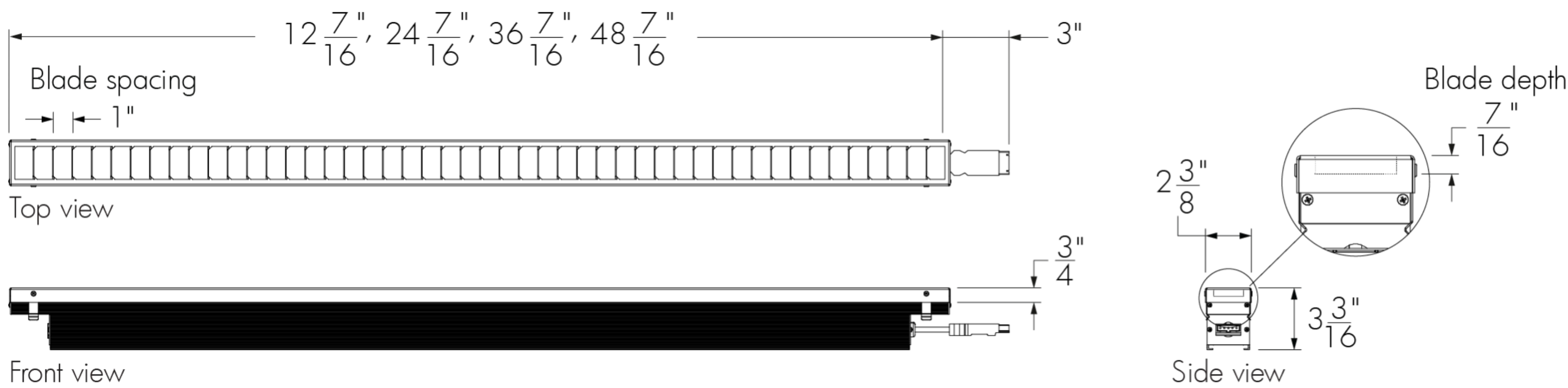

LOGiRD-LENGTH-FINISH

Please specify:  
**LENGTH:** 12 in, 24 in, 36 in or 48 in; **FINISH:** BK - Black Sandtex®, BRZ - Bronze Sandtex®, SI - Silver Sandtex®, WH - Smooth white or CC - custom color and finish (please specify RAL color)

- The addition of a louver will affect beam distribution. Consult factory for application support.
- Not suitable for asymmetric wallwash optic.

Cables (order separately)

LOGiLC - Leader cable for Lumenfacade Interior

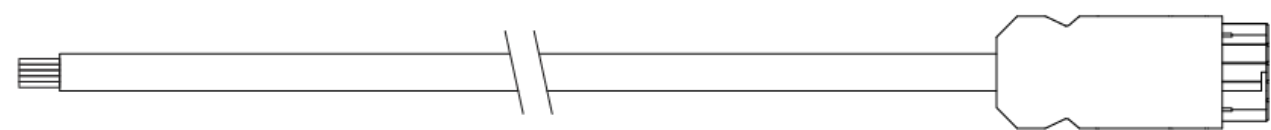

LOGiLC-CERTIFICATION-CONTROL-LENGTH-CABLE COLOR

Please specify:  
**CERTIFICATION:** UL or CE; **CONTROL:** NO - non-dimming or DATA - dimming/data; **LENGTH:** 10 ft, 25 ft, 50 ft, 100 ft, 150 ft or 200 ft; **CABLE COLOR:** black or white (connectors are the same color as the specified cable color)

- Consult Lumenfacade Interior leader cable specification sheet for details.

LOGiJC - Jumper cable for Lumenfacade Interior

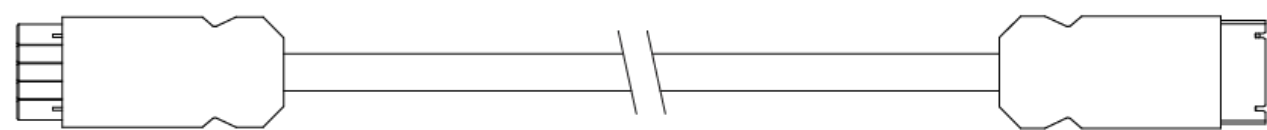

LOGiJC-CERTIFICATION-CONTROL-LENGTH-CABLE COLOR

Please specify:  
**CERTIFICATION:** UL or CE; **CONTROL:** NO - non-dimming or DATA - dimming/data; **LENGTH:** 1 ft to 30 ft (available in 1 ft increments) or 50 ft; **CABLE COLOR:** black or white (connectors are the same color as the specified cable color)

- Consult Lumenfacade Interior jumper cable specification sheet for details.



Control boxes (order separately)

CBX-DMX/RDM - DMX/RDM enabled (daisy chain or star configuration)

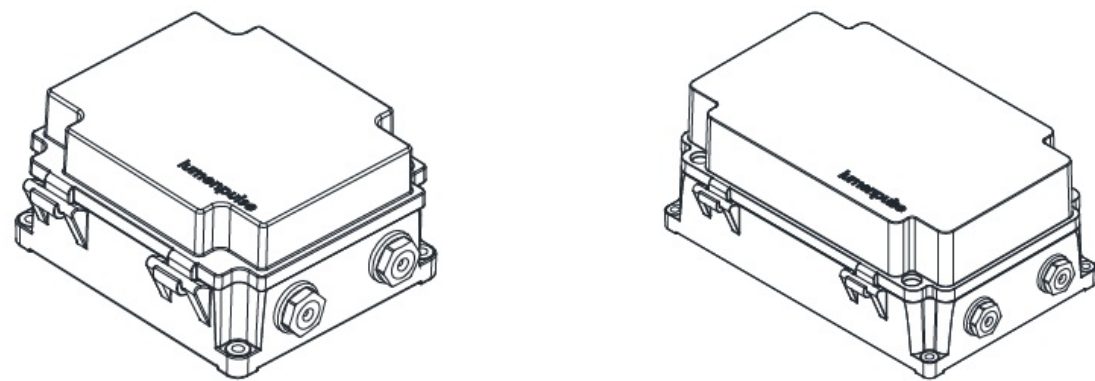

DMX/RDM control box. Up to six power and data outputs to fixtures or fixture runs. Consult CBX specification sheet and installation instructions for details. Lumenterminators provided with CBX (2x for daisy chain configuration, 6x for star configuration), consult factory to order spares.

CBX-ENET - Ethernet enabled (daisy chain or star configuration)

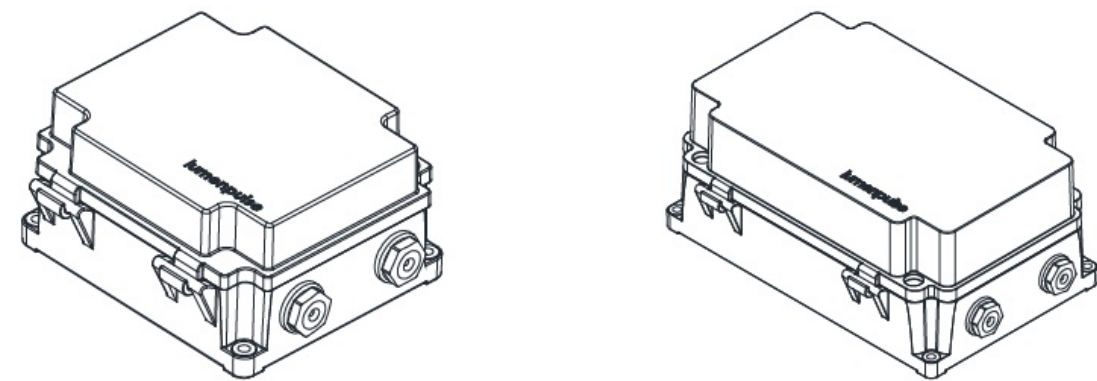

Ethernet control box. Up to four power and data outputs to fixture or fixture runs. Consult Ethernet CBX specification sheet and installation instructions for details.

LDB - Lumentalk Data Bridge

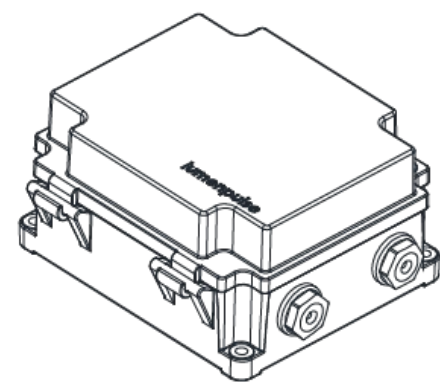

Lumentalk Data Bridge, 0-10V or DMX output. Consult LDB specification sheet for details.

Control systems (order separately)

LTN2 - Lumentone™ 2



Lumentone 2 is a simple pre-programmed DMX 512 controller with a push button rotary dial and live feedback.

PHAROS - Pharos® kit

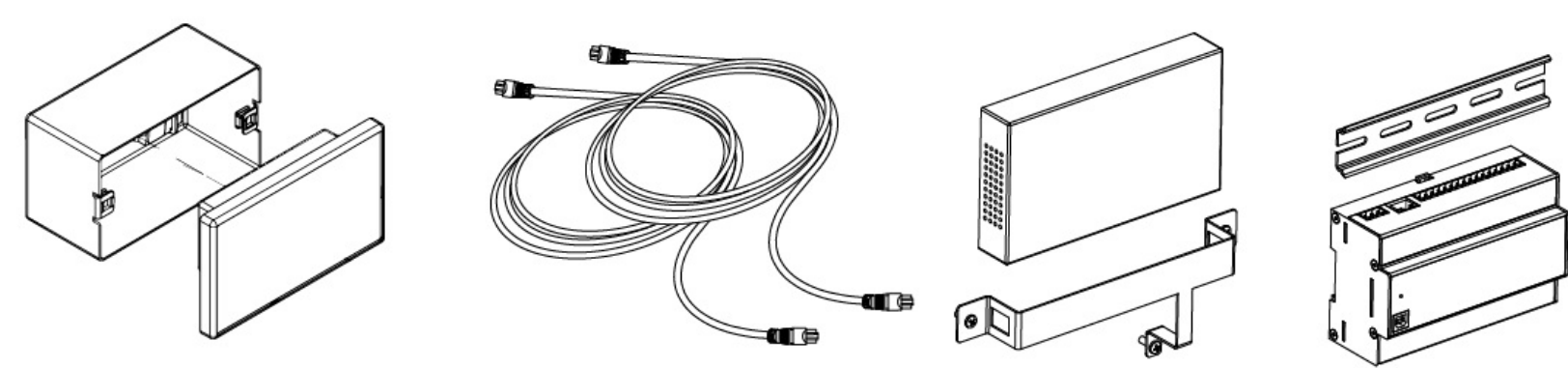

The Pharos kit, available for 1 or 2 DMX universes, allows for complete control of large lighting installations. 2 DMX universes kit shown.

Diagnostic and addressing tools (order separately)

LID - LumenID

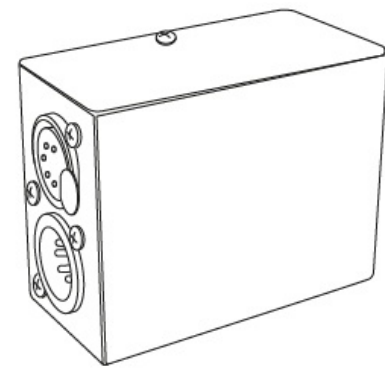

LumenID is a diagnostic and addressing DMX/RDM tool. It must be specified on all DMX applications. Consult LID specification sheet for details.

LID-LT - LumentalkID

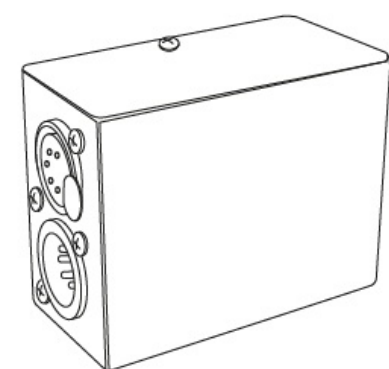

LumentalkID is a diagnostic and addressing tool. It must be specified for all Lumentalk (LT) applications. Consult LID-LT specification sheet for details.

Resolution details

Resolution per foot: each 12 in section is addressed independently

DMX addresses:



Resolution per fixture: each fixture is addressed independently

DMX addresses:



- 48 in fixtures shown.
- Applicable for DMX/RDM control option only. Fixture resolution can be configured on-site within the LumenID V3 software. A DMX/RDM enabled CBX is required.

Typical wiring diagrams

Wiring color code

| UL Color Code | USE            |
|---------------|----------------|
| Green         | Ground         |
| Black         | Line           |
| White         | Line/Neutral   |
| Red or Purple | 0-10V / Data + |
| Orange        | 0-10V / Data - |

On/Off control (NO)

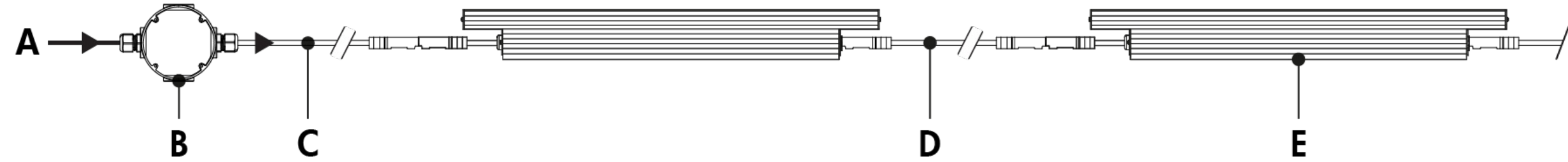

- A** - Power input (100-277V, wiring by others)
- B** - Junction box (by others)
- C** - Leader cable (LOGiLC)
- D** - Jumper cable (LOGiJC) (optional)
- E** - Lumenfacade Interior

On/Off control (NO) - wiring detail

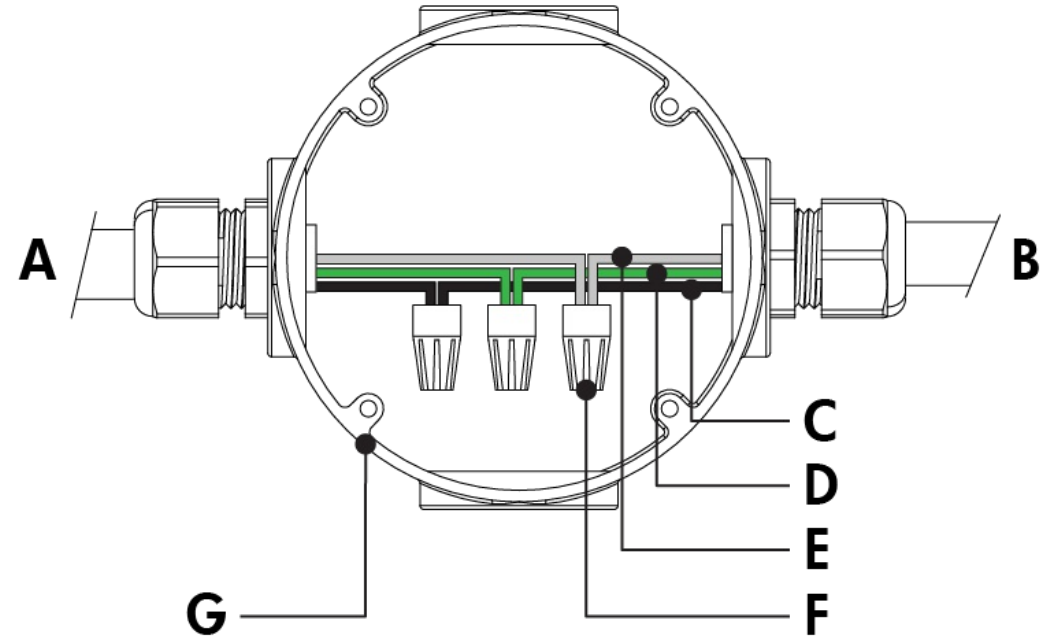

- A** - Power input
- B** - To fixture
- C** - Line
- D** - Ground
- E** - Line/Neutral
- F** - Wire-nuts (by others)
- G** - Junction box (by others)

- Consult factory for specific applications and maximum fixture count/cable length recommendations.
- ASHRAE version (not available for 12 in fixture lengths): 5 W/ft; Regular Output version: 8.5 W/ft; High Output version: 15.25 W/ft.



Lumentalk (LT)

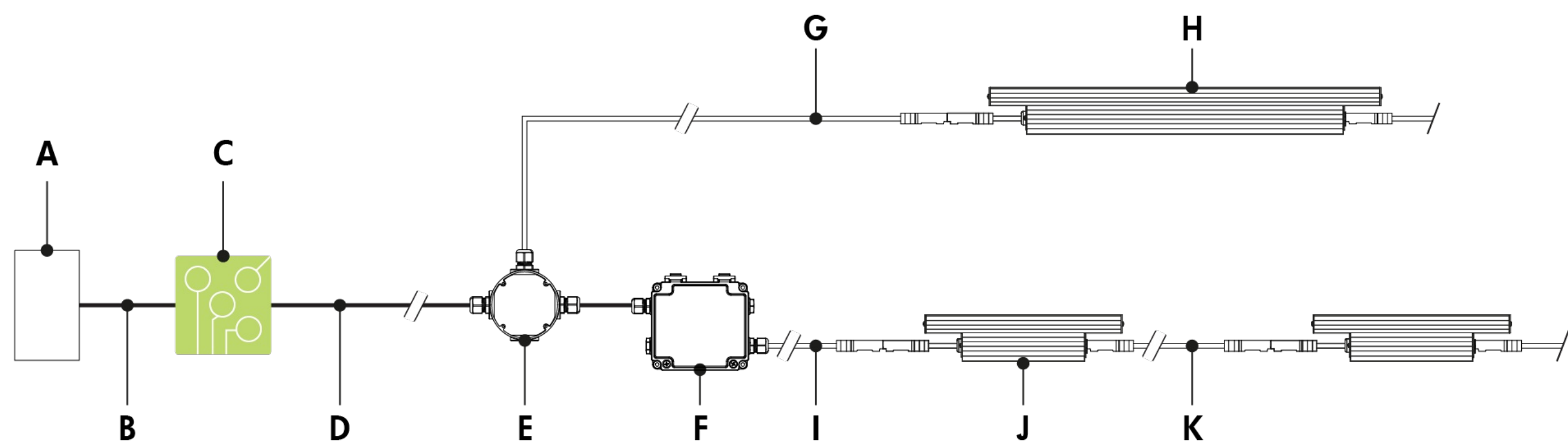

- A** - Dimmer/controller (order separately from Lumenpulse, or by others)
- B** - Data wiring (by others)
- C** - Lumentranslator (LTL-010, -DMX, -TRIAC, -DALI)
- D** - Power line (120-277V AC, wiring by others)
- E** - Junction box (by others)
- F** - Lumentalk Data Bridge (LDB-DIM or LDB-DMX)
- G** - Leader cable (LOGiLC)
- H** - Lumenfacade Interior (24 in, 36 in or 48 in fixture lengths)
- I** - Leader cable (LOGiLC-DATA)
- J** - Lumenfacade Interior 12 in
- K** - Jumper cable (LOGiJC-DATA) (optional)

Lumentalk (LT) - wiring detail

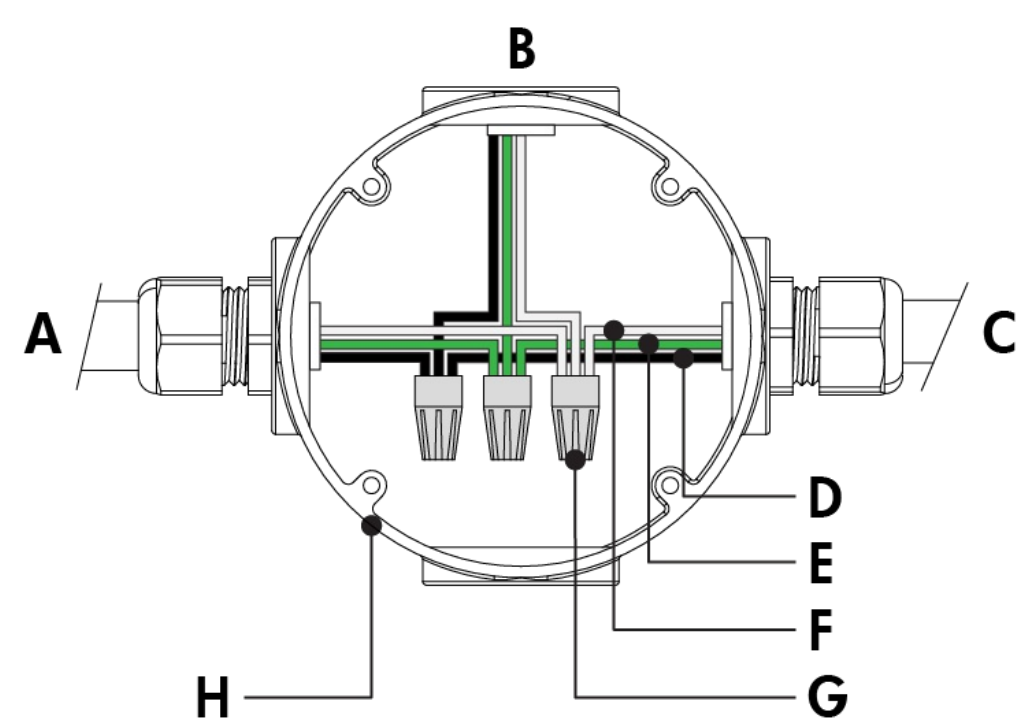

- A** - Power input (control over power line via Lumentalk system) or from previous fixture
- B** - To fixture
- C** - To Lumentalk Data Bridge (for run lengths with 12 in fixtures)
- D** - Line
- E** - Ground
- F** - Line/Neutral
- G** - Wire-nuts (by others)
- H** - Junction box (by others)

- Consult factory for specific applications and maximum fixture count/cable length recommendations.
- Lumentalk Data Bridge required for 12 in fixture lengths, see LDB installation instructions for details.
- For applications with all fixtures controlled as 1 zone: fixtures and Lumentalk Data Bridge must be specified as DIM. Maximum of 10 fixtures per LDB-DIM, consult factory for applications that require additional capabilities.
- For applications with fixtures controlled individually: fixtures and Lumentalk Data Bridge must be specified as DMX, 2-step commissioning process: 1 - DMX/RDM system using LumenID software and a LID, 2 - Lumentalk system using LumentalkID software and a LID-LT. Maximum of 32 fixtures per LDB-DMX. Consult factory for details.
- For DMX applications: 1 DMX controller per Lumentalk network, maximum of 48 DMX channels per Lumentalk network (minimum step transition update rate is 1 second, minimum fade time between two colors is 1 minute). Consult factory for applications that require additional capabilities.
- Maximum of 1 transmitter (Lumentranslator or Lumenlink) per system.
- No third party fixtures allowed on the same circuit.
- Consult factory for DALI Lumentalk applications.
- 1% minimum dimming value.
- ASHRAE version (not available for 12 in fixture lengths): 5 W/ft; Regular Output version: 8.5 W/ft; High Output version: 15.25 W/ft.



0-10V dimming (DIM)

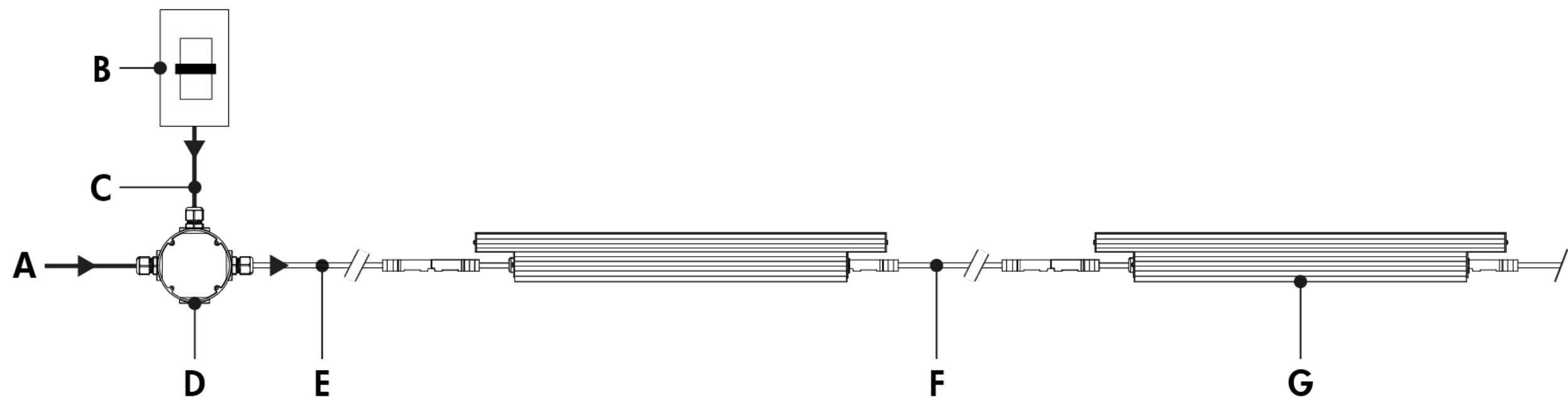

- A** - Power input (100-277V, wiring by others)
- B** - Dimmer (by others)
- C** - Data wiring (by others)
- D** - Junction box (by others)
- E** - Leader cable (LOGiLC)
- F** - Jumper cable (LOGiJC) (optional)
- G** - Lumenfacade Interior

0-10V dimming (DIM) - wiring detail

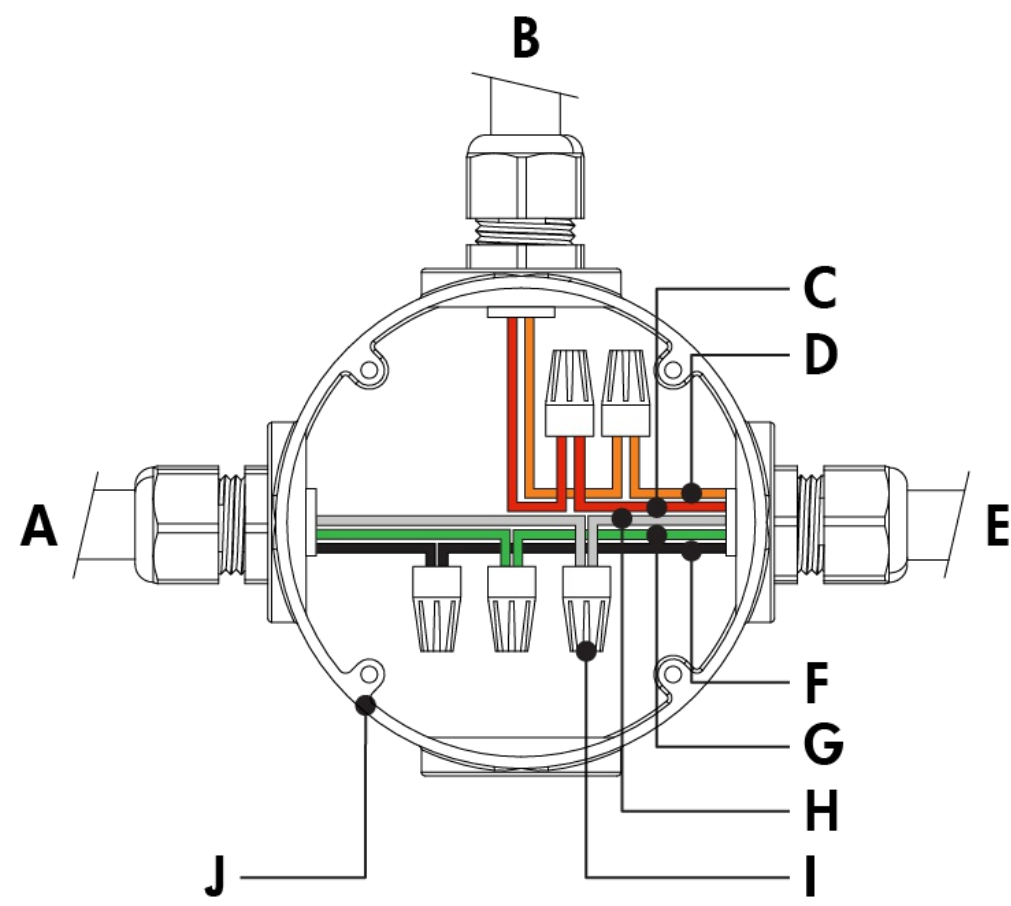

- A** - Power input
- B** - From dimmer (by others)
- C** - 0-10 V +
- D** - 0-10 V -
- E** - To fixture
- F** - Line
- G** - Ground
- H** - Neutral
- I** - Wire-nuts (by others)
- J** - Junction box (by others)

- Consult factory for specific applications and maximum fixture count/cable length recommendations.
- 0-10V mA ratings: passive dimmer (Current Sink): 3 mA per fixture, active dimmer (Current Source): 0.5 mA per fixture.
- 10% minimum dimming value.
- ASHRAE version (not available for 12 in fixture lengths): 5 W/ft; Regular Output version: 8.5 W/ft; High Output version: 15.25 W/ft.

DALI dimming (DALI)

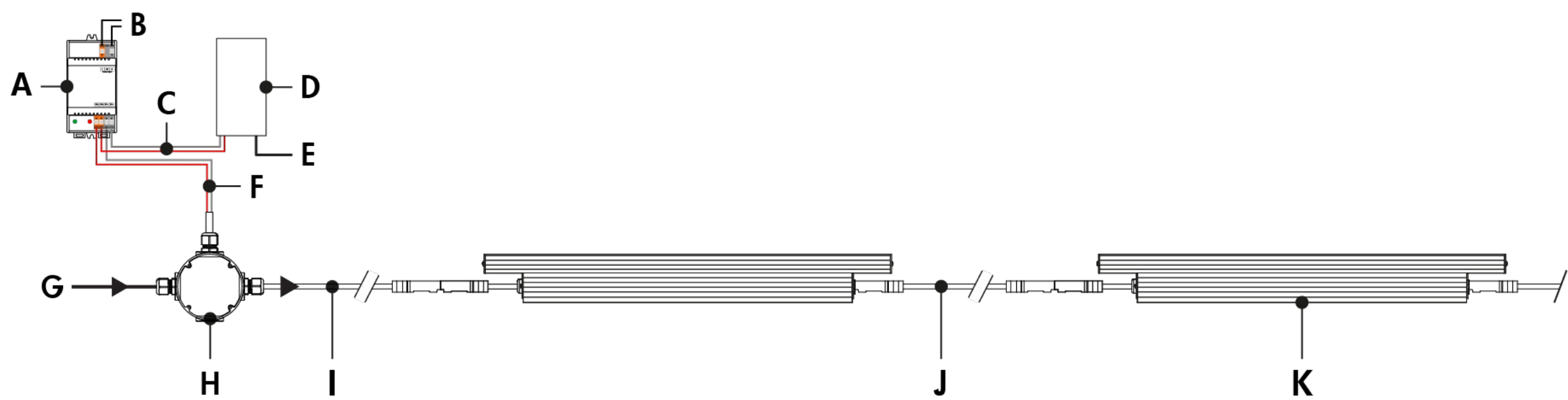

- A** - DALI bus power supply (by others)
- B** - Power input for DALI bus power supply (wiring by others)
- C** - Data output to DALI controller (wiring by others)
- D** - DALI controller (by others)
- E** - Power input for DALI controller (wiring by others)
- F** - Data output to fixture (wiring by others)
- G** - Power input (100-277V, wiring by others)
- H** - Junction box (by others)
- I** - Leader cable (LOGiLC)
- J** - Jumper cable (LOGiJC) (optional)
- K** - Lumenfacade Interior

DALI dimming (DALI) - wiring detail

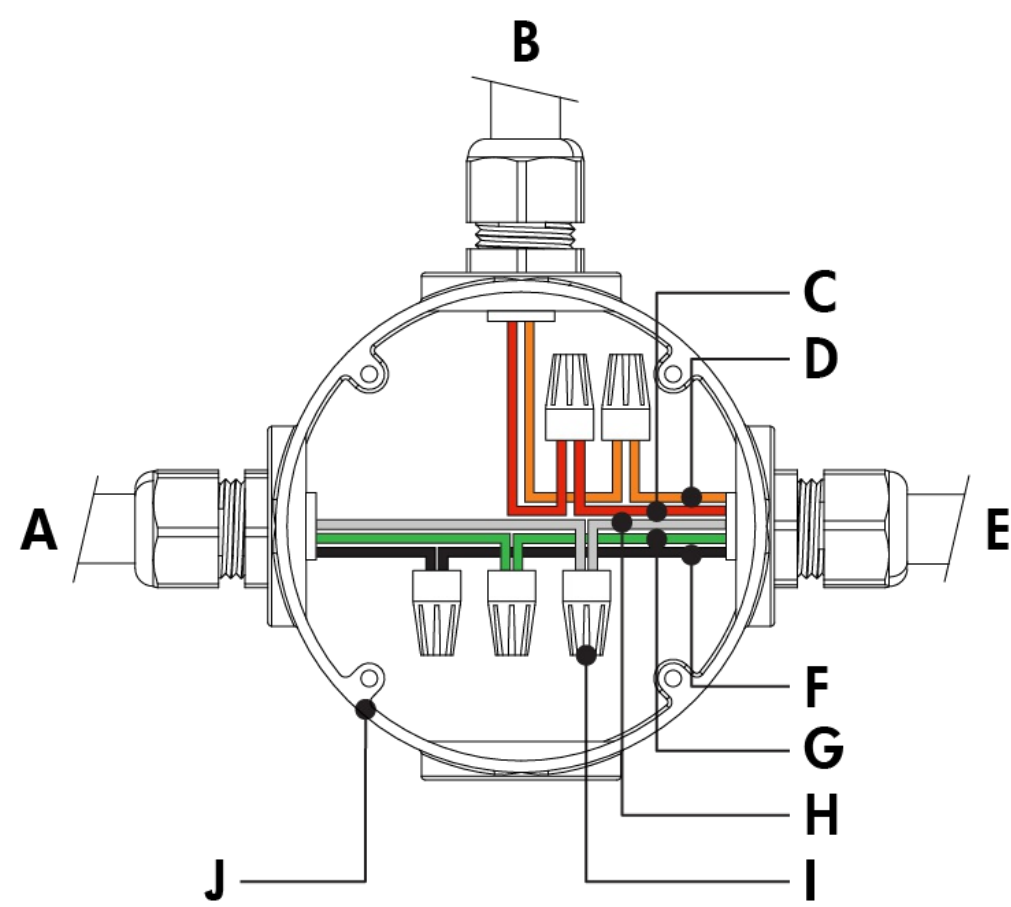

- A** - Power input
- B** - From DALI controller (by others)
- C** - Data +
- D** - Data -
- E** - To fixture
- F** - Line
- G** - Ground
- H** - Neutral
- I** - Wire-nuts (by others)
- J** - Junction box (by others)

- Consult factory for specific applications and maximum fixture count/cable length recommendations.
- Maximum of 64 DALI fixtures per DALI loop.
- 1% minimum dimming value.
- ASHRAE version (not available for 12 in fixture lengths): 5 W/ft; Regular Output version: 8.5 W/ft; High Output version: 15.25 W/ft.



Lutron® EcoSystem® Enabled dimming (ES)

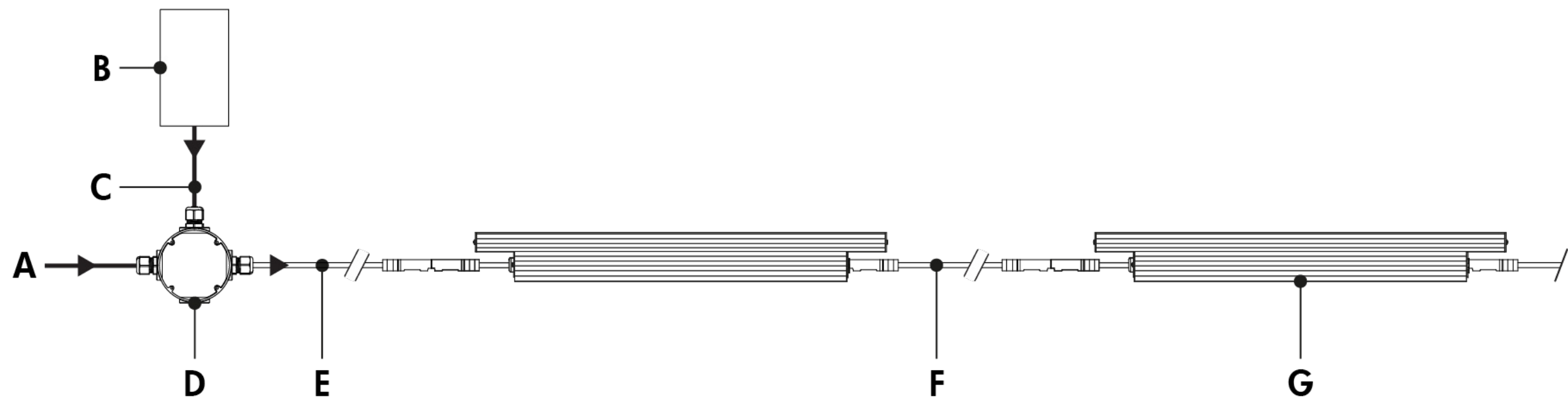

- A** - Power input (100-277V, wiring by others)
- B** - Lutron® EcoSystem® controller (by others)
- C** - Data wiring (by others)
- D** - Junction box (by others)
- E** - Leader cable (LOGiLC)
- F** - Jumper cable (LOGiJC) (optional)
- G** - Lumenfacade Interior (24 in, 36 in or 48 in fixture lengths)

Lutron® EcoSystem® Enabled dimming (ES) - wiring detail

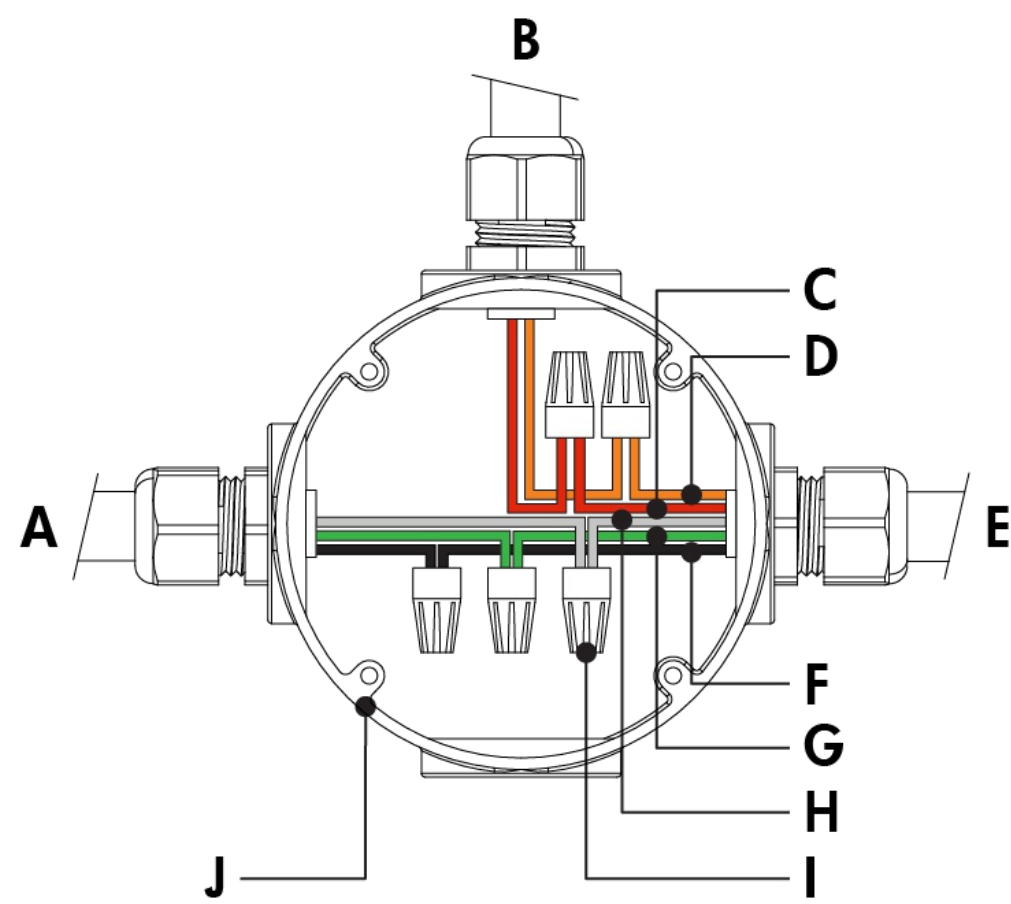

- A** - Power input
- B** - From Lutron® EcoSystem® controller (by others)
- C** - Data +
- D** - Data -
- E** - To fixture
- F** - Line
- G** - Ground
- H** - Neutral
- I** - Wire-nuts (by others)
- J** - Junction box (by others)

- Consult factory for specific applications and maximum fixture count/cable length recommendations.
- Each Lutron® EcoSystem® enabled fixture has its own address; for the example shown, there are a total of 2 EcoSystem® addresses.
- 1% minimum dimming value.
- ASHRAE version (not available for 12 in fixture lengths): 5 W/ft; Regular Output version: 8.5 W/ft; High Output version: 15.25 W/ft.

Star Layout (DMX/RDM)

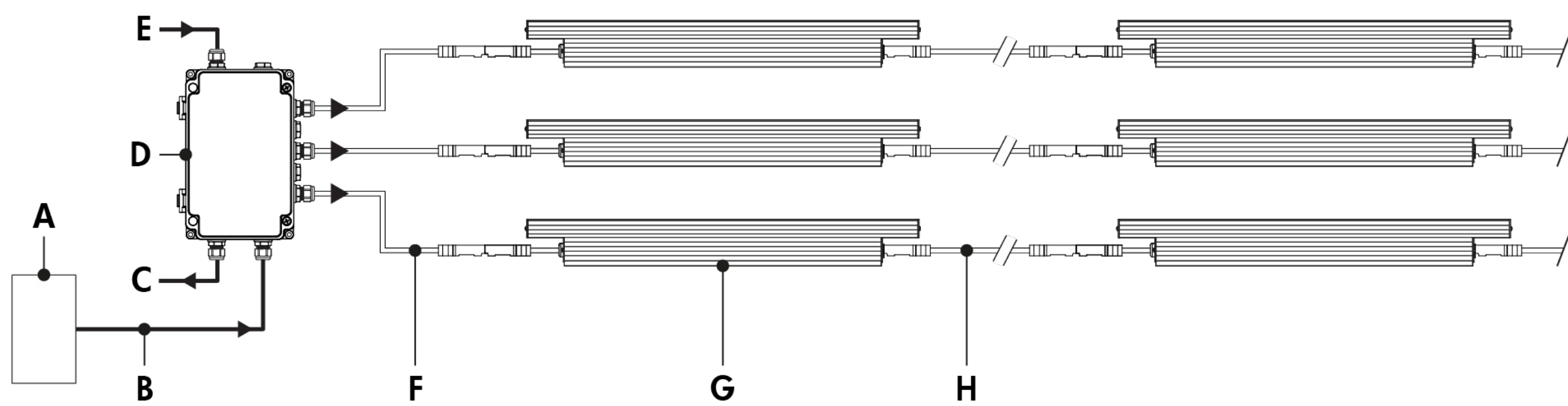

- A** - DMX/RDM controller (order separately from Lumenpulse, or by others)
- B** - Data input (Belden 9841 or equivalent, by others)
- C** - Data output to next CBX (optional, not isolated/not boosted)
- D** - CBX-ST
- E** - Power input (100-277V, wiring by others)
- F** - Leader cable (LOGiLC)
- G** - Lumenfacade Interior
- H** - Jumper cable (LOGiJC) (optional)

Daisy Chain Layout (DMX/RDM)

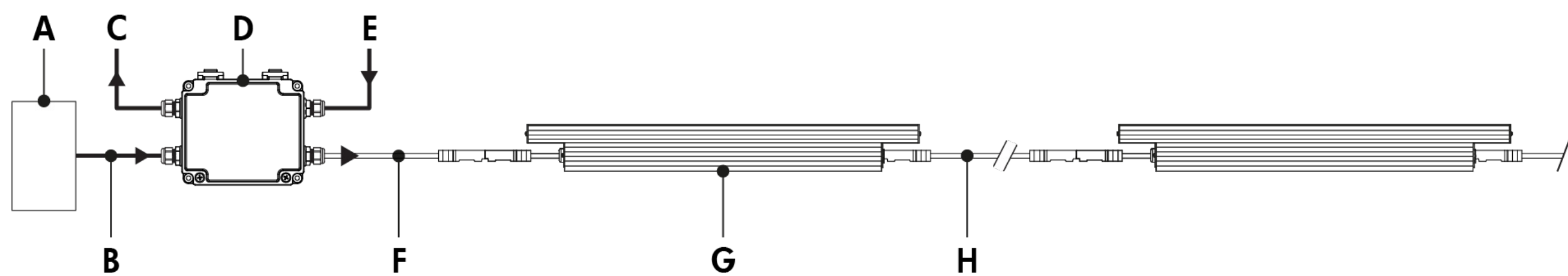

- A** - DMX/RDM controller (order separately from Lumenpulse, or by others)
- B** - Data input (Belden 9841 or equivalent, by others)
- C** - Data output to next CBX (optional, not isolated/not boosted)
- D** - CBX-DS
- E** - Power input (100-277V, wiring by others)
- F** - Leader cable (LOGiLC)
- G** - Lumenfacade Interior
- H** - Jumper cable (LOGiJC) (optional)

Maximum run length

| Configuration/Voltage | 120V  | 240V  | 277V  |
|-----------------------|-------|-------|-------|
| LOGi HO               | 68ft  | 76ft  | 84ft  |
| LOGi RO               | 120ft | 128ft | 128ft |
| LOGi ASHRAE           | 128ft | 128ft | 128ft |

Based on 15A maximum, 50 ft leader cable.

- Consult CBX installation instructions for additional wiring details.
- Consult factory for specific applications and maximum fixture count/cable length recommendations. Maximum run length calculations are typically based on 48 in fixtures.
- The DMX/RDM protocol states a maximum of 32 DMX/RDM enabled fixtures on any single run.
- Maximum of 4 DMX/RDM repeaters/CBX cascading in line.
- Maximum of 6 outputs per CBX-ST; maximum of 1 output per CBX-DS.
- Each fixture requires 1 DMX address.
- 1% minimum dimming value.
- ASHRAE version (not available for 12 in fixture lengths): 5 W/ft; Regular Output version: 8.5 W/ft; High Output version: 15.25 W/ft.



| How to order |   |   |   |   |   |   |   |
|--------------|---|---|---|---|---|---|---|
| 1            | 2 | 3 | 4 | 5 | 6 | 7 | 8 |
|              |   |   |   |   |   |   |   |

1 . Housing <sup>(1)</sup>

|             |  |
|-------------|--|
| LOGi ASHRAE | Lumenfacade™ Interior, 5 W/ft, ASHRAE compliant <sup>(2)</sup> |
| LOGi RO     | Lumenfacade™ Interior Regular Output, 8.5 W/ft                 |
| LOGi HO     | Lumenfacade™ Interior High Output, 15.25 W/ft                  |

<sup>(1)</sup> Power consumption is typically 20% higher for 12 in fixture lengths.

<sup>(2)</sup> ASHRAE version not available for 12 in fixture lengths.

2 . Voltage

|     |           |
|-----|-----------|
| 100 | 100 volts |
| 120 | 120 volts |
| 208 | 208 volts |
| 220 | 220 volts |
| 240 | 240 volts |
| 277 | 277 volts |

3 . Length

|    |   |
|----|---|
| 12 | 12 3/8 in (2.1 lbs) <sup>(1)</sup> <sup>(2)</sup> |
| 24 | 24 3/8 in (3.7 lbs)                               |
| 36 | 36 3/8 in (5.3 lbs)                               |
| 48 | 48 3/8 in (6.8 lbs)                               |

<sup>(1)</sup> Power consumption is typically 20% higher for 12 in fixture lengths.

<sup>(2)</sup> To connect 12 in fixture lengths to the Lumentalk system, DIM or DMX/RDM must be specified as the control option, and a Lumentalk Data Bridge (LDB) is required. See the typical wiring diagrams in the specification sheet for details.

4 . Color and Color Temperature <sup>(1)</sup>

|     |                      |
|-----|----------------------|
| 22K | 2200K                |
| 27K | 2700K                |
| 30K | 3000K                |
| 35K | 3500K                |
| 40K | 4000K                |
| RD  | Red <sup>(2)</sup>   |
| GR  | Green <sup>(2)</sup> |
| BL  | Blue <sup>(2)</sup>  |

<sup>(1)</sup> Consult factory for availability of static Royal Blue, 6500K and 90+ CRI.

<sup>(2)</sup> Static colors made to order 8-10 weeks.

5 . Optics

|       |                                 |
|-------|---------------------------------|
| WWLF  | Asymmetric Wallwash, left feed  |
| WWRF  | Asymmetric Wallwash, right feed |
| 8x8   | 8° x 8° <sup>(1)</sup>          |
| 10x10 | 10° x 10° <sup>(1)</sup>        |
| 10x30 | 10° x 30°                       |
| 10x60 | 10° x 60°                       |
| 10x90 | 10° x 90°                       |
| 15x25 | 15° x 25°                       |
| 30x30 | 30° x 30°                       |
| 30x60 | 30° x 60°                       |
| 35x35 | 35° x 35°                       |
| 50x80 | 50° x 80°                       |
| 60x60 | 60° x 60°                       |
| 80x80 | 80° x 80°                       |
| 90x90 | 90° x 90°                       |

<sup>(1)</sup> For best results use with HO fixtures at a 6 in setback from surface. Contact factory for application support.

6 . Mounting Options

|              |  |
|--------------|--|
| <b>SAM</b>   | Slim Adjustable Mounting               |
| <b>UMP</b>   | Fixed Mounting                         |
| <b>UMAS</b>  | Universal Adjustable Mounting          |
| <b>WAM2</b>  | Adjustable Wall Mounting 2 in          |
| <b>WAM6</b>  | Adjustable Extended Arm Mounting 6 in  |
| <b>WAM12</b> | Adjustable Extended Arm Mounting 12 in |
| <b>WAM18</b> | Adjustable Extended Arm Mounting 18 in |

8 . Control

|                |   |
|----------------|---|
| <b>NO</b>      | On/Off control                                    |
| <b>LT</b>      | Lumentalk <sup>(1)</sup> <sup>(2)</sup>           |
| <b>DIM</b>     | 0-10V dimming                                     |
| <b>DALI</b>    | DALI dimming                                      |
| <b>ES</b>      | Lutron® EcoSystem® Enabled dimming <sup>(3)</sup> |
| <b>DMX/RDM</b> | DMX/RDM enabled <sup>(4)</sup>                    |

<sup>(1)</sup> To connect 12 in fixture lengths to the Lumentalk system, DIM or DMX/RDM must be specified as the control option, and a Lumentalk Data Bridge (LDB) is required. See the typical wiring diagrams in the specification sheet for details.

<sup>(2)</sup> A Lumentranslator and LumentalkID (LIDLT) must be specified for Lumentalk applications. Consult Lumentranslator and Lumentalk pages and specification sheets for details.

<sup>(3)</sup> Available for 24 in, 36 in and 48 in fixture lengths only.

<sup>(4)</sup> A control box (CBX) and LumenID (LID) must be specified.

7 . Finish

|            |   |
|------------|---|
| <b>BK</b>  | Black Sandtex®  |
| <b>BRZ</b> | Bronze Sandtex®   |
| <b>SI</b>  | Silver Sandtex®   |
| <b>WH</b>  | Smooth white  |
| <b>CC</b>  | Custom color and finish (please specify RAL color) <sup>(1)</sup> |

<sup>(1)</sup> Lumenpulse offers a wide selection of RAL CLASSIC (K7) colors with a smooth texture and high-gloss finish. Please consult factory for a list of available K7 colors, other RAL textures and glosses, or to match alternate color charts. Final color matching results may vary.