

Project Name

Qty

Type

Catalog / Part Number

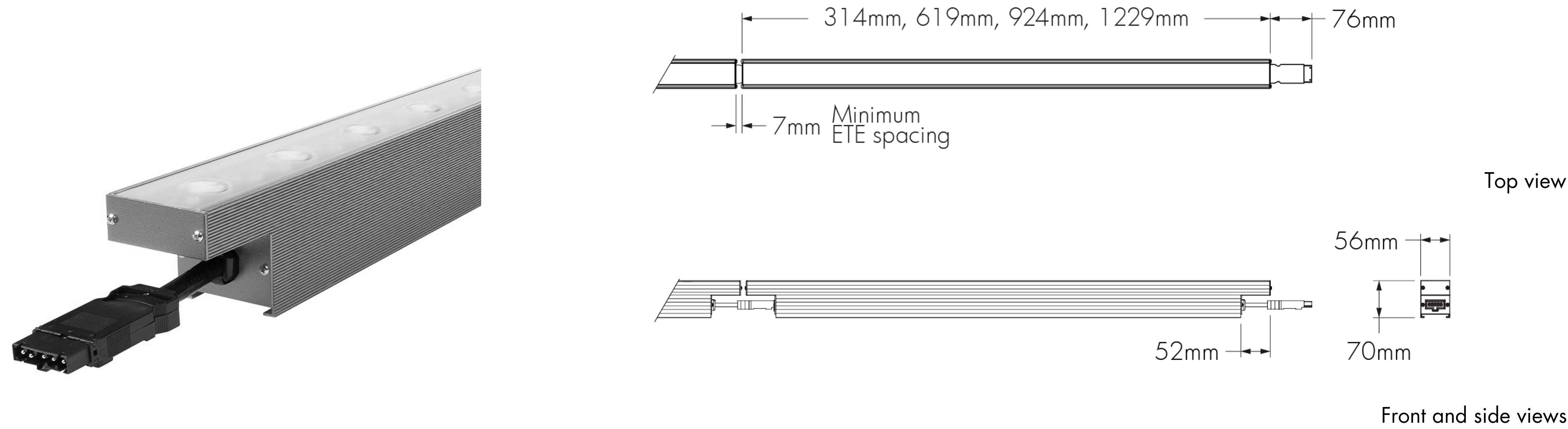

Description

The Lumenfacade Interior is a high-performance interior LED luminaire for grazing or wall washing applications. Featuring second generation LED technology, the luminaire is available in 305 mm, 610 mm, 914 mm or 1219 mm sections, and can be configured with a number of options including: optics for grazing or flood lighting; a choice of outputs (RO 27.89 W/m or HO 50.03 W/m); various colour temperatures or static colours; various mounting options, finishes, accessories and controls. The Lumenfacade is also available with a unique asymmetric wallwash distribution, providing exceptional uniformity and brightness for walls and signage.

Features

Colour and Colour Temperature	2200K, 2700K, 3000K, 3500K, 4000K, Red, Green, Blue
Length (nominal)	305 mm, 610 mm, 914 mm, 1219 mm
Optics	Asymmetric Wallwash, 8° x 8°, 10° x 10°, 10° x 30°, 10° x 60°, 10° x 90°, 15° x 25°, 30° x 30°, 30° x 60°, 35° x 35°, 50° x 80°, 60° x 60°, 80° x 80°, 90° x 90°
Power Consumption	16.4 W/m (meets ASHRAE standards for linear lighting on building facades - not available for 305 mm fixture lengths), 27.89 W/m (RO version), 50.03 W/m (HO version), Typically 20% higher for 305 mm fixture lengths
Warranty	5-year limited warranty
Performance	
Illuminance at Distance	Minimum 1 fc at 34.7 m (HO 4000K, 1219 mm fixture, 10° x 60°, DMX/RDM)
Colour Consistency	2 SDCM, 3 SDCM (2200K)
Colour Rendering	Minimum CRI 80
Lumen Maintenance	L70 280,000 hrs, L95 35,000 hrs

Colours and Colour Temperatures

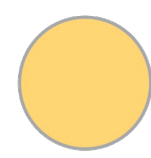

2200K

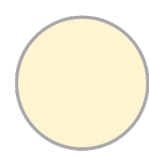

2700K

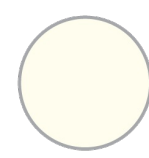

3000K

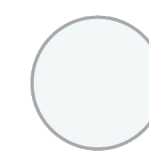

3500K

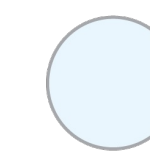

4000K

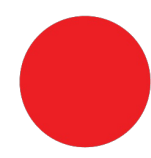

Red



Green

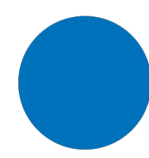

Blue

Controls

ON/OFF

0-10V

DALI







Certifications









Physical

Housing Material	Low copper content extruded aluminium
Lens Material	Clear acrylic
Hardware Material	Stainless steel
End Cap Material	Aluminium
Surface Finish	Electrostatically applied polyester powder coat
Weight	305 mm: 0.95 kg, 610 mm: 1.68 kg, 914 mm: 2.4 kg, 1219 mm: 3.08 kg

Electrical and control

Voltage	100 to 277 volts
Fixture Cable	Power and data in one cable, End-to-end configuration standard (factory installed input cable - no jumper cable needed for minimum spacing between two fixtures)
Fixture Cable and Connector Colour	Black for Black Sandtex, Bronze Sandtex and Silver Sandtex finishes, White for Smooth white finish
Leader Cable Conductors	3C #16-3 (NO, LT control), 5C #16-5 (DIM, DALI, ES, DMX/RDM control)
Maximum Cable and Fixture Run Length	76.8 m (On/Off, 277V, RO version), 50 m (On/Off, 277V, HO version)
Control	On/Off control, Lumentalk, 0-10V dimming, DALI dimming, Lutron® EcoSystem® Enabled dimming, DMX/RDM enabled
Resolution (DMX/RDM)	Per foot or per fixture (configured with LumenID V3 software), 8-bit or 16-bit

Environmental

Environment	Indoor applications only
Storage Temperature	-40 °C to 85 °C (device must reach start-up temperature value before operating)
Start-up Temperature	-25 °C to 50 °C
Operating Temperature	-40 °C to 50 °C

Accessories (order separately)

Optical Accessories	Lumenfacade Interior Radial Louvre
Cables	Lumenfacade Interior Leader Cable, Lumenfacade Interior Jumper Cable
Control Boxes	DMX/RDM enabled (daisy chain or star configuration), Ethernet enabled (daisy chain or star configuration), Lumentalk Data Bridge
Control Systems	Lumentone™ 2, Pharos® kit
Diagnostic and Addressing Tools	LumenID, LumentalkID

Asymmetric wallwash optic details

WWLF - Asymmetric wallwash optic, left feed

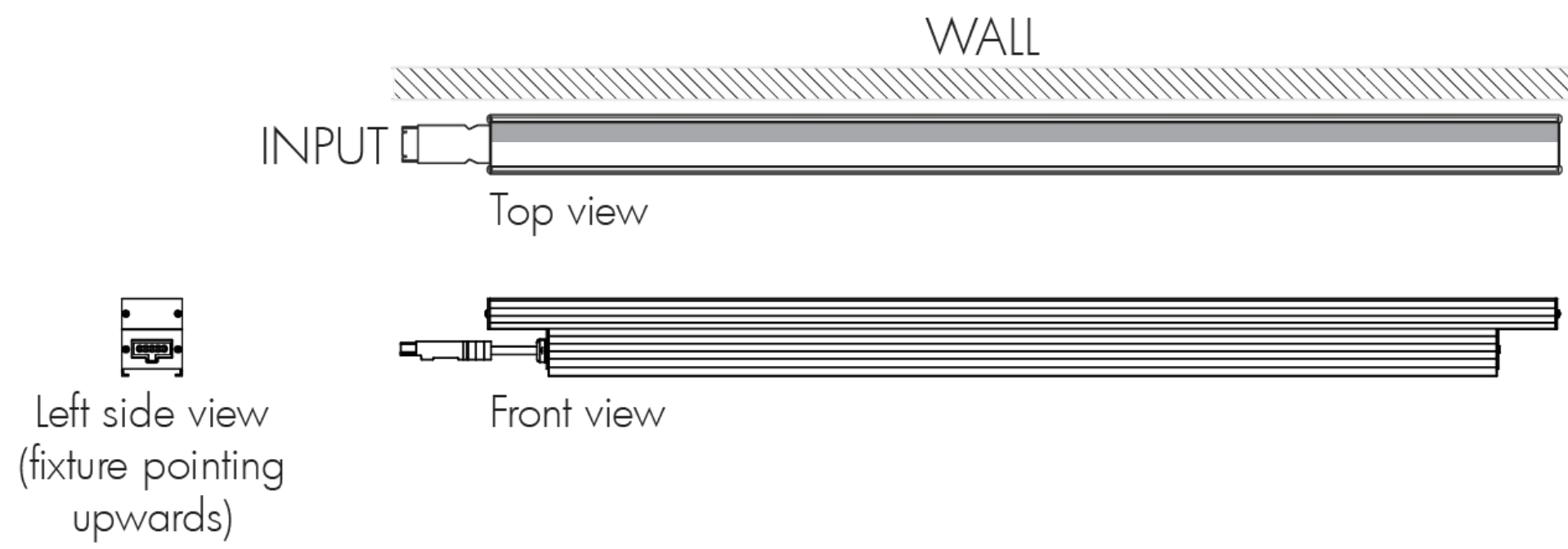

WWRF - Asymmetric wallwash optic, right feed

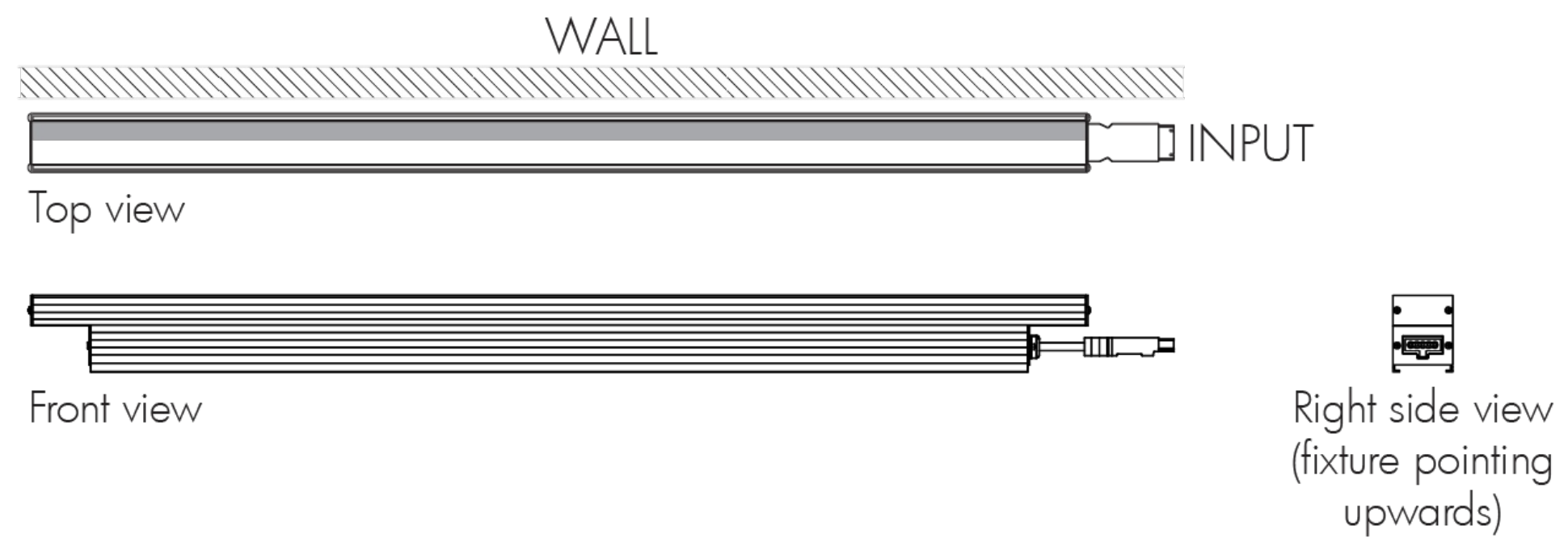

- Always position frosted side toward the wall.
- Fixture's feeding side is based on uplight installations. Feeding sides are reversed when fixture is used in a downlight application.
- Recommended setback from wall is 1/10 of the wall height. Example: 0.6 m setback for a 6.1 m wall.

Mounting options

Surface Mount

SAM - Slim Adjustable Mounting

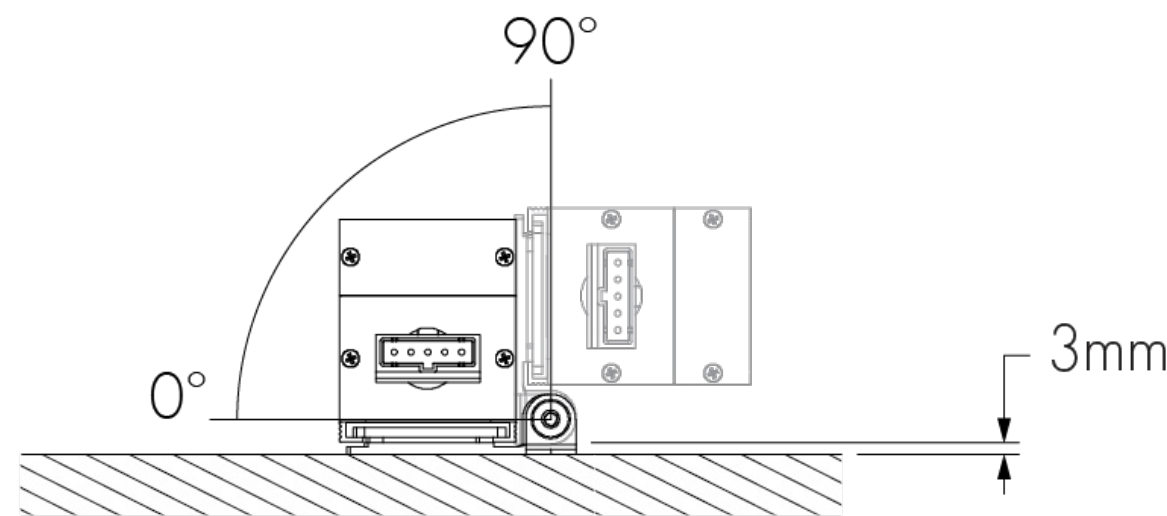

SAM - Mounting hole pattern

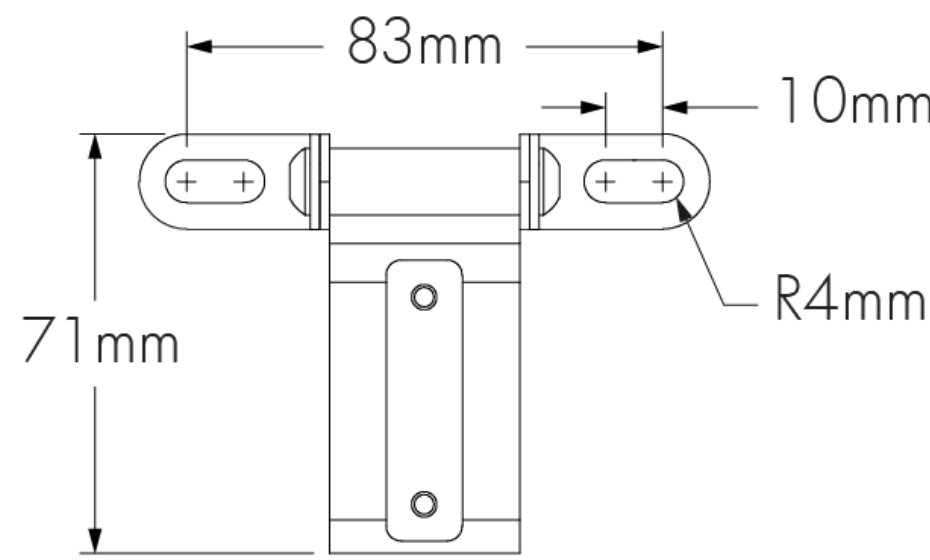

UMP - Fixed Mounting

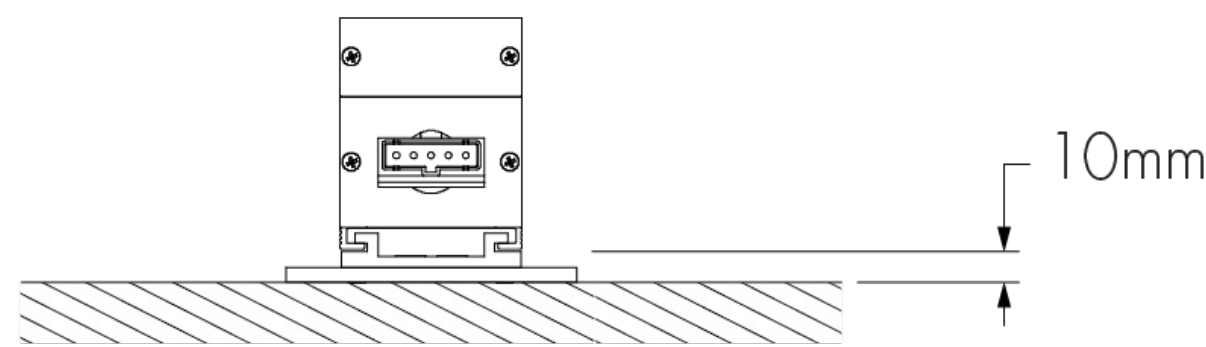

UMP - Mounting hole pattern

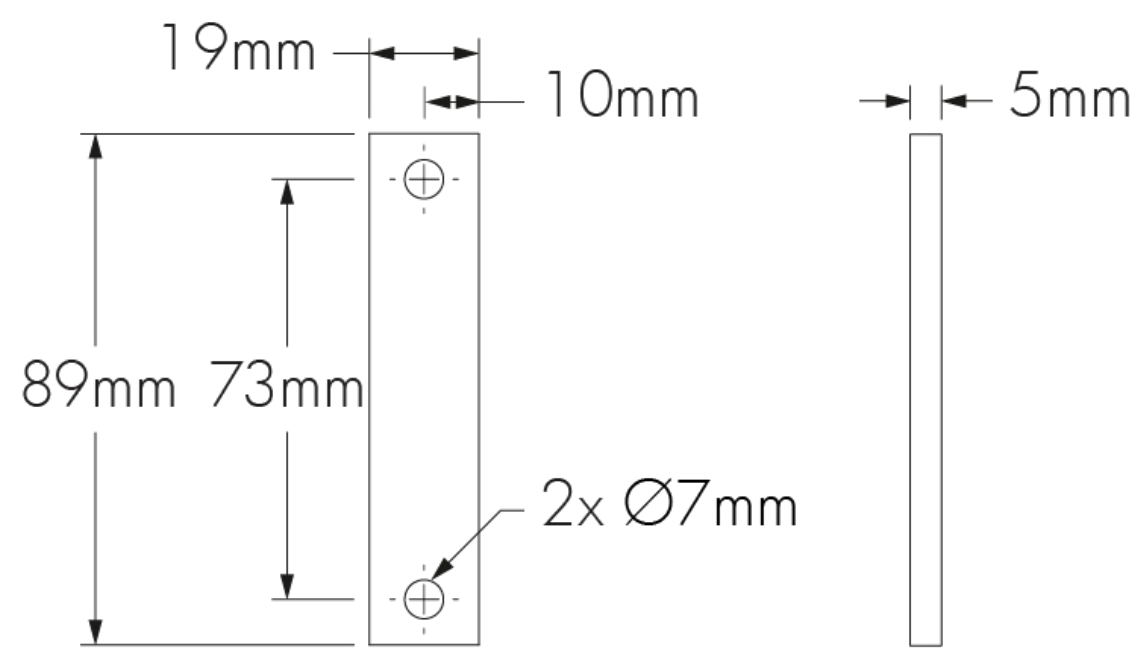

Wall Mount

UMAS - Universal Adjustable Mounting

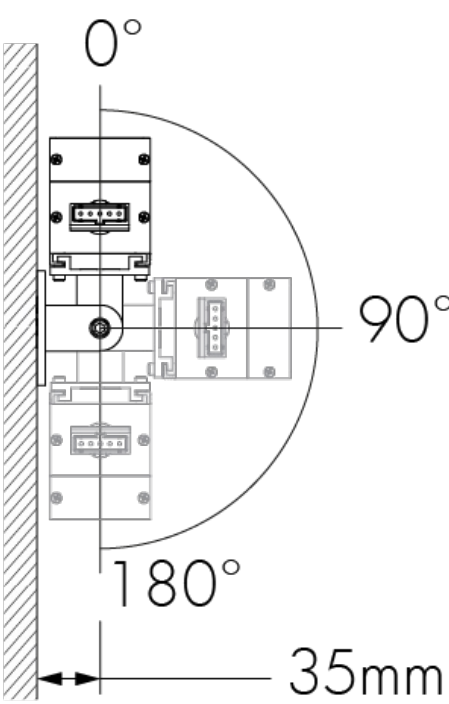

UMAS - Mounting hole pattern

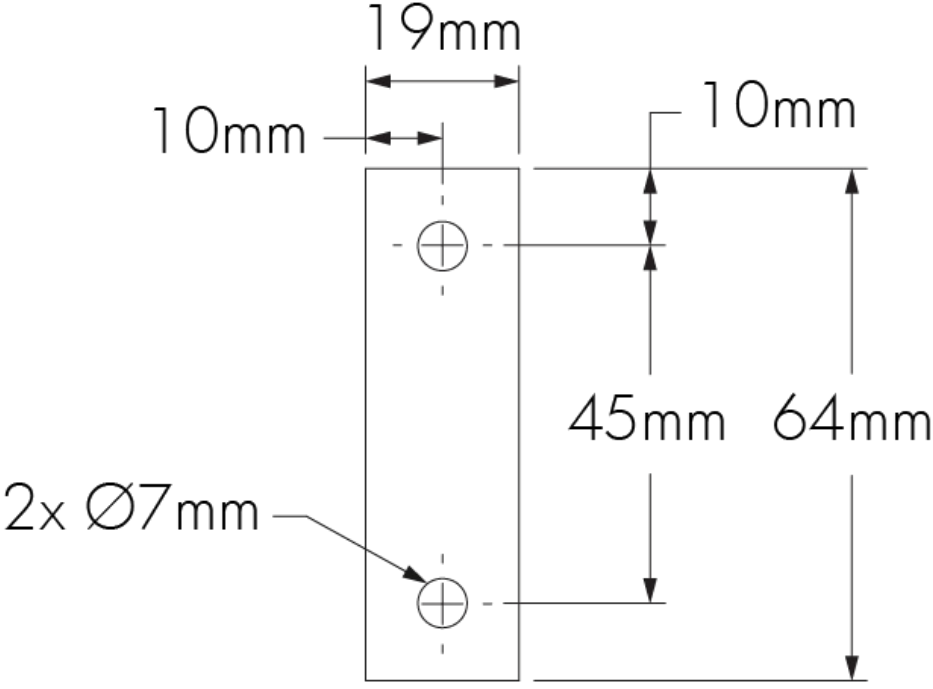

WAM2 - Adjustable Wall Mounting 51 mm

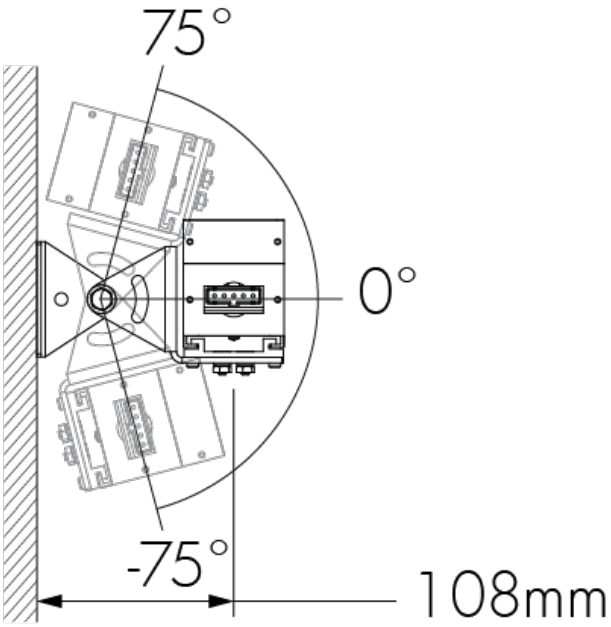

WAM2 - Mounting hole pattern

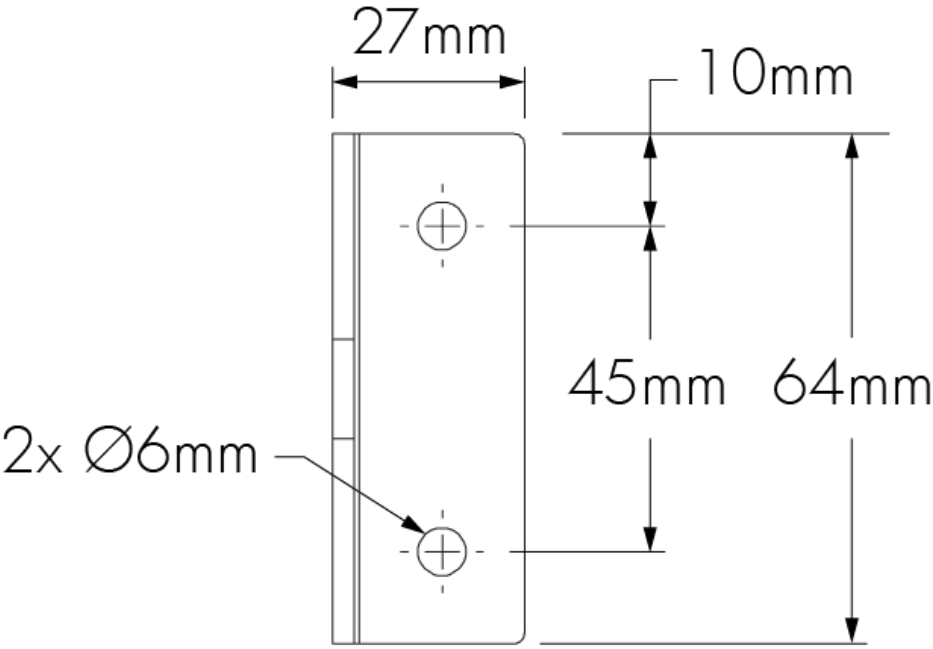

WAM6 - Adjustable Extended Arm Mounting 152 mm

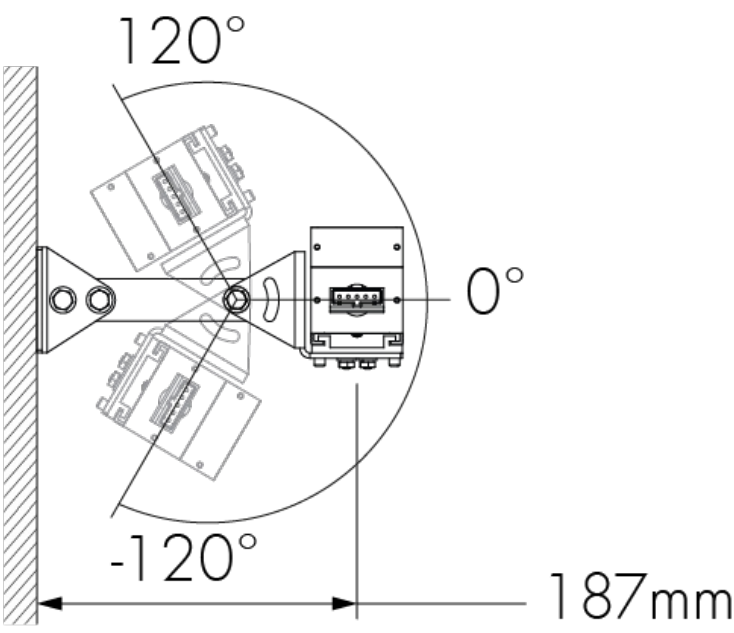

WAM6 - Mounting hole pattern

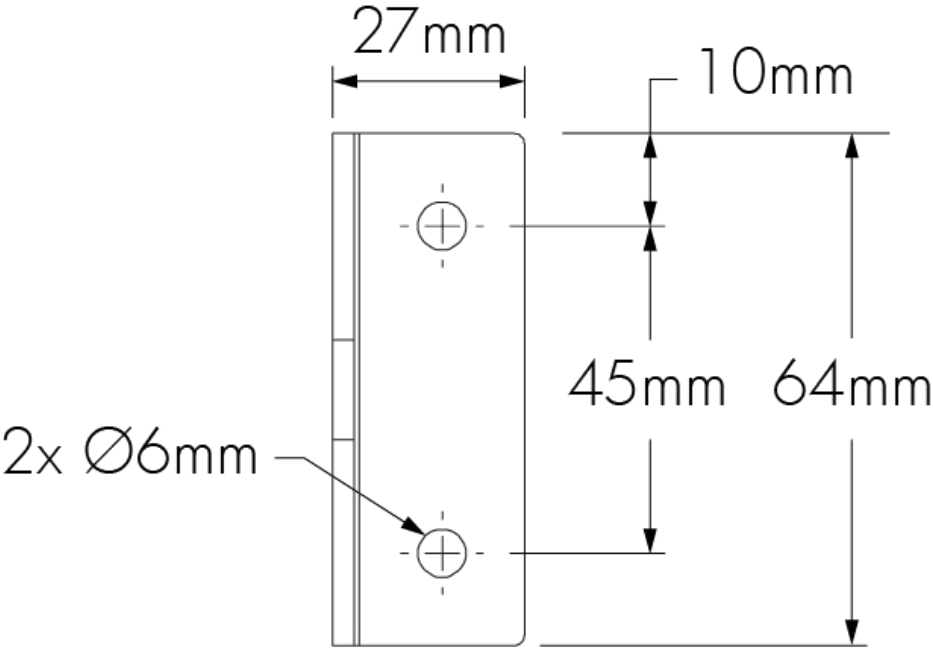

WAM12 - Adjustable Extended Arm Mounting 305 mm

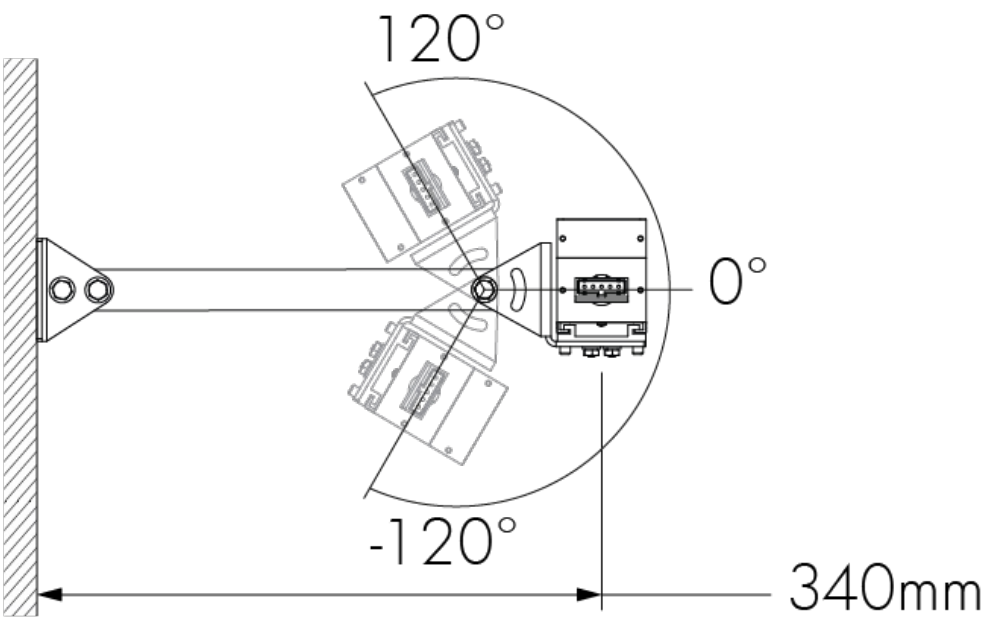

WAM12 - Mounting hole pattern

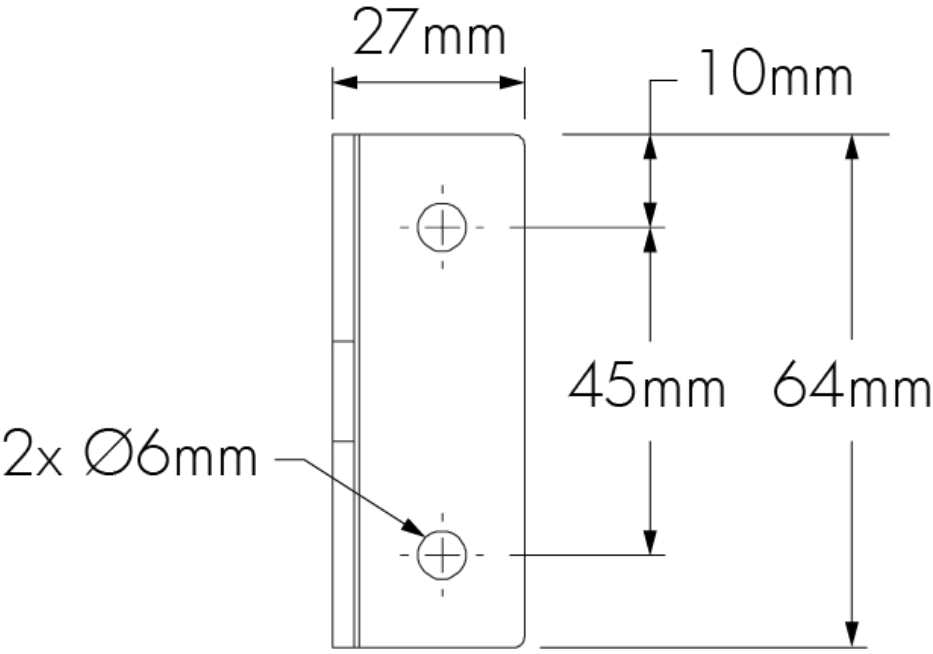

WAM18 - Adjustable Extended Arm Mounting 457 mm

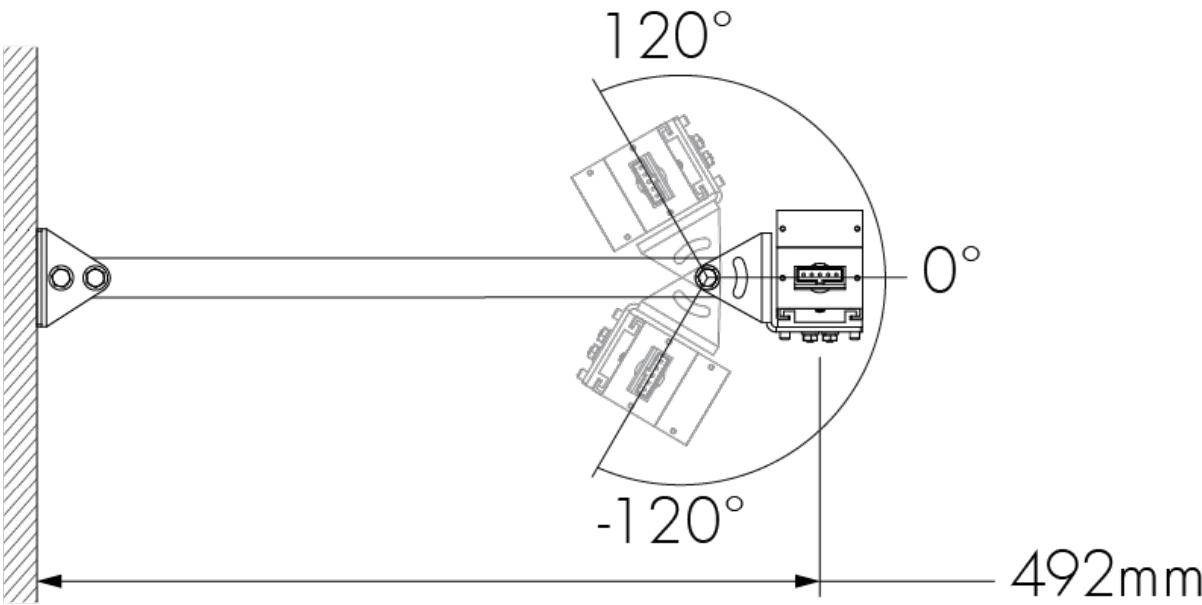

WAM18 - Mounting hole pattern

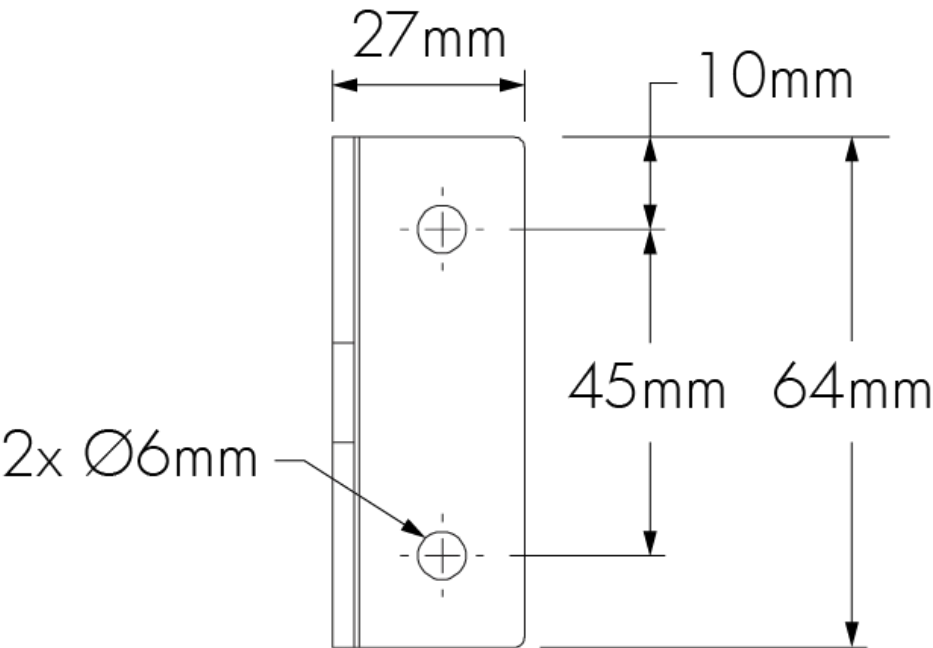

Optical accessories (order separately)

LOGiRD - Radial louvre for Lumenfacade Interior

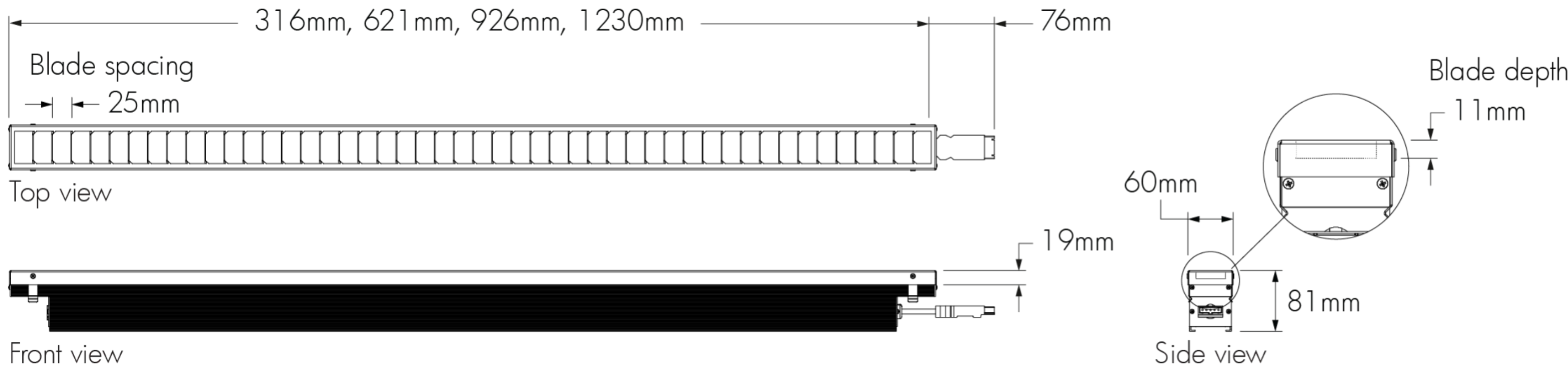

LOGiRD-LENGTH-FINISH

- Please specify:
- LENGTH:** 305 mm, 610 mm, 914 mm or 1219 mm; **FINISH:** BK - Black Sandtex®, BRZ - Bronze Sandtex®, SI - Silver Sandtex®, WH - Smooth white or CC - custom colour and finish (please specify RAL colour)
- The addition of a louvre will affect beam distribution. Consult factory for application support.
 - Not suitable for asymmetric wallwash optic.

Cables (order separately)

LOGiLC - Leader cable for Lumenfacade Interior

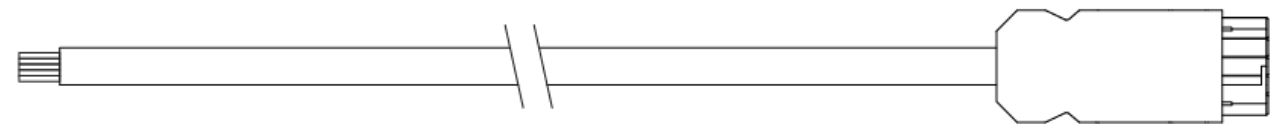

LOGiLC-CERTIFICATION-CONTROL-LENGTH-CABLE COLOUR

- Please specify:
- CERTIFICATION:** UL or CE; **CONTROL:** NO - non-dimming or DATA - dimming/data; **LENGTH:** 3 m, 7.6 m, 15.2 m, 30.5 m, 45.7 m or 61 m; **CABLE COLOUR:** black or white (connectors are the same colour as the specified cable colour)
- Consult Lumenfacade Interior leader cable specification sheet for details.

LOGiJC - Jumper cable for Lumenfacade Interior

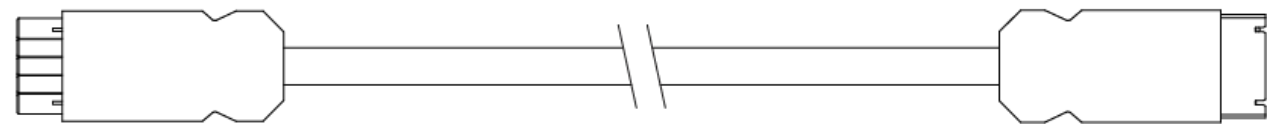

LOGiJC-CERTIFICATION-CONTROL-LENGTH-CABLE COLOUR

- Please specify:
- CERTIFICATION:** UL or CE; **CONTROL:** NO - non-dimming or DATA - dimming/data; **LENGTH:** 0.3 m to 9.1 m (available in 0.3 m increments) or 15.2 m; **CABLE COLOUR:** black or white (connectors are the same colour as the specified cable colour)
- Consult Lumenfacade Interior jumper cable specification sheet for details.

Control boxes (order separately)

CBX-DMX/RDM - DMX/RDM enabled (daisy chain or star configuration)

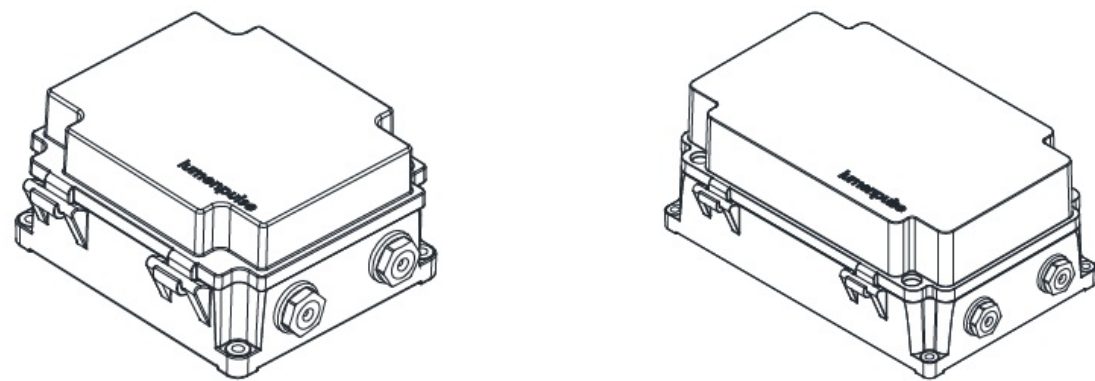

DMX/RDM control box. Up to six power and data outputs to fixtures or fixture runs. Consult CBX specification sheet and installation instructions for details. Lumenterminators provided with CBX (2x for daisy chain configuration, 6x for star configuration), consult factory to order spares.

CBX-ENET - Ethernet enabled (daisy chain or star configuration)

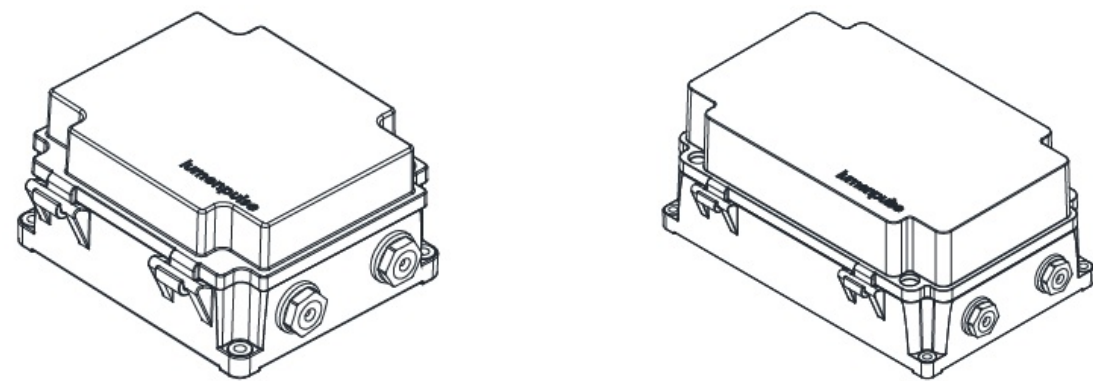

Ethernet control box. Up to four power and data outputs to fixture or fixture runs. Consult Ethernet CBX specification sheet and installation instructions for details.

LDB - Lumentalk Data Bridge

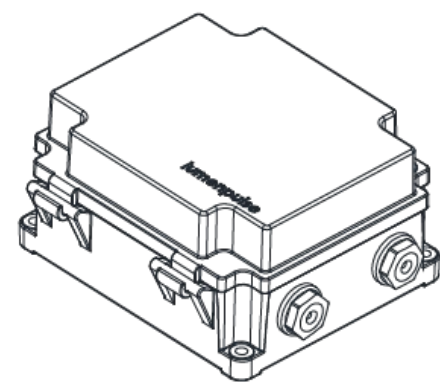

Lumentalk Data Bridge, 0-10V or DMX output. Consult LDB specification sheet for details.

Control systems (order separately)

LTN2 - Lumentone™ 2



Lumentone 2 is a simple pre-programmed DMX 512 controller with a push button rotary dial and live feedback.

PHAROS - Pharos® kit

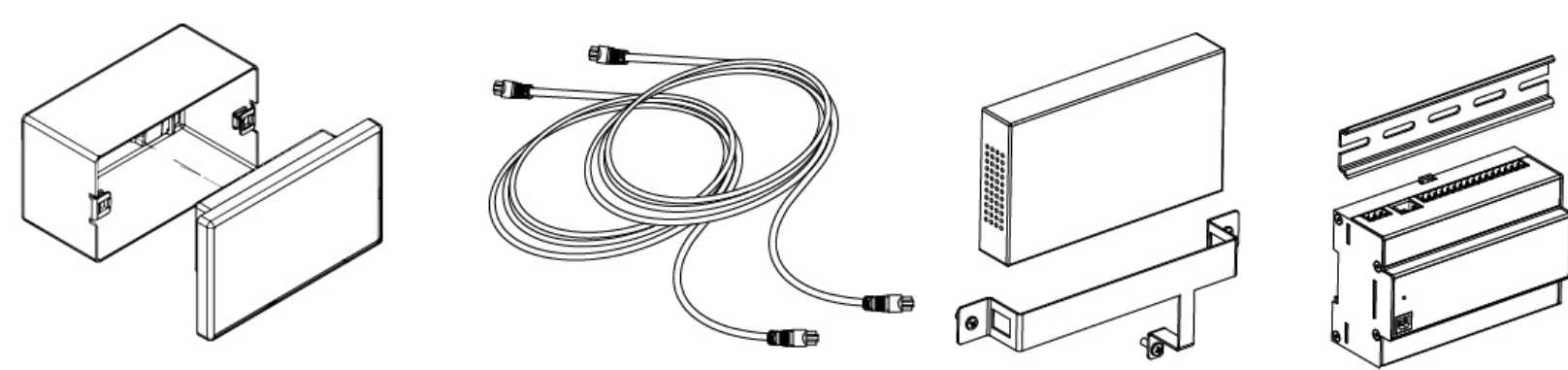

The Pharos kit, available for 1 or 2 DMX universes, allows for complete control of large lighting installations. 2 DMX universes kit shown.

Diagnostic and addressing tools (order separately)

LID - LumenID

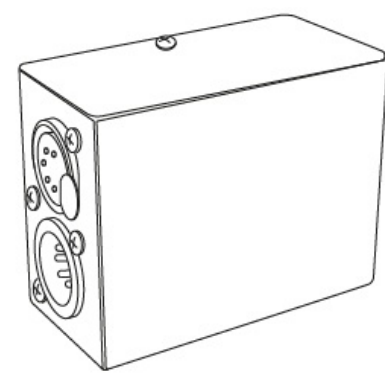

LumenID is a diagnostic and addressing DMX/RDM tool. It must be specified on all DMX applications. Consult LID specification sheet for details.

LID-LT - LumentalkID

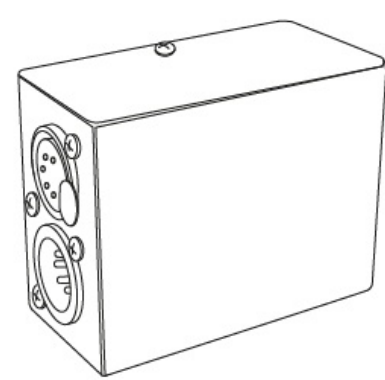

LumentalkID is a diagnostic and addressing tool. It must be specified for all Lumentalk (LT) applications. Consult LID-LT specification sheet for details.

Resolution details

Resolution per foot: each 305 mm section is addressed independently

DMX addresses:



Resolution per fixture: each fixture is addressed independently

DMX addresses:



- 1219 mm fixtures shown.
- Applicable for DMX/RDM control option only. Fixture resolution can be configured on-site within the LumenID V3 software. A DMX/RDM enabled CBX is required.

Typical wiring diagrams

Wiring colour code

UL Color Code	USE
Green	Ground
Black	Line
White	Line/Neutral
Red or Purple	0-10V / Data +
Orange	0-10V / Data -

On/Off control (NO)

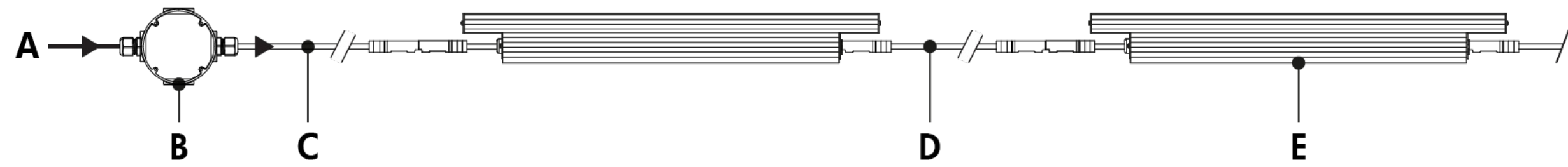

- A** - Power input (100-277V, wiring by others)
- B** - Junction box (by others)
- C** - Leader cable (LOGiLC)
- D** - Jumper cable (LOGiJC) (optional)
- E** - Lumenfacade Interior

On/Off control (NO) - wiring detail

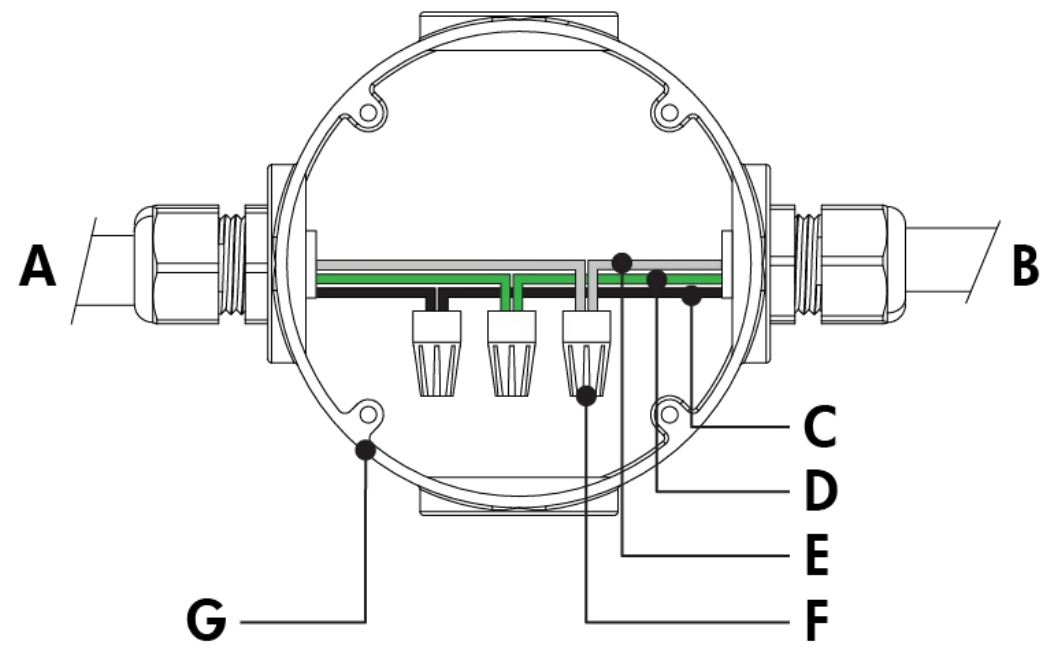

- A** - Power input
- B** - To fixture
- C** - Line
- D** - Ground
- E** - Line/Neutral
- F** - Wire-nuts (by others)
- G** - Junction box (by others)

- Consult factory for specific applications and maximum fixture count/cable length recommendations.
- ASHRAE version (not available for 305 mm fixture lengths): 16.4 W/m; Regular Output version: 27.89 W/m; High Output version: 50.03 W/m.

Lumentalk (LT)

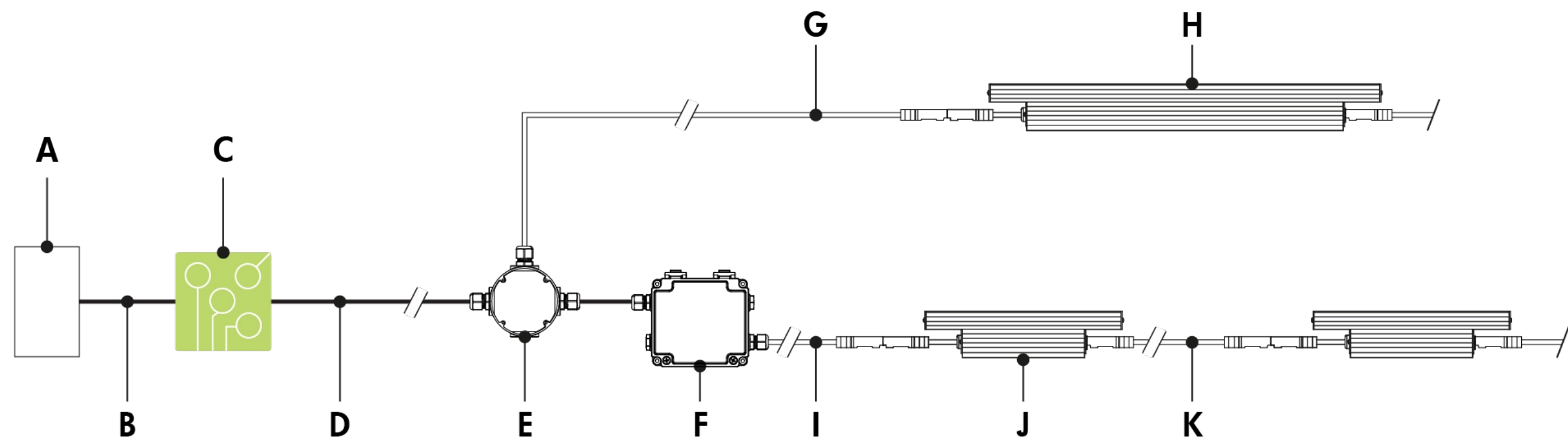

- A** - Dimmer/controller (order separately from Lumenpulse, or by others)
- B** - Data wiring (by others)
- C** - Lumentranslator (LTL-010, -DMX, -TRIAC, -DALI)
- D** - Power line (120-277V AC, wiring by others)
- E** - Junction box (by others)
- F** - Lumentalk Data Bridge (LDB-DIM or LDB-DMX)
- G** - Leader cable (LOGiLC)
- H** - Lumenfacade Interior (610 mm, 914 mm or 1219 mm fixture lengths)
- I** - Leader cable (LOGiLC-DATA)
- J** - Lumenfacade Interior 305 mm
- K** - Jumper cable (LOGiJC-DATA) (optional)

Lumentalk (LT) - wiring detail

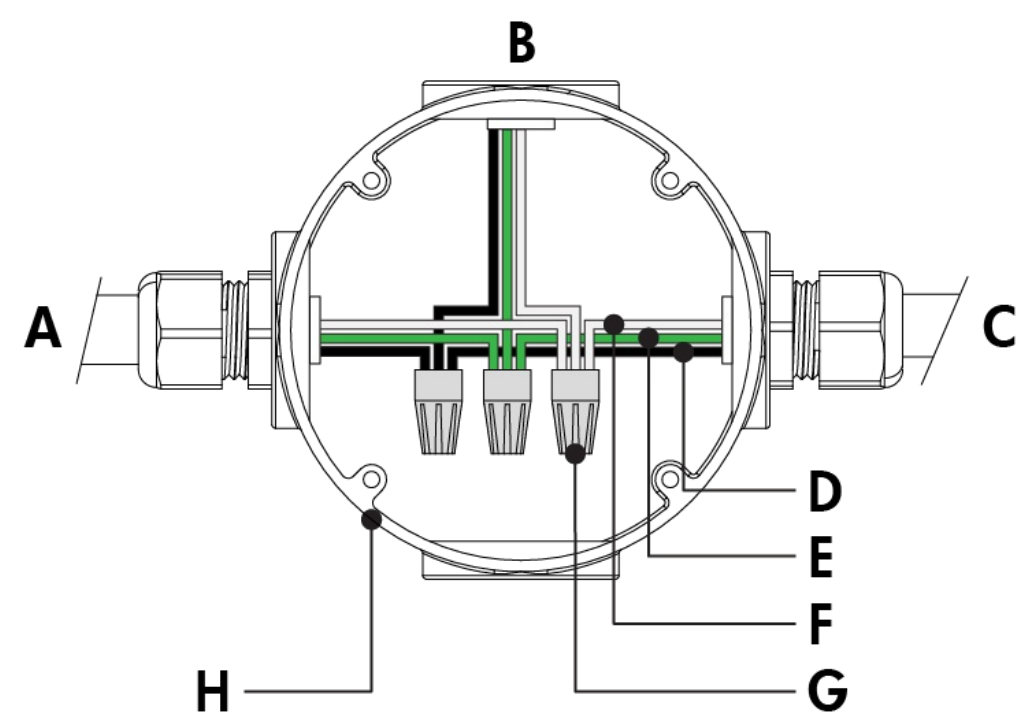

- A** - Power input (control over power line via Lumentalk system) or from previous fixture
- B** - To fixture
- C** - To Lumentalk Data Bridge (for run lengths with 305 mm fixtures)
- D** - Line
- E** - Ground
- F** - Line/Neutral
- G** - Wire-nuts (by others)
- H** - Junction box (by others)

- Consult factory for specific applications and maximum fixture count/cable length recommendations.
- Lumentalk Data Bridge required for 305 mm fixture lengths, see LDB installation instructions for details.
- For applications with all fixtures controlled as 1 zone: fixtures and Lumentalk Data Bridge must be specified as DIM. Maximum of 10 fixtures per LDB-DIM, consult factory for applications that require additional capabilities.
- For applications with fixtures controlled individually: fixtures and Lumentalk Data Bridge must be specified as DMX, 2-step commissioning process: 1 - DMX/RDM system using LumenID software and a LID, 2 - Lumentalk system using LumentalkID software and a LID-LT. Maximum of 32 fixtures per LDB-DMX. Consult factory for details.
- For DMX applications: 1 DMX controller per Lumentalk network, maximum of 48 DMX channels per Lumentalk network (minimum step transition update rate is 1 second, minimum fade time between two colours is 1 minute). Consult factory for applications that require additional capabilities.
- Maximum of 1 transmitter (Lumentranslator or Lumenlink) per system.
- No third party fixtures allowed on the same circuit.
- Consult factory for DALI Lumentalk applications.
- 1% minimum dimming value.
- ASHRAE version (not available for 305 mm fixture lengths): 16.4 W/m; Regular Output version: 27.89 W/m; High Output version: 50.03 W/m.

0-10V dimming (DIM)

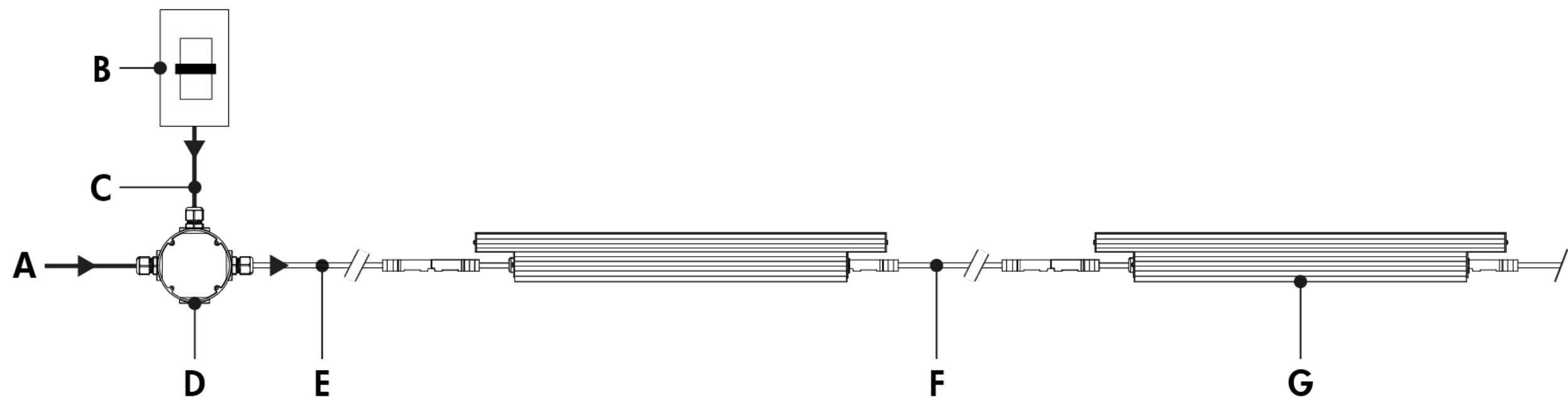

- A** - Power input (100-277V, wiring by others)
- B** - Dimmer (by others)
- C** - Data wiring (by others)
- D** - Junction box (by others)
- E** - Leader cable (LOGiLC)
- F** - Jumper cable (LOGiJC) (optional)
- G** - Lumenfacade Interior

0-10V dimming (DIM) - wiring detail

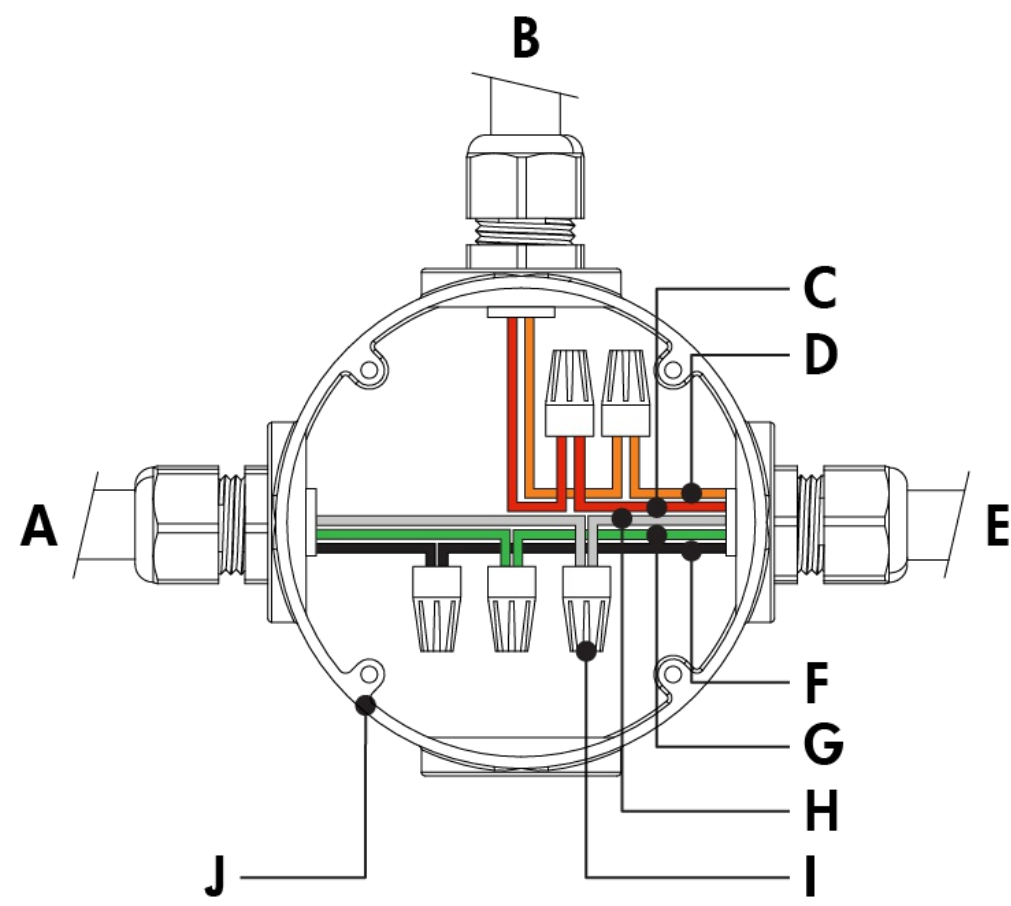

- A** - Power input
- B** - From dimmer (by others)
- C** - 0-10 V +
- D** - 0-10 V -
- E** - To fixture
- F** - Line
- G** - Ground
- H** - Neutral
- I** - Wire-nuts (by others)
- J** - Junction box (by others)

- Consult factory for specific applications and maximum fixture count/cable length recommendations.
- 0-10V mA ratings: passive dimmer (Current Sink): 3 mA per fixture, active dimmer (Current Source): 0.5 mA per fixture.
- 10% minimum dimming value.
- ASHRAE version (not available for 305 mm fixture lengths): 16.4 W/m; Regular Output version: 27.89 W/m; High Output version: 50.03 W/m.

DALI dimming (DALI)

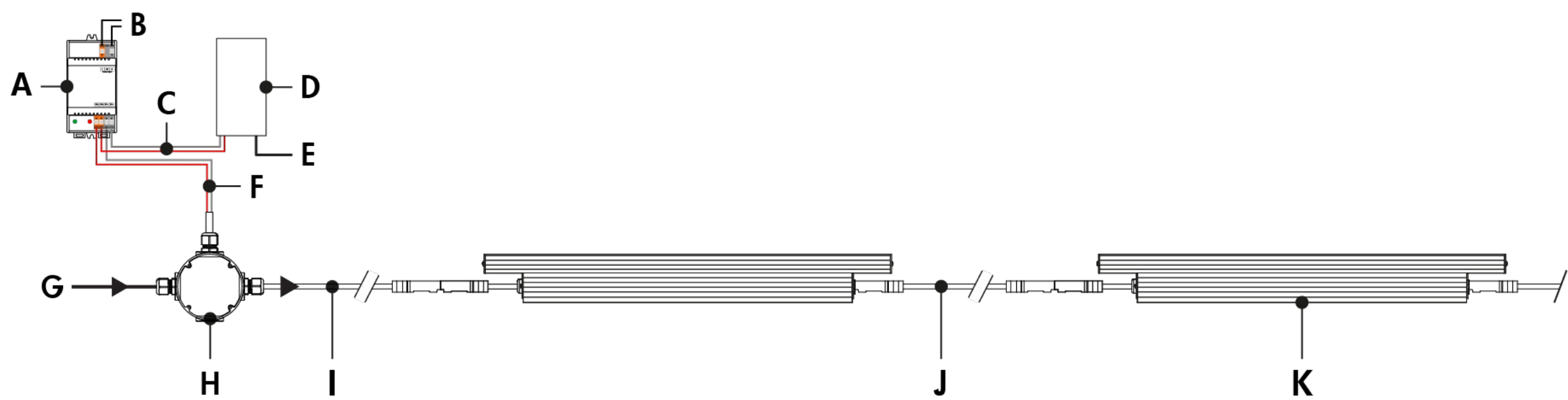

- A** - DALI bus power supply (by others)
- B** - Power input for DALI bus power supply (wiring by others)
- C** - Data output to DALI controller (wiring by others)
- D** - DALI controller (by others)
- E** - Power input for DALI controller (wiring by others)
- F** - Data output to fixture (wiring by others)
- G** - Power input (100-277V, wiring by others)
- H** - Junction box (by others)
- I** - Leader cable (LOGiLC)
- J** - Jumper cable (LOGiJC) (optional)
- K** - Lumenfacade Interior

DALI dimming (DALI) - wiring detail

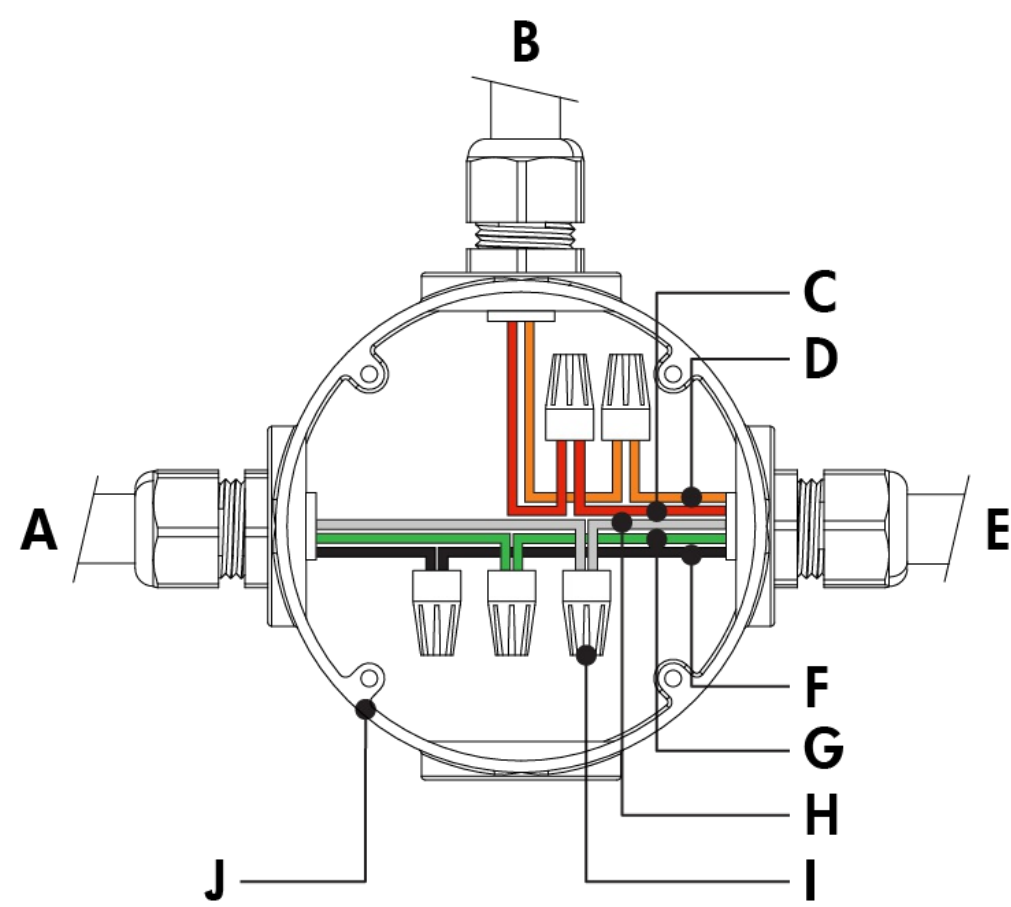

- A** - Power input
- B** - From DALI controller (by others)
- C** - Data +
- D** - Data -
- E** - To fixture
- F** - Line
- G** - Ground
- H** - Neutral
- I** - Wire-nuts (by others)
- J** - Junction box (by others)

- Consult factory for specific applications and maximum fixture count/cable length recommendations.
- Maximum of 64 DALI fixtures per DALI loop.
- 1% minimum dimming value.
- ASHRAE version (not available for 305 mm fixture lengths): 16.4 W/m; Regular Output version: 27.89 W/m; High Output version: 50.03 W/m.

Lutron® EcoSystem® Enabled dimming (ES)

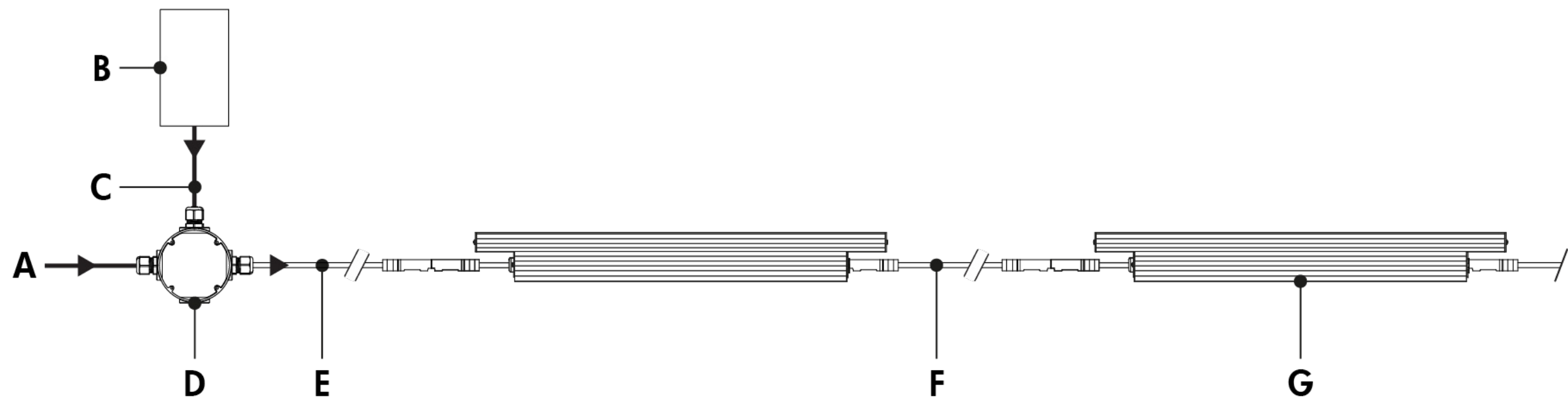

- A** - Power input (100-277V, wiring by others)
- B** - Lutron® EcoSystem® controller (by others)
- C** - Data wiring (by others)
- D** - Junction box (by others)
- E** - Leader cable (LOGiLC)
- F** - Jumper cable (LOGiJC) (optional)
- G** - Lumenfacade Interior (610 mm, 914 mm or 1219 mm fixture lengths)

Lutron® EcoSystem® Enabled dimming (ES) - wiring detail

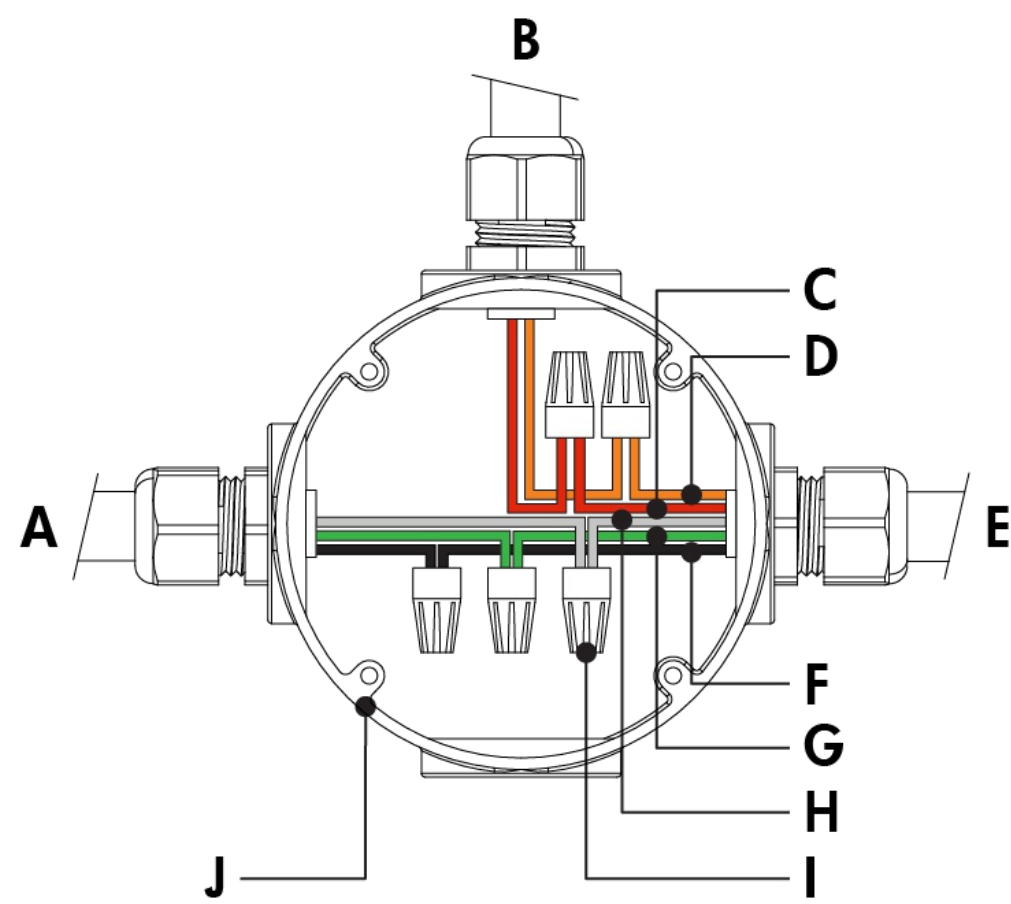

- A** - Power input
- B** - From Lutron® EcoSystem® controller (by others)
- C** - Data +
- D** - Data -
- E** - To fixture
- F** - Line
- G** - Ground
- H** - Neutral
- I** - Wire-nuts (by others)
- J** - Junction box (by others)

- Consult factory for specific applications and maximum fixture count/cable length recommendations.
- Each Lutron® EcoSystem® enabled fixture has its own address; for the example shown, there are a total of 2 EcoSystem® addresses.
- 1% minimum dimming value.
- ASHRAE version (not available for 305 mm fixture lengths): 16.4 W/m; Regular Output version: 27.89 W/m; High Output version: 50.03 W/m.

Star Layout (DMX/RDM)

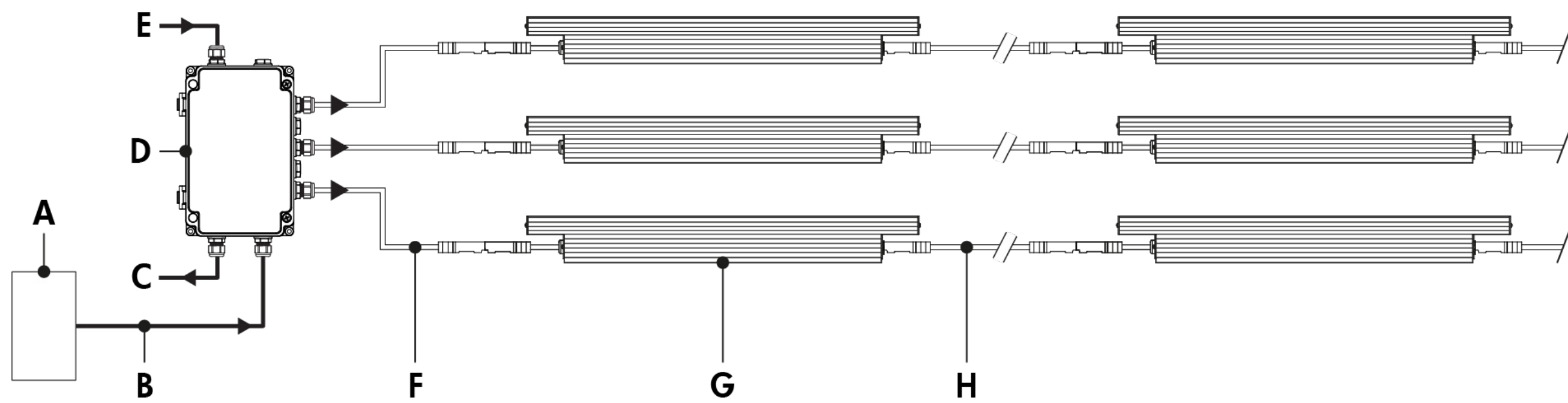

- A** - DMX/RDM controller (order separately from Lumenpulse, or by others)
- B** - Data input (Belden 9841 or equivalent, by others)
- C** - Data output to next CBX (optional, not isolated/not boosted)
- D** - CBX-ST
- E** - Power input (100-277V, wiring by others)
- F** - Leader cable (LOGiLC)
- G** - Lumenfacade Interior
- H** - Jumper cable (LOGiJC) (optional)

Daisy Chain Layout (DMX/RDM)

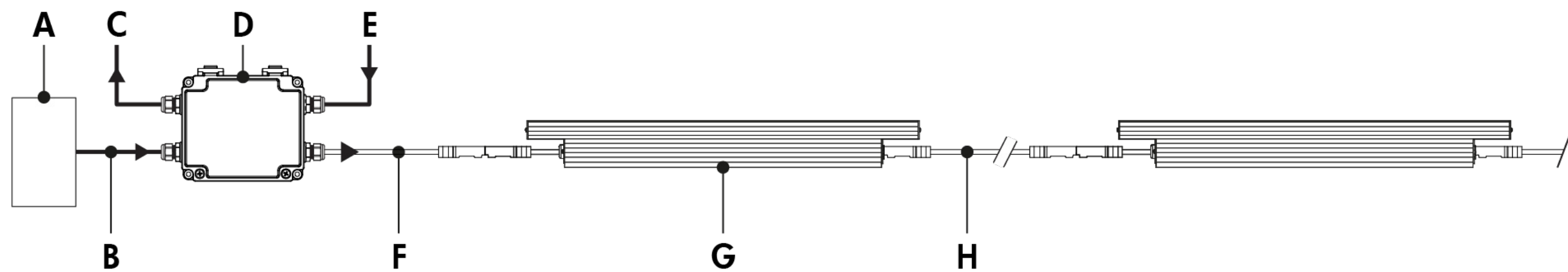

- A** - DMX/RDM controller (order separately from Lumenpulse, or by others)
- B** - Data input (Belden 9841 or equivalent, by others)
- C** - Data output to next CBX (optional, not isolated/not boosted)
- D** - CBX-DS
- E** - Power input (100-277V, wiring by others)
- F** - Leader cable (LOGiLC)
- G** - Lumenfacade Interior
- H** - Jumper cable (LOGiJC) (optional)

Maximum run length

Configuration/Voltage	120V	240V	277V
LOGi HO	21m	23m	26m
LOGi RO	37m	39m	39m
LOGi ASHRAE	39m	39m	39m

Based on 15A maximum, 15.2 m leader cable.

- Consult CBX installation instructions for additional wiring details.
- Consult factory for specific applications and maximum fixture count/cable length recommendations. Maximum run length calculations are typically based on 1219 mm fixtures.
- The DMX/RDM protocol states a maximum of 32 DMX/RDM enabled fixtures on any single run.
- Maximum of 4 DMX/RDM repeaters/CBX cascading in line.
- Maximum of 6 outputs per CBX-ST; maximum of 1 output per CBX-DS.
- Each fixture requires 1 DMX address.
- 1% minimum dimming value.
- ASHRAE version (not available for 305 mm fixture lengths): 16.4 W/m; Regular Output version: 27.89 W/m; High Output version: 50.03 W/m.

How to order							
1	2	3	4	5	6	7	8

1 . Housing ⁽¹⁾	
LOGi ASHRAE	Lumenfacade™ Interior, 16.4 W/m, ASHRAE compliant ⁽²⁾
LOGi RO	Lumenfacade™ Interior Regular Output, 27.89 W/m
LOGi HO	Lumenfacade™ Interior High Output, 50.03 W/m
⁽¹⁾ Power consumption is typically 20% higher for 305 mm fixture lengths.	
⁽²⁾ ASHRAE version not available for 305 mm fixture lengths.	

2 . Voltage	
100	100 volts
120	120 volts
208	208 volts
220	220 volts
240	240 volts
277	277 volts
3 . Length	
12	314 mm (0.95 kg) ⁽¹⁾ ⁽²⁾
24	619 mm (1.68 kg)
36	924 mm (2.4 kg)
48	1229 mm (3.08 kg)
⁽¹⁾ Power consumption is typically 20% higher for 305 mm fixture lengths.	
⁽²⁾ To connect 305 mm fixture lengths to the Lumentalk system, DIM or DMX/RDM must be specified as the control option, and a Lumentalk Data Bridge (LDB) is required. See the typical wiring diagrams in the specification sheet for details.	

4 . Colour and Colour Temperature ⁽¹⁾	
22K	2200K
27K	2700K
30K	3000K
35K	3500K
40K	4000K
RD	Red ⁽²⁾
GR	Green ⁽²⁾
BL	Blue ⁽²⁾
⁽¹⁾ Consult factory for availability of static Royal Blue, 6500K and 90+ CRI.	
⁽²⁾ Static colours made to order 8-10 weeks.	

5 . Optics	
WWLF	Asymmetric Wallwash, left feed
WWRF	Asymmetric Wallwash, right feed
8x8	8° x 8° ⁽¹⁾
10x10	10° x 10° ⁽¹⁾
10x30	10° x 30°
10x60	10° x 60°
10x90	10° x 90°
15x25	15° x 25°
30x30	30° x 30°
30x60	30° x 60°
35x35	35° x 35°
50x80	50° x 80°
60x60	60° x 60°
80x80	80° x 80°
90x90	90° x 90°
⁽¹⁾ For best results use with HO fixtures at a 6 in setback from surface. Contact factory for application support.	

6 . Mounting Options

SAM	Slim Adjustable Mounting
UMP	Fixed Mounting
UMAS	Universal Adjustable Mounting
WAM2	Adjustable Wall Mounting 51 mm
WAM6	Adjustable Extended Arm Mounting 152 mm
WAM12	Adjustable Extended Arm Mounting 305 mm
WAM18	Adjustable Extended Arm Mounting 457 mm

8 . Control

NO	On/Off control
LT	Lumentalk ⁽¹⁾ ⁽²⁾
DIM	0-10V dimming
DALI	DALI dimming
ES	Lutron® EcoSystem® Enabled dimming ⁽³⁾
DMX/RDM	DMX/RDM enabled ⁽⁴⁾

⁽¹⁾ To connect 305 mm fixture lengths to the Lumentalk system, DIM or DMX/RDM must be specified as the control option, and a Lumentalk Data Bridge (LDB) is required. See the typical wiring diagrams in the specification sheet for details.

⁽²⁾ A Lumentranslator and LumentalkID (LIDLT) must be specified for Lumentalk applications. Consult Lumentranslator and Lumentalk pages and specification sheets for details.

⁽³⁾ Available for 610 mm, 914 mm and 1219 mm fixture lengths only.

⁽⁴⁾ A control box (CBX) and LumenID (LID) must be specified.

7 . Finish

BK	Black Sandtex®
BRZ	Bronze Sandtex®
SI	Silver Sandtex®
WH	Smooth white
CC	Custom colour and finish (please specify RAL colour) ⁽¹⁾

⁽¹⁾ Lumenpulse offers a wide selection of RAL CLASSIC (K7) colours with a smooth texture and high-gloss finish. Please consult factory for a list of available K7 colours, other RAL textures and glosses, or to match alternate colour charts. Final colour matching results may vary.