

Project Name

Qty

Type

Catalog / Part Number

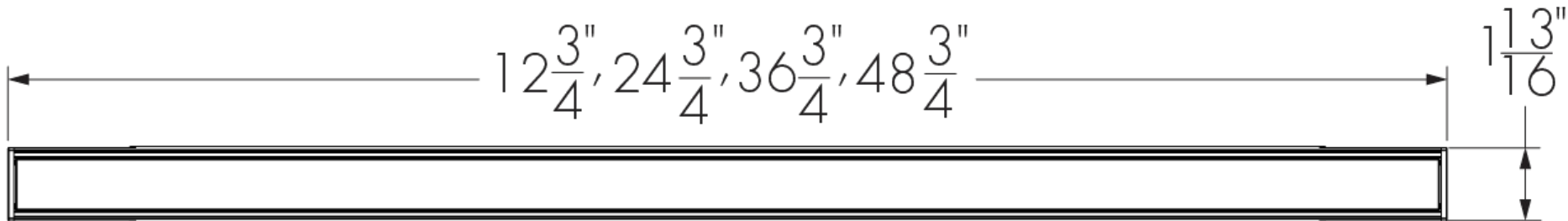

Top view

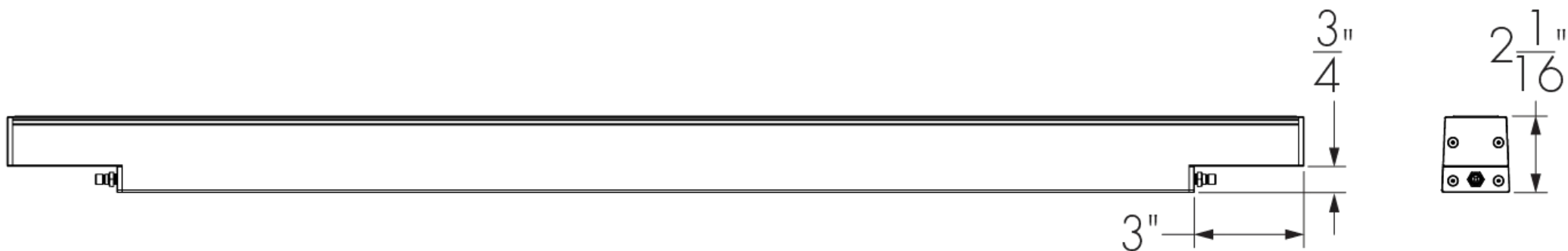

Front and side views

Photometric Summary

4ft, 4 W/ft, 4000K	Delivered output (lm)	Intensity (peak cd)
8°x8°	1,530	41,352
10°x10°	1,456	32,262
10°x30°	1,435	9,126
10°x60°	1,427	4,867
10°x90°	1,424	2,551
30°x10°	1,439	9,098
30°x30°	1,767	4,079
30°x60°	1,713	2,581
30°x90°	1,726	1,865
60°x10°	1,426	5,647
60°x60°	1,730	1,279
60°x90°	1,719	1,540
90°x90°	1,690	1,045
W (120°)	864	N/A
WW	1,524	7,393

Photometric performance is measured in compliance with IESNA LM 79-08.

Optics

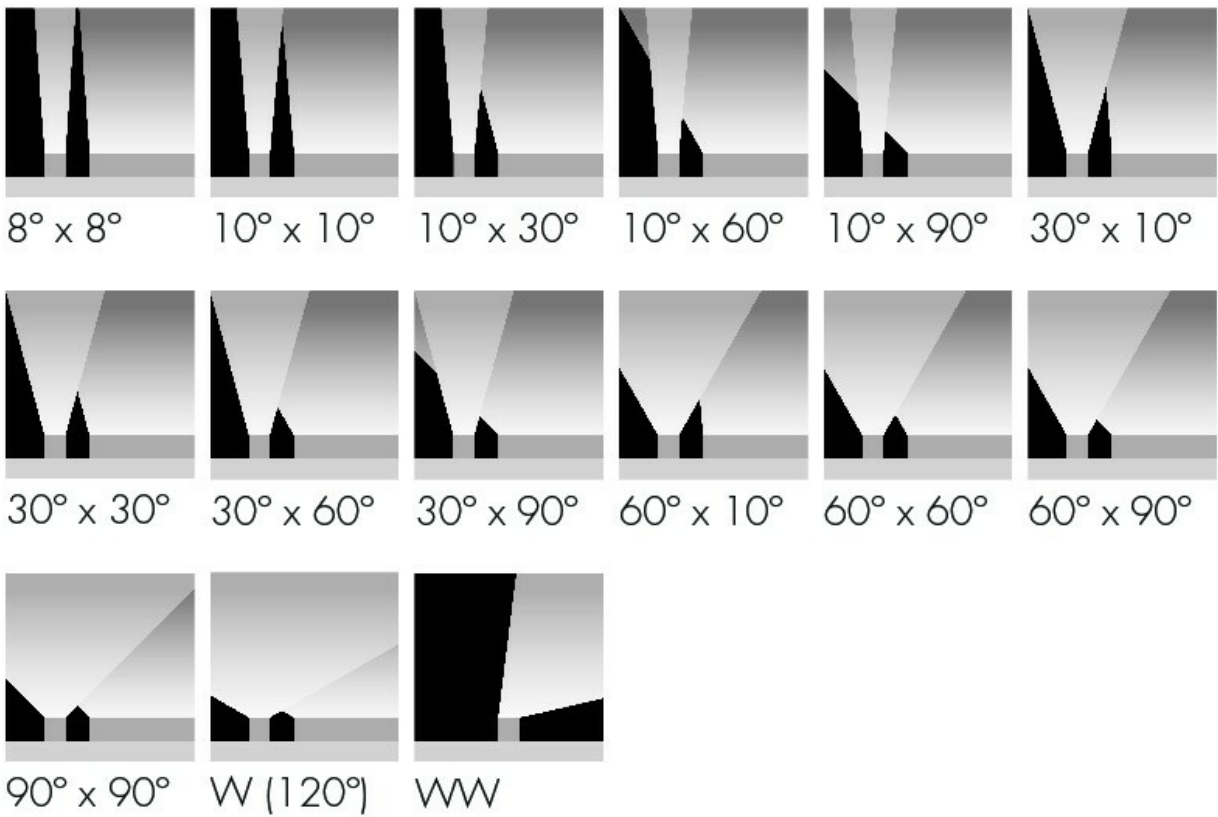

Description

The Lumenfacade Nano White and Static Colors is a high-efficiency linear LED luminaire that goes where no facade lighting has gone before. Available in 12 in, 24 in, 36 in or 48 in sections, the Lumenfacade Nano is the right fit for general urban structures, historical buildings and those hardest to reach places. The Lumenfacade Nano packs all the bells and whistles of the larger members of the Lumenfacade family and can be configured with a wide number of options, including: optics for grazing, floodlighting or wall washing; a choice of outputs; various color temperatures or static colors; various mounting options, finishes, accessories and controls. The Lumenfacade Nano is also available with a unique asymmetric distribution, providing exceptional uniformity and brightness for walls and signage.

Features

Color and Color Temperature	2200K, 2700K, 3000K, 3500K, 4000K, Red, Green, Blue
Length (nominal)	12 in, 24 in, 36 in, 48 in
Optics	8° x 8°, 10° x 10°, 10° x 30°, 10° x 60°, 10° x 90°, 30° x 10°, 30° x 30°, 30° x 60°, 30° x 90°, 60° x 10°, 60° x 60°, 60° x 90°, 90° x 90°, Wide 120°, Asymmetric Wallwash
Options	Corrosion-resistant coating for hostile environments
Power Consumption	2 W/ft, 4 W/ft
Warranty	5-year limited warranty

Colors and Color Temperatures

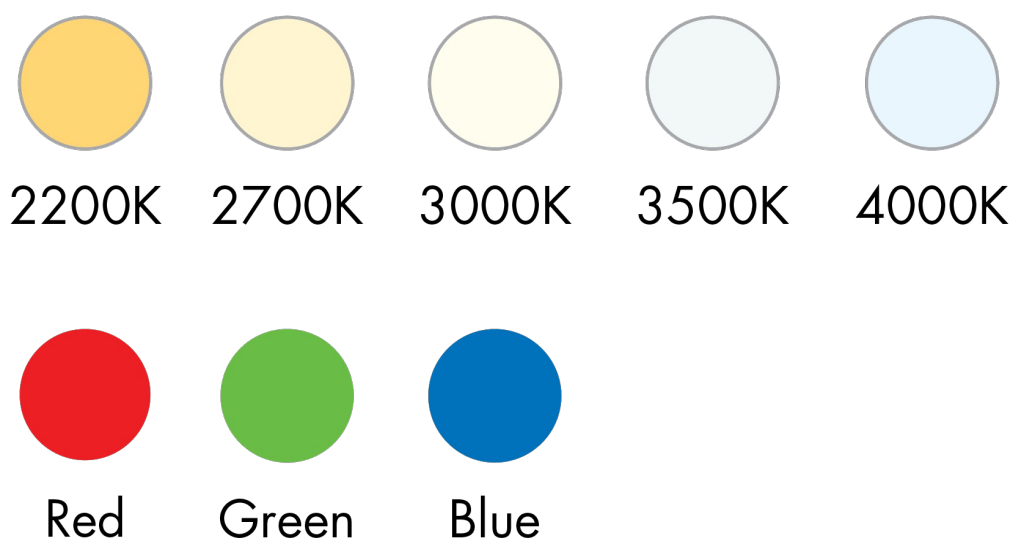

Controls

ON/OFF  DMXrdm

Ratings

IP66 IK08

Certifications



Performance

Delivered Output	884 lm (2 W/ft, 48 in fixture, 4000K, 30° x 30°, DMX/RDM), 1,767 lm (4 W/ft, 48 in fixture, 4000K, 30° x 30°, DMX/RDM)
Delivered Intensity	20,676 cd at nadir (2 W/ft, 48 in fixture, 4000K, 8° x 8°, DMX/RDM), 41,352 cd at nadir (4 W/ft, 48 in fixture, 4000K, 8° x 8°, DMX/RDM)
Illuminance at Distance	Minimum 1 fc at 144 ft (2 W/ft, 48 in fixture, 4000K, 8° x 8°, DMX/RDM), Minimum 1 fc at 203 ft (4 W/ft, 48 in fixture, 4000K, 8° x 8°, DMX/RDM)
Color Consistency	3 SDCM (2 SDCM for 8° x 8°, 10° x 10°, 10° x 30°, 10° x 60°, 10° x 90°, 30° x 10°, 60° x 10°, W and WW optics)
Color Rendering	CRI 80+
Lumen Maintenance	L70 >90,000 hrs

Physical

Housing Material	Low copper content extruded aluminum
Lens Material	Clear tempered glass
Hardware Material	Stainless steel
End Cap Material	Machined aluminum
Gasket Material	Silicone
Surface Finish	Electrostatically applied polyester powder coat
Weight	1.4 lbs (12 in), 2.9 lbs (24 in), 4.4 lbs (36 in), 6 lbs (48 in)

Electrical and control

Voltage	48 VDC
Resolution (DMX/RDM)	Per fixture, 8-bit or 16-bit
Control	On/Off control, DMX/RDM enabled (compatible with 0-10V or DMX/RDM systems)

Environmental

Storage Temperature	-58 °F to 185 °F (device must reach start-up temperature value before operating)
Start-up Temperature	-13 °F to 122 °F
Operating Temperature	-40 °F to 122 °F
Ingress Protection Rating	IP66
Impact Resistance Rating	IK08 (IK09 for 48 in fixtures)



Accessories (order separately)

Cables	Lumenfacade Nano Jumper Cable, Trunk Power Cable, Trunk Data Cable
Control Boxes	Low-Voltage Control Box, Low-Voltage Splitter Box
Optical Accessories	Lumenfacade Nano Radial Louver, Lumenfacade Nano Visor
Control Systems	Lumentouch 2.0™, Lumentone™ 2 , Lumencue, Pharos® kit
Diagnostic and Addressing Tools	LumenID

Optical option installation details

HFR - Half-frosted lens



- Always position frosted side toward the wall.
- Applicable for 8° x 8°, 10° x 10° or asymmetric wallwash optics only.

WW - Asymmetric wallwash

Recommended setback from wall is 1/10 of the wall height.

Example: 2 ft setback for a 20 ft wall.

Mounting option

One mounting bracket provided for 12 in fixtures. Two mounting brackets provided for 24 in, 36 in and 48 in fixtures. See installation instructions for details.

SAMN - Slim Adjustable Mounting Nano

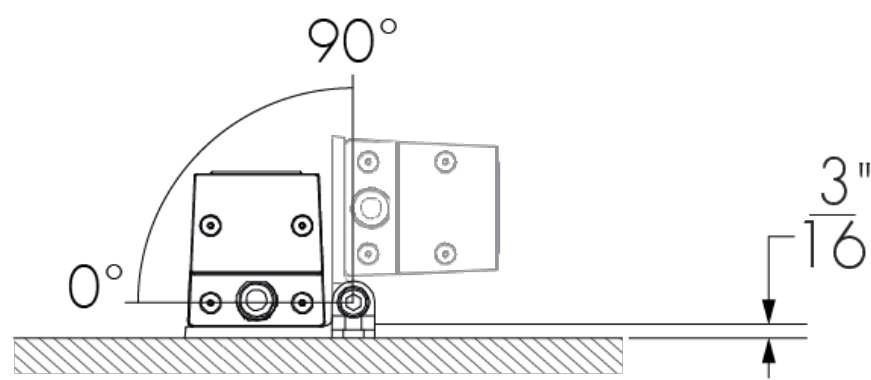

UMPN - Fixed Mounting Nano

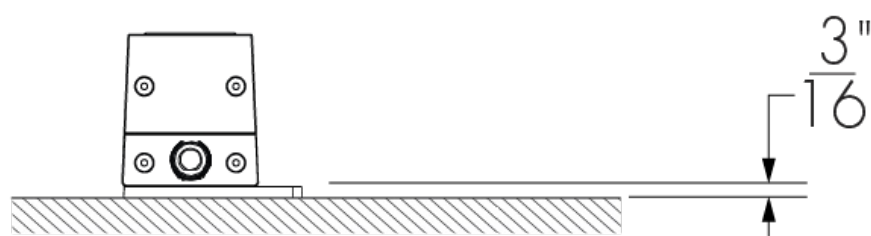

SAMN - Mounting hole pattern

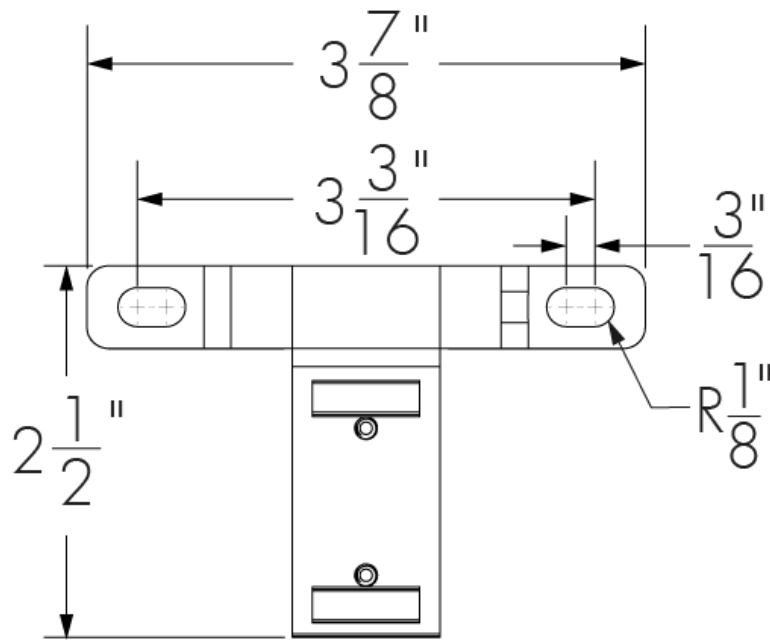

UMPN - Mounting hole pattern

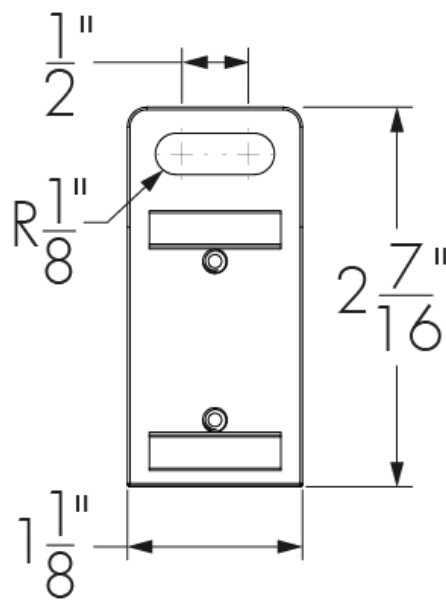

UMASN - Universal Adjustable Mounting Nano

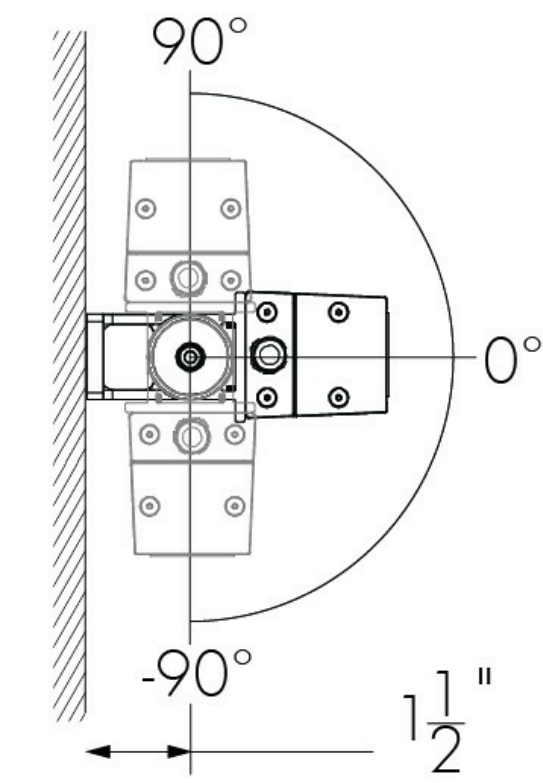

UMASN - Mounting hole pattern

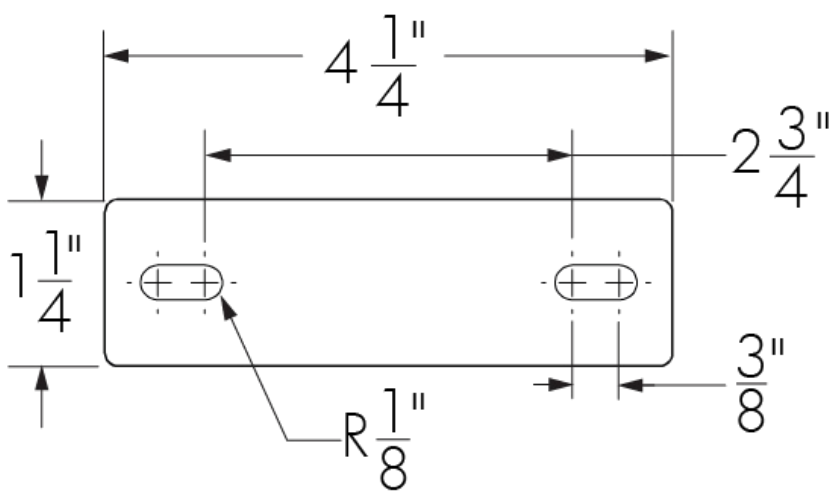

For 1 ft fixtures

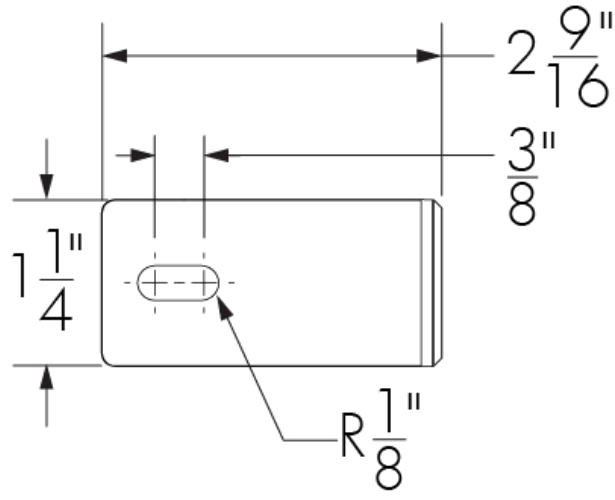

For 2 ft, 3 ft and 4 ft fixtures

WAMN2 - Adjustable Extended Arm Mounting Nano 2 in

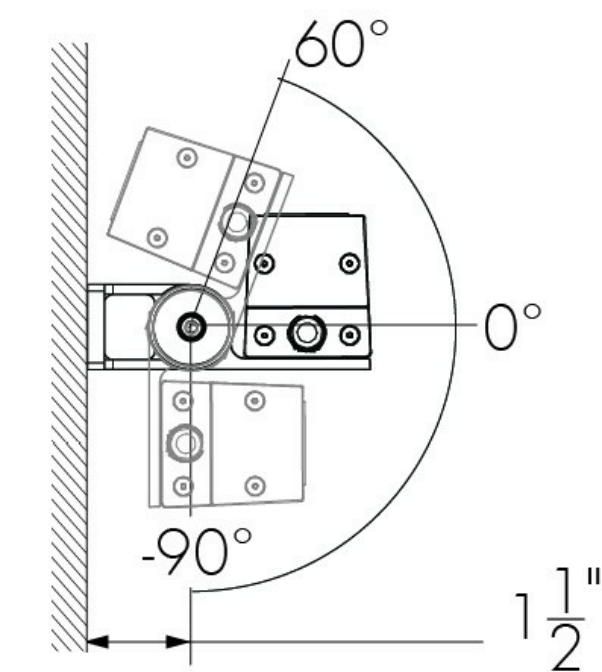

WAMN2 - Mounting hole pattern

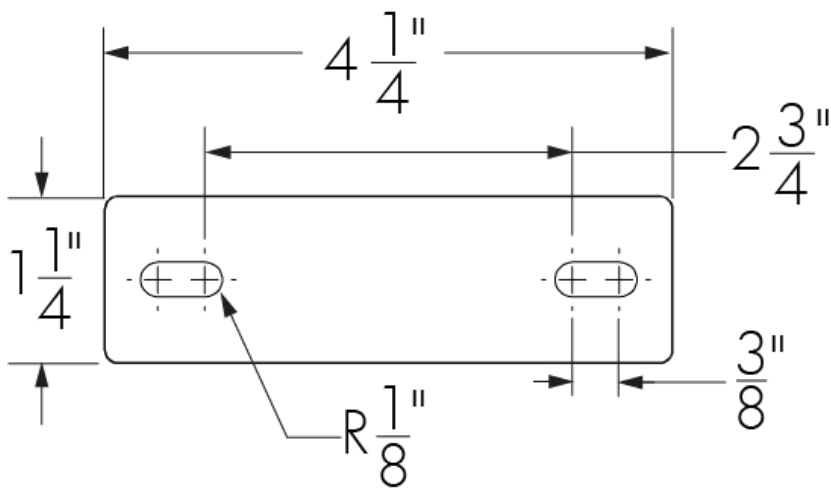

For 1 ft fixtures

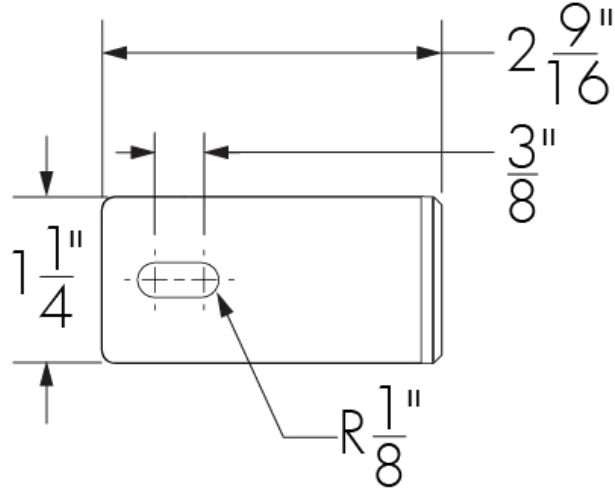

For 2 ft, 3 ft and 4 ft fixtures

WAMN6 - Adjustable Extended Arm Mounting Nano 6 in

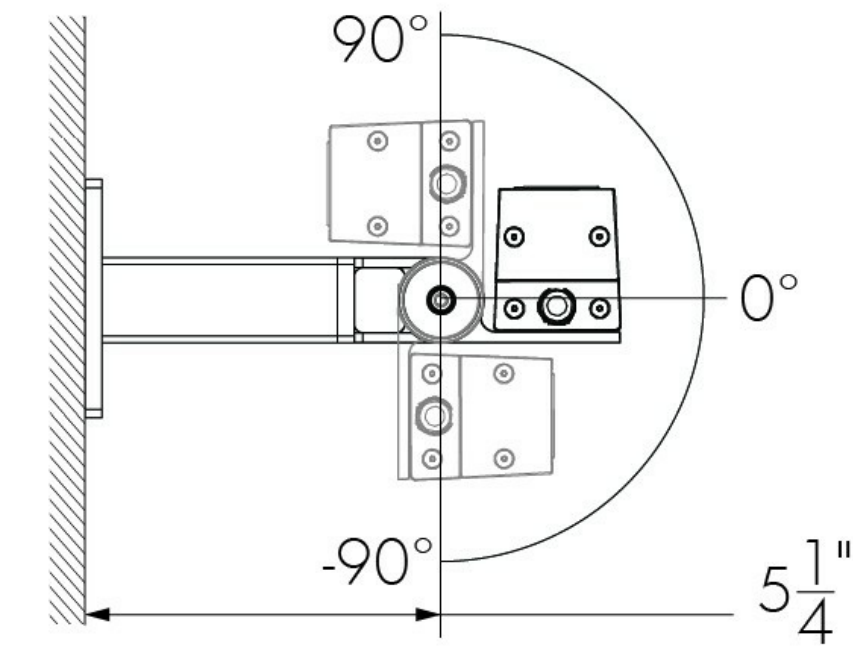

WAMN6 - Mounting hole pattern

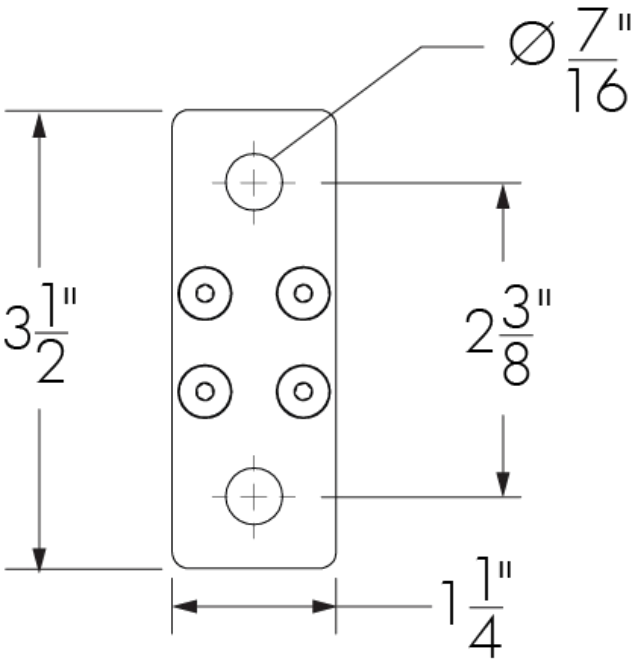

WAMN12 - Adjustable Extended Arm Mounting Nano 12 in

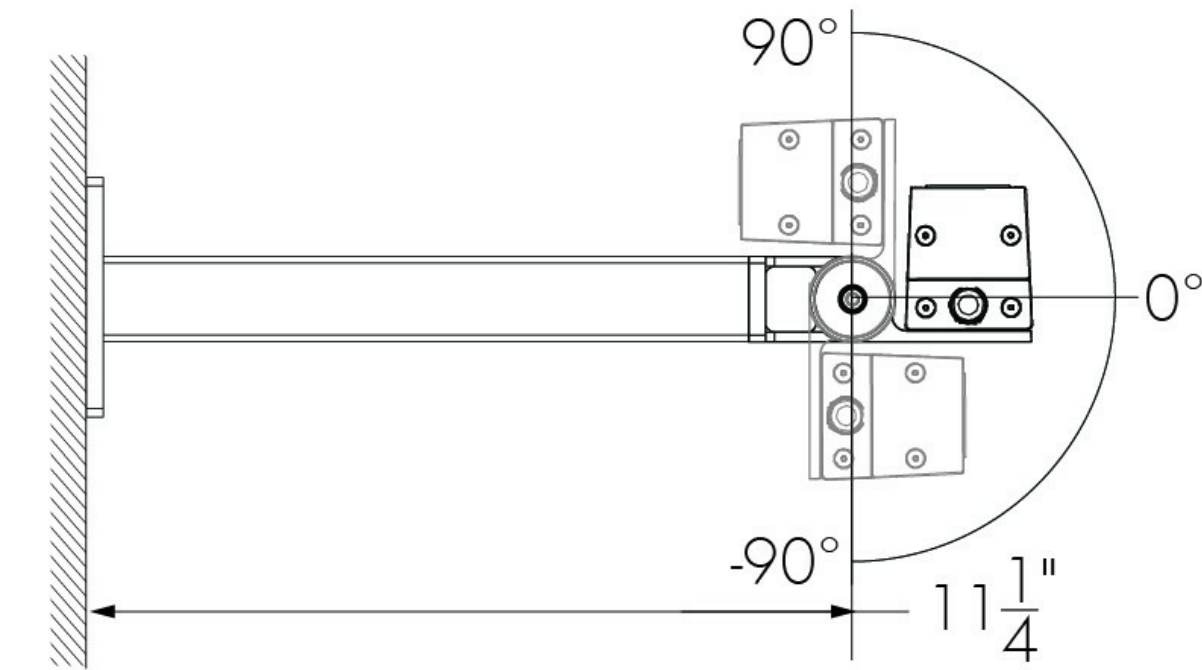

WAMN12 - Mounting hole pattern

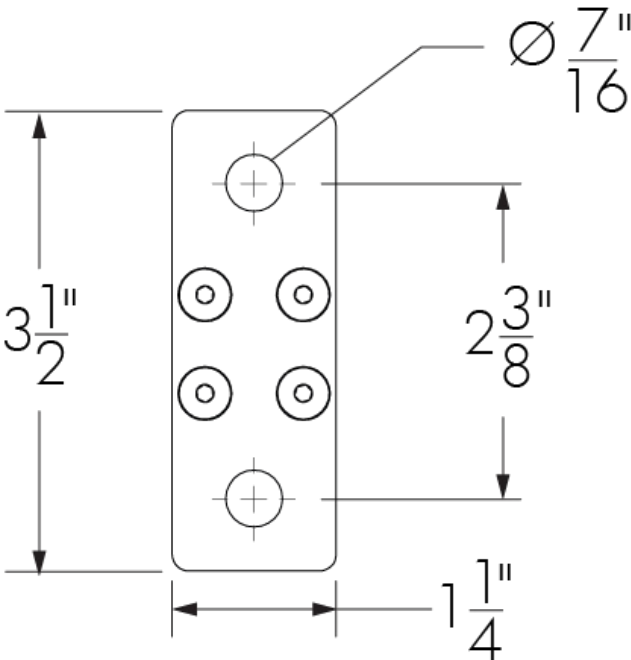

WAMN18 - Adjustable Extended Arm Mounting Nano 18 in

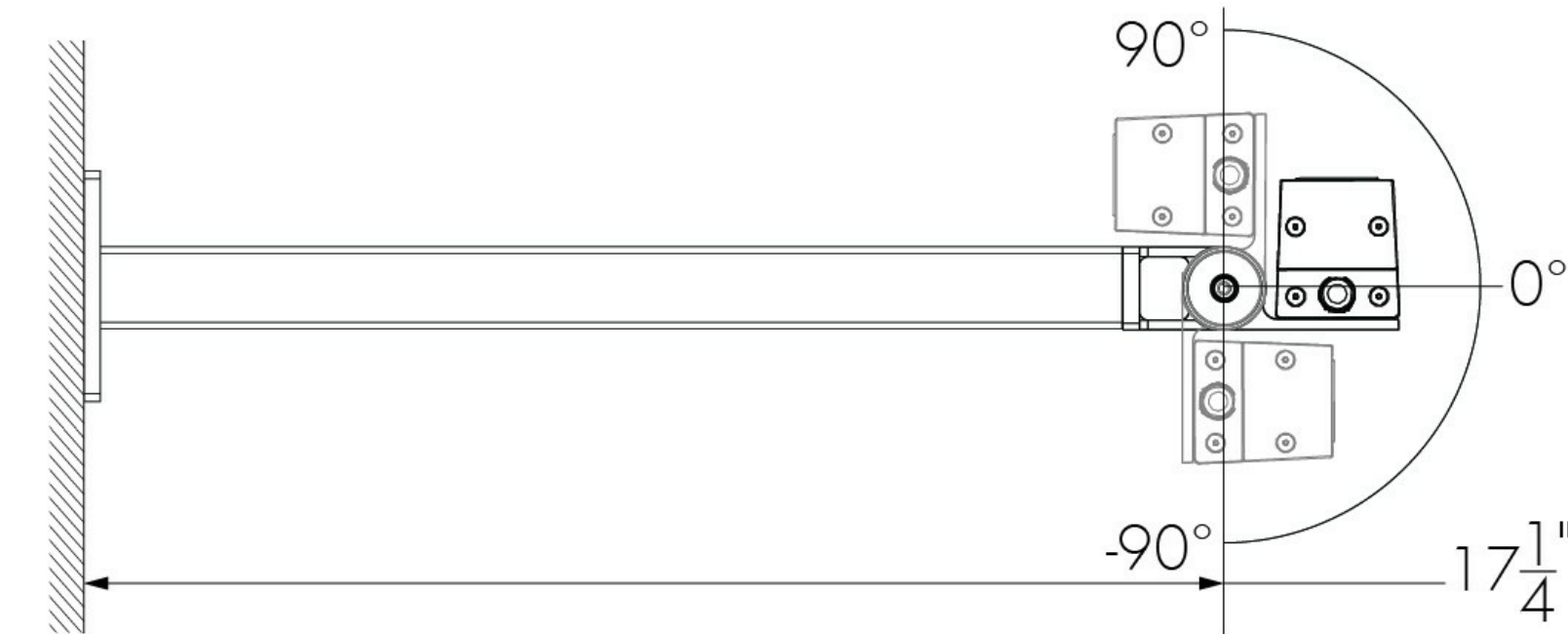

WAMN18 - Mounting hole pattern

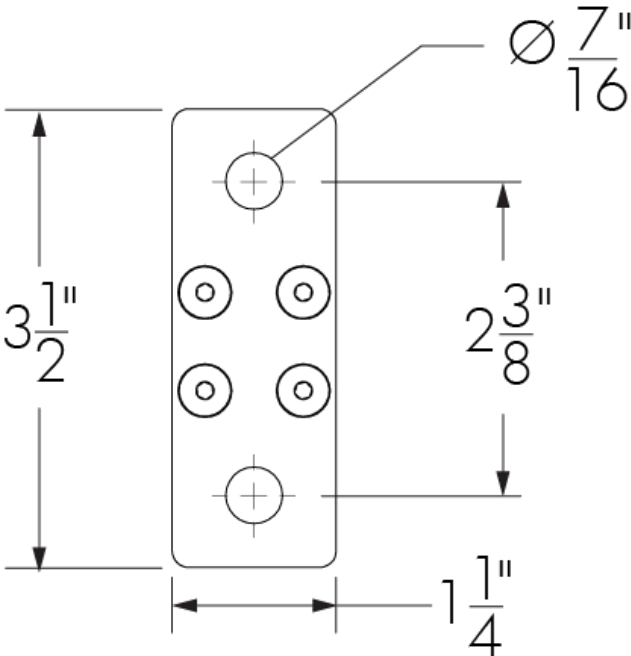



Optical accessories (order separately)

LOGNRD - Radial louver for Lumenfacade Nano

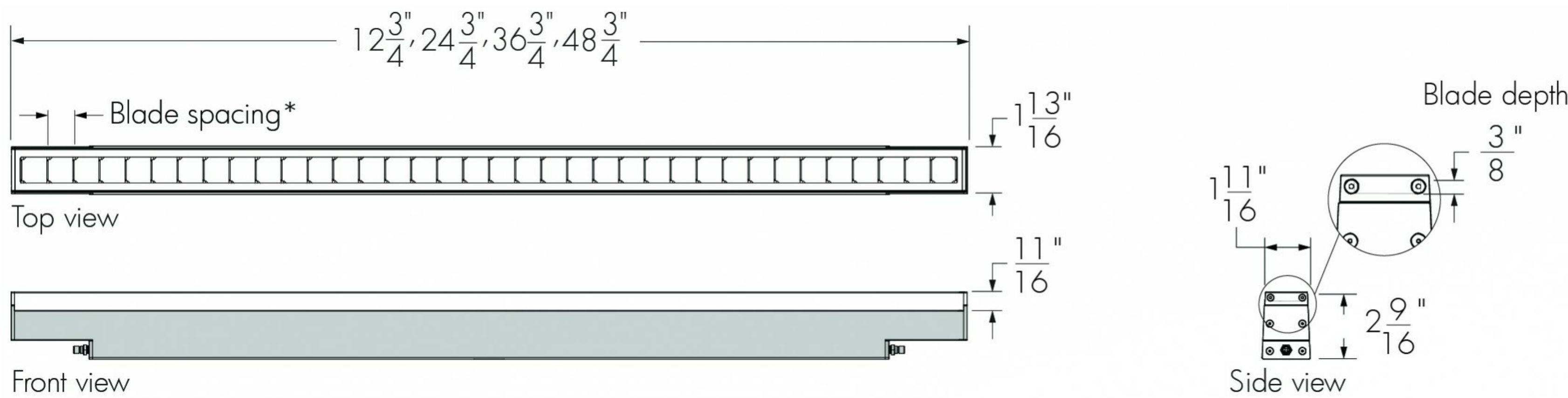

\*15/16 in blade spacing for 8° x 8°, 10° x 10°, 10° x 30°, 10° x 60°, 10° x 90°, 30° x 10° and 60° x 10° optics.  
\*1 15/16 in blade spacing for 30° x 30°, 30° x 60°, 30° x 90°, 60° x 60°, 60° x 90° and 90° x 90° optics.

LOGNRD-LENGTH-FINISH-OPTIONS

Please specify:

**LENGTH:** 12 in, 24 in, 36 in or 48 in; **FINISH:** BK - Black Sandtex®, BRZ - Bronze Sandtex®, SI - Silver Sandtex®, WH - Smooth white or CC - custom color and finish (please specify RAL color); **OPTIONS:** CRC - Corrosion-resistant coating for hostile environments

- The addition of a louver will affect beam distribution. Consult factory for application support.
- Not suitable for wide 120° and asymmetric wallwash optics.
- Maximum one accessory per fixture. Louvers are field installable.

LOGNVS - Visor for Lumenfacade Nano

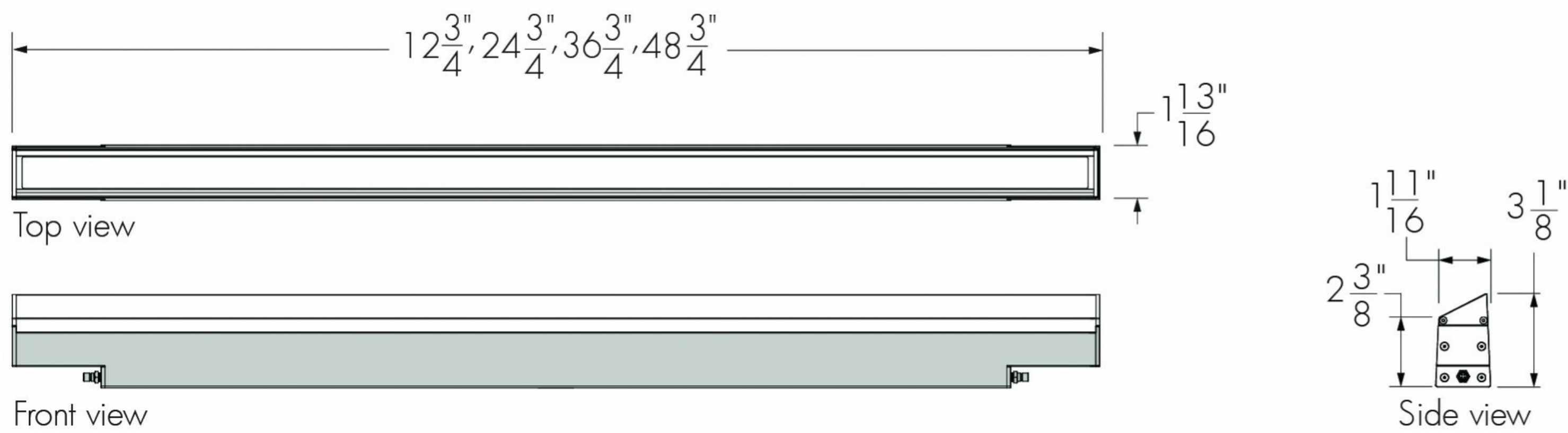

LOGNVS-LENGTH-FINISH-OPTIONS

Please specify:

**LENGTH:** 12 in, 24 in, 36 in or 48 in; **FINISH:** BK - Black Sandtex®, BRZ - Bronze Sandtex®, SI - Silver Sandtex®, WH - Smooth white or CC - custom color and finish (please specify RAL color); **OPTIONS:** CRC - Corrosion-resistant coating for hostile environments

- The addition of a visor will affect beam distribution. Consult factory for application support.
- Not suitable for wide 120° optic.
- Maximum one accessory per fixture. Visors are field installable.

Cables (order separately)

LOGNJC - Jumper cable for Lumenfacade Nano



LOGNJC-CERTIFICATION-LENGTH-CABLE COLOR-OPTION

Please specify:

**CERTIFICATION:** UL or CE; **LENGTH:** 1 ft to 30 ft (available in 1 ft increments) or 50 ft; **CABLE COLOR:** black or white (connectors are the same color as the specified cable color); **OPTION:** Master (To identify the jumper cable connecting the LCBX or LSBX to the first Lumenfacade Nano fixture, specify the Master option when ordering master jumper cables. The Master option does not need to be specified for jumper cables connecting Lumenfacade Nano fixtures together.)

- Suitable for dimming/data and non-dimming applications.
- Consult Lumenfacade Nano jumper cable specification sheet for details.

Resolution details

Resolution per fixture: each fixture is addressed independently  
DMX addresses:

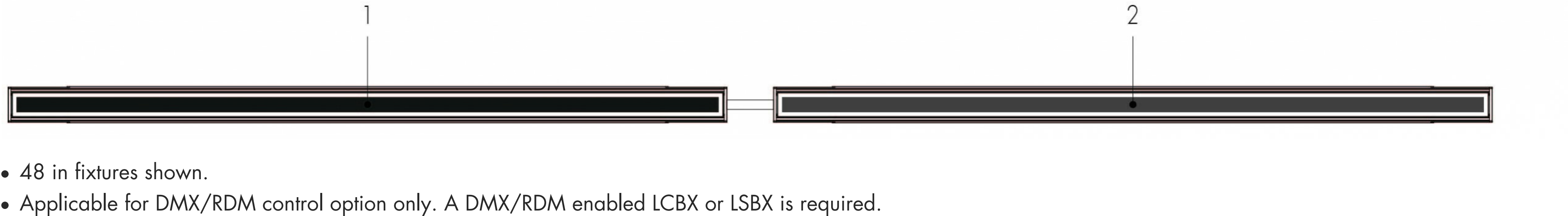



Typical wiring diagrams

On/Off control (NO)

Single unit - LCBX 60W



Continuous run - LCBX 60W or 120W

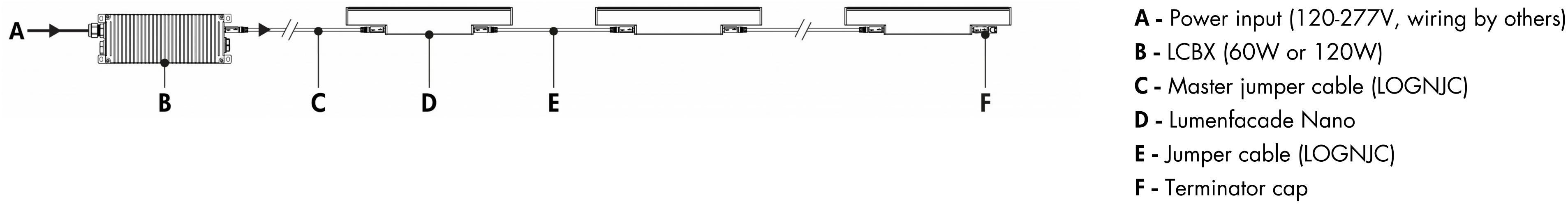

Continuous run - LCBX 200W

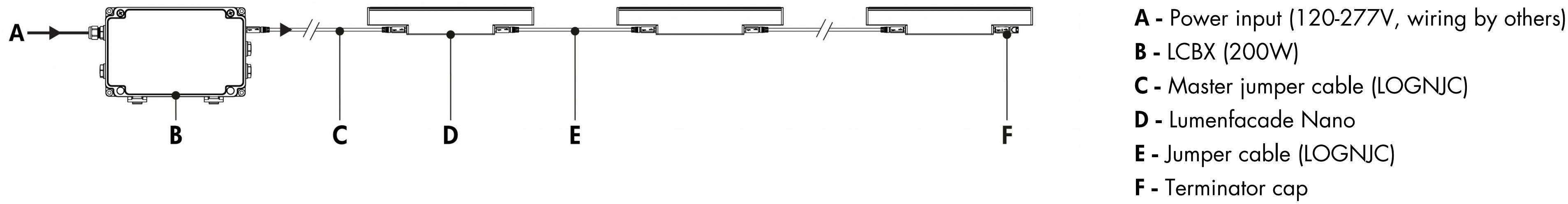

- Consult factory for specific applications and maximum fixture count/run length recommendations.
- For installations of 600W or more, consult factory to select the optimal system: either a daisy chain continuous run system with LCBXs or a trunk system with LSBXs.
- Maximum of 1 output to fixture, or fixture run, per LCBX.
- Consult the LCBX specification sheet for more information.
- 2W version: 2 W/ft; 4W version: 4 W/ft.

Trunk system - LSBX

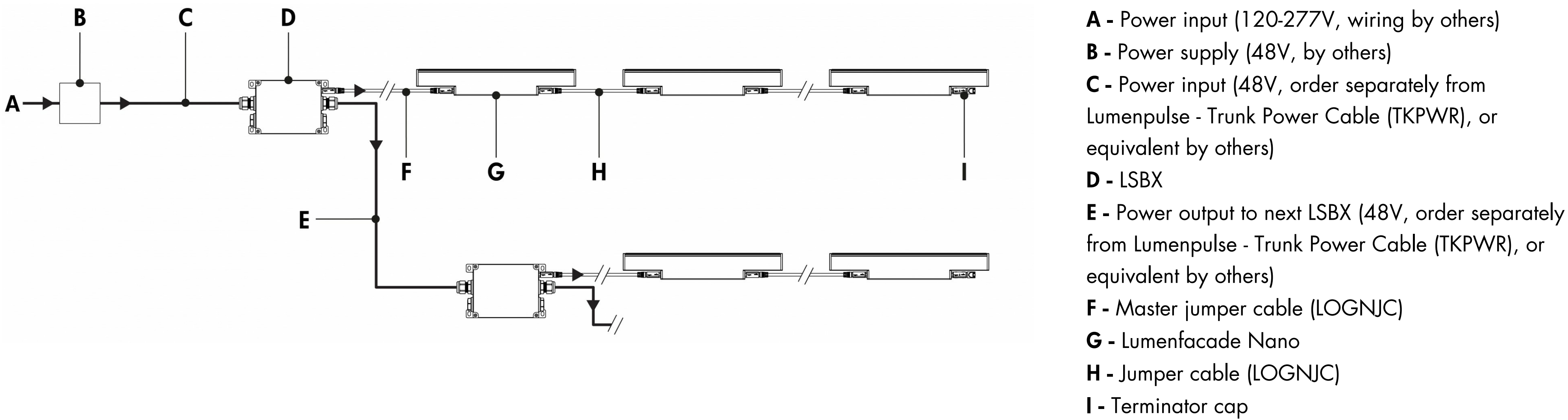

- Consult factory for specific applications and maximum fixture count/run length recommendations.
- For installations of 600W or more, consult factory to select the optimal system: either a daisy chain continuous run system with LCBXs or a trunk system with LSBXs.
- Maximum of 1 output to fixture run per LSBX.
- Consult the LSBX specification sheet for more information.
- Consult factory for power supply recommendations.
- 2W version: 2 W/ft; 4W version: 4 W/ft.



DMX/RDM

Single unit - LCBX 60W

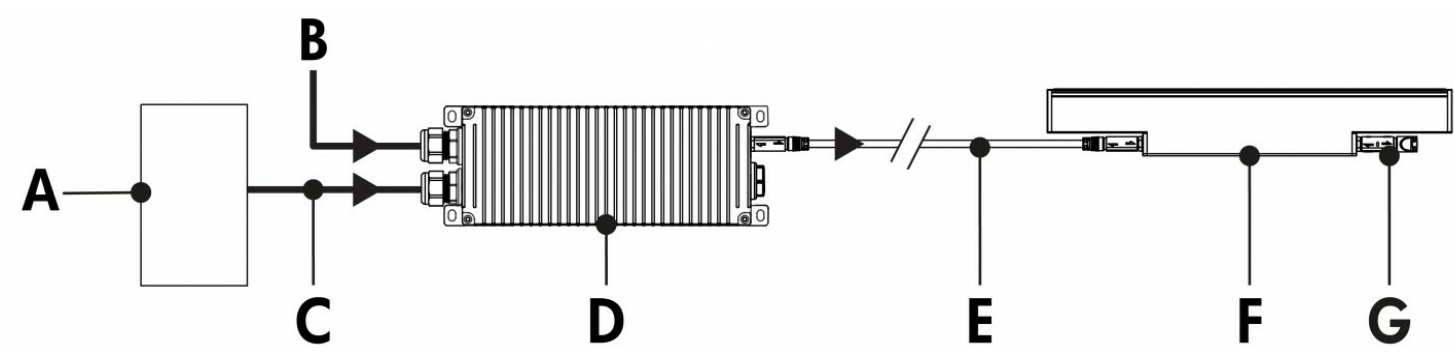

- A** - Dimmer/controller (order separately from Lumenpulse, or by others)
- B** - Power input (120-277V, wiring by others)
- C** - Data input (wiring by others)
- D** - LCBX (60W)
- E** - Master jumper cable (LOGNJC)
- F** - Lumenfacade Nano
- G** - Terminator cap

Continuous run - LCBX 60W or 120W

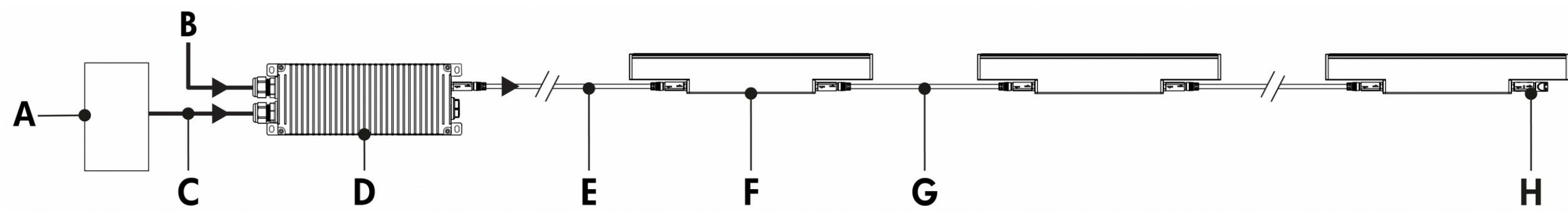

- A** - Dimmer/controller (order separately from Lumenpulse, or by others)
- B** - Power input (120-277V, wiring by others)
- C** - Data input (wiring by others)
- D** - LCBX (60W or 120W)
- E** - Master jumper cable (LOGNJC)
- F** - Lumenfacade Nano
- G** - Jumper cable (LOGNJC)
- H** - Terminator cap

Continuous run - LCBX 200W

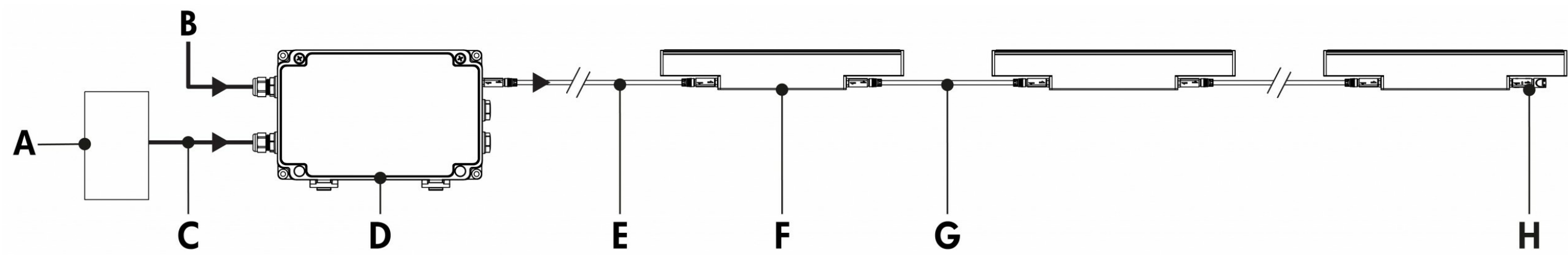

- A** - Dimmer/controller (order separately from Lumenpulse, or by others)
- B** - Power input (120-277V, wiring by others)
- C** - Data input (wiring by others)
- D** - LCBX (200W)
- E** - Master jumper cable (LOGNJC)
- F** - Lumenfacade Nano
- G** - Jumper cable (LOGNJC)
- H** - Terminator cap

Continuous run - Daisy chain  
LCBX 60W or 120W

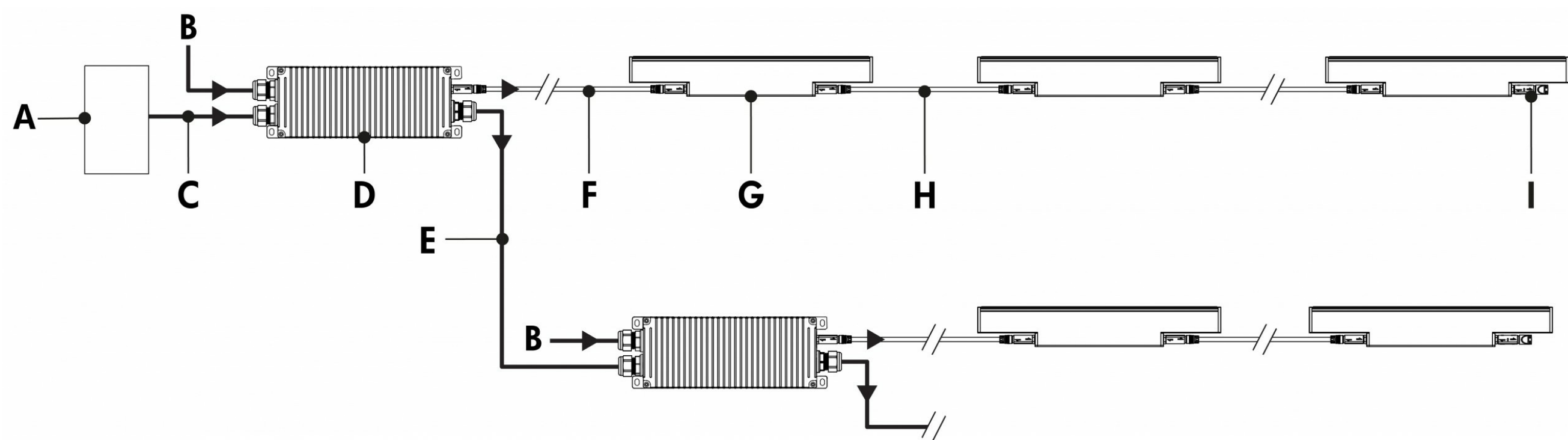

- A** - Dimmer/controller (order separately from Lumenpulse, or by others)
- B** - Power input (120-277V, wiring by others)
- C** - Data input (wiring by others)
- D** - LCBX (60W or 120W)
- E** - Data output to next LCBX (wiring by others)
- F** - Master jumper cable (LOGNJC)
- G** - Lumenfacade Nano
- H** - Jumper cable (LOGNJC)
- I** - Terminator cap

Continuous run - Daisy chain  
LCBX 200W

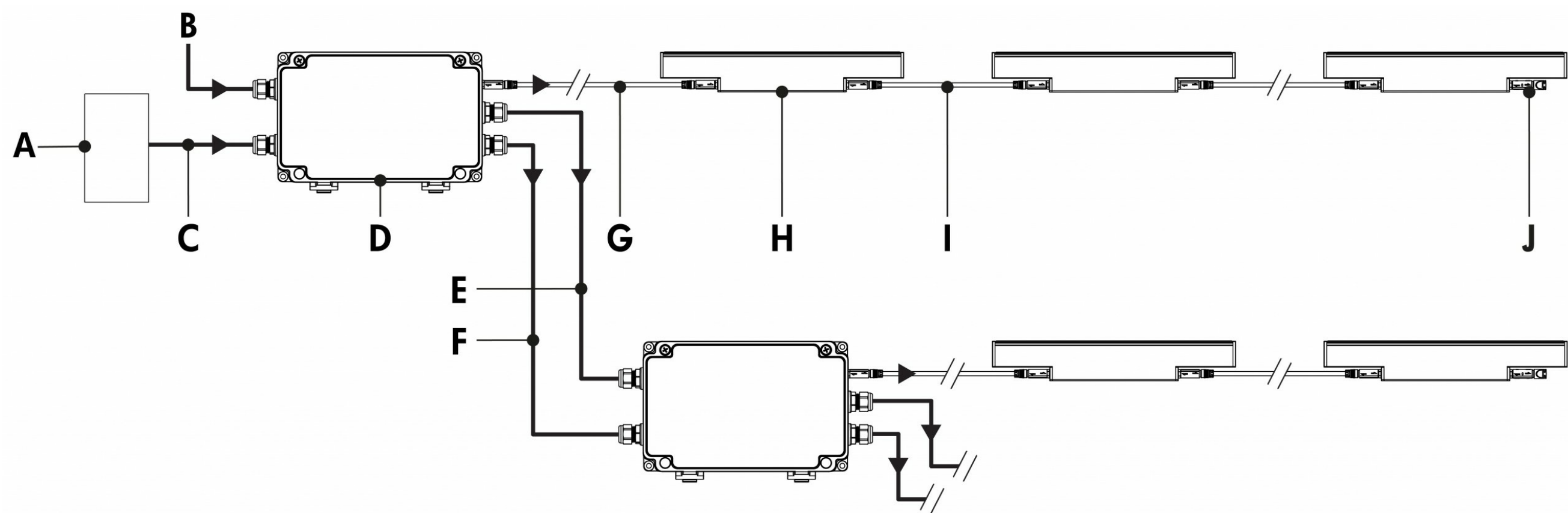

- A** - Dimmer/controller (order separately from Lumenpulse, or by others)  
**B** - Power input (120-277V, wiring by others)  
**C** - Data input (wiring by others)  
**D** - LCBX (200W)  
**E** - Power output to next LCBX (120-277V, wiring by others)  
**F** - Data output to next LCBX (wiring by others)  
**G** - Master jumper cable (LOGNJC)  
**H** - Lumenfacade Nano  
**I** - Jumper cable (LOGNJC)  
**J** - Terminator cap

Maximum run length per LCBX (Based on a 50 ft master jumper cable)		
Configuration	2 W/ft	4 W/ft
LCBX 60W	28 ft	12 ft
LCBX 120W	52 ft	24 ft
LCBX 200W	76 ft	40 ft

- Consult factory for specific applications and maximum fixture count/run length recommendations.
- For installations of 600W or more, consult factory to select the optimal system: either a daisy chain continuous run system with LCBXs or a trunk system with LSBXs.
- Maximum of 1 output to fixture, or fixture run, per LCBX.
- Consult the LCBX specification sheet for more information.
- Can be controlled via a 0-10V dimmer or DMX/RDM controller.
- For 0-10V dimming applications:
  - 0-10V mA ratings: Current Sink Mode: 25µA per LCBX; Current Source Mode: 2.5mA per LCBX.
- For DMX/RDM applications:
  - Each fixture requires 1 DMX channel.
  - A maximum of 128 DMX/RDM devices on the output port of the LCBX.
- 1% minimum dimming value.
- 2W version: 2 W/ft; 4W version: 4 W/ft.



Trunk system - LSBX

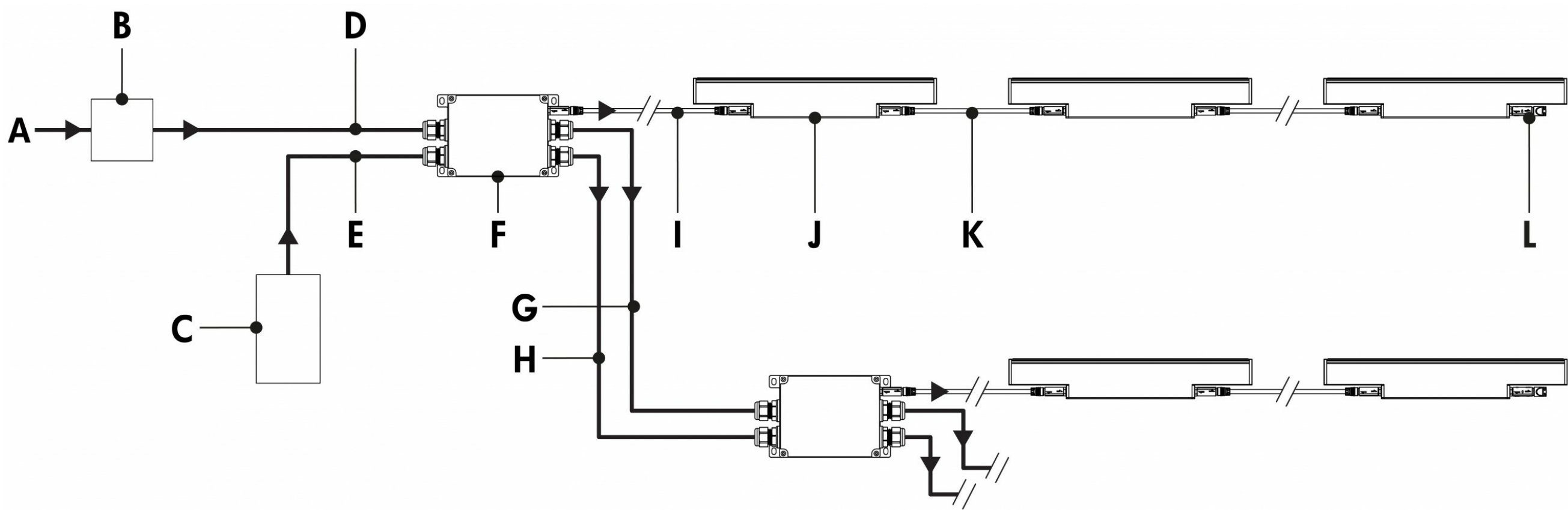

- A** - Power input (120-277V, wiring by others)
- B** - Power supply (48V, by others)
- C** - Controller (order separately from Lumenpulse, or by others)
- D** - Power input (48V, order separately from Lumenpulse - Trunk Power Cable (TKPWR), or equivalent by others)
- E** - Data input (order separately from Lumenpulse - Trunk Data Cable (TKDMX), or equivalent by others)
- F** - LSBX
- G** - Power output to next LSBX (48V, order separately from Lumenpulse - Trunk Power Cable (TKPWR), or equivalent by others)
- H** - Data output to next LSBX (order separately from Lumenpulse - Trunk Data Cable (TKDMX), or equivalent by others)
- I** - Master jumper cable (LOGNJC)
- J** - Lumenfacade Nano
- K** - Jumper cable (LOGNJC)
- L** - Terminator cap

- Consult factory for specific applications and maximum fixture count/run length recommendations.
- For installations of 600W or more, consult factory to select the optimal system: either a daisy chain continuous run system with LCBXs or a trunk system with LSBXs.
- A maximum of 128 DMX/RDM devices on the output port of the LSBX.
- Maximum of 1 output to fixture run per LSBX.
- Consult the LSBX specification sheet for more information.
- Consult factory for power supply recommendations.
- Each fixture requires 1 DMX channel.
- 1% minimum dimming value.
- 2W version: 2 W/ft; 4W version: 4 W/ft.

Accessories (order separately)

Control Boxes

LCBX-Low-Voltage Control Box

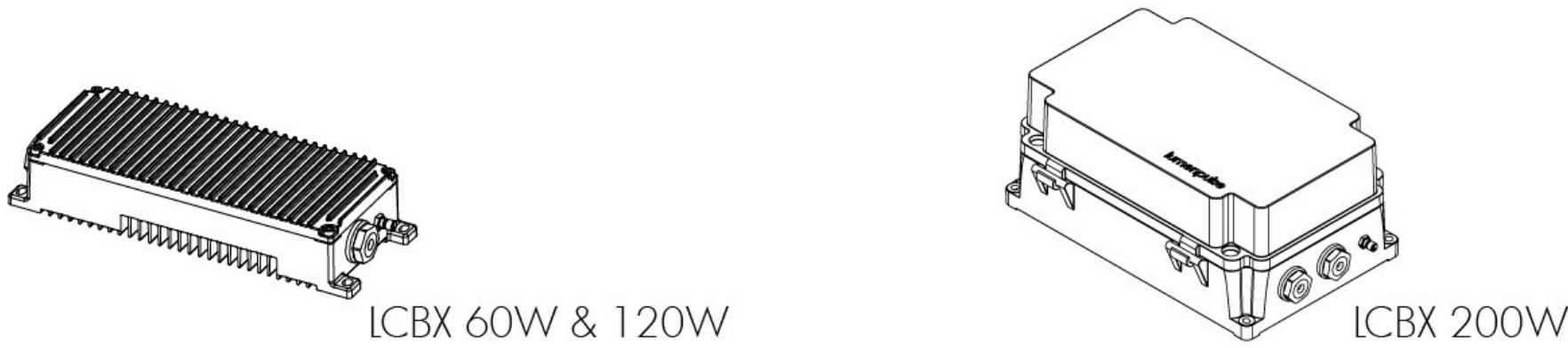

Low-voltage control and power box. One power and data output to fixture, or fixture run. Refer to LCBX specification sheet for details.

LSBX-Low-Voltage Splitter Box

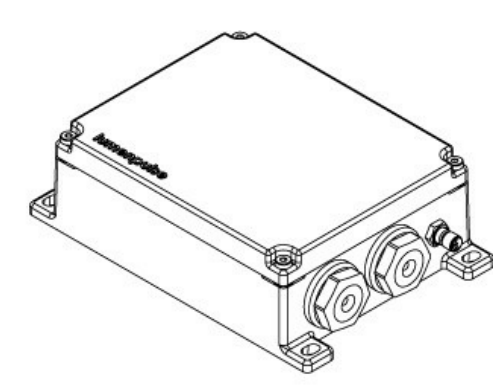

Low-voltage control and power splitter box. One power and data output to fixture run. Refer to LSBX specification sheet for details.

Control Systems

LTO2-Lumentouch 2.0™

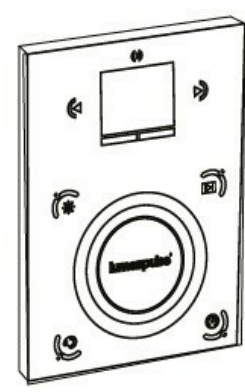

Lumentouch is a wall mount DMX 512 controller keypad.

LTN2-Lumentone™ 2

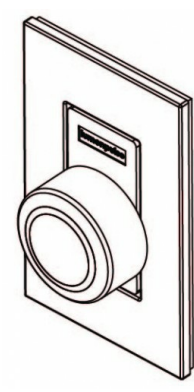

Lumentone 2 is a simple pre-programmed DMX 512 controller with a push button rotary dial and live feedback.

LCU-Lumencue



Lumencue is a USB / mini SD DMX 512 controller.

PHAROS-Pharos® kit

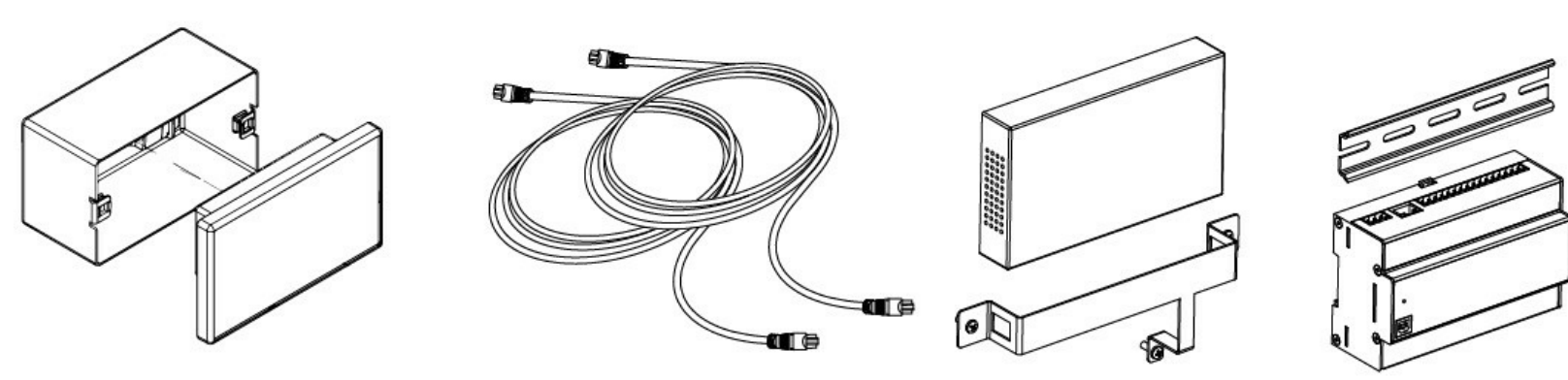

The Pharos kit, available for 1 or 2 DMX universes, allows for complete control of large lighting installations. 2 DMX universes kit shown.

Diagnostic and Addressing Tools

LID-LumenID

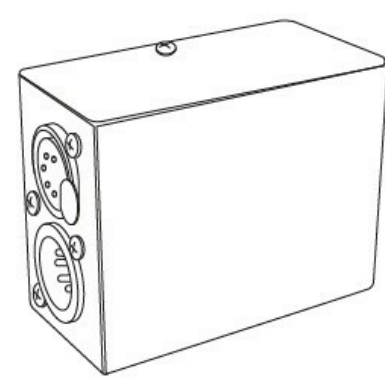

LumenID is a diagnostic and addressing DMX/RDM tool. It must be specified on all DMX applications. Refer to LID specification sheet for details.



How to order							
1	2	3	4	5	6	7	8
9	10	11	12				

1 . Housing	
LOGN	Lumenfacade™ Nano

2 . Wattage	
2W	2 W/ft <sup>(1)</sup>
4W	4 W/ft

3 . Voltage	
48V	48 VDC

4 . Length	
12	12 3/4 in (1.4 lbs)
24	24 3/4 in (2.9 lbs)
36	36 3/4 in (4.4 lbs)
48	48 3/4 in (6 lbs)

5 . Color and Color Temperature <sup>(2)</sup>	
22K	2200K
27K	2700K
30K	3000K
35K	3500K
40K	4000K
RD	Red
GR	Green
BL	Blue

6 . Optics	
8x8	8° x 8°
10x10	10° x 10°
10x30	10° x 30°
10x60	10° x 60°
10x90	10° x 90°
30x10	30° x 10°
30x30	30° x 30°
30x60	30° x 60°
30x90	30° x 90°
60x10	60° x 10°
60x60	60° x 60°
60x90	60° x 90°
90x90	90° x 90
W	Wide 120°
WW	Asymmetric Wallwash

7 . Lens	
CL	Clear lens <sup>(3)</sup>
FR	Frosted lens <sup>(4)</sup>
HFR	Half-frosted lens <sup>(5)</sup>

8 . Mounting Options <sup>(6)</sup>	
SAMN	Slim Adjustable Mounting Nano
UMPN	Fixed Mounting Nano
UMASN	Universal Adjustable Mounting Nano
WAMN2	Adjustable Wall Mounting Nano 2 in
WAMN6	Adjustable Extended Arm Mounting Nano 6 in
WAMN12	Adjustable Extended Arm Mounting Nano 12 in
WAMN18	Adjustable Extended Arm Mounting Nano 18 in

9 . Finish

BK	Black Sandtex®
BRZ	Bronze Sandtex®
SI	Silver Sandtex®
WH	Smooth white
CC	Custom color and finish (please specify RAL color) <sup>(7)</sup>

12 . Certification

UL	UL compliant
CE	CE compliant

10 . Control

NO	On/Off control <sup>(8)</sup>
DMX/RDM	DMX/RDM enabled (compatible with 0-10V or DMX/RDM systems) <sup>(9)</sup>

11 . Options

CRC	Corrosion-resistant coating for hostile environments <sup>(10)</sup>
-----	--

Notes:

- <sup>(1)</sup> Not available for static red, green or blue color options.
- <sup>(2)</sup> Consult factory for availability of static Royal Blue, 6500K and 90+ CRI.
- <sup>(3)</sup> Not available for 8x8, 10x10, W or WW optics.
- <sup>(4)</sup> Not available for WW optic.
- <sup>(5)</sup> Available for 8x8, 10x10 or WW optics only.
- <sup>(6)</sup> One mounting bracket provided for 12 in fixtures. Two mounting brackets provided for 24 in, 36 in and 48 in fixtures.
- <sup>(7)</sup> Lumenpulse offers a wide selection of RAL CLASSIC (K7) colors with a smooth texture and high-gloss finish. Please consult factory for a list of available K7 colors, other RAL textures and glosses, or to match alternate color charts. Final color matching results may vary.
- <sup>(8)</sup> A Low-Voltage Control Box (LCBX) or Low-Voltage Splitter Box (LSBX) must be specified.
- <sup>(9)</sup> A Low-Voltage Control Box (LCBX) or Low-Voltage Splitter Box (LSBX) and LumenID (LID) must be specified.
- <sup>(10)</sup> Use only when exposed to salt spray and harsh chemicals. This option is not required for normal outdoor exposure.